

ADDITIONAL NOTES:

The LOT dimensions and area shown hereon are subject to final field survey and also to the requirements of Council and any other authority which may have requirements under any relevant legislation

Final surface contours shown hereon have been supplied by Peak Urban.

Location of retaining walls are as shown on Engineering design drawings. Their as-constructed location may differ from their design location. Retaining wall heights have been supplied by Peak Urban. **The engineering detail shown hereon are preliminary only and are subject to change in final design and statutory approvals**

Compaction of any fill material placed on this site shall be completed to level one inspection and testing services in accordance with AS3798-2007.

Depth of fill values are calculated to the pre-development surface.

Copyright © Veris Australia Pty Ltd
26/04/2022.

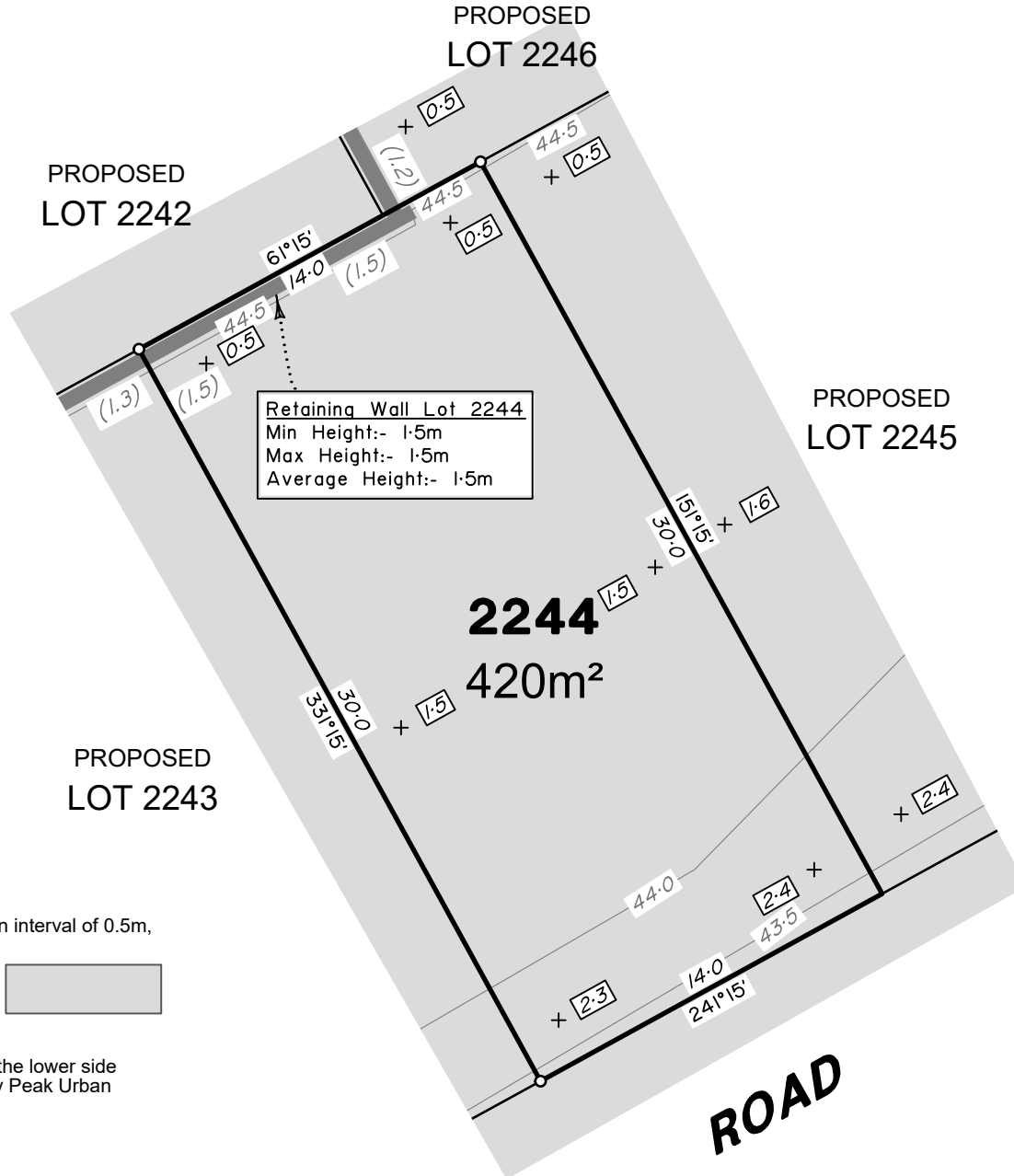

Retaining Wall Lot 2244
Min Height:- 1.5m
Max Height:- 1.5m
Average Height:- 1.5m

2244
420m²

ROAD

LEGEND

Final surface contours based on A.H.D. datum at an interval of 0.5m, shown as: 1.5.5

Where applicable, areas to be filled are shown as:

Depth of fill, in metres, shown as:- + 0.5

Retaining wall and retaining wall height, shown on the lower side of the wall, have been taken from plans supplied by Peak Urban and shown as: (1.2)

Bin Pad Location shown as:

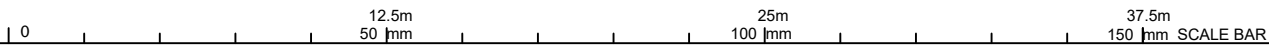

**FLAGSTONE
PRECINCT 1 STAGE 5D**
For
**PEET FLAGSTONE
CITY PTY LTD**

IMPORTANT NOTES:
(These notes are an integral part of this plan)

This plan has been prepared for **PEET FLAGSTONE CITY PTY LTD** for the purposes of **A Disclosure Plan Under the Land Sales Act 1984 (as amended)**.

It is not to be used by any other person or corporation or for any other purposes and is subject to the following limitations:

Please refer to the approved Development Application for conditions relating to the LOT and to approved Operational Works drawings for services location and possible easements.

THESE DESIGNS AND DRAWINGS ARE COPYRIGHT AND ARE NOT TO BE USED OR REPRODUCED WITHOUT THE WRITTEN PERMISSION OF VERIS

Data Sources
Cadastral Boundaries
30109-LC-Master(CX) F594 2014.dwg
Engineering Design
FLAGSTONE - STAGE 5 D L M - DISCLOSURE INFO - 12/04/2022 - BASE FILE
Final Surface Contours
FLAGSTONE - STAGE 5 D L M - DISCLOSURE INFO - 22/04/2022 - TIN DESIGN
Depth of Fill
FLAGSTONE - STAGE 5 D L M - DISCLOSURE INFO - 22/04/2022 - Depth Contours in 3D

Issue	Revisions	Date	Drawn
A	Original	26.04.2022	BK

Locality: FLAGSTONE
Local Authority: LOGAN CITY COUNCIL
Horizontal Meridian: MGA, Zone 56
Vertical Level Datum: AHD D
Scale: 1:250 @ A4
Designed: Peak Urban
Drawn: BK 26/04/2022
Checked: DE 26/04/2022
Plot Date: 04 May, 2022
Computer File Ref: 30109-StSD-DP-(A).dwg

DISCLOSURE PLAN
of Proposed LOT 2244
being part of
Lot 911
on SP321079



veris

BRISBANE (07) 3686 4700 WHITSUNDAYS (07) 4945 6600
MACKAY (07) 4957 9700 CAIRNS (07) 4252 9400

veris.com.au
ACN 615 735 727
Veris Australia Pty Ltd

Drawing No: 30109-DP- 2244 Issue: A

ADDITIONAL NOTES:

The LOT dimensions and area shown hereon are subject to final field survey and also to the requirements of Council and any other authority which may have requirements under any relevant legislation

Final surface contours shown hereon have been supplied by Peak Urban.

Location of retaining walls are as shown on Engineering design drawings. Their as-constructed location may differ from their design location. Retaining wall heights have been supplied by Peak Urban. **The engineering detail shown hereon are preliminary only and are subject to change in final design and statutory approvals**

Compaction of any fill material placed on this site shall be completed to level one inspection and testing services in accordance with AS3798-2007.

Depth of fill values are calculated to the pre-development surface.

Copyright © Veris Australia Pty Ltd
26/04/2022.

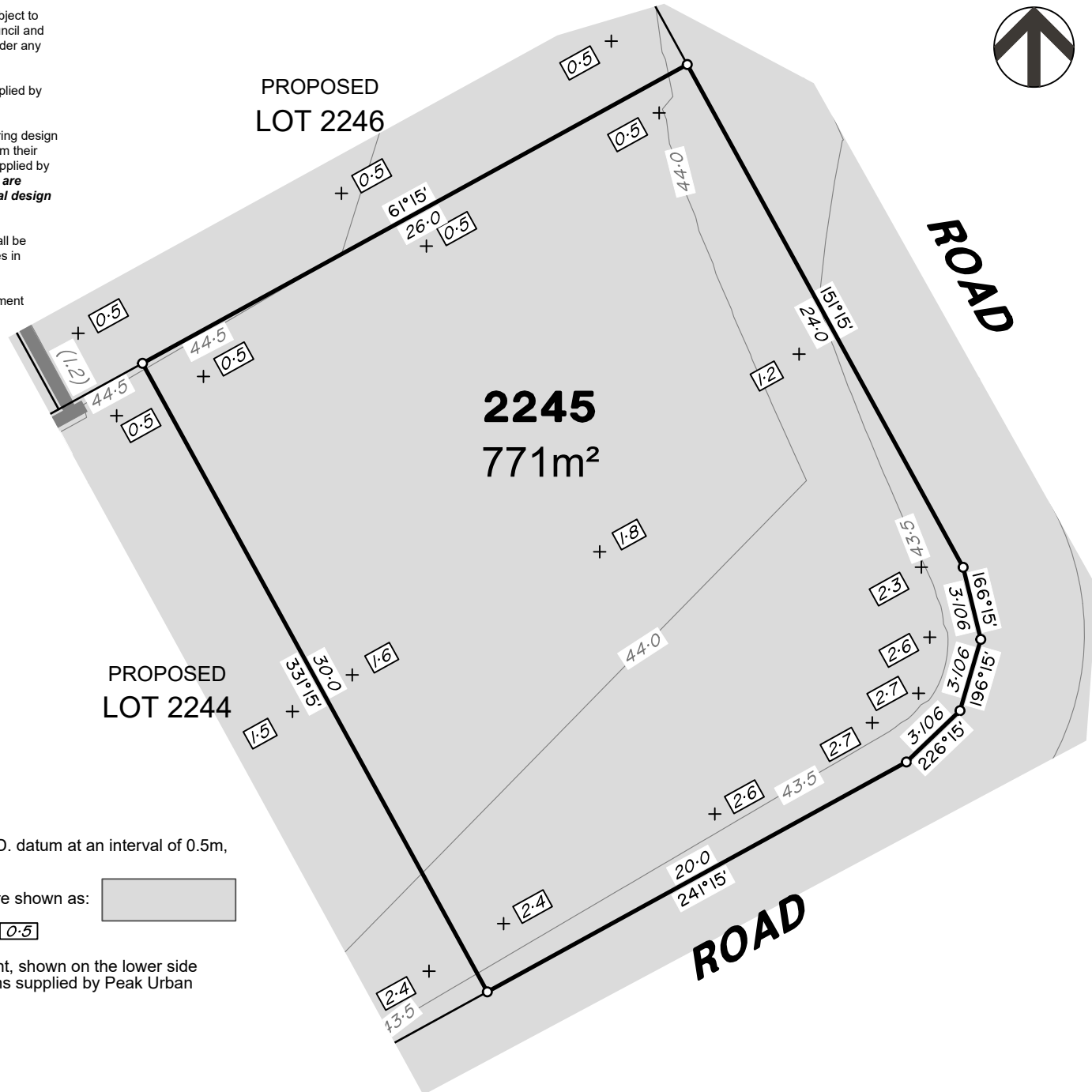

LEGEND

Final surface contours based on A.H.D. datum at an interval of 0.5m, shown as: 15.5

Where applicable, areas to be filled are shown as:

Depth of fill, in metres, shown as: - + 0.5

Retaining wall and retaining wall height, shown on the lower side of the wall, have been taken from plans supplied by Peak Urban and shown as: (1.2)

Bin Pad Location shown as:



**FLAGSTONE
PRECINCT 1 STAGE 5D**
For
**PEET FLAGSTONE
CITY PTY LTD**

IMPORTANT NOTES:
(These notes are an integral part of this plan)

This plan has been prepared for PEET FLAGSTONE CITY PTY LTD for the purposes of **A Disclosure Plan Under the Land Sales Act 1984 (as amended)**.

It is not to be used by any other person or corporation or for any other purposes and is subject to the following limitations:

Please refer to the approved Development Application for conditions relating to the LOT and to approved Operational Works drawings for services location and possible easements.

THESE DESIGNS AND DRAWINGS ARE COPYRIGHT AND ARE NOT TO BE USED OR REPRODUCED WITHOUT THE WRITTEN PERMISSION OF VERIS

Data Sources
Cadastral Boundaries
30109-LC-Master(CX) F594 2014.dwg
Engineering Design
FLAGSTONE - STAGE 5 D L M - DISCLOSURE INFO - 12 04 2022 - BASE FILE
Final Surface Contours
FLAGSTONE - STAGE 5 D L M - DISCLOSURE INFO - 22 04 2022 - TIN DESIGN
Depth of Fill
FLAGSTONE - STAGE 5 D L M - DISCLOSURE INFO - 22 04 2022 - Depth Contours in 3D

Issue	Revisions	Date	Drawn
A	Original	26.04.2022	BK

Locality: FLAGSTONE
Local Authority: LOGAN CITY COUNCIL
Horizontal Meridian: MGA, Zone 56
Vertical Level Datum: AHD D
Scale: 1:250 @ A4
Designed: Peak Urban
Drawn: BK 26/04/2022
Checked: DE 26/04/2022
Plot Date: 04 May, 2022
Computer File Ref: 30109-StSD-DP-(A).dwg

**DISCLOSURE PLAN
of Proposed LOT 2245
being part of
Lot 911
on SP321079**



BRISBANE (07) 3686 4700 WHITSUNDAYS (07) 4945 6600

MACKAY (07) 4957 9700 CAIRNS (07) 4252 9400

veris.com.au
ACN 615 735 727
Veris Australia Pty Ltd

Drawing No Issue
30109-DP- 2245 A

ADDITIONAL NOTES:

The LOT dimensions and area shown hereon are subject to final field survey and also to the requirements of Council and any other authority which may have requirements under any relevant legislation

Final surface contours shown hereon have been supplied by Peak Urban.

Location of retaining walls are as shown on Engineering design drawings. Their as-constructed location may differ from their design location. Retaining wall heights have been supplied by Peak Urban. **The engineering detail shown hereon are preliminary only and are subject to change in final design and statutory approvals**

Compaction of any fill material placed on this site shall be completed to level one inspection and testing services in accordance with AS3798-2007.

Depth of fill values are calculated to the pre-development surface.

Copyright © Veris Australia Pty Ltd
26/04/2022.

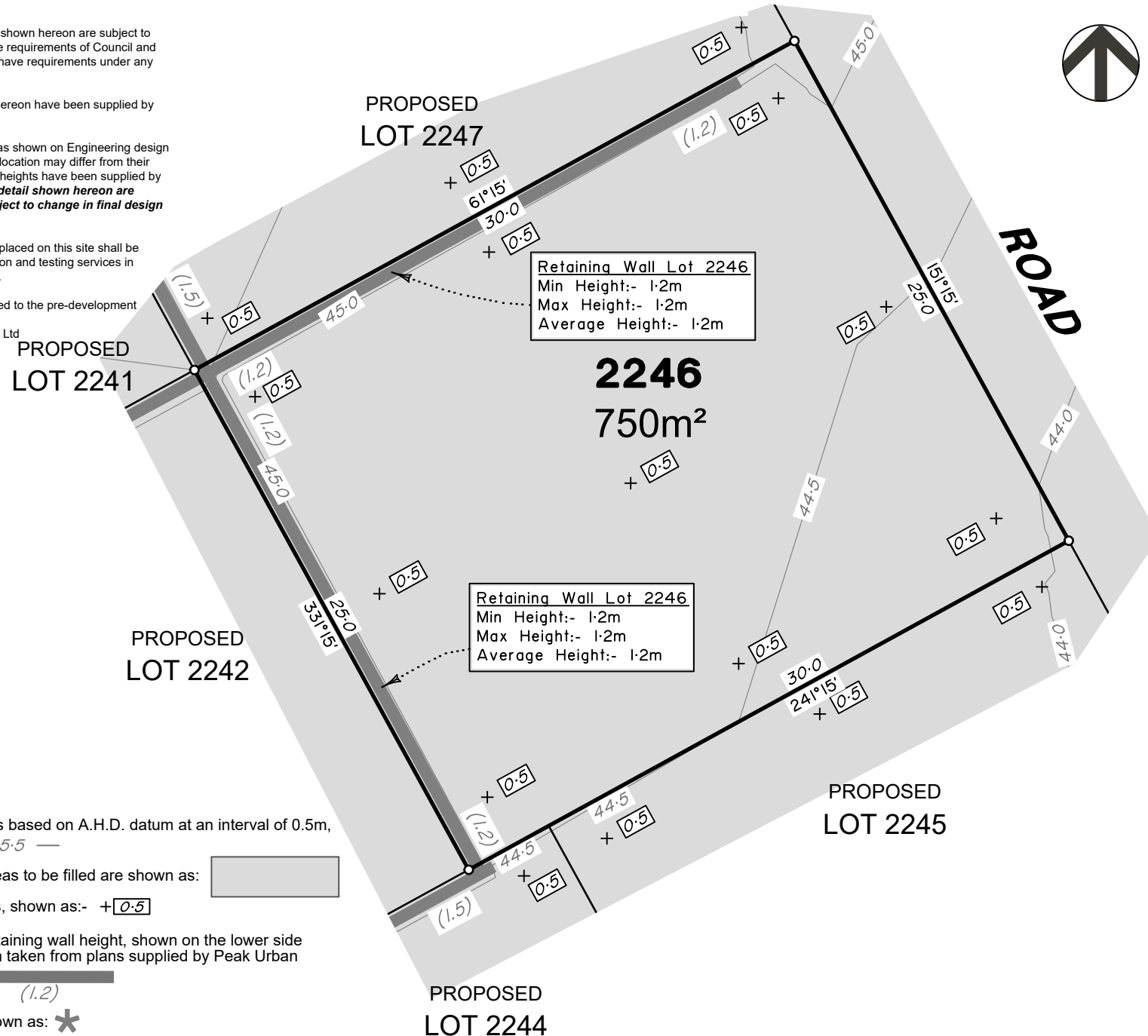

Retaining Wall Lot 2246
Min Height:- 1.2m
Max Height:- 1.2m
Average Height:- 1.2m

Retaining Wall Lot 2246
Min Height:- 1.2m
Max Height:- 1.2m
Average Height:- 1.2m

2246
750m²

LEGEND

Final surface contours based on A.H.D. datum at an interval of 0.5m, shown as: 1.5.5

Where applicable, areas to be filled are shown as:

Depth of fill, in metres, shown as:- 0.5

Retaining wall and retaining wall height, shown on the lower side of the wall, have been taken from plans supplied by Peak Urban and shown as: (1.2)

Bin Pad Location shown as:



**FLAGSTONE
PRECINCT 1 STAGE 5D**
For
**PEET FLAGSTONE
CITY PTY LTD**

IMPORTANT NOTES:
(These notes are an integral part of this plan)

This plan has been prepared for PEET FLAGSTONE CITY PTY LTD for the purposes of **A Disclosure Plan Under the Land Sales Act 1984 (as amended)**.

It is not to be used by any other person or corporation or for any other purposes and is subject to the following limitations:

Please refer to the approved Development Application for conditions relating to the LOT and to approved Operational Works drawings for services location and possible easements.

THESE DESIGNS AND DRAWINGS ARE COPYRIGHT AND ARE NOT TO BE USED OR REPRODUCED WITHOUT THE WRITTEN PERMISSION OF VERIS

Data Sources
Cadastral Boundaries
30109-LC-Master(CX) F594 2014.dwg
Engineering Design
FLAGSTONE - STAGE 5 D L M - DISCLOSURE INFO - 12/04/2022 - BASE FILE
Final Surface Contours
FLAGSTONE - STAGE 5 D L M - DISCLOSURE INFO - 22/04/2022 - TIN DESIGN
Depth of Fill
FLAGSTONE - STAGE 5 D L M - DISCLOSURE INFO - 22/04/2022 - Depth Contours in 3D

Issue	Revisions	Date	BK	Drawn
A	Original	26.04.2022		BK

Locality: FLAGSTONE
Local Authority: LOGAN CITY COUNCIL
Horizontal Meridian: MGA, Zone 56
Vertical Level Datum: AHD D
Scale: 1:250 @ A4
Designed: Peak Urban
Drawn: BK 26/04/2022
Checked: DE 26/04/2022
Plot Date: 04 May, 2022
Computer File Ref: 30109-StSD-DP-(A).dwg

DISCLOSURE PLAN
of Proposed LOT 2246
being part of
Lot 911
on SP321079



veris

BRISBANE WHITSUNDAYS
(07) 3686 4700 (07) 4945 6600

MACKAY CAIRNS
(07) 4957 9700 (07) 4252 9400

veris.com.au
ACN 615 735 727
Veris Australia Pty Ltd

Drawing No Issue
30109-DP- 2246 A

ADDITIONAL NOTES:

The LOT dimensions and area shown hereon are subject to final field survey and also to the requirements of Council and any other authority which may have requirements under any relevant legislation

Final surface contours shown hereon have been supplied by Peak Urban.

Location of retaining walls are as shown on Engineering design drawings. Their as-constructed location may differ from their design location. Retaining wall heights have been supplied by Peak Urban. **The engineering detail shown hereon are preliminary only and are subject to change in final design and statutory approvals**

Compaction of any fill material placed on this site shall be completed to level one inspection and testing services in accordance with AS3798-2007.

Depth of fill values are calculated to the pre-development surface.

Copyright © Veris Australia Pty Ltd
26/04/2022.



**FLAGSTONE
PRECINCT 1 STAGE 5D**
For
**PEET FLAGSTONE
CITY PTY LTD**

IMPORTANT NOTES:
(These notes are an integral part of this plan)

This plan has been prepared for PEET FLAGSTONE CITY PTY LTD for the purposes of a Disclosure Plan Under the Land Sales Act 1984 (as amended).

It is not to be used by any other person or corporation or for any other purposes and is subject to the following limitations:

Please refer to the approved Development Application for conditions relating to the LOT and to approved Operational Works drawings for services location and possible easements.

THESE DESIGNS AND DRAWINGS ARE COPYRIGHT AND ARE NOT TO BE USED OR REPRODUCED WITHOUT THE WRITTEN PERMISSION OF VERIS

Data Sources
Cadastral Boundaries
30109-LC-Master(CX) F994 2014.dwg
Engineering Design
FLAGSTONE - STAGE 5 D L M - DISCLOSURE INFO - 12/04/2022 - BASE FILE
Final Surface Contours
FLAGSTONE - STAGE 5 D L M - DISCLOSURE INFO - 22/04/2022 - TIN DESIGN
Depth of Fill
FLAGSTONE - STAGE 5 D L M - DISCLOSURE INFO - 22/04/2022 - Depth Contours in 3D

Issue	Revisions	Date	Drawn
A	Original	26.04.2022	BK

Locality: FLAGSTONE
Local Authority: LOGAN CITY COUNCIL
Horizontal Meridian: MGA, Zone 56
Vertical Level Datum: AHD D
Scale: 1:250 @ A4
Designed: Peak Urban
Drawn: BK 26/04/2022
Checked: DE 26/04/2022
Plot Date: 04 May, 2022
Computer File Ref: 30109-StSD-DP-(A).dwg

**DISCLOSURE PLAN
of Proposed LOT 2247**
being part of
Lot 911
on SP321079



veris

BRISBANE WHITSUNDAYS
(07) 3686 4700 (07) 4945 6600

MACKAY CAIRNS
(07) 4957 9700 (07) 4252 9400

veris.com.au
ACN 615 735 727
Veris Australia Pty Ltd

Drawing No Issue
30109-DP- 2247 A

Retaining Wall Lot 2247
Min Height:- 1.2m
Max Height:- 1.2m
Average Height:- 1.2m

PROPOSED
LOT 2248

2247
600m²

ROAD

PROPOSED
LOT 2240

Retaining Wall Lot 2247
Min Height:- 1.5m
Max Height:- 1.5m
Average Height:- 1.5m

PROPOSED
LOT 2241

Retaining Wall Lot 2246
Min Height:- 1.2m
Max Height:- 1.2m
Average Height:- 1.2m

PROPOSED
LOT 2246

PROPOSED
LOT 2242

LEGEND

Final surface contours based on A.H.D. datum at an interval of 0.5m, shown as: 15.5

Where applicable, areas to be filled are shown as:

Depth of fill, in metres, shown as:- +0.5

Retaining wall and retaining wall height, shown on the lower side of the wall, have been taken from plans supplied by Peak Urban and shown as:

Bin Pad Location shown as:



ADDITIONAL NOTES:

The LOT dimensions and area shown hereon are subject to final field survey and also to the requirements of Council and any other authority which may have requirements under any relevant legislation

Final surface contours shown hereon have been supplied by Peak Urban.

Location of retaining walls are as shown on Engineering design drawings. Their as-constructed location may differ from their design location. Retaining wall heights have been supplied by Peak Urban. **The engineering detail shown hereon are preliminary only and are subject to change in final design and statutory approvals**

Compaction of any fill material placed on this site shall be completed to level one inspection and testing services in accordance with AS3798-2007.

Depth of fill values are calculated to the pre-development surface.

Copyright © Veris Australia Pty Ltd
26/04/2022.

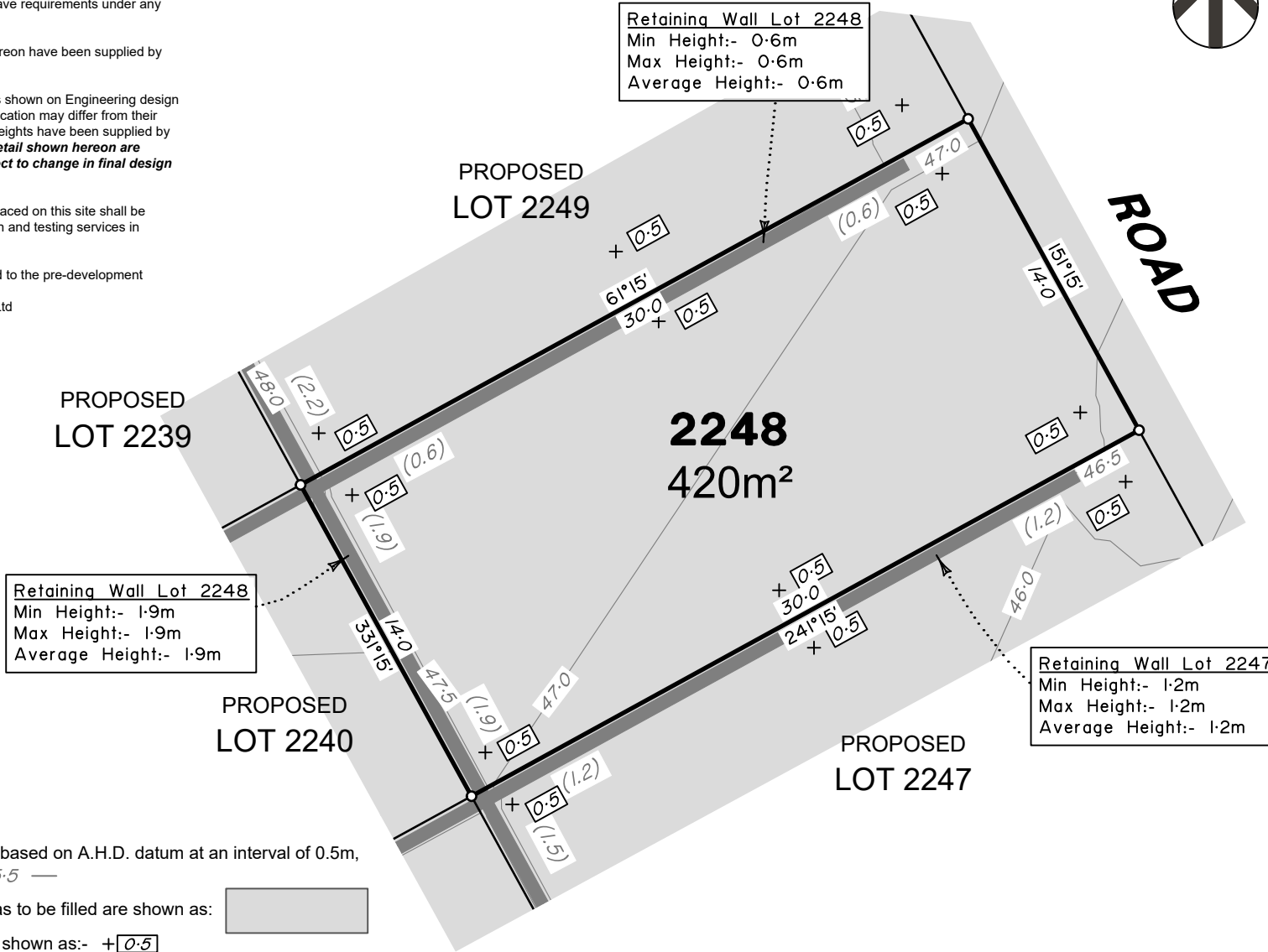

LEGEND

Final surface contours based on A.H.D. datum at an interval of 0.5m, shown as: 15.5

Where applicable, areas to be filled are shown as:

Depth of fill, in metres, shown as:- 0.5

Retaining wall and retaining wall height, shown on the lower side of the wall, have been taken from plans supplied by Peak Urban and shown as: (1.2)

Bin Pad Location shown as:

PROPOSED LOT 2241



**FLAGSTONE
PRECINCT 1 STAGE 5D**
For
**PEET FLAGSTONE
CITY PTY LTD**

IMPORTANT NOTES:
(These notes are an integral part of this plan)

This plan has been prepared for PEET FLAGSTONE CITY PTY LTD for the purposes of a Disclosure Plan Under the Land Sales Act 1984 (as amended).

It is not to be used by any other person or corporation or for any other purposes and is subject to the following limitations:

Please refer to the approved Development Application for conditions relating to the LOT and to approved Operational Works drawings for services location and possible easements.

THESE DESIGNS AND DRAWINGS ARE COPYRIGHT AND ARE NOT TO BE USED OR REPRODUCED WITHOUT THE WRITTEN PERMISSION OF VERIS

Data Sources
Cadastral Boundaries
30109-LC-Master(CX) FS94 2014.dwg
Engineering Design
FLAGSTONE - STAGE 5 D L M - DISCLOSURE INFO - 12 04 2022 - BASE FILE
Final Surface Contours
FLAGSTONE - STAGE 5 D L M - DISCLOSURE INFO - 22 04 2022 - TIN DESIGN
Depth of Fill
FLAGSTONE - STAGE 5 D L M - DISCLOSURE INFO - 22 04 2022 - Depth Contours in 3D

Issue	Revisions	Date	Drawn
A	Original	26.04.2022	BK

Locality: FLAGSTONE
Local Authority: LOGAN CITY COUNCIL
Horizontal Meridian: MGA, Zone 56
Vertical Level Datum: AHD D
Scale: 1:250 @ A4
Designed: Peak Urban
Drawn: BK 26/04/2022
Checked: DE 26/04/2022
Plot Date: 04 May, 2022
Computer File Ref: 30109-STSD-DP-(A).dwg

DISCLOSURE PLAN
of Proposed LOT 2248
being part of
Lot 911
on SP321079



veris

BRISBANE WHITSUNDAYS
(07) 3686 4700 (07) 4945 6600

MACKAY CAIRNS
(07) 4957 9700 (07) 4252 9400

veris.com.au
ACN 615 735 727
Veris Australia Pty Ltd

Drawing No Issue
30109-DP- 2248 A

ADDITIONAL NOTES:

The LOT dimensions and area shown hereon are subject to final field survey and also to the requirements of Council and any other authority which may have requirements under any relevant legislation

Final surface contours shown hereon have been supplied by Peak Urban.

Location of retaining walls are as shown on Engineering design drawings. Their as-constructed location may differ from their design location. Retaining wall heights have been supplied by Peak Urban. **The engineering detail shown hereon are preliminary only and are subject to change in final design and statutory approvals**

Compaction of any fill material placed on this site shall be completed to level one inspection and testing services in accordance with AS3798-2007.

Depth of fill values are calculated to the pre-development surface.

Copyright © Veris Australia Pty Ltd
26/04/2022.

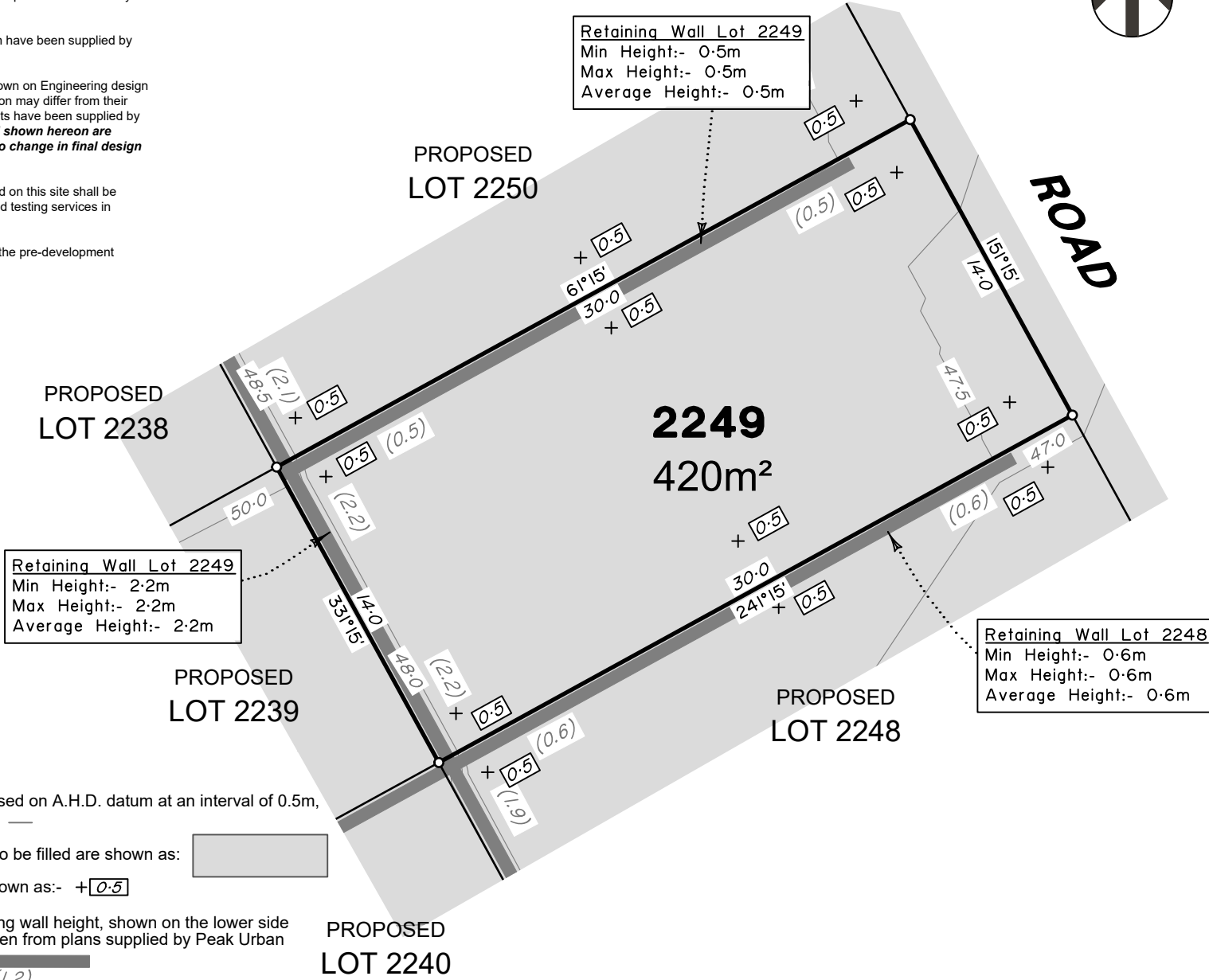

LEGEND

Final surface contours based on A.H.D. datum at an interval of 0.5m, shown as: 15.5

Where applicable, areas to be filled are shown as:

Depth of fill, in metres, shown as:- +

Retaining wall and retaining wall height, shown on the lower side of the wall, have been taken from plans supplied by Peak Urban and shown as:

(1.2)

Bin Pad Location shown as:



**FLAGSTONE
PRECINCT 1 STAGE 5D**
For
**PEET FLAGSTONE
CITY PTY LTD**

IMPORTANT NOTES:
(These notes are an integral part of this plan)

This plan has been prepared for PEET FLAGSTONE CITY PTY LTD for the purposes of a Disclosure Plan Under the Land Sales Act 1984 (as amended).

It is not to be used by any other person or corporation or for any other purposes and is subject to the following limitations:

Please refer to the approved Development Application for conditions relating to the LOT and to approved Operational Works drawings for services location and possible easements.

THESE DESIGNS AND DRAWINGS ARE COPYRIGHT AND ARE NOT TO BE USED OR REPRODUCED WITHOUT THE WRITTEN PERMISSION OF VERIS

Data Sources
Cadastral Boundaries
30109-LC-Master(CX) FS94 2014.dwg
Engineering Design
FLAGSTONE - STAGE 5 D L M - DISCLOSURE INFO - 12/04/2022 - BASE FILE
Final Surface Contours
FLAGSTONE - STAGE 5 D L M - DISCLOSURE INFO - 22/04/2022 - TIN DESIGN
Depth of Fill
FLAGSTONE - STAGE 5 D L M - DISCLOSURE INFO - 22/04/2022 - Depth Contours in 3D

Issue	Revisions	Date	BK	Drawn
A	Original	26.04.2022		BK

Locality: FLAGSTONE
Local Authority: LOGAN CITY COUNCIL
Horizontal Meridian: MGA, Zone 56
Vertical Level Datum: AHD D
Scale: 1:250 @ A4
Designed: Peak Urban
Drawn: BK 26/04/2022
Checked: DE 26/04/2022
Plot Date: 04 May, 2022
Computer File Ref: 30109-StSD-DP-(A).dwg

DISCLOSURE PLAN
of Proposed LOT 2249
being part of
Lot 911
on SP321079



BRISBANE (07) 3686 4700 WHITSUNDAYS (07) 4945 6600

MACKAY (07) 4957 9700 CAIRNS (07) 4252 9400

veris.com.au
ACN 615 735 727
Veris Australia Pty Ltd

Drawing No: 30109-DP- 2249 Issue: A

ADDITIONAL NOTES:

The LOT dimensions and area shown hereon are subject to final field survey and also to the requirements of Council and any other authority which may have requirements under any relevant legislation

Final surface contours shown hereon have been supplied by Peak Urban.

Location of retaining walls are as shown on Engineering design drawings. Their as-constructed location may differ from their design location. Retaining wall heights have been supplied by Peak Urban. **The engineering detail shown hereon are preliminary only and are subject to change in final design and statutory approvals**

Compaction of any fill material placed on this site shall be completed to level one inspection and testing services in accordance with AS3798-2007.

Depth of fill values are calculated to the pre-development surface.

Copyright © Veris Australia Pty Ltd
26/04/2022.

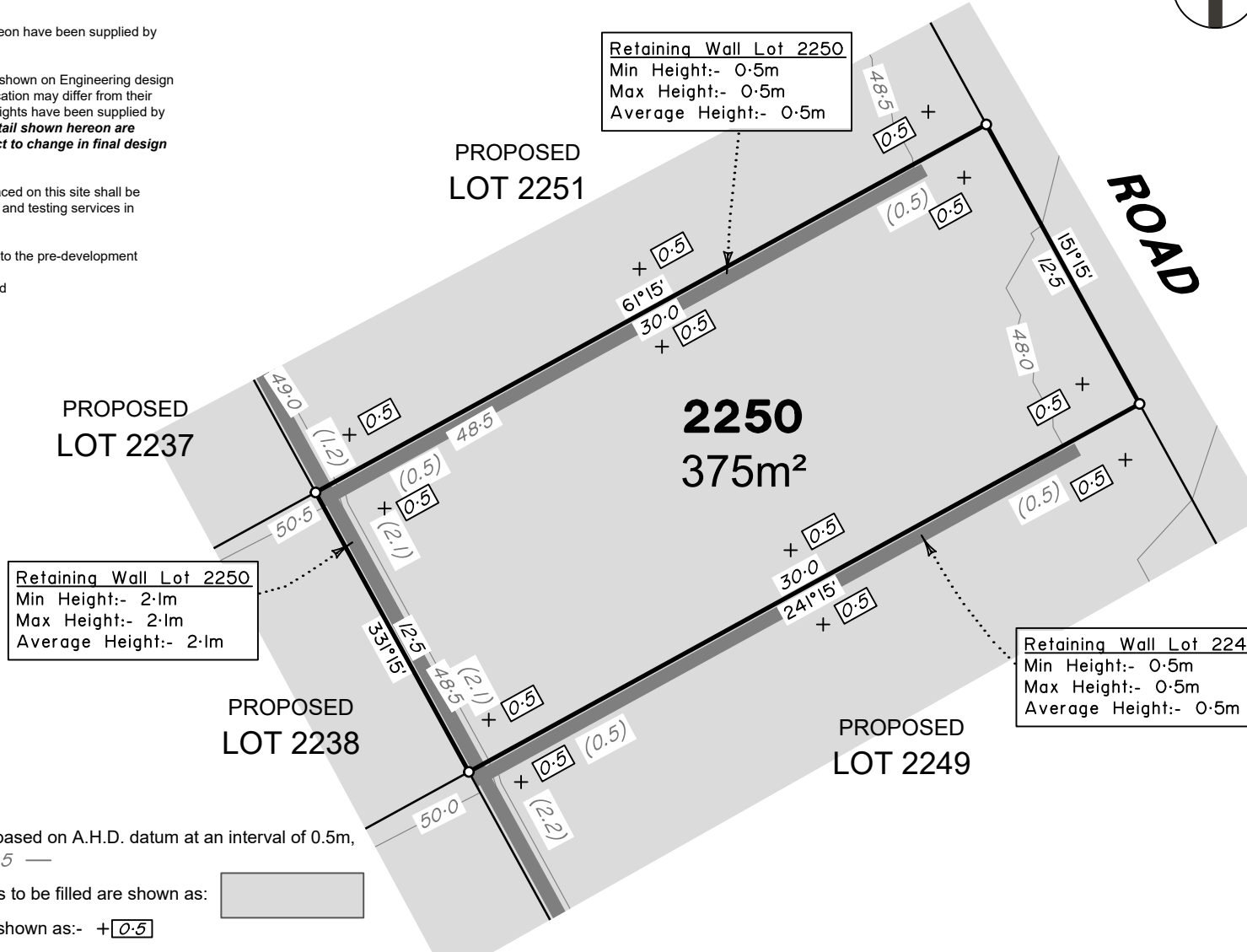

LEGEND

Final surface contours based on A.H.D. datum at an interval of 0.5m, shown as: 15.5

Where applicable, areas to be filled are shown as:

Depth of fill, in metres, shown as:- + 0.5

Retaining wall and retaining wall height, shown on the lower side of the wall, have been taken from plans supplied by Peak Urban and shown as: (1.2)

Bin Pad Location shown as:



**FLAGSTONE
PRECINCT 1 STAGE 5D**
For
**PEET FLAGSTONE
CITY PTY LTD**

IMPORTANT NOTES:
(These notes are an integral part of this plan)

This plan has been prepared for PEET FLAGSTONE CITY PTY LTD for the purposes of a Disclosure Plan Under the Land Sales Act 1984 (as amended).

It is not to be used by any other person or corporation or for any other purposes and is subject to the following limitations:

Please refer to the approved Development Application for conditions relating to the LOT and to approved Operational Works drawings for services location and possible easements.

THESE DESIGNS AND DRAWINGS ARE COPYRIGHT AND ARE NOT TO BE USED OR REPRODUCED WITHOUT THE WRITTEN PERMISSION OF VERIS

Data Sources
Cadastral Boundaries
30109-LC-Master(CX) FS94 2014.dwg
Engineering Design
FLAGSTONE - STAGE 5 D L M - DISCLOSURE INFO - 12 04 2022 - BASE FILE
Final Surface Contours
FLAGSTONE - STAGE 5 D L M - DISCLOSURE INFO - 22 04 2022 - TIN DESIGN
Depth of Fill
FLAGSTONE - STAGE 5 D L M - DISCLOSURE INFO - 22 04 2022 - Depth Contours in 3D

Issue	Revisions	Date	Drawn
A	Original	26.04.2022	BK

Locality: FLAGSTONE
Local Authority: LOGAN CITY COUNCIL
Horizontal Meridian: MGA, Zone 56
Vertical Level Datum: AHD D
Scale: 1:250 @ A4
Designed: Peak Urban
Drawn: BK 26/04/2022
Checked: DE 26/04/2022
Plot Date: 04 May, 2022
Computer File Ref: 30109-STSD-DP-(A).dwg

DISCLOSURE PLAN
of Proposed LOT 2250
being part of
Lot 911
on SP321079



BRISBANE WHITSUNDAYS
(07) 3686 4700 (07) 4945 6600

MACKAY CAIRNS
(07) 4957 9700 (07) 4252 9400

veris.com.au
ACN 615 735 727
Veris Australia Pty Ltd

Drawing No Issue
30109-DP- 2250 A

ADDITIONAL NOTES:

The LOT dimensions and area shown hereon are subject to final field survey and also to the requirements of Council and any other authority which may have requirements under any relevant legislation

Final surface contours shown hereon have been supplied by Peak Urban.

Location of retaining walls are as shown on Engineering design drawings. Their as-constructed location may differ from their design location. Retaining wall heights have been supplied by Peak Urban. **The engineering detail shown hereon are preliminary only and are subject to change in final design and statutory approvals**

Compaction of any fill material placed on this site shall be completed to level one inspection and testing services in accordance with AS3798-2007.

Depth of fill values are calculated to the pre-development surface.

Copyright © Veris Australia Pty Ltd
26/04/2022.

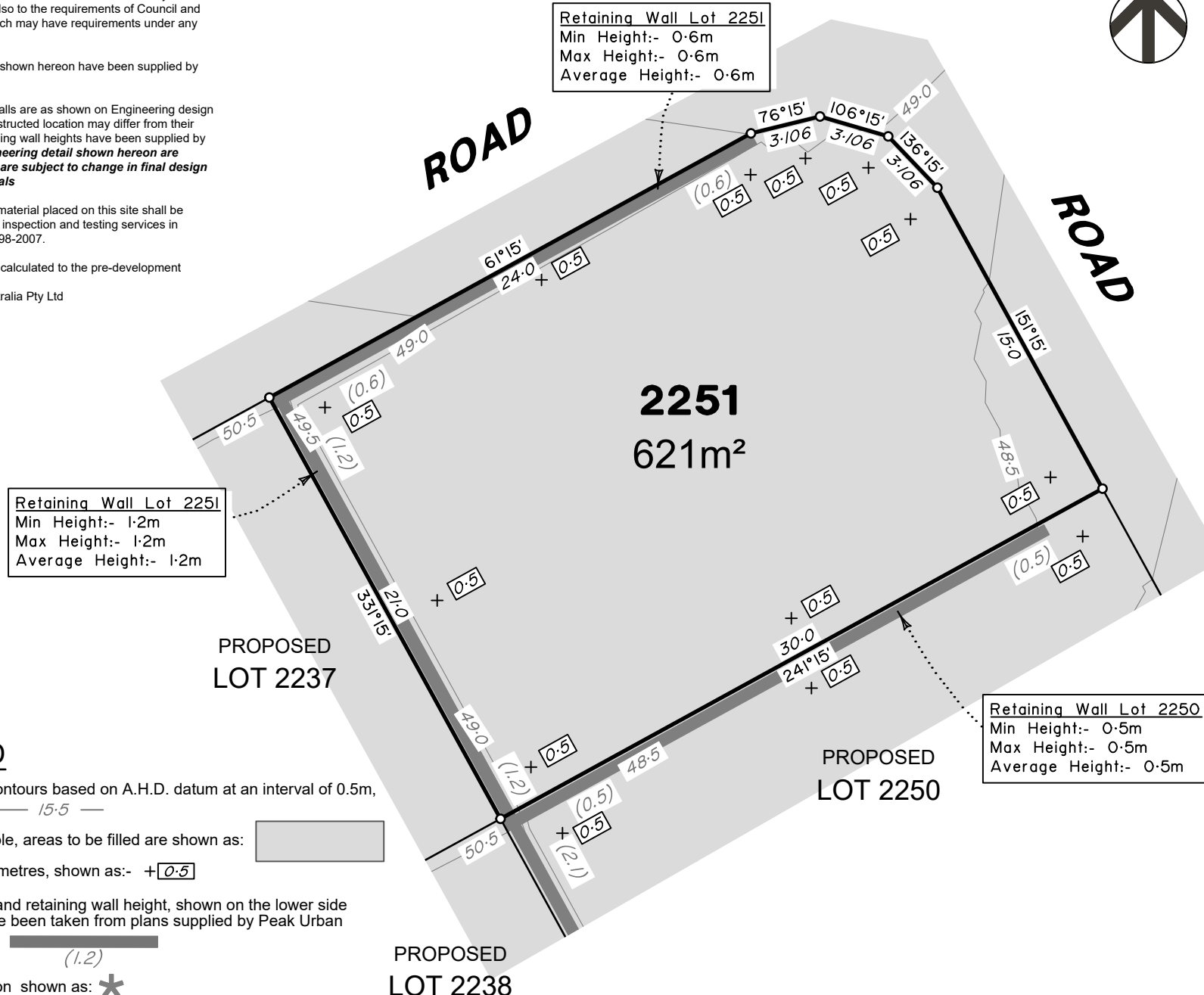

Retaining Wall Lot 2251
Min Height:- 0.6m
Max Height:- 0.6m
Average Height:- 0.6m

Retaining Wall Lot 2251
Min Height:- 1.2m
Max Height:- 1.2m
Average Height:- 1.2m

Retaining Wall Lot 2250
Min Height:- 0.5m
Max Height:- 0.5m
Average Height:- 0.5m

LEGEND

Final surface contours based on A.H.D. datum at an interval of 0.5m, shown as: 15.5

Where applicable, areas to be filled are shown as:

Depth of fill, in metres, shown as:- + 0.5

Retaining wall and retaining wall height, shown on the lower side of the wall, have been taken from plans supplied by Peak Urban and shown as: (1.2)

Bin Pad Location shown as:

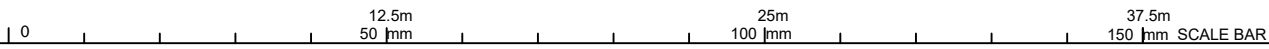

**FLAGSTONE
PRECINCT 1 STAGE 5D**
For
**PEET FLAGSTONE
CITY PTY LTD**

IMPORTANT NOTES:
(These notes are an integral part of this plan)

This plan has been prepared for PEET FLAGSTONE CITY PTY LTD for the purposes of a Disclosure Plan Under the Land Sales Act 1984 (as amended).

It is not to be used by any other person or corporation or for any other purposes and is subject to the following limitations:

Please refer to the approved Development Application for conditions relating to the LOT and to approved Operational Works drawings for services location and possible easements.

THESE DESIGNS AND DRAWINGS ARE COPYRIGHT AND ARE NOT TO BE USED OR REPRODUCED WITHOUT THE WRITTEN PERMISSION OF VERIS

Data Sources
Cadastral Boundaries
30109-LC-Master(CX) FS94 2014.dwg
Engineering Design
FLAGSTONE - STAGE 5 D L M - DISCLOSURE INFO - 12/04/2022 - BASE FILE
Final Surface Contours
FLAGSTONE - STAGE 5 D L M - DISCLOSURE INFO - 22/04/2022 - TIN DESIGN
Depth of Fill
FLAGSTONE - STAGE 5 D L M - DISCLOSURE INFO - 22/04/2022 - Depth Contours in 3D

Issue	Revisions	Date	Drawn
A	Original	26.04.2022	BK

Locality: FLAGSTONE
Local Authority: LOGAN CITY COUNCIL
Horizontal Meridian: MGA, Zone 56
Vertical Level Datum: AHD D
Scale: 1:250 @ A4
Designed: Peak Urban
Drawn: BK 26/04/2022
Checked: DE 26/04/2022
Plot Date: 04 May, 2022
Computer File Ref: 30109-SISD-DP-(A).dwg

DISCLOSURE PLAN
of Proposed LOT 2251
being part of
Lot 911
on SP321079



veris

BRISBANE (07) 3686 4700 WHITSUNDAYS (07) 4945 6600
MACKAY (07) 4957 9700 CAIRNS (07) 4252 9400

veris.com.au
ACN 615 735 727
Veris Australia Pty Ltd

Drawing No: 30109-DP- 2251 Issue: A

ADDITIONAL NOTES:

The LOT dimensions and area shown hereon are subject to final field survey and also to the requirements of Council and any other authority which may have requirements under any relevant legislation

Final surface contours shown hereon have been supplied by Peak Urban.

Location of retaining walls are as shown on Engineering design drawings. Their as-constructed location may differ from their design location. Retaining wall heights have been supplied by Peak Urban. **The engineering detail shown hereon are preliminary only and are subject to change in final design and statutory approvals**

Compaction of any fill material placed on this site shall be completed to level one inspection and testing services in accordance with AS3798-2007.

Depth of fill values are calculated to the pre-development surface.

Copyright © Veris Australia Pty Ltd
26/04/2022.

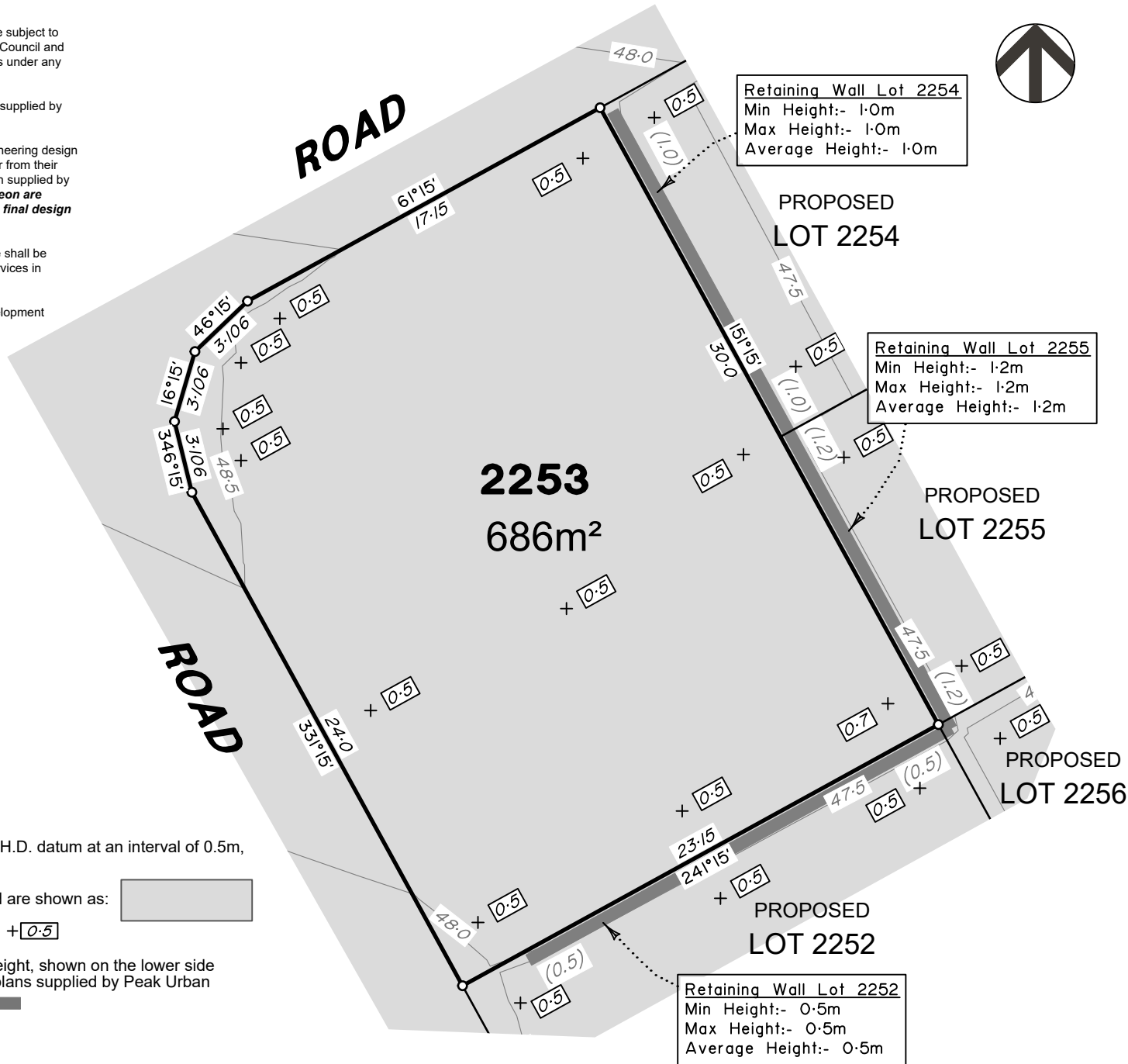

LEGEND

Final surface contours based on A.H.D. datum at an interval of 0.5m, shown as: 15.5

Where applicable, areas to be filled are shown as:

Depth of fill, in metres, shown as:- + 0.5

Retaining wall and retaining wall height, shown on the lower side of the wall, have been taken from plans supplied by Peak Urban and shown as: (1.2)

Bin Pad Location shown as:



**FLAGSTONE
PRECINCT 1 STAGE 5D**
For
**PEET FLAGSTONE
CITY PTY LTD**

IMPORTANT NOTES:
(These notes are an integral part of this plan)

This plan has been prepared for PEET FLAGSTONE CITY PTY LTD for the purposes of a Disclosure Plan Under the Land Sales Act 1984 (as amended).

It is not to be used by any other person or corporation or for any other purposes and is subject to the following limitations:

Please refer to the approved Development Application for conditions relating to the LOT and to approved Operational Works drawings for services location and possible easements.

THESE DESIGNS AND DRAWINGS ARE COPYRIGHT AND ARE NOT TO BE USED OR REPRODUCED WITHOUT THE WRITTEN PERMISSION OF VERIS

Data Sources
Cadastral Boundaries
30109-LC-Master(CX) FS94 2014.dwg
Engineering Design
FLAGSTONE - STAGE 5 D L M - DISCLOSURE INFO - 12/04/2022 - BASE FILE
Final Surface Contours
FLAGSTONE - STAGE 5 D L M - DISCLOSURE INFO - 22/04/2022 - TIN DESIGN
Depth of Fill
FLAGSTONE - STAGE 5 D L M - DISCLOSURE INFO - 22/04/2022 - Depth Contours in 3D

Issue	Revisions	Date	Drawn	BK
A	Original	26.04.2022		BK

Locality: FLAGSTONE
Local Authority: LOGAN CITY COUNCIL
Horizontal Meridian: MGA, Zone 56
Vertical Level Datum: AHD D
Scale: 1:250 @ A4
Designed: Peak Urban
Drawn: BK 26/04/2022
Checked: DE 26/04/2022
Plot Date: 04 May, 2022
Computer File Ref: 30109-StSD-DP-(A).dwg

DISCLOSURE PLAN
of Proposed LOT 2253
being part of
Lot 911
on SP321079



veris

BRISBANE WHITSUNDAYS
(07) 3686 4700 (07) 4945 6600

MACKAY CAIRNS
(07) 4957 9700 (07) 4252 9400

veris.com.au
ACN 615 735 727
Veris Australia Pty Ltd

Drawing No Issue
30109-DP- 2253 A

ADDITIONAL NOTES:

The LOT dimensions and area shown hereon are subject to final field survey and also to the requirements of Council and any other authority which may have requirements under any relevant legislation

Final surface contours shown hereon have been supplied by Peak Urban.

Location of retaining walls are as shown on Engineering design drawings. Their as-constructed location may differ from their design location. Retaining wall heights have been supplied by Peak Urban. **The engineering detail shown hereon are preliminary only and are subject to change in final design and statutory approvals**

Compaction of any fill material placed on this site shall be completed to level one inspection and testing services in accordance with AS3798-2007.

Depth of fill values are calculated to the pre-development surface.

Copyright © Veris Australia Pty Ltd
01/03/2023.

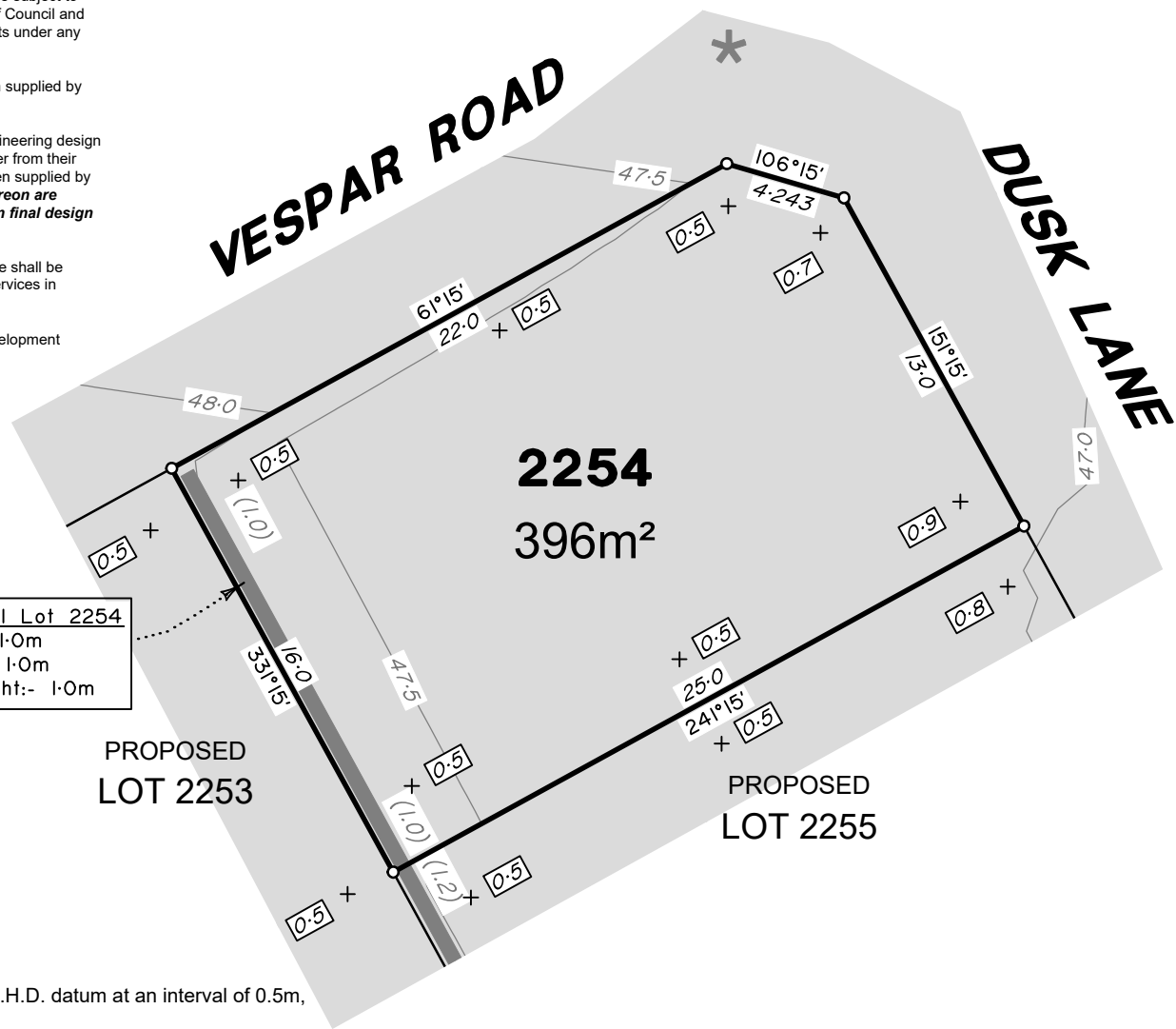

Retaining Wall Lot 2254
Min Height:- 1.0m
Max Height:- 1.0m
Average Height:- 1.0m

LEGEND

Final surface contours based on A.H.D. datum at an interval of 0.5m, shown as: 15.5

Where applicable, areas to be filled are shown as:

Depth of fill, in metres, shown as:- + 0.5

Retaining wall and retaining wall height, shown on the lower side of the wall, have been taken from plans supplied by Peak Urban and shown as: (1.2)

Bin Pad Location shown as:



**FLAGSTONE
PRECINCT 1 STAGE 5D**
For
**PEET FLAGSTONE
CITY PTY LTD**

IMPORTANT NOTES:
(These notes are an integral part of this plan)

This plan has been prepared for PEET FLAGSTONE CITY PTY LTD for the purposes of a Disclosure Plan Under the Land Sales Act 1984 (as amended).

It is not to be used by any other person or corporation or for any other purposes and is subject to the following limitations:

Please refer to the approved Development Application for conditions relating to the LOT and to approved Operational Works drawings for services location and possible easements.

THESE DESIGNS AND DRAWINGS ARE COPYRIGHT AND ARE NOT TO BE USED OR REPRODUCED WITHOUT THE WRITTEN PERMISSION OF VERIS

Data Sources
Cadastral Boundaries
30109-LC-Master(CY) F594 2014.dwg
Engineering Design
FLAGSTONE - STAGE 5 D L M - DISCLOSURE INFO - 12 04 2022 - BASE FILE
Final Surface Contours
FLAGSTONE - STAGE 5 D L M - DISCLOSURE INFO - 22 04 2022 - TIN DESIGN
Depth of Fill
FLAGSTONE - STAGE 5 D L M - DISCLOSURE INFO - 22 04 2022 - Depth Contours in 3D

C	Lease area removed	01.03.2023	BK
B	Add lease area	16.06.2022	BK
A	Original	26.04.2022	BK

Issue	Revisions	Date	Drawn

Locality: FLAGSTONE
Local Authority: LOGAN CITY COUNCIL
Horizontal Meridian: MGA, Zone 56
Vertical Level Datum: AHD D
Scale: 1:250 @ A4
Designed: Peak Urban
Drawn: BK 26/04/2022
Checked: DE 26/04/2022
Plot Date: 03 Mar, 2023
Computer File Ref: 30109-St5D-DP-(C).dwg

**DISCLOSURE PLAN
of Proposed LOT 2254
being part of
Lot 911
on SP331693**



veris

BRISBANE WHITSUNDAYS
(07) 3666 4700 (07) 4945 6600

MACKAY CAIRNS
(07) 4957 9700 (07) 4252 9400

veris.com.au
ACN 615 735 727
Veris Australia Pty Ltd

Drawing No Issue
30109-DP- 2254 C

ADDITIONAL NOTES:

The LOT dimensions and area shown hereon are subject to final field survey and also to the requirements of Council and any other authority which may have requirements under any relevant legislation

Final surface contours shown hereon have been supplied by Peak Urban.

Location of retaining walls are as shown on Engineering design drawings. Their as-constructed location may differ from their design location. Retaining wall heights have been supplied by Peak Urban. **The engineering detail shown hereon are preliminary only and are subject to change in final design and statutory approvals**

Compaction of any fill material placed on this site shall be completed to level one inspection and testing services in accordance with AS3798-2007.

Depth of fill values are calculated to the pre-development surface.

Copyright © Veris Australia Pty Ltd
26/04/2022.



**FLAGSTONE
PRECINCT 1 STAGE 5D**
For
**PEET FLAGSTONE
CITY PTY LTD**

IMPORTANT NOTES:
(These notes are an integral part of this plan)

This plan has been prepared for **PEET FLAGSTONE CITY PTY LTD** for the purposes of **A Disclosure Plan Under the Land Sales Act 1984 (as amended)**.

It is not to be used by any other person or corporation or for any other purposes and is subject to the following limitations:

Please refer to the approved Development Application for conditions relating to the LOT and to approved Operational Works drawings for services location and possible easements.

THESE DESIGNS AND DRAWINGS ARE COPYRIGHT AND ARE NOT TO BE USED OR REPRODUCED WITHOUT THE WRITTEN PERMISSION OF VERIS

Data Sources
Cadastral Boundaries
30109-LC-Master(CX) F594 2014.dwg
Engineering Design
FLAGSTONE - STAGE 5 D L M - DISCLOSURE INFO - 12/04/2022 - BASE FILE
Final Surface Contours
FLAGSTONE - STAGE 5 D L M - DISCLOSURE INFO - 22/04/2022 - TIN DESIGN
Depth of Fill
FLAGSTONE - STAGE 5 D L M - DISCLOSURE INFO - 22/04/2022 - Depth Contours in 3D

Issue	Revisions	Date	Drawn
A	Original	26.04.2022	BK

Locality: FLAGSTONE
Local Authority: LOGAN CITY COUNCIL
Horizontal Meridian: MGA, Zone 56
Vertical Level Datum: AHD D
Scale: 1:250 @ A4
Designed: Peak Urban
Drawn: BK 26/04/2022
Checked: DE 26/04/2022
Plot Date: 04 May, 2022
Computer File Ref: 30109-StSD-DP-(A).dwg

**DISCLOSURE PLAN
of Proposed LOT 2255**
being part of
Lot 911
on SP321079



veris

BRISBANE (07) 3666 4700 WHITSUNDAYS (07) 4945 6600

MACKAY (07) 4957 9700 CAIRNS (07) 4252 9400

veris.com.au
ACN 615 735 727
Veris Australia Pty Ltd

Drawing No: 30109-DP- 2255 Issue: A

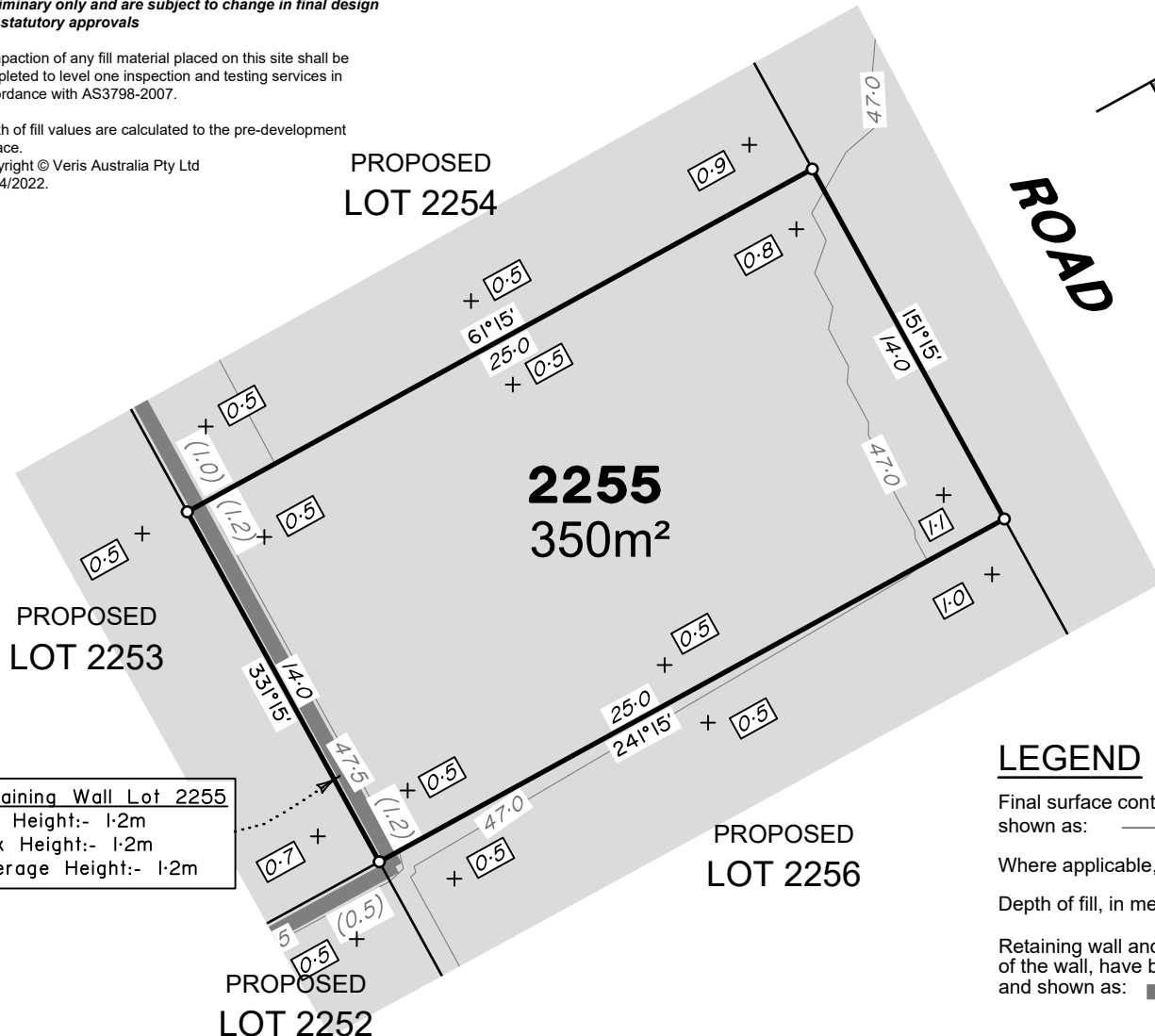

Retaining Wall Lot 2255
Min Height:- 1.2m
Max Height:- 1.2m
Average Height:- 1.2m

LEGEND

Final surface contours based on A.H.D. datum at an interval of 0.5m, shown as: — 15.5 —

Where applicable, areas to be filled are shown as:

Depth of fill, in metres, shown as:- +0.5

Retaining wall and retaining wall height, shown on the lower side of the wall, have been taken from plans supplied by Peak Urban and shown as:

Bin Pad Location shown as: *



ADDITIONAL NOTES:

The LOT dimensions and area shown hereon are subject to final field survey and also to the requirements of Council and any other authority which may have requirements under any relevant legislation

Final surface contours shown hereon have been supplied by Peak Urban.

Location of retaining walls are as shown on Engineering design drawings. Their as-constructed location may differ from their design location. Retaining wall heights have been supplied by Peak Urban. **The engineering detail shown hereon are preliminary only and are subject to change in final design and statutory approvals**

Compaction of any fill material placed on this site shall be completed to level one inspection and testing services in accordance with AS3798-2007.

Depth of fill values are calculated to the pre-development surface.

Copyright © Veris Australia Pty Ltd
26/04/2022.

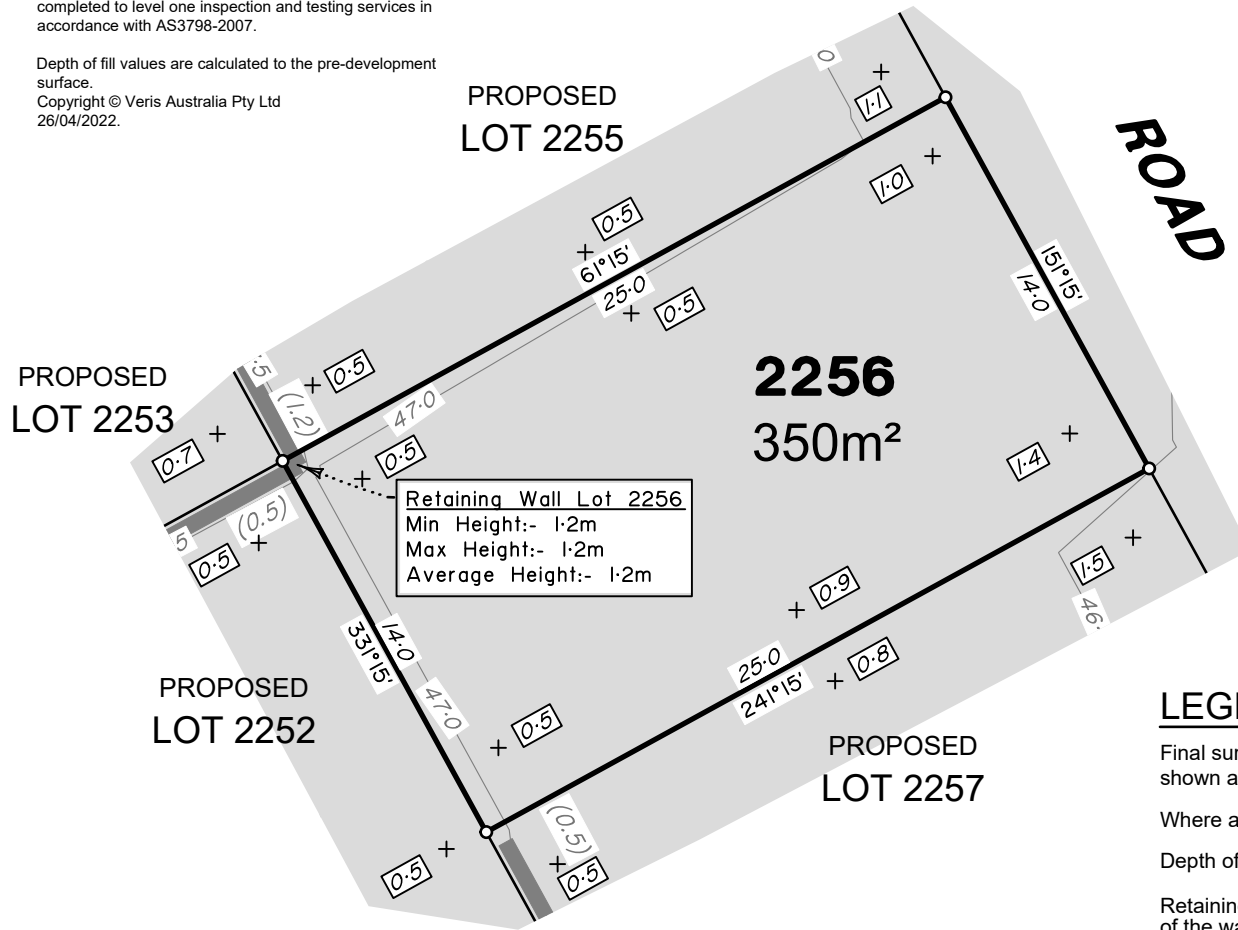

Retaining Wall Lot 2256
Min Height:- 1.2m
Max Height:- 1.2m
Average Height:- 1.2m

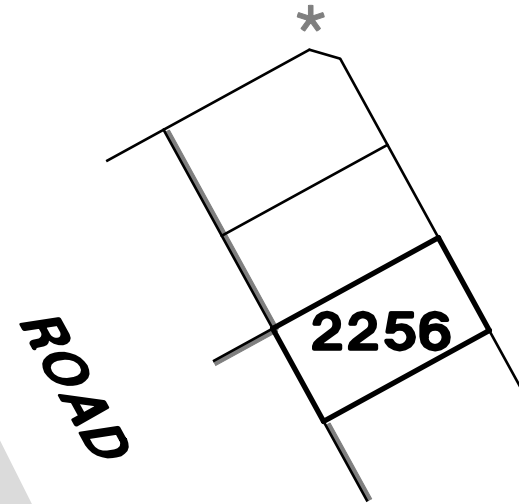

LEGEND

Final surface contours based on A.H.D. datum at an interval of 0.5m, shown as: 15.5

Where applicable, areas to be filled are shown as:

Depth of fill, in metres, shown as:- 0.5

Retaining wall and retaining wall height, shown on the lower side of the wall, have been taken from plans supplied by Peak Urban and shown as: (1.2)

Bin Pad Location shown as:



**FLAGSTONE
PRECINCT 1 STAGE 5D**
For
**PEET FLAGSTONE
CITY PTY LTD**

IMPORTANT NOTES:
(These notes are an integral part of this plan)

This plan has been prepared for PEET FLAGSTONE CITY PTY LTD for the purposes of A Disclosure Plan Under the Land Sales Act 1984 (as amended).

It is not to be used by any other person or corporation or for any other purposes and is subject to the following limitations:

Please refer to the approved Development Application for conditions relating to the LOT and to approved Operational Works drawings for services location and possible easements.

THESE DESIGNS AND DRAWINGS ARE COPYRIGHT AND ARE NOT TO BE USED OR REPRODUCED WITHOUT THE WRITTEN PERMISSION OF VERIS

- Data Sources**
Cadastral Boundaries
30109-LC-Master(CX) F594 2014.dwg
Engineering Design
FLAGSTONE - STAGE 5 D L M - DISCLOSURE INFO - 12/04/2022 - BASE FILE
Final Surface Contours
FLAGSTONE - STAGE 5 D L M - DISCLOSURE INFO - 22/04/2022 - TIN DESIGN
Depth of Fill
FLAGSTONE - STAGE 5 D L M - DISCLOSURE INFO - 22/04/2022 - Depth Contours in 3D

Issue	Revisions	Date	Drawn
A	Original	26.04.2022	BK

Locality: FLAGSTONE
Local Authority: LOGAN CITY COUNCIL
Horizontal Meridian: MGA, Zone 56
Vertical Level Datum: AHD D
Scale: 1:250 @ A4
Designed: Peak Urban
Drawn: BK 26/04/2022
Checked: DE 26/04/2022
Plot Date: 04 May, 2022
Computer File Ref: 30109-StSD-DP-(A).dwg

**DISCLOSURE PLAN
of Proposed LOT 2256
being part of
Lot 911
on SP321079**



BRISBANE (07) 3686 4700 WHITSUNDAYS (07) 4945 6600

MACKAY (07) 4957 9700 CAIRNS (07) 4252 9400

veris.com.au
ACN 615 735 727
Veris Australia Pty Ltd

Drawing No 30109-DP- 2256 Issue A

ADDITIONAL NOTES:

The LOT dimensions and area shown hereon are subject to final field survey and also to the requirements of Council and any other authority which may have requirements under any relevant legislation

Final surface contours shown hereon have been supplied by Peak Urban.

Location of retaining walls are as shown on Engineering design drawings. Their as-constructed location may differ from their design location. Retaining wall heights have been supplied by Peak Urban. **The engineering detail shown hereon are preliminary only and are subject to change in final design and statutory approvals**

Compaction of any fill material placed on this site shall be completed to level one inspection and testing services in accordance with AS3798-2007.

Depth of fill values are calculated to the pre-development surface.

Copyright © Veris Australia Pty Ltd
26/04/2022.

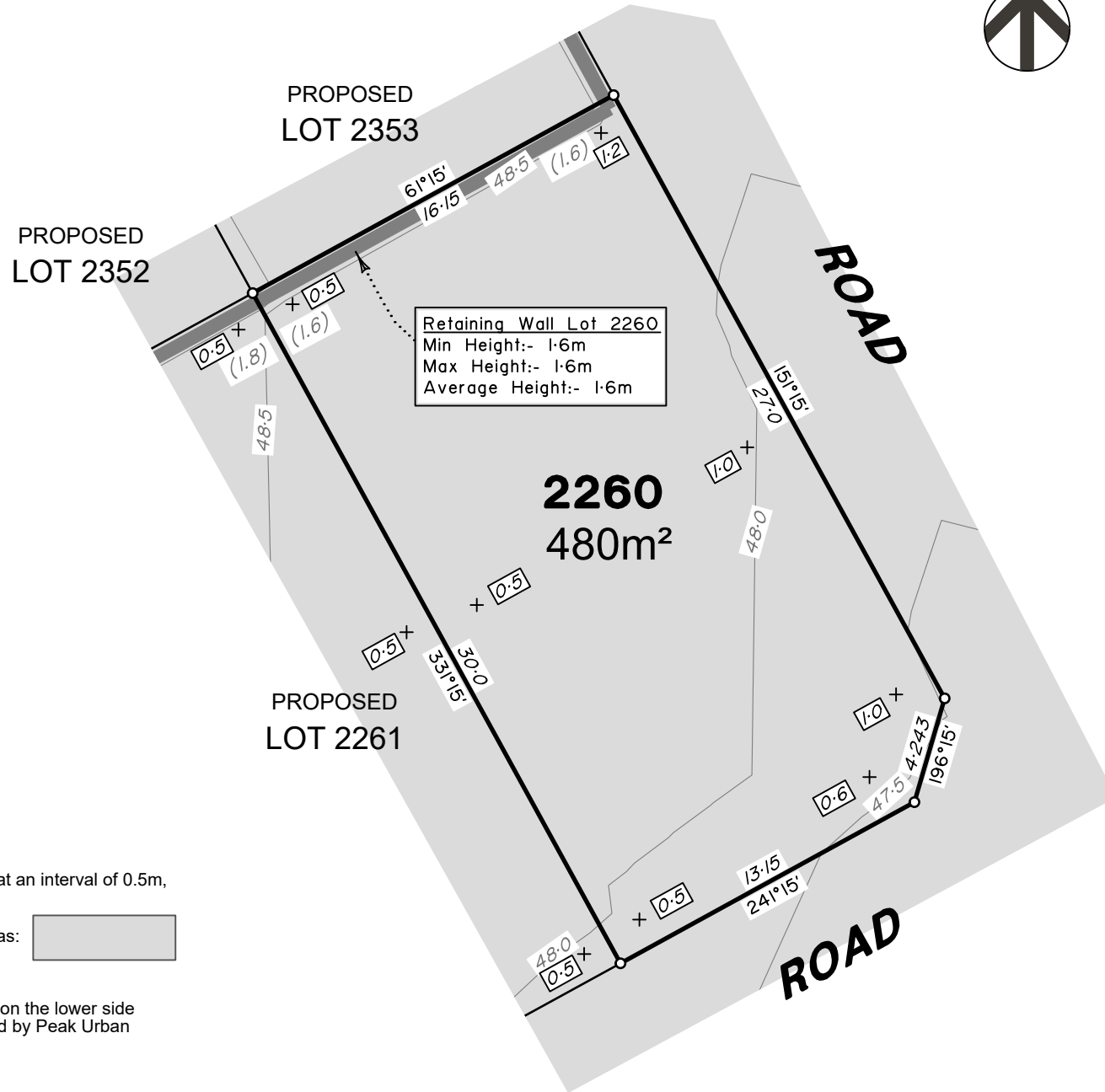

Retaining Wall Lot 2260
Min Height:- 1.6m
Max Height:- 1.6m
Average Height:- 1.6m

2260
480m²

LEGEND

Final surface contours based on A.H.D. datum at an interval of 0.5m, shown as: 15.5

Where applicable, areas to be filled are shown as:

Depth of fill, in metres, shown as:- + 0.5

Retaining wall and retaining wall height, shown on the lower side of the wall, have been taken from plans supplied by Peak Urban and shown as: (1.2)

Bin Pad Location shown as:



**FLAGSTONE
PRECINCT 1 STAGE 5D**
For
**PEET FLAGSTONE
CITY PTY LTD**

IMPORTANT NOTES:
(These notes are an integral part of this plan)

This plan has been prepared for **PEET FLAGSTONE CITY PTY LTD** for the purposes of **A Disclosure Plan Under the Land Sales Act 1984 (as amended)**.

It is not to be used by any other person or corporation or for any other purposes and is subject to the following limitations:

Please refer to the approved Development Application for conditions relating to the LOT and to approved Operational Works drawings for services location and possible easements.

THESE DESIGNS AND DRAWINGS ARE COPYRIGHT AND ARE NOT TO BE USED OR REPRODUCED WITHOUT THE WRITTEN PERMISSION OF VERIS

Data Sources
Cadastral Boundaries
30109-LC-Master(CX) FS94 2014.dwg
Engineering Design
FLAGSTONE - STAGE 5 D L M - DISCLOSURE INFO - 12/04/2022 - BASE FILE
Final Surface Contours
FLAGSTONE - STAGE 5 D L M - DISCLOSURE INFO - 22/04/2022 - TIN DESIGN
Depth of Fill
FLAGSTONE - STAGE 5 D L M - DISCLOSURE INFO - 22/04/2022 - Depth Contours in 3D

Issue	Revisions	Date	Drawn
A	Original	26.04.2022	BK

Locality: FLAGSTONE
Local Authority: LOGAN CITY COUNCIL
Horizontal Meridian: MGA, Zone 56
Vertical Level Datum: AHD D
Scale: 1:250 @ A4
Designed: Peak Urban
Drawn: BK 26/04/2022
Checked: DE 26/04/2022
Plot Date: 04 May, 2022
Computer File Ref: 30109-StSD-DP-(A).dwg

DISCLOSURE PLAN
of Proposed LOT 2260
being part of
Lot 911
on SP321079



veris

BRISBANE WHITSUNDAYS
(07) 3666 4700 (07) 4945 6600

MACKAY CAIRNS
(07) 4957 9700 (07) 4252 9400

veris.com.au
ACN 615 735 727
Veris Australia Pty Ltd

Drawing No Issue
30109-DP- 2260 A

ADDITIONAL NOTES:

The LOT dimensions and area shown hereon are subject to final field survey and also to the requirements of Council and any other authority which may have requirements under any relevant legislation

Final surface contours shown hereon have been supplied by Peak Urban.

Location of retaining walls are as shown on Engineering design drawings. Their as-constructed location may differ from their design location. Retaining wall heights have been supplied by Peak Urban. **The engineering detail shown hereon are preliminary only and are subject to change in final design and statutory approvals**

Compaction of any fill material placed on this site shall be completed to level one inspection and testing services in accordance with AS3798-2007.

Depth of fill values are calculated to the pre-development surface.

Copyright © Veris Australia Pty Ltd
26/04/2022.

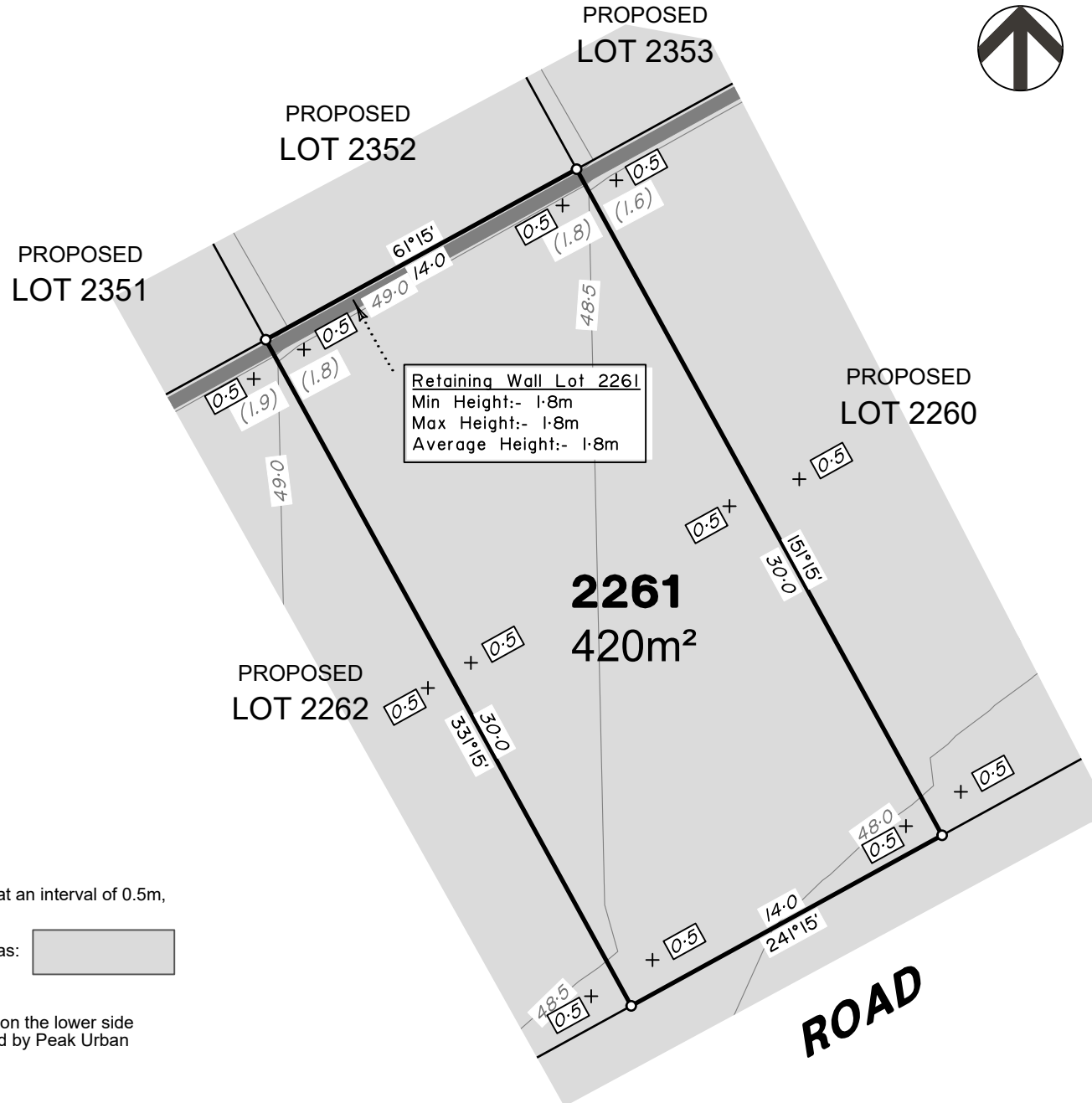

Retaining Wall Lot 2261
Min Height:- 1.8m
Max Height:- 1.8m
Average Height:- 1.8m

LEGEND

Final surface contours based on A.H.D. datum at an interval of 0.5m, shown as: 15.5

Where applicable, areas to be filled are shown as:

Depth of fill, in metres, shown as:- +0.5

Retaining wall and retaining wall height, shown on the lower side of the wall, have been taken from plans supplied by Peak Urban and shown as:

Bin Pad Location shown as:



**FLAGSTONE
PRECINCT 1 STAGE 5D**
For
**PEET FLAGSTONE
CITY PTY LTD**

IMPORTANT NOTES:
(These notes are an integral part of this plan)

This plan has been prepared for PEET FLAGSTONE CITY PTY LTD for the purposes of **A Disclosure Plan Under the Land Sales Act 1984 (as amended)**.

It is not to be used by any other person or corporation or for any other purposes and is subject to the following limitations:

Please refer to the approved Development Application for conditions relating to the LOT and to approved Operational Works drawings for services location and possible easements.

THESE DESIGNS AND DRAWINGS ARE COPYRIGHT AND ARE NOT TO BE USED OR REPRODUCED WITHOUT THE WRITTEN PERMISSION OF VERIS

Data Sources
Cadastral Boundaries
30109-LC-Master(CX) F594 2014.dwg
Engineering Design
FLAGSTONE - STAGE 5 D L M - DISCLOSURE INFO - 12 04 2022 - BASE FILE
Final Surface Contours
FLAGSTONE - STAGE 5 D L M - DISCLOSURE INFO - 22 04 2022 - TIN DESIGN
Depth of Fill
FLAGSTONE - STAGE 5 D L M - DISCLOSURE INFO - 22 04 2022 - Depth Contours in 3D

A	Original	26.04.2022	BK
Issue	Revisions	Date	Drawn

Locality: FLAGSTONE
Local Authority: LOGAN CITY COUNCIL
Horizontal Meridian: MGA, Zone 56
Vertical Level Datum: AHD D
Scale: 1:250 @ A4
Designed: Peak Urban
Drawn: BK 26/04/2022
Checked: DE 26/04/2022
Plot Date: 04 May, 2022
Computer File Ref: 30109-STSD-DP-(A).dwg

**DISCLOSURE PLAN
of Proposed LOT 2261
being part of
Lot 911
on SP321079**



BRISBANE WHITSUNDAYS
(07) 3686 4700 (07) 4945 6600

MACKAY CAIRNS
(07) 4957 9700 (07) 4252 9400

veris.com.au
ACN 615 735 727
Veris Australia Pty Ltd

Drawing No Issue
30109-DP- 2261 A

ADDITIONAL NOTES:

The LOT dimensions and area shown hereon are subject to final field survey and also to the requirements of Council and any other authority which may have requirements under any relevant legislation

Final surface contours shown hereon have been supplied by Peak Urban.

Location of retaining walls are as shown on Engineering design drawings. Their as-constructed location may differ from their design location. Retaining wall heights have been supplied by Peak Urban. **The engineering detail shown hereon are preliminary only and are subject to change in final design and statutory approvals**

Compaction of any fill material placed on this site shall be completed to level one inspection and testing services in accordance with AS3798-2007.

Depth of fill values are calculated to the pre-development surface.

Copyright © Veris Australia Pty Ltd
26/04/2022.

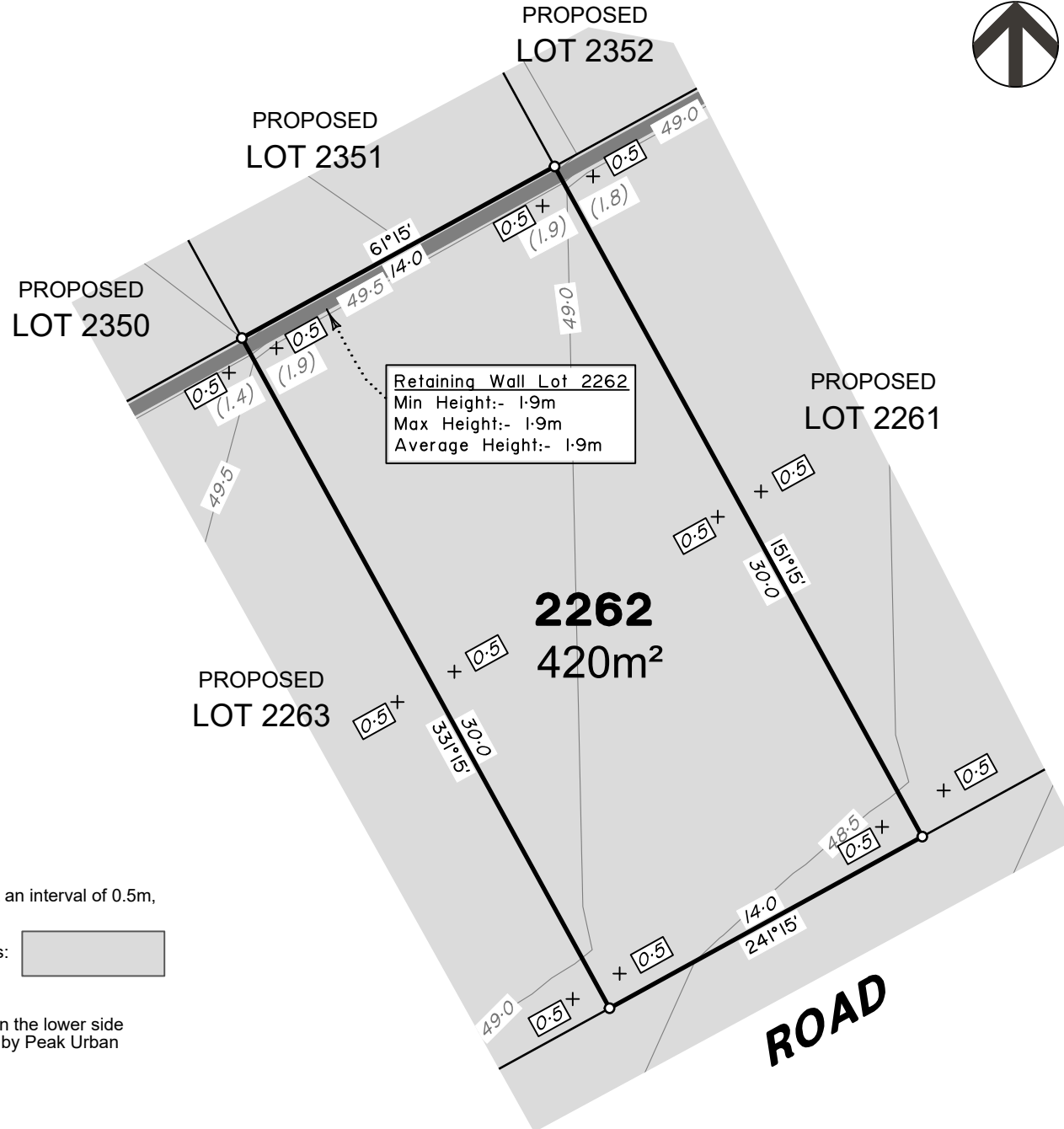

Retaining Wall Lot 2262
Min Height:- 1.9m
Max Height:- 1.9m
Average Height:- 1.9m

LEGEND

Final surface contours based on A.H.D. datum at an interval of 0.5m, shown as: 15.5

Where applicable, areas to be filled are shown as:

Depth of fill, in metres, shown as:- +0.5

Retaining wall and retaining wall height, shown on the lower side of the wall, have been taken from plans supplied by Peak Urban and shown as: (1.2)

Bin Pad Location shown as:



**FLAGSTONE
PRECINCT 1 STAGE 5D**
For
**PEET FLAGSTONE
CITY PTY LTD**

IMPORTANT NOTES:
(These notes are an integral part of this plan)

This plan has been prepared for PEET FLAGSTONE CITY PTY LTD for the purposes of **A Disclosure Plan Under the Land Sales Act 1984 (as amended)**.

It is not to be used by any other person or corporation or for any other purposes and is subject to the following limitations:

Please refer to the approved Development Application for conditions relating to the LOT and to approved Operational Works drawings for services location and possible easements.

THESE DESIGNS AND DRAWINGS ARE COPYRIGHT AND ARE NOT TO BE USED OR REPRODUCED WITHOUT THE WRITTEN PERMISSION OF VERIS

Data Sources
Cadastral Boundaries
30109-LC-Master(CX) FS94 2014.dwg
Engineering Design
FLAGSTONE - STAGE 5 D L M - DISCLOSURE INFO - 12 04 2022 - BASE FILE
Final Surface Contours
FLAGSTONE - STAGE 5 D L M - DISCLOSURE INFO - 22 04 2022 - TIN DESIGN
Depth of Fill
FLAGSTONE - STAGE 5 D L M - DISCLOSURE INFO - 22 04 2022 - Depth Contours in 3D

Issue	Original	Revisions	Date	Drawn
A	Original		26.04.2022	BK

Locality: FLAGSTONE
Local Authority: LOGAN CITY COUNCIL
Horizontal Meridian: MGA, Zone 56
Vertical Level Datum: AHD D
Scale: 1:250 @ A4
Designed: Peak Urban
Drawn: BK 26/04/2022
Checked: DE 26/04/2022
Plot Date: 04 May, 2022
Computer File Ref: 30109-STSD-DP-(A).dwg

**DISCLOSURE PLAN
of Proposed LOT 2262**
being part of
Lot 911
on SP321079



BRISBANE WHITSUNDAYS
(07) 3686 4700 (07) 4945 6600

MACKAY CAIRNS
(07) 4957 9700 (07) 4252 9400

veris.com.au
ACN 615 735 727
Veris Australia Pty Ltd

Drawing No Issue
30109-DP- 2262 A

ADDITIONAL NOTES:

The LOT dimensions and area shown hereon are subject to final field survey and also to the requirements of Council and any other authority which may have requirements under any relevant legislation

Final surface contours shown hereon have been supplied by Peak Urban.

Location of retaining walls are as shown on Engineering design drawings. Their as-constructed location may differ from their design location. Retaining wall heights have been supplied by Peak Urban. **The engineering detail shown hereon are preliminary only and are subject to change in final design and statutory approvals**

Compaction of any fill material placed on this site shall be completed to level one inspection and testing services in accordance with AS3798-2007.

Depth of fill values are calculated to the pre-development surface.

Copyright © Veris Australia Pty Ltd
26/04/2022.

PROPOSED
LOT 2349

PROPOSED
LOT 2348

PROPOSED
LOT 2347

PROPOSED
LOT 2263

PROPOSED
LOT 2265

Retaining Wall Lot 2264
Min Height:- 2.5m
Max Height:- 2.5m
Average Height:- 2.5m

2264
420m²

ROAD



FLAGSTONE
PRECINCT 1 STAGE 5D
For
PEET FLAGSTONE
CITY PTY LTD

IMPORTANT NOTES:
(These notes are an integral part of this plan)

This plan has been prepared for PEET FLAGSTONE CITY PTY LTD for the purposes of A Disclosure Plan Under the Land Sales Act 1984 (as amended).

It is not to be used by any other person or corporation or for any other purposes and is subject to the following limitations:

Please refer to the approved Development Application for conditions relating to the LOT and to approved Operational Works drawings for services location and possible easements.

THESE DESIGNS AND DRAWINGS ARE COPYRIGHT AND ARE NOT TO BE USED OR REPRODUCED WITHOUT THE WRITTEN PERMISSION OF VERIS

Data Sources
Cadastral Boundaries
30109-LC-Master(CX) F594 2014.dwg
Engineering Design
FLAGSTONE - STAGE 5 D L M - DISCLOSURE INFO - 12/04/2022 - BASE FILE
Final Surface Contours
FLAGSTONE - STAGE 5 D L M - DISCLOSURE INFO - 22/04/2022 - TIN DESIGN
Depth of Fill
FLAGSTONE - STAGE 5 D L M - DISCLOSURE INFO - 22/04/2022 - Depth Contours in 3D

Issue	Revisions	Date	Drawn
A	Original	26.04.2022	BK

Locality: FLAGSTONE
Local Authority: LOGAN CITY COUNCIL
Horizontal Meridian: MGA, Zone 56
Vertical Level Datum: AHD D
Scale: 1:250 @ A4
Designed: Peak Urban
Drawn: BK 26/04/2022
Checked: DE 26/04/2022
Plot Date: 04 May, 2022
Computer File Ref: 30109-StSD-DP-(A).dwg

DISCLOSURE PLAN
of Proposed LOT 2264
being part of
Lot 911
on SP321079



veris

BRISBANE WHITSUNDAYS
(07) 3686 4700 (07) 4945 6600

MACKAY CAIRNS
(07) 4957 9700 (07) 4252 9400

veris.com.au
ACN 615 735 727
Veris Australia Pty Ltd

Drawing No Issue
30109-DP- 2264 A

LEGEND

Final surface contours based on A.H.D. datum at an interval of 0.5m, shown as: 15.5

Where applicable, areas to be filled are shown as:

Depth of fill, in metres, shown as:- +0.5

Retaining wall and retaining wall height, shown on the lower side of the wall, have been taken from plans supplied by Peak Urban and shown as:

Bin Pad Location shown as:



ADDITIONAL NOTES:

The LOT dimensions and area shown hereon are subject to final field survey and also to the requirements of Council and any other authority which may have requirements under any relevant legislation

Final surface contours shown hereon have been supplied by Peak Urban.

Location of retaining walls are as shown on Engineering design drawings. Their as-constructed location may differ from their design location. Retaining wall heights have been supplied by Peak Urban. **The engineering detail shown hereon are preliminary only and are subject to change in final design and statutory approvals**

Compaction of any fill material placed on this site shall be completed to level one inspection and testing services in accordance with AS3798-2007.

Depth of fill values are calculated to the pre-development surface.

Copyright © Veris Australia Pty Ltd
26/04/2022.

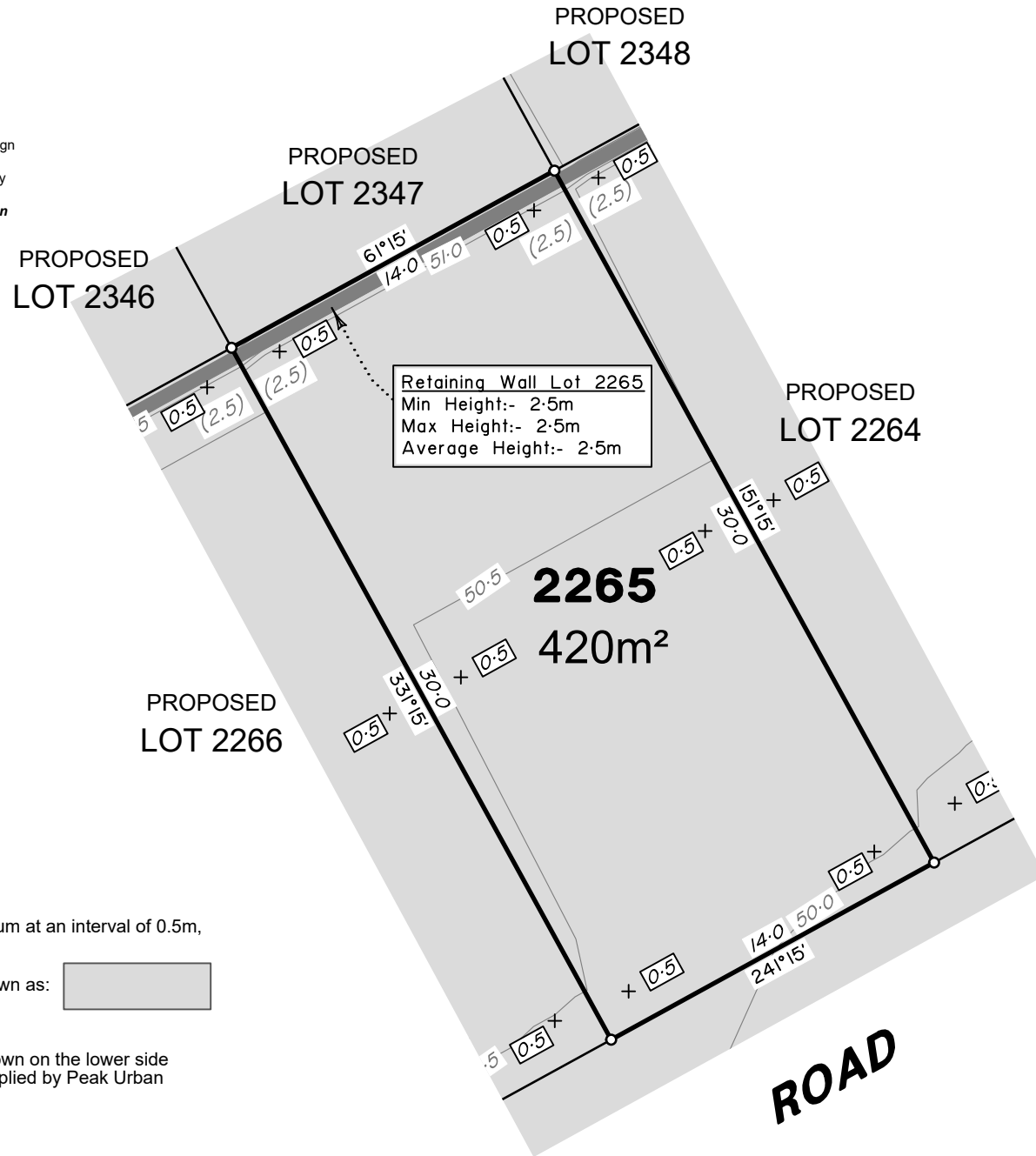

Retaining Wall Lot 2265
Min Height:- 2.5m
Max Height:- 2.5m
Average Height:- 2.5m

2265
420m²

LEGEND

Final surface contours based on A.H.D. datum at an interval of 0.5m, shown as: 15.5

Where applicable, areas to be filled are shown as:

Depth of fill, in metres, shown as:- 0.5

Retaining wall and retaining wall height, shown on the lower side of the wall, have been taken from plans supplied by Peak Urban and shown as: (1.2)

Bin Pad Location shown as:

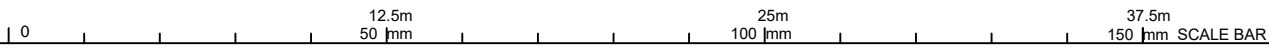

**FLAGSTONE
PRECINCT 1 STAGE 5D**
For
**PEET FLAGSTONE
CITY PTY LTD**

IMPORTANT NOTES:
(These notes are an integral part of this plan)

This plan has been prepared for PEET FLAGSTONE CITY PTY LTD for the purposes of **A Disclosure Plan Under the Land Sales Act 1984 (as amended)**.

It is not to be used by any other person or corporation or for any other purposes and is subject to the following limitations:

Please refer to the approved Development Application for conditions relating to the LOT and to approved Operational Works drawings for services location and possible easements.

THESE DESIGNS AND DRAWINGS ARE COPYRIGHT AND ARE NOT TO BE USED OR REPRODUCED WITHOUT THE WRITTEN PERMISSION OF VERIS

- Data Sources**
Cadastral Boundaries
30109-LC-Master(CX) FS94 2014.dwg
Engineering Design
FLAGSTONE - STAGE 5 D L M - DISCLOSURE INFO - 12/04/2022 - BASE FILE
Final Surface Contours
FLAGSTONE - STAGE 5 D L M - DISCLOSURE INFO - 22/04/2022 - TIN DESIGN
Depth of Fill
FLAGSTONE - STAGE 5 D L M - DISCLOSURE INFO - 22/04/2022 - Depth Contours in 3D

Issue	Revisions	Date	Drawn
A	Original	26.04.2022	BK

Locality: FLAGSTONE
Local Authority: LOGAN CITY COUNCIL
Horizontal Meridian: MGA, Zone 56
Vertical Level Datum: AHD D
Scale: 1:250 @ A4
Designed: Peak Urban
Drawn: BK 26/04/2022
Checked: DE 26/04/2022
Plot Date: 04 May, 2022
Computer File Ref: 30109-STSD-DP-(A).dwg

DISCLOSURE PLAN
of Proposed LOT 2265
being part of
Lot 911
on SP321079



veris

BRISBANE (07) 3686 4700 WHITSUNDAYS (07) 4945 6600
MACKAY (07) 4957 9700 CAIRNS (07) 4252 9400

veris.com.au
ACN 615 735 727
Veris Australia Pty Ltd

Drawing No 30109-DP- 2265 Issue A

ADDITIONAL NOTES:

The LOT dimensions and area shown hereon are subject to final field survey and also to the requirements of Council and any other authority which may have requirements under any relevant legislation

Final surface contours shown hereon have been supplied by Peak Urban.

Location of retaining walls are as shown on Engineering design drawings. Their as-constructed location may differ from their design location. Retaining wall heights have been supplied by Peak Urban. **The engineering detail shown hereon are preliminary only and are subject to change in final design and statutory approvals**

Compaction of any fill material placed on this site shall be completed to level one inspection and testing services in accordance with AS3798-2007.

Depth of fill values are calculated to the pre-development surface.

Copyright © Veris Australia Pty Ltd
26/04/2022.

LEGEND

Final surface contours based on A.H.D. datum at an interval of 0.5m, shown as: 15.5

Where applicable, areas to be filled are shown as:

Depth of fill, in metres, shown as:- +

Retaining wall and retaining wall height, shown on the lower side of the wall, have been taken from plans supplied by Peak Urban and shown as:

Bin Pad Location shown as:

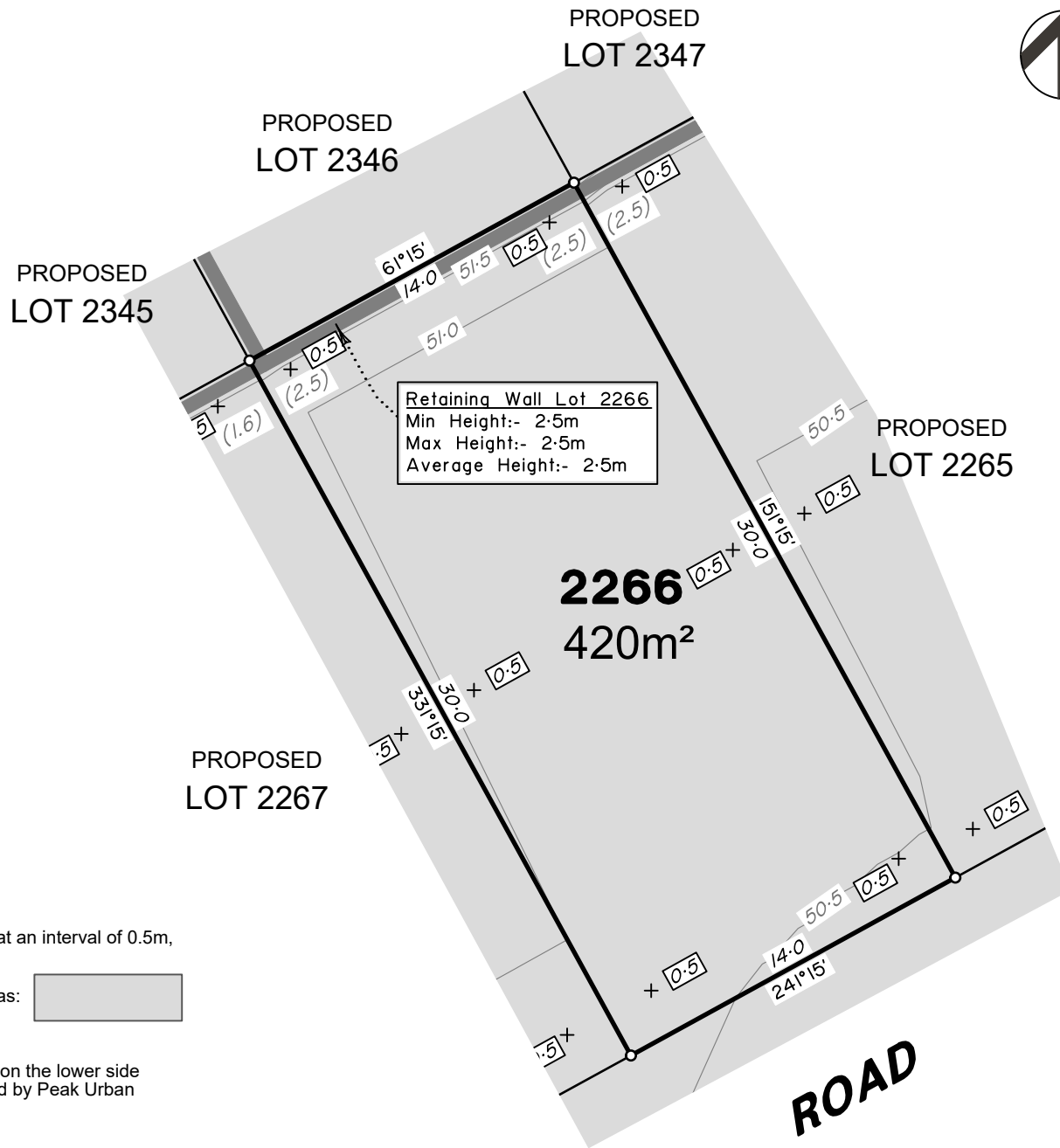

**FLAGSTONE
PRECINCT 1 STAGE 5D**
For
**PEET FLAGSTONE
CITY PTY LTD**

IMPORTANT NOTES:
(These notes are an integral part of this plan)

This plan has been prepared for **PEET FLAGSTONE CITY PTY LTD** for the purposes of **A Disclosure Plan Under the Land Sales Act 1984 (as amended)**.

It is not to be used by any other person or corporation or for any other purposes and is subject to the following limitations:

Please refer to the approved Development Application for conditions relating to the LOT and to approved Operational Works drawings for services location and possible easements.

THESE DESIGNS AND DRAWINGS ARE COPYRIGHT AND ARE NOT TO BE USED OR REPRODUCED WITHOUT THE WRITTEN PERMISSION OF VERIS

Data Sources
Cadastral Boundaries
30109-LC-Master(CX) F594 2014.dwg
Engineering Design
FLAGSTONE - STAGE 5 D L M - DISCLOSURE INFO - 12 04 2022 - BASE FILE
Final Surface Contours
FLAGSTONE - STAGE 5 D L M - DISCLOSURE INFO - 22 04 2022 - TIN DESIGN
Depth of Fill
FLAGSTONE - STAGE 5 D L M - DISCLOSURE INFO - 22 04 2022 - Depth Contours in 3D

A	Original	26.04.2022	BK
Issue	Revisions	Date	Drawn

Locality: FLAGSTONE
Local Authority: LOGAN CITY COUNCIL
Horizontal Meridian: MGA, Zone 56
Vertical Level Datum: AHD D
Scale: 1:250 @ A4
Designed: Peak Urban
Drawn: BK 26/04/2022
Checked: DE 26/04/2022
Plot Date: 04 May, 2022
Computer File Ref: 30109-StSD-DP-(A).dwg

DISCLOSURE PLAN
of Proposed LOT 2266
being part of
Lot 911
on SP321079



BRISBANE WHITSUNDAYS
(07) 3686 4700 (07) 4945 6600
MACKAY CAIRNS
(07) 4957 9700 (07) 4252 9400
veris.com.au
ACN 615 735 727
Veris Australia Pty Ltd

Drawing No: 30109-DP- 2266
Issue: A

ADDITIONAL NOTES:

The LOT dimensions and area shown hereon are subject to final field survey and also to the requirements of Council and any other authority which may have requirements under any relevant legislation

Final surface contours shown hereon have been supplied by Peak Urban.

Location of retaining walls are as shown on Engineering design drawings. Their as-constructed location may differ from their design location. Retaining wall heights have been supplied by Peak Urban. **The engineering detail shown hereon are preliminary only and are subject to change in final design and statutory approvals**

Compaction of any fill material placed on this site shall be completed to level one inspection and testing services in accordance with AS3798-2007.

Depth of fill values are calculated to the pre-development surface.

Copyright © Veris Australia Pty Ltd
26/04/2022.

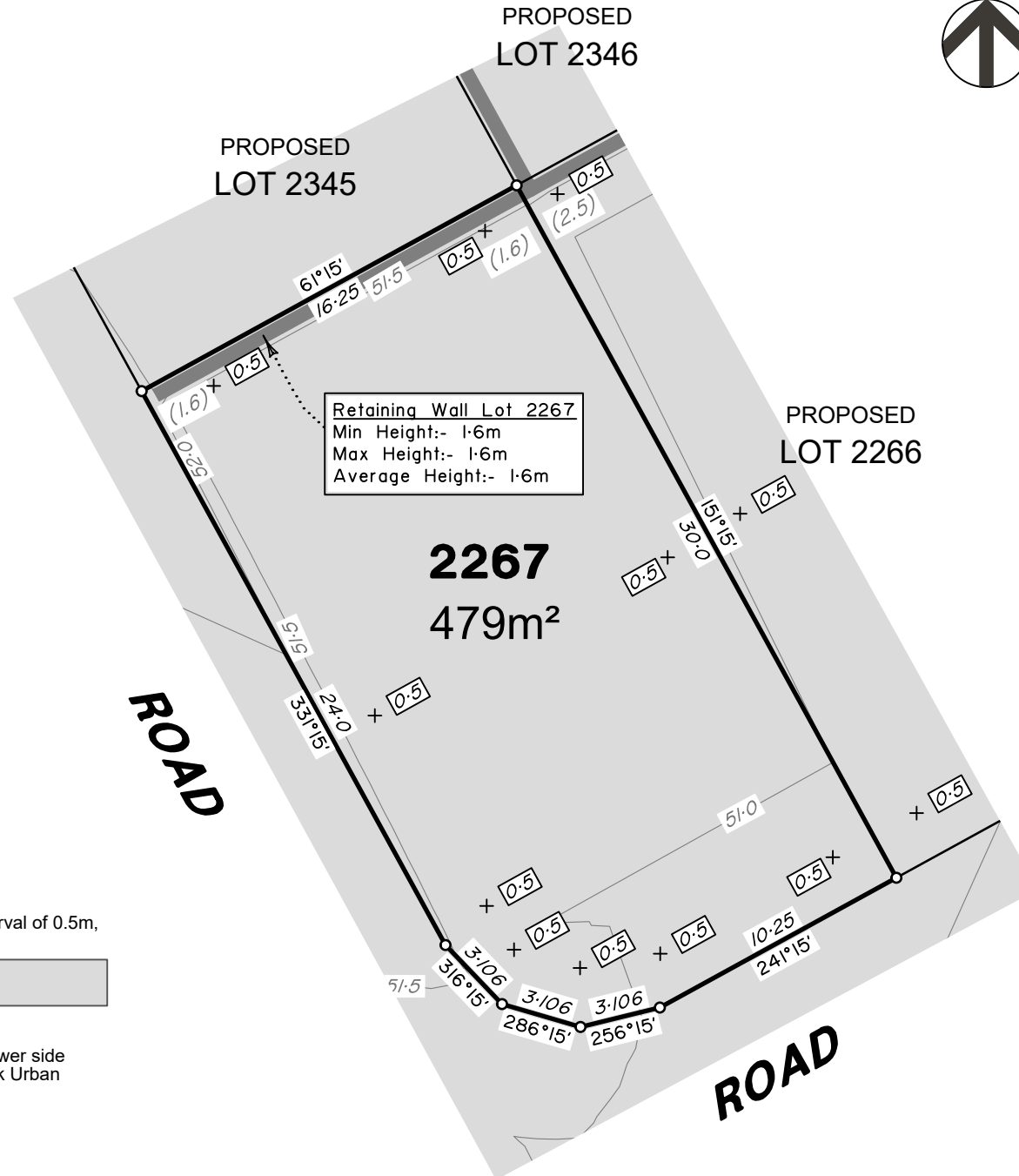

LEGEND

Final surface contours based on A.H.D. datum at an interval of 0.5m, shown as: 15.5

Where applicable, areas to be filled are shown as: [shaded area]

Depth of fill, in metres, shown as:- +0.5

Retaining wall and retaining wall height, shown on the lower side of the wall, have been taken from plans supplied by Peak Urban and shown as: (1.2)

Bin Pad Location shown as: *



**FLAGSTONE
PRECINCT 1 STAGE 5D**
For
**PEET FLAGSTONE
CITY PTY LTD**

IMPORTANT NOTES:
(These notes are an integral part of this plan)

This plan has been prepared for PEET FLAGSTONE CITY PTY LTD for the purposes of A Disclosure Plan Under the Land Sales Act 1984 (as amended).

It is not to be used by any other person or corporation or for any other purposes and is subject to the following limitations:

Please refer to the approved Development Application for conditions relating to the LOT and to approved Operational Works drawings for services location and possible easements.

THESE DESIGNS AND DRAWINGS ARE COPYRIGHT AND ARE NOT TO BE USED OR REPRODUCED WITHOUT THE WRITTEN PERMISSION OF VERIS

Data Sources
Cadastral Boundaries
30109-LC-Master(CX) F594 2014.dwg
Engineering Design
FLAGSTONE - STAGE 5 D L M - DISCLOSURE INFO - 12/04/2022 - BASE FILE
Final Surface Contours
FLAGSTONE - STAGE 5 D L M - DISCLOSURE INFO - 22/04/2022 - TIN DESIGN
Depth of Fill
FLAGSTONE - STAGE 5 D L M - DISCLOSURE INFO - 22/04/2022 - Depth Contours in 3D

Issue	Revisions	Date	Drawn
A	Original	26.04.2022	BK

Locality: FLAGSTONE
Local Authority: LOGAN CITY COUNCIL
Horizontal Meridian: MGA, Zone 56
Vertical Level Datum: AHD D
Scale: 1:250 @ A4
Designed: Peak Urban
Drawn: BK 26/04/2022
Checked: DE 26/04/2022
Plot Date: 04 May, 2022
Computer File Ref: 30109-SISD-DP-(A).dwg

DISCLOSURE PLAN
of Proposed LOT 2267
being part of
Lot 911
on SP321079



veris

BRISBANE WHITSUNDAYS
(07) 3686 4700 (07) 4945 6600

MACKAY CAIRNS
(07) 4957 9700 (07) 4252 9400

veris.com.au
ACN 615 735 727
Veris Australia Pty Ltd

Drawing No Issue
30109-DP- 2267 A

ADDITIONAL NOTES:

The LOT dimensions and area shown hereon are subject to final field survey and also to the requirements of Council and any other authority which may have requirements under any relevant legislation

Final surface contours shown hereon have been supplied by Peak Urban.

Location of retaining walls are as shown on Engineering design drawings. Their as-constructed location may differ from their design location. Retaining wall heights have been supplied by Peak Urban. **The engineering detail shown hereon are preliminary only and are subject to change in final design and statutory approvals**

Compaction of any fill material placed on this site shall be completed to level one inspection and testing services in accordance with AS3798-2007.

Depth of fill values are calculated to the pre-development surface.

Copyright © Veris Australia Pty Ltd
26/04/2022.

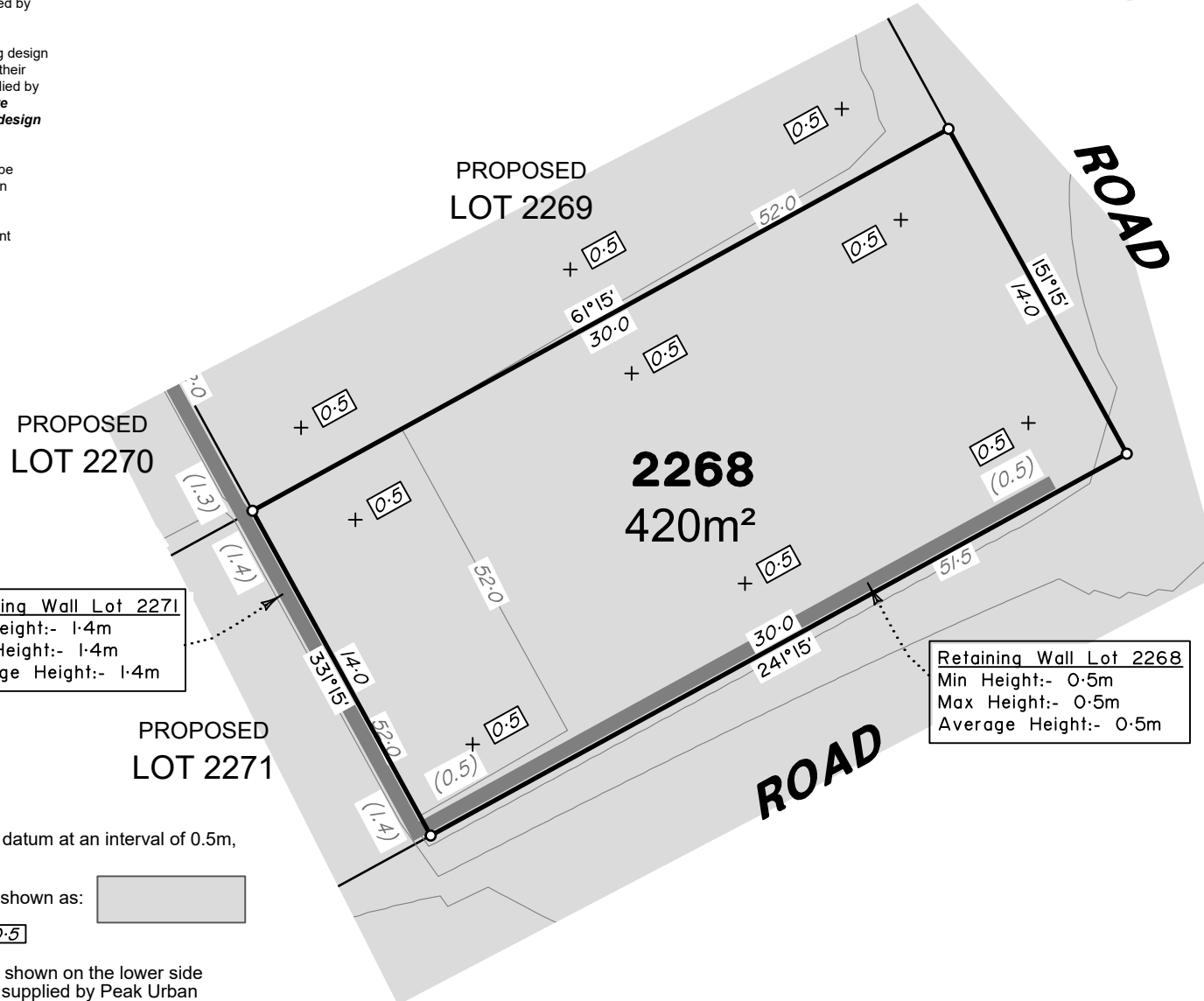

Retaining Wall Lot 2271
Min Height:- 1.4m
Max Height:- 1.4m
Average Height:- 1.4m

Retaining Wall Lot 2268
Min Height:- 0.5m
Max Height:- 0.5m
Average Height:- 0.5m

LEGEND

Final surface contours based on A.H.D. datum at an interval of 0.5m, shown as: 15.5

Where applicable, areas to be filled are shown as:

Depth of fill, in metres, shown as:- 0.5

Retaining wall and retaining wall height, shown on the lower side of the wall, have been taken from plans supplied by Peak Urban and shown as:

Bin Pad Location shown as:



**FLAGSTONE
PRECINCT 1 STAGE 5D**
For
**PEET FLAGSTONE
CITY PTY LTD**

IMPORTANT NOTES:
(These notes are an integral part of this plan)

This plan has been prepared for PEET FLAGSTONE CITY PTY LTD for the purposes of a Disclosure Plan Under the Land Sales Act 1984 (as amended).

It is not to be used by any other person or corporation or for any other purposes and is subject to the following limitations:

Please refer to the approved Development Application for conditions relating to the LOT and to approved Operational Works drawings for services location and possible easements.

THESE DESIGNS AND DRAWINGS ARE COPYRIGHT AND ARE NOT TO BE USED OR REPRODUCED WITHOUT THE WRITTEN PERMISSION OF VERIS

Data Sources
Cadastral Boundaries
30109-LC-Master(CX) FS94 2014.dwg
Engineering Design
FLAGSTONE - STAGE 5 D L M - DISCLOSURE INFO - 12/04/2022 - BASE FILE
Final Surface Contours
FLAGSTONE - STAGE 5 D L M - DISCLOSURE INFO - 22/04/2022 - TIN DESIGN
Depth of Fill
FLAGSTONE - STAGE 5 D L M - DISCLOSURE INFO - 22/04/2022 - Depth Contours in 3D

Issue	Revisions	Date	BK	Drawn
A	Original	26.04.2022		

Locality: FLAGSTONE
Local Authority: LOGAN CITY COUNCIL
Horizontal Meridian: MGA, Zone 56
Vertical Level Datum: AHD D
Scale: 1:250 @ A4
Designed: Peak Urban
Drawn: BK 26/04/2022
Checked: DE 26/04/2022
Plot Date: 04 May, 2022
Computer File Ref: 30109-StSD-DP-(A).dwg

DISCLOSURE PLAN
of Proposed LOT 2268
being part of
Lot 911
on SP321079



veris

BRISBANE WHITSUNDAYS
(07) 3686 4700 (07) 4945 6600

MACKAY CAIRNS
(07) 4957 9700 (07) 4252 9400

veris.com.au
ACN 615 735 727
Veris Australia Pty Ltd

Drawing No Issue
30109-DP- 2268 A

ADDITIONAL NOTES:

The LOT dimensions and area shown hereon are subject to final field survey and also to the requirements of Council and any other authority which may have requirements under any relevant legislation

Final surface contours shown hereon have been supplied by Peak Urban.

Location of retaining walls are as shown on Engineering design drawings. Their as-constructed location may differ from their design location. Retaining wall heights have been supplied by Peak Urban. **The engineering detail shown hereon are preliminary only and are subject to change in final design and statutory approvals**

Compaction of any fill material placed on this site shall be completed to level one inspection and testing services in accordance with AS3798-2007.

Depth of fill values are calculated to the pre-development surface.

Copyright © Veris Australia Pty Ltd
26/04/2022.

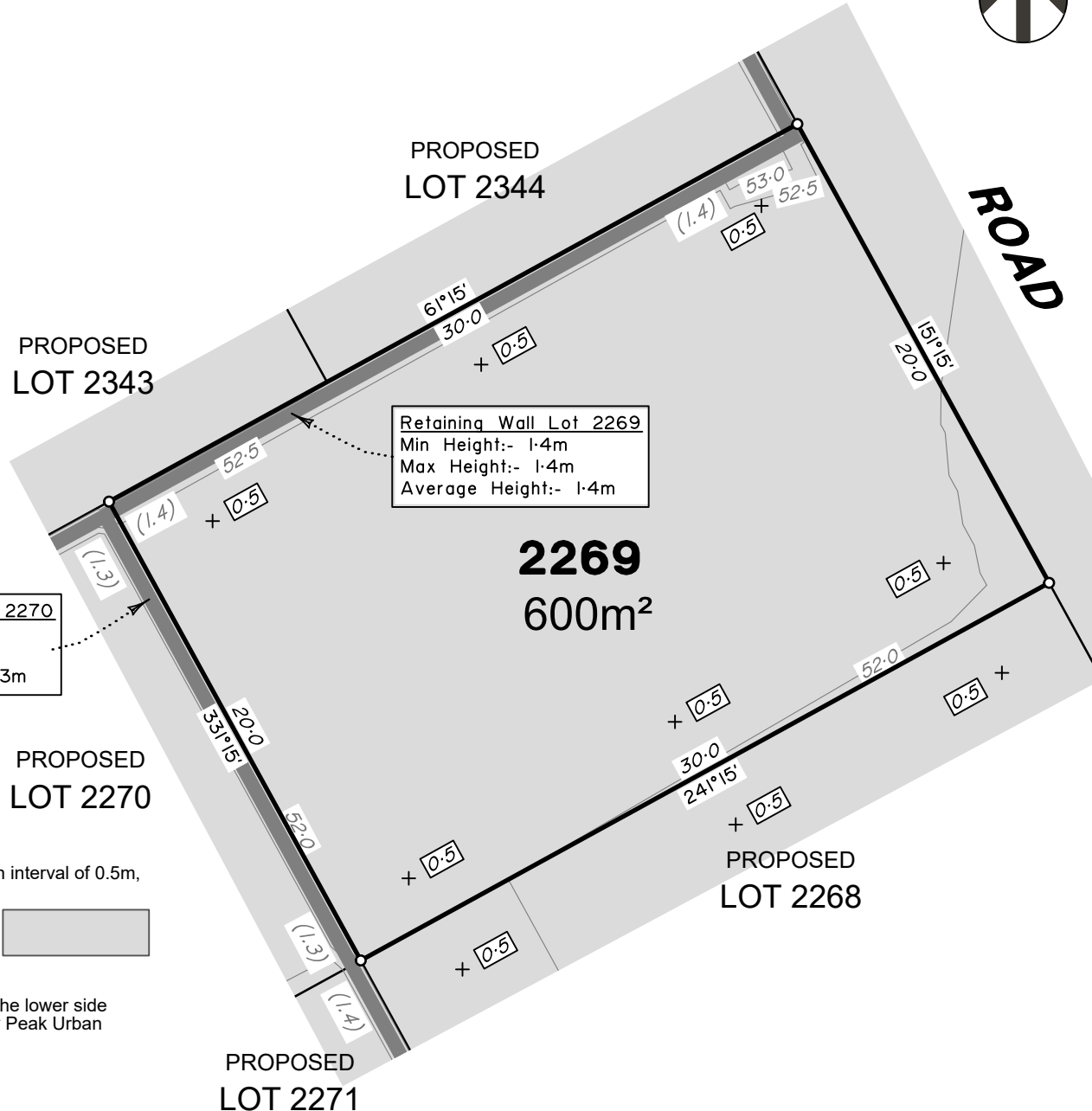

Retaining Wall Lot 2270
Min Height:- 1.3m
Max Height:- 1.3m
Average Height:- 1.3m

Retaining Wall Lot 2269
Min Height:- 1.4m
Max Height:- 1.4m
Average Height:- 1.4m

LEGEND

Final surface contours based on A.H.D. datum at an interval of 0.5m, shown as: 15.5

Where applicable, areas to be filled are shown as:

Depth of fill, in metres, shown as:- +0.5

Retaining wall and retaining wall height, shown on the lower side of the wall, have been taken from plans supplied by Peak Urban and shown as: (1.2)

Bin Pad Location shown as:



**FLAGSTONE
PRECINCT 1 STAGE 5D**
For
**PEET FLAGSTONE
CITY PTY LTD**

IMPORTANT NOTES:
(These notes are an integral part of this plan)

This plan has been prepared for **PEET FLAGSTONE CITY PTY LTD** for the purposes of **A Disclosure Plan Under the Land Sales Act 1984 (as amended)**.

It is not to be used by any other person or corporation or for any other purposes and is subject to the following limitations:

Please refer to the approved Development Application for conditions relating to the LOT and to approved Operational Works drawings for services location and possible easements.

THESE DESIGNS AND DRAWINGS ARE COPYRIGHT AND ARE NOT TO BE USED OR REPRODUCED WITHOUT THE WRITTEN PERMISSION OF VERIS

Data Sources
Cadastral Boundaries
30109-LC-Master(CX) F594 2014.dwg
Engineering Design
FLAGSTONE - STAGE 5 D L M - DISCLOSURE INFO - 12/04/2022 - BASE FILE
Final Surface Contours
FLAGSTONE - STAGE 5 D L M - DISCLOSURE INFO - 22/04/2022 - TIN DESIGN
Depth of Fill
FLAGSTONE - STAGE 5 D L M - DISCLOSURE INFO - 22/04/2022 - Depth Contours in 3D

Issue	Revisions	Date	BK	Drawn
A	Original	26.04.2022		BK

Locality: FLAGSTONE
Local Authority: LOGAN CITY COUNCIL
Horizontal Meridian: MGA, Zone 56
Vertical Level Datum: AHD D
Scale: 1:250 @ A4
Designed: Peak Urban
Drawn: BK 26/04/2022
Checked: DE 26/04/2022
Plot Date: 04 May, 2022
Computer File Ref: 30109-StSD-DP-(A).dwg

DISCLOSURE PLAN
of Proposed LOT 2269
being part of
Lot 911
on SP321079



BRISBANE WHITSUNDAYS
(07) 3666 4700 (07) 4945 6600

MACKAY CAIRNS
(07) 4957 9700 (07) 4252 9400

veris.com.au
ACN 615 735 727
Veris Australia Pty Ltd

Drawing No Issue
30109-DP- 2269 A

ADDITIONAL NOTES:

The LOT dimensions and area shown hereon are subject to final field survey and also to the requirements of Council and any other authority which may have requirements under any relevant legislation

Final surface contours shown hereon have been supplied by Colliers.

Location of retaining walls are as shown on Engineering design drawings. Their as-constructed location may differ from their design location. Retaining wall heights have been supplied by Colliers.

Compaction of any fill material placed on this site shall be completed to level one inspection and testing services in accordance with AS3798-2007.

Depth of fill values are calculated to the pre-development surface.

Copyright © Veris Australia Pty Ltd
20/12/2022.

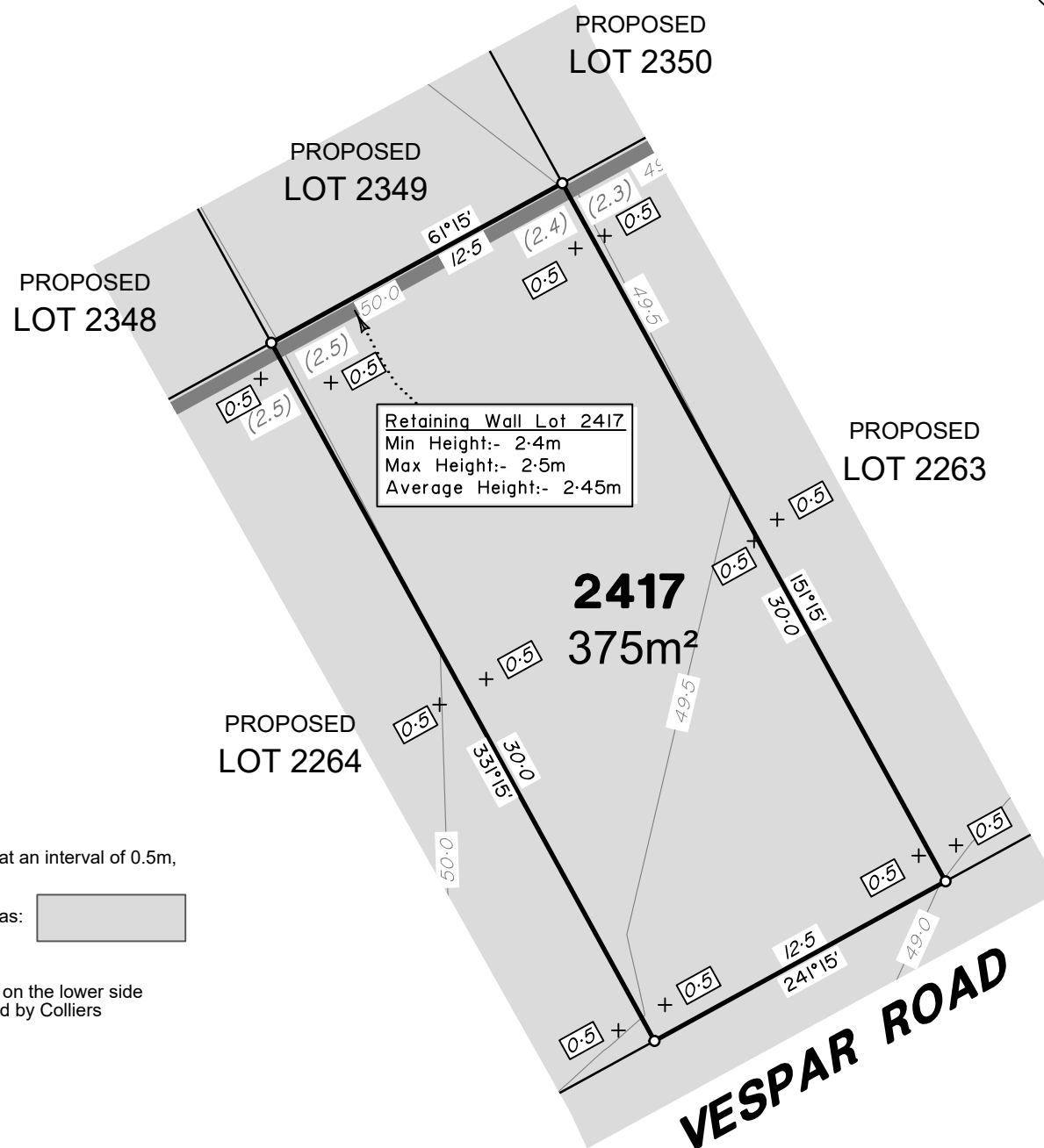

Retaining Wall Lot 2417
Min Height:- 2.4m
Max Height:- 2.5m
Average Height:- 2.45m

LEGEND

Final surface contours based on A.H.D. datum at an interval of 0.5m, shown as: 15.5

Where applicable, areas to be filled are shown as:

Depth of fill, in metres, shown as:- + 0.5

Retaining wall and retaining wall height, shown on the lower side of the wall, have been taken from plans supplied by Colliers and shown as:

Bin Pad Location shown as:



**FLAGSTONE
PRECINCT 1 STAGE 5D**
For
**PEET FLAGSTONE
CITY PTY LTD**

IMPORTANT NOTES:
(These notes are an integral part of this plan)

This plan has been prepared for PEET FLAGSTONE CITY PTY LTD for the purposes of A Disclosure Plan Under the Land Sales Act 1984 (as amended).

It is not to be used by any other person or corporation or for any other purposes and is subject to the following limitations:

Please refer to the approved Development Application for conditions relating to the LOT and to approved Operational Works drawings for services location and possible easements.

THESE DESIGNS AND DRAWINGS ARE COPYRIGHT AND ARE NOT TO BE USED OR REPRODUCED WITHOUT THE WRITTEN PERMISSION OF VERIS

Data Sources
Cadastral Boundaries
30109-LC-Master(DB) F594 2014.dwg
Engineering Design
20-0138_X_BASE DESIGN (STAGE 5D).dwg
Final Surface Contours
FLAGSTONE - DESIGN SURFACE TIN - OVERALL STAGE 5 DISCLOSURE INFO - 22 11 2022.dxf
Depth of Fill
FLAGSTONE - DEPTH RANGE CONTOURS - OVERALL STAGE 5 DISCLOSURE INFO - 22 11 2022.dwg

Issue	Revisions	Date	Drawn
A	Original	19.12.2022	BK

Locality: FLAGSTONE
Local Authority: LOGAN CITY COUNCIL
Horizontal Meridian: MGA Zone 56
Vertical Level Datum: AHD D
Scale: 1:250 @ A4
Designed: Colliers
Drawn: BK 19/12/2022
Checked: DE 20/12/2022
Plot Date: 09 Jan, 2023
Computer File Ref: 30109-StSD-DP.dwg

DISCLOSURE PLAN
of Proposed LOT 2417
being part of
Lot 911
on SP331193



veris

BRISBANE (07) 3686 4700 WHITSUNDAYS (07) 4945 6600

MACKAY (07) 4957 9700 CAIRNS (07) 4252 9400

veris.com.au
ACN 615 735 727
Veris Australia Pty Ltd

Drawing No
30109-DP- 2417

Issue
A

ADDITIONAL NOTES:

The LOT dimensions and area shown hereon are subject to final field survey and also to the requirements of Council and any other authority which may have requirements under any relevant legislation

Final surface contours shown hereon have been supplied by Colliers.

Location of retaining walls are as shown on Engineering design drawings. Their as-constructed location may differ from their design location. Retaining wall heights have been supplied by Colliers.

Compaction of any fill material placed on this site shall be completed to level one inspection and testing services in accordance with AS3798-2007.

Depth of fill values are calculated to the pre-development surface.

Copyright © Veris Australia Pty Ltd
20/12/2022.

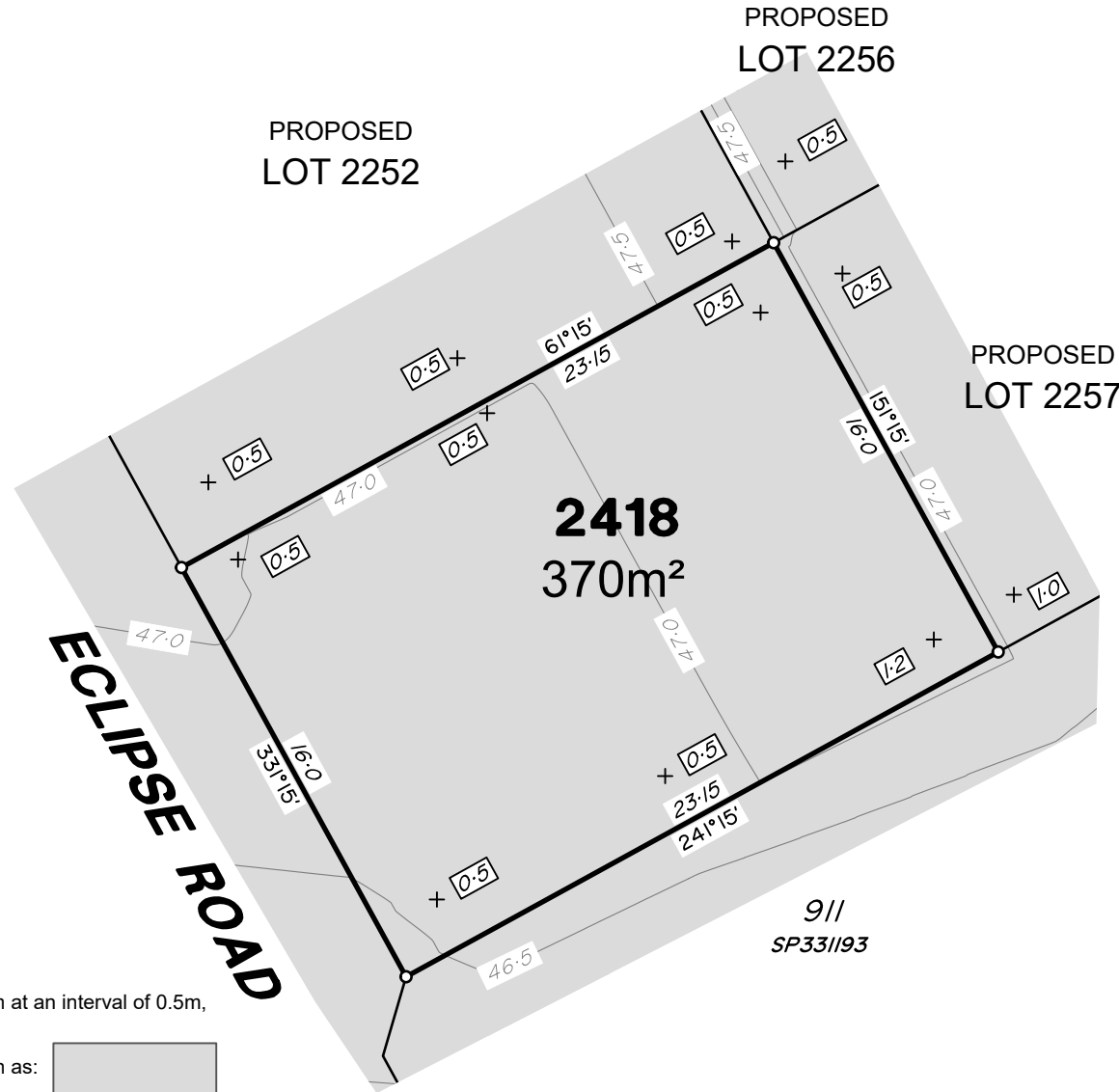

LEGEND

Final surface contours based on A.H.D. datum at an interval of 0.5m, shown as: 15.5

Where applicable, areas to be filled are shown as:

Depth of fill, in metres, shown as:- + 0.5

Retaining wall and retaining wall height, shown on the lower side of the wall, have been taken from plans supplied by Colliers and shown as: (1.2)

Bin Pad Location shown as:



**FLAGSTONE
PRECINCT 1 STAGE 5D**
For
**PEET FLAGSTONE
CITY PTY LTD**

IMPORTANT NOTES:
(These notes are an integral part of this plan)

This plan has been prepared for PEET FLAGSTONE CITY PTY LTD for the purposes of a Disclosure Plan Under the Land Sales Act 1984 (as amended).

It is not to be used by any other person or corporation or for any other purposes and is subject to the following limitations:

Please refer to the approved Development Application for conditions relating to the LOT and to approved Operational Works drawings for services location and possible easements.

THESE DESIGNS AND DRAWINGS ARE COPYRIGHT AND ARE NOT TO BE USED OR REPRODUCED WITHOUT THE WRITTEN PERMISSION OF VERIS

Data Sources
Cadastral Boundaries
30109-LC-Master(DB) F594 2014.dwg
Engineering Design
20-0138_X_BASE DESIGN (STAGE 5D).dwg
Final Surface Contours
FLAGSTONE - DESIGN SURFACE TIN - OVERALL STAGE 5 DISCLOSURE INFO - 22 11 2022.dxf
Depth of Fill
FLAGSTONE - DEPTH RANGE CONTOURS - OVERALL STAGE 5 DISCLOSURE INFO - 22 11 2022.dwg

Issue	Revisions	Date	Drawn
A	Original	19.12.2022	BK

Locality: FLAGSTONE
Local Authority: LOGAN CITY COUNCIL
Horizontal Meridian: MGA Zone 56
Vertical Level Datum: AHD D
Scale: 1:250 @ A4
Designed: Colliers
Drawn: BK 19/12/2022
Checked: DE 20/12/2022
Plot Date: 09 Jan, 2023
Computer File Ref: 30109-StSD-DP.dwg

DISCLOSURE PLAN
of Proposed LOT 2418
being part of
Lot 911
on SP331193



veris

BRISBANE (07) 3686 4700 WHITSUNDAYS (07) 4945 6600

MACKAY (07) 4957 9700 CAIRNS (07) 4252 9400

veris.com.au
ACN 615 735 727
Veris Australia Pty Ltd

Drawing No
30109-DP- 2418

Issue
A

ADDITIONAL NOTES:

The LOT dimensions and area shown hereon are subject to final field survey and also to the requirements of Council and any other authority which may have requirements under any relevant legislation

Final surface contours shown hereon have been supplied by Colliers.

Location of retaining walls are as shown on Engineering design drawings. Their as-constructed location may differ from their design location. Retaining wall heights have been supplied by Colliers.

Compaction of any fill material placed on this site shall be completed to level one inspection and testing services in accordance with AS3798-2007.

Depth of fill values are calculated to the pre-development surface.

Copyright © Veris Australia Pty Ltd
20/12/2022.

Retaining Wall Lot 2252
Min Height:- 0.8m
Max Height:- 0.8m
Average Height:- 0.8m

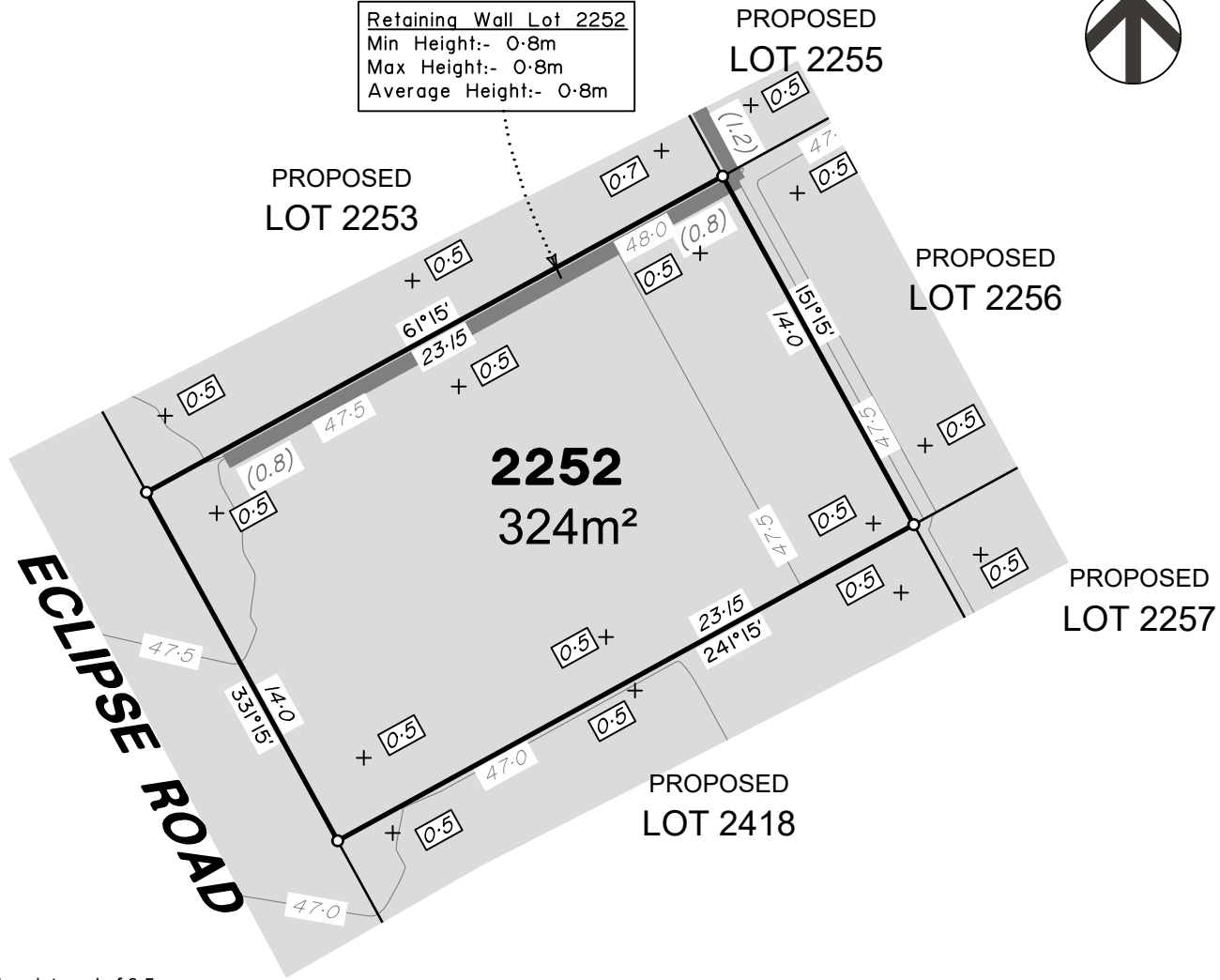

LEGEND

Final surface contours based on A.H.D. datum at an interval of 0.5m, shown as: 15.5

Where applicable, areas to be filled are shown as:

Depth of fill, in metres, shown as:- + 0.5

Retaining wall and retaining wall height, shown on the lower side of the wall, have been taken from plans supplied by Colliers and shown as: (1.2)

Bin Pad Location shown as:



FLAGSTONE
PRECINCT 1 STAGE 5D
For
PEET FLAGSTONE
CITY PTY LTD

IMPORTANT NOTES:
(These notes are an integral part of this plan)

This plan has been prepared for PEET FLAGSTONE CITY PTY LTD for the purposes of a Disclosure Plan Under the Land Sales Act 1984 (as amended).

It is not to be used by any other person or corporation or for any other purposes and is subject to the following limitations:

Please refer to the approved Development Application for conditions relating to the LOT and to approved Operational Works drawings for services location and possible easements.

THESE DESIGNS AND DRAWINGS ARE COPYRIGHT AND ARE NOT TO BE USED OR REPRODUCED WITHOUT THE WRITTEN PERMISSION OF VERIS

Data Sources
Cadastral Boundaries
30109-LC-Master(DB) FS94 2014.dwg
Engineering Design
20-0138_X_BASE DESIGN (STAGE 5D).dwg
Final Surface Contours
FLAGSTONE - DESIGN SURFACE TIN - OVERALL
STAGE 5 - DISCLOSURE INFO - 22 11 2022.dwg

Depth of Fill
FLAGSTONE - DEPTH RANGE CONTOURS - OVERALL
STAGE 5 - DISCLOSURE INFO - 22 11 2022.dwg

B	Change lot layout	19.12.2022	BK
A	Original	26.04.2022	BK
Issue	Revisions	Date	Drawn

Locality: FLAGSTONE
Local Authority: LOGAN CITY COUNCIL
Horizontal Meridian: MGA Zone 56
Vertical Level Datum: AHD D
Scale: 1:250 @ A4
Designed: Colliers
Drawn: BK 19/12/2022
Checked: DE 20/12/2022
Plot Date: 09 Jan, 2023
Computer File Ref: 30109-SISD-DP.dwg

DISCLOSURE PLAN
of Proposed LOT 2252
being part of
Lot 911
on SP331193



veris

BRISBANE WHITSUNDAYS
(07) 3666 4700 (07) 4945 6600

MACKAY CAIRNS
(07) 4957 9700 (07) 4252 9400

veris.com.au
ACN 615 735 727
Veris Australia Pty Ltd

Drawing No Issue
30109-DP- 2252 B

ADDITIONAL NOTES:

The LOT dimensions and area shown hereon are subject to final field survey and also to the requirements of Council and any other authority which may have requirements under any relevant legislation

Final surface contours shown hereon have been supplied by Colliers.

Location of retaining walls are as shown on Engineering design drawings. Their as-constructed location may differ from their design location. Retaining wall heights have been supplied by Colliers.

Compaction of any fill material placed on this site shall be completed to level one inspection and testing services in accordance with AS3798-2007.

Depth of fill values are calculated to the pre-development surface.

Copyright © Veris Australia Pty Ltd
09/01/2022.

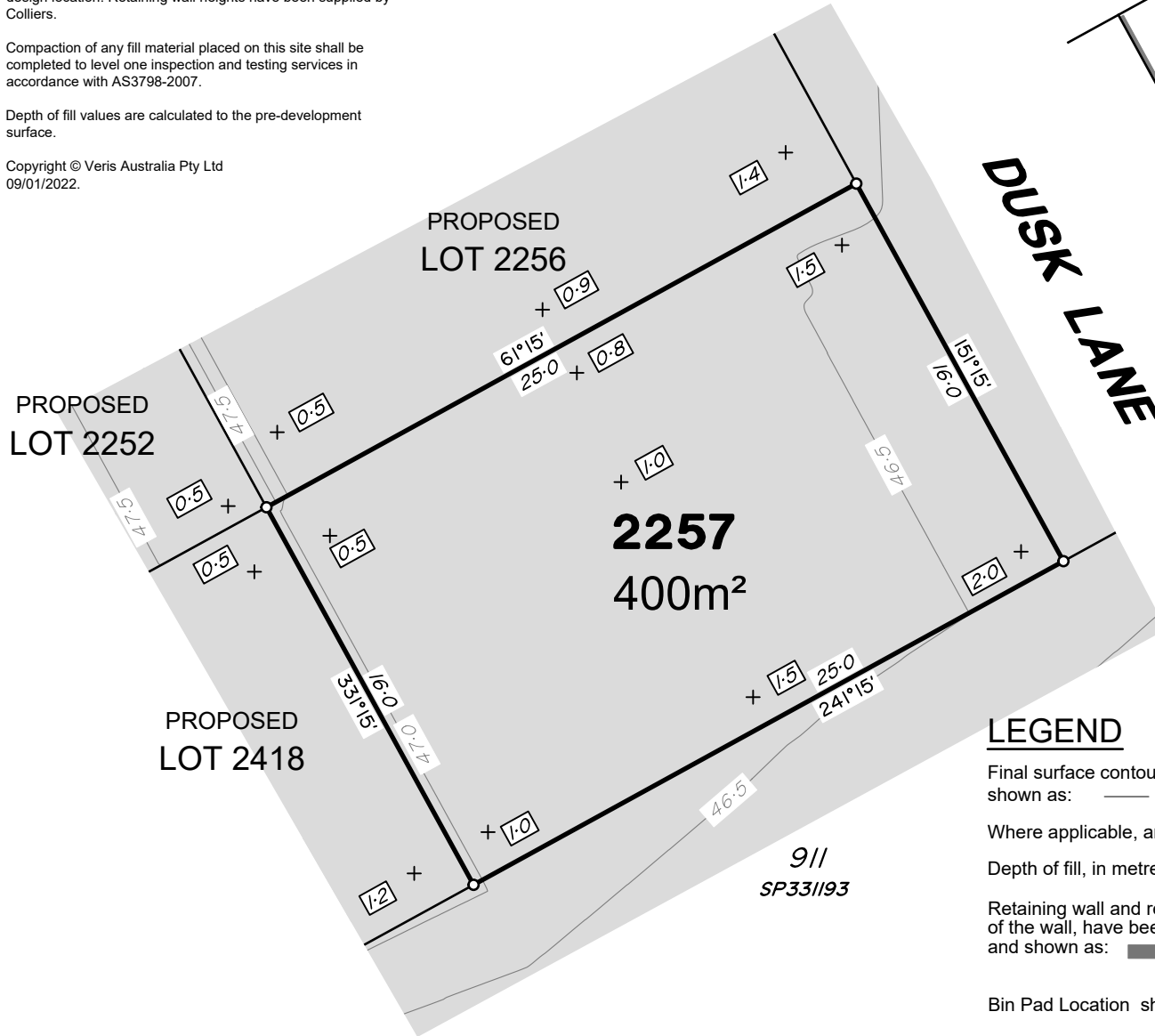

DUSK LANE

BIN LOCATION

LEGEND

Final surface contours based on A.H.D. datum at an interval of 0.5m, shown as: 15.5

Where applicable, areas to be filled are shown as:

Depth of fill, in metres, shown as: - 0.5

Retaining wall and retaining wall height, shown on the lower side of the wall, have been taken from plans supplied by Colliers and shown as: (1.2)

Bin Pad Location shown as:

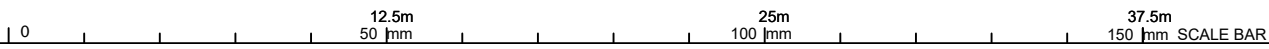

**FLAGSTONE
PRECINCT 1 STAGE 5D**
For
**PEET FLAGSTONE
CITY PTY LTD**

IMPORTANT NOTES:
(These notes are an integral part of this plan)

This plan has been prepared for PEET FLAGSTONE CITY PTY LTD for the purposes of a Disclosure Plan Under the Land Sales Act 1984 (as amended).

It is not to be used by any other person or corporation or for any other purposes and is subject to the following limitations:

Please refer to the approved Development Application for conditions relating to the LOT and to approved Operational Works drawings for services location and possible easements.

THESE DESIGNS AND DRAWINGS ARE COPYRIGHT AND ARE NOT TO BE USED OR REPRODUCED WITHOUT THE WRITTEN PERMISSION OF VERIS

Data Sources
Cadastral Boundaries
30109-LC-Master(DB) FS94 2014.dwg
Engineering Design
20-0138_X_BASE DESIGN (STAGE 5D).dwg
Final Surface Contours
FLAGSTONE - DESIGN SURFACE TIN - OVERALL
STAGE 5 - DISCLOSURE INFO - 22 11 2022.dwg

Depth of Fill
FLAGSTONE - DEPTH RANGE CONTOURS - OVERALL
STAGE 5 - DISCLOSURE INFO - 22 11 2022.dwg

B	Retaining Wall removed	09.01.2023	BK
A	Original	26.04.2022	BK
Issue	Revisions	Date	Drawn

Locality: FLAGSTONE
Local Authority: LOGAN CITY COUNCIL
Horizontal Meridian: MGA Zone 56
Vertical Level Datum: AHD D
Scale: 1:250 @ A4
Designed: Colliers
Drawn: BK 19/12/2022
Checked: DE 20/12/2022
Plot Date: 09 Jan, 2023
Computer File Ref: 30109-StSD-DP.dwg

**DISCLOSURE PLAN
of Proposed LOT 2257
being part of
Lot 911
on SP331193**



veris

BRISBANE (07) 3686 4700 WHITSUNDAYS (07) 4945 6600

MACKAY (07) 4957 9700 CAIRNS (07) 4252 9400

veris.com.au
ACN 615 735 727
Veris Australia Pty Ltd

Drawing No: 30109-DP- 2257 Issue: B

ADDITIONAL NOTES:

The LOT dimensions and area shown hereon are subject to final field survey and also to the requirements of Council and any other authority which may have requirements under any relevant legislation

Final surface contours shown hereon have been supplied by Colliers.

Location of retaining walls are as shown on Engineering design drawings. Their as-constructed location may differ from their design location. Retaining wall heights have been supplied by Colliers.

Compaction of any fill material placed on this site shall be completed to level one inspection and testing services in accordance with AS3798-2007.

Depth of fill values are calculated to the pre-development surface.

Copyright © Veris Australia Pty Ltd
20/12/2022.



Retaining Wall Lot 2263
Min Height:- 2.3m
Max Height:- 2.3m
Average Height:- 2.3m

LEGEND

Final surface contours based on A.H.D. datum at an interval of 0.5m, shown as: 15.5

Where applicable, areas to be filled are shown as:

Depth of fill, in metres, shown as:- 0.5

Retaining wall and retaining wall height, shown on the lower side of the wall, have been taken from plans supplied by Colliers and shown as: (1.2)

Bin Pad Location shown as:



**FLAGSTONE
PRECINCT 1 STAGE 5D**
For
**PEET FLAGSTONE
CITY PTY LTD**

IMPORTANT NOTES:
(These notes are an integral part of this plan)

This plan has been prepared for PEET FLAGSTONE CITY PTY LTD for the purposes of **A Disclosure Plan Under the Land Sales Act 1984 (as amended)**.

It is not to be used by any other person or corporation or for any other purposes and is subject to the following limitations:

Please refer to the approved Development Application for conditions relating to the LOT and to approved Operational Works drawings for services location and possible easements.

THESE DESIGNS AND DRAWINGS ARE COPYRIGHT AND ARE NOT TO BE USED OR REPRODUCED WITHOUT THE WRITTEN PERMISSION OF VERIS

Data Sources
Cadastral Boundaries
30109-LC-Master(DB) F894 2014.dwg
Engineering Design
20-0138_X_BASE DESIGN (STAGE 5D).dwg
Final Surface Contours
FLAGSTONE - DESIGN SURFACE TIN - OVERALL STAGE 5 - DISCLOSURE INFO - 22 11 2022.dxf
Depth of Fill
FLAGSTONE - DEPTH RANGE CONTOURS - OVERALL STAGE 5 - DISCLOSURE INFO - 22 11 2022.dwg

B	Change lot layout	19/12/2022	BK
A	Original	26/04/2022	BK
Issue	Revisions	Date	Drawn

Locality: FLAGSTONE
Local Authority: LOGAN CITY COUNCIL
Horizontal Meridian: MGA Zone 56
Vertical Level Datum: AHD D
Scale: 1:250 @ A4
Designed: Colliers
Drawn: BK 19/12/2022
Checked: DE 20/12/2022
Plot Date: 09 Jan, 2023
Computer File Ref: 30109-S15D-DP.dwg

**DISCLOSURE PLAN
of Proposed LOT 2263**
being part of
Lot 911
on SP331193



veris

BRISBANE WHITSUNDAYS
(07) 3666 4700 (07) 4945 6600
MACKAY CAIRNS
(07) 4957 9700 (07) 4252 9400

veris.com.au
ACN 615 735 727
Veris Australia Pty Ltd

Drawing No 30109-DP- 2263 Issue B