

LEGEND

- ① 100mm STOP VALVE
- ② 100mm FIRE HYDRANT
- ③ 100mm 11.25° BEND
- ④ 100mm 22.5° BEND
- ⑤ 100mm 45° BEND
- ⑥ 150mm STOP VALVE
- ⑦ 150mm FIRE HYDRANT
- ⑧ 100 X 100 TEE
- ⑨ 150mm 11.25° BEND
- ⑩ 150mm 22.5° BEND
- ⑪ 150mm 45° BEND
- ⑫ 150 X 100 TEE
- ⑬ 150 X 100 REDUCER

- WATER SERVICE CONDUIT (Ø100 PVC-O PN16)
- SERVICE POINT (indicative)
- NEW WATER HOUSE CONNECTION (TAPPING BAND)
- NEW WATER MAIN (Ø100 or Ø150 PVC-M PN16)
- NEW WATER MAIN (Ø100 D.I.C.L PN35)



FLAGSTONE STAGE 2G  
PEET FLAGSTONE CITY PTY LTD

**IMPORTANT NOTES:**  
This Plan has been prepared for PEET FLAGSTONE CITY PTY LTD to be used for the purpose of recording the As Constructed details of a new service constructed under a specific Council Approval and should not be used for any other purpose.  
No report is made on any other services, nor any services that may exist before or be constructed after the time of survey, or constructed under any other approval.  
The property boundaries, assessments and lot numbers shown herein may be proposed only and subject to registration by the Department of Natural Resources. All property information should be determined from the registered Survey Plans.  
All dimensions should be verified and confirmed against the latest information prior to commencement by any person using this plan for building purposes.  
Veris Australia Pty Ltd accepts no responsibility for any changes made to construction or otherwise, after the date of this plan. Any discrepancies should be clarified in writing with the relevant Authority prior to commencement of the work.

Copyright © Veris Australia Pty Ltd, January 2022  
THESE ISSUES AND DRAWINGS ARE COPYRIGHT AND ARE NOT TO BE USED OR REPRODUCED WITHOUT THE WRITTEN PERMISSION OF VERIS AUSTRALIA PTY LTD

As-con survey	Veris
Engineering Design	Member

B	Progress Plan	08/02/2022	CJP
A	Progress Plan	11/02/2021	JMC
Drawn	Revision	Date	Drawn

AS-CONSTRUCTED WATER RETICULATION  
SHEET 1 OF 3

BRISBANE (07) 968 4700  
MACKAY (07) 4967 9700  
WHITSUNDAYS (07) 4940 9400  
CAIRNS (07) 4322 9400  
veris.com.au  
ACN 615 735 727  
Veris Australia Pty Ltd

Consulting Engineer's Certification.  
I, ..... hereby certify that the As Constructed information shown on this plan is a true and correct record of the sizes, types, materials, classes etc., and it corresponds with the relevant approved Engineering Drawings.  
Signed..... RPEQ No ..... Dated.....

Registered Surveyor's Certification.  
We, VERIS AUSTRALIA P/L hereby certify that the horizontal and vertical locations, and dimensions shown on this plan are a true and correct record of the As Constructed information.  
Signed *Alastair Bayson* Reg No 6448  
Dated 10/02/2022  
Cadastral Surveyor & Delegate

SHEET 2

SHEET 3

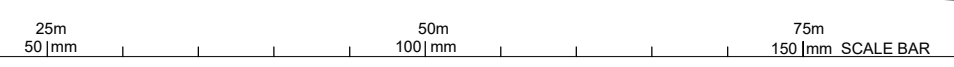

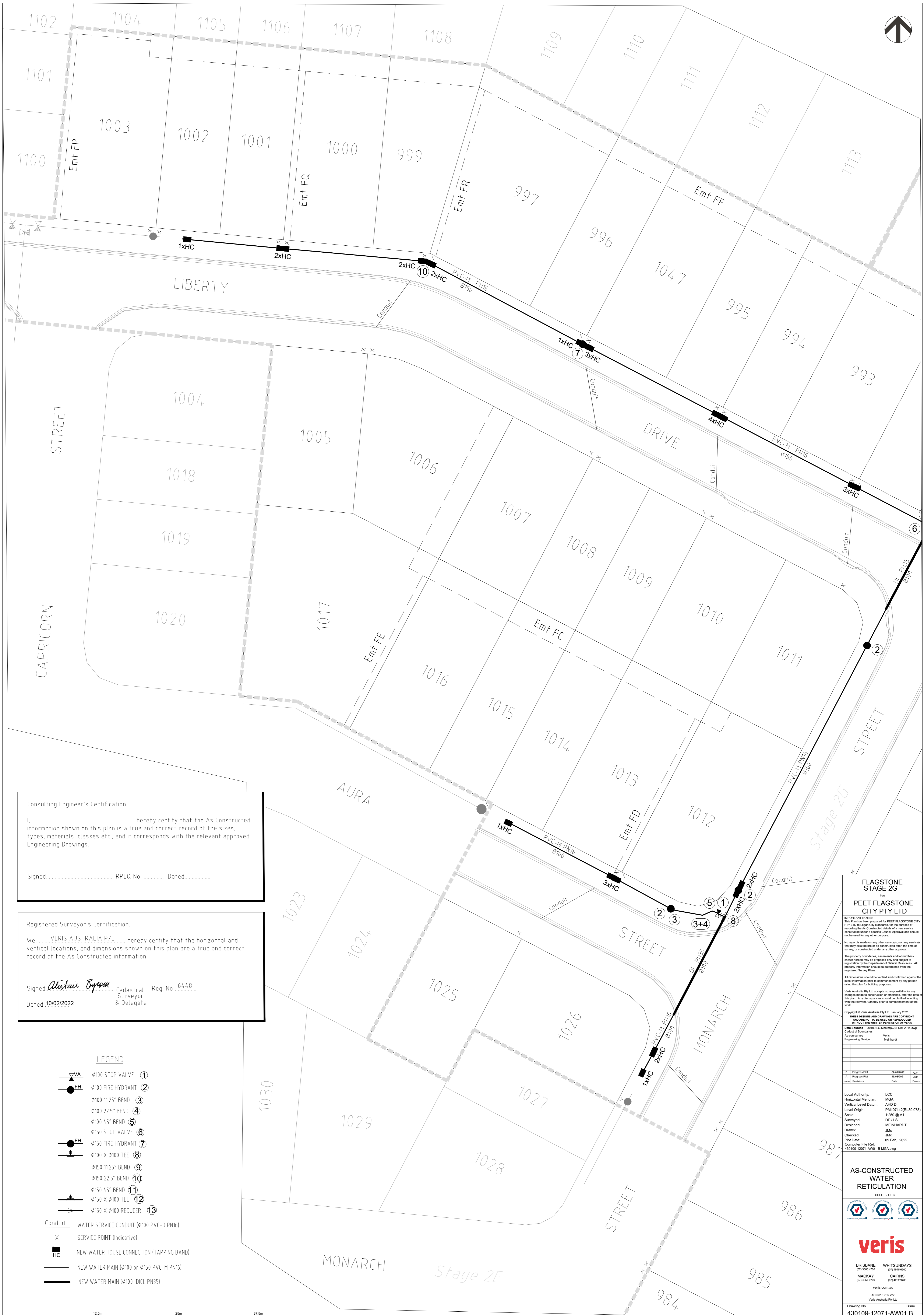

Consulting Engineer's Certification.

I, ..... hereby certify that the As Constructed information shown on this plan is a true and correct record of the sizes, types, materials, classes etc., and it corresponds with the relevant approved Engineering Drawings.

Signed..... RPEQ No ..... Dated.....

Registered Surveyor's Certification.

We, VERIS AUSTRALIA P/L ..... hereby certify that the horizontal and vertical locations, and dimensions shown on this plan are a true and correct record of the As Constructed information.

Signed *Alistair Byrom* Cadastral Reg No 6448  
Surveyor & Delegate  
Dated 10/02/2022

**LEGEND**

- 100 STOP VALVE ①
- 100 FIRE HYDRANT ②
- 100 112.5° BEND ③
- 100 225° BEND ④
- 100 45° BEND ⑤
- 150 STOP VALVE ⑥
- 150 FIRE HYDRANT ⑦
- 100 X 100 TEE ⑧
- 150 112.5° BEND ⑨
- 150 225° BEND ⑩
- 150 45° BEND ⑪
- 150 X 100 TEE ⑫
- 150 X 100 REDUCER ⑬

- WATER SERVICE CONDUIT (Ø100 PVC-O PN16)
- SERVICE POINT (Indicative)
- NEW WATER HOUSE CONNECTION (TAPPING BAND)
- NEW WATER MAIN (Ø100 or Ø150 PVC-M PN16)
- NEW WATER MAIN (Ø100 DI CL PN35)

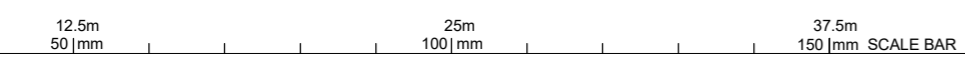

**FLAGSTONE STAGE 2G**  
For  
**PEET FLAGSTONE CITY PTY LTD**

**IMPORTANT NOTES:**  
This Plan has been prepared for PEET FLAGSTONE CITY PTY LTD to Logon City standards for the purpose of recording the As Constructed details of a new service constructed under a specific Council Approval and should not be used for any other purpose.

No report is made on any other services, nor any services that may exist before or be constructed after, the time of survey, or constructed under any other approval.

The property boundaries, easements and lot numbers shown hereon may be proposed only and subject to registration by the Department of Natural Resources. All property information should be determined from the registered Survey Plans.

All dimensions should be verified and confirmed against the latest information prior to commencement by any person using this plan for building purposes.

Veris Australia Pty Ltd accepts no responsibility for any changes made to construction or otherwise, after the date of this plan. Any discrepancies should be clarified in writing with the relevant Authority prior to commencement of the work.

Copyright © Veris Australia Pty Ltd, January 2021.  
THIS DRAWING AND DIMENSIONS ARE COPYRIGHT AND ARE NOT TO BE REPRODUCED WITHOUT THE WRITTEN PERMISSION OF VERIS.

**Data Sources:** 30109-LC Master (C) JFS4 2014.dwg  
Cadastral Boundaries: Veris  
As-built Survey: Veris  
Engineering Design: Veris

B	Progress Plot	09/02/2022	JMB
A	Progress Plot	15/02/2021	JMB

Local Authority: LCC  
Horizontal Meridian: MGA  
Vertical Level Datum: AHD D  
Level Origin: PA1017142(RL39.078)  
Scale: 1:250 @ A1  
Surveyed: DE / LS  
Designed: MCKINARDT  
Drawn: JMC  
Checked: JMC  
Plot Date: 09 Feb, 2022  
Computer File Ref: 430109-12071-AW01-B MGA.dwg

**AS-CONSTRUCTED WATER RETICULATION**  
SHEET 2 OF 3

**veris**  
BRISBANE (07) 386 4700  
MACKAY (07) 462 8700  
WHITSUNDAYS (07) 464 9600  
CAIRNS (07) 4252 9400  
veris.com.au  
ACN 615 735 727  
Veris Australia Pty Ltd

Drawing No: 430109-12071-AW01 B Issue

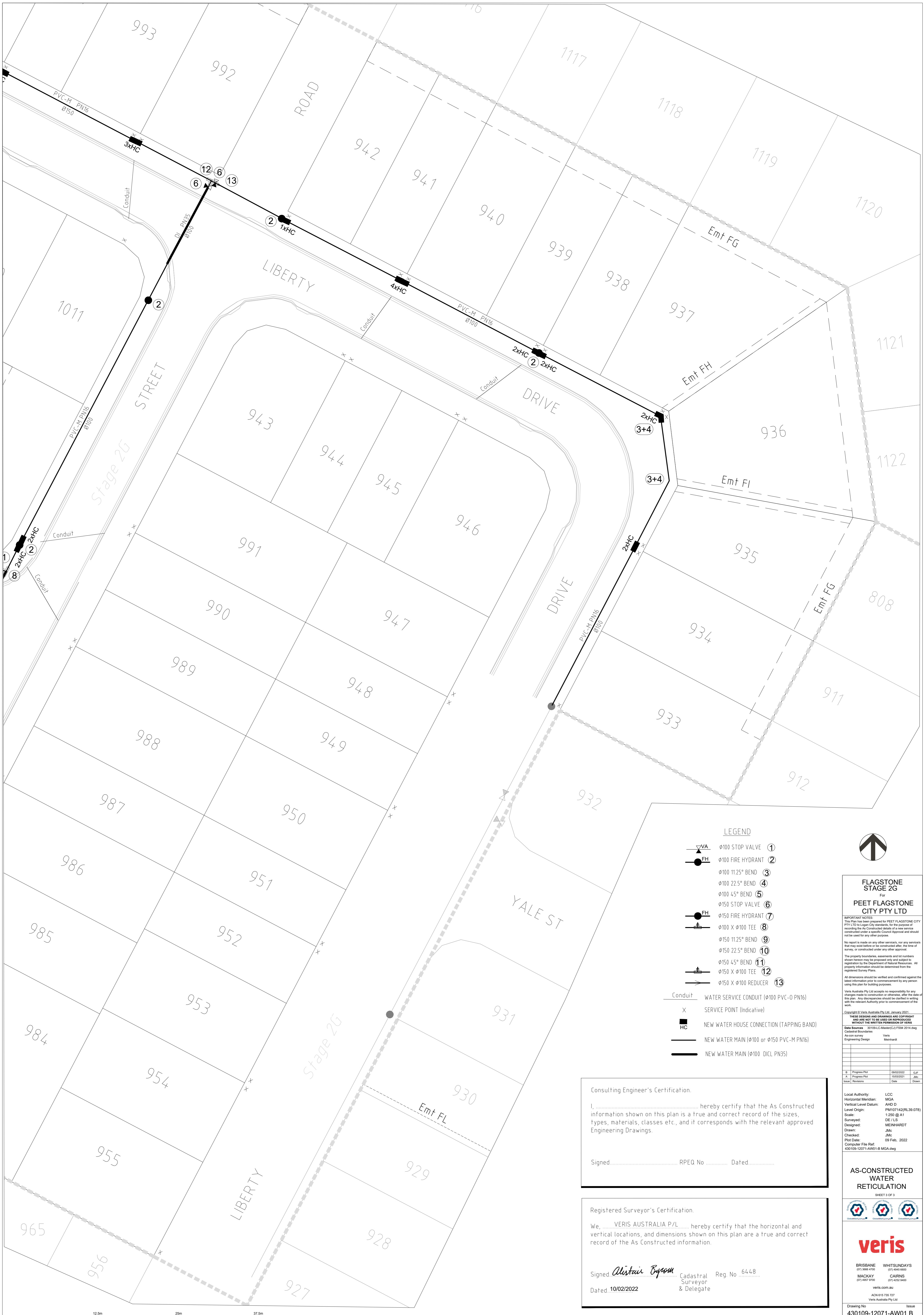

**LEGEND**

- 100 STOP VALVE ①
- 100 FIRE HYDRANT ②
- 100 112.5° BEND ③
- 100 22.5° BEND ④
- 100 45° BEND ⑤
- 150 STOP VALVE ⑥
- 150 FIRE HYDRANT ⑦
- 100 X 100 TEE ⑧
- 150 112.5° BEND ⑨
- 150 22.5° BEND ⑩
- 150 45° BEND ⑪
- 150 X 100 TEE ⑫
- 150 X 100 REDUCER ⑬
- WATER SERVICE CONDUIT (Ø100 PVC-O PN16)
- SERVICE POINT (Indicative)
- NEW WATER HOUSE CONNECTION (TAPPING BAND)
- NEW WATER MAIN (Ø100 or Ø150 PVC-M PN16)
- NEW WATER MAIN (Ø100 DI CL PN35)

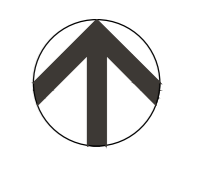

**FLAGSTONE STAGE 2G**  
For  
**PEET FLAGSTONE CITY PTY LTD**

IMPORTANT NOTES:  
This plan has been prepared for PEET FLAGSTONE CITY PTY LTD in Logan City standards for the purpose of recording the As Constructed details of a new service constructed under a specific Council Approval and should not be used for any other purpose.  
No report is made on any other services, nor any services that may exist before or be constructed after, the time of survey, or constructed under any other approval.  
The property boundaries, easements and lot numbers shown herein may be proposed only and subject to registration by the Department of Natural Resources. All property information should be determined from the registered Survey Plans.  
All dimensions should be verified and confirmed against the latest information prior to commencement by any person using this plan for building purposes.  
Veris Australia Pty Ltd accepts no responsibility for any changes made to construction or otherwise, after the date of this plan. Any discrepancies should be clarified in writing with the relevant Authority prior to commencement of the work.  
Copyright © Veris Australia Pty Ltd, January 2021.  
THIS DRAWING AND ANY INFORMATION CONTAINED HEREIN ARE NOT TO BE REPRODUCED OR TRANSMITTED IN ANY FORM OR BY ANY MEANS, ELECTRONIC OR MECHANICAL, INCLUDING PHOTOCOPYING, RECORDING, OR BY ANY INFORMATION STORAGE AND RETRIEVAL SYSTEM.

Level	Origin	Scale	Surveyed	Designed	Drawn	Checked	Plot Date	Computer File Ref
B	Progress Plot	09/02/2022	JM					
A	Progress Plot	15/02/2021	JM					

**AS-CONSTRUCTED WATER RETICULATION**  
SHEET 3 OF 3

**veris**  
BRISBANE (07) 3864 8700  
MACKEY (07) 4627 8700  
WHITSUNDAYS (07) 4642 8000  
CAIRNS (07) 4252 8400  
veris.com.au  
ACN 615 735 727  
Veris Australia Pty Ltd

Drawing No: 430109-12071-AW01-B Issue

Consulting Engineer's Certification.

I, ..... hereby certify that the As Constructed information shown on this plan is a true and correct record of the sizes, types, materials, classes etc., and it corresponds with the relevant approved Engineering Drawings.

Signed ..... RPEQ No ..... Dated .....

Registered Surveyor's Certification.

We, VERIS AUSTRALIA P/L, hereby certify that the horizontal and vertical locations, and dimensions shown on this plan are a true and correct record of the As Constructed information.

Signed, *Alistair Byrom* Cadastral Surveyor & Delegate Reg. No. 6448  
Dated 10/02/2022

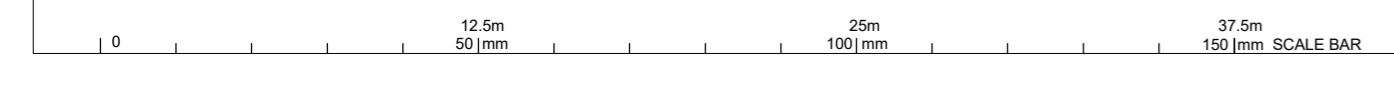

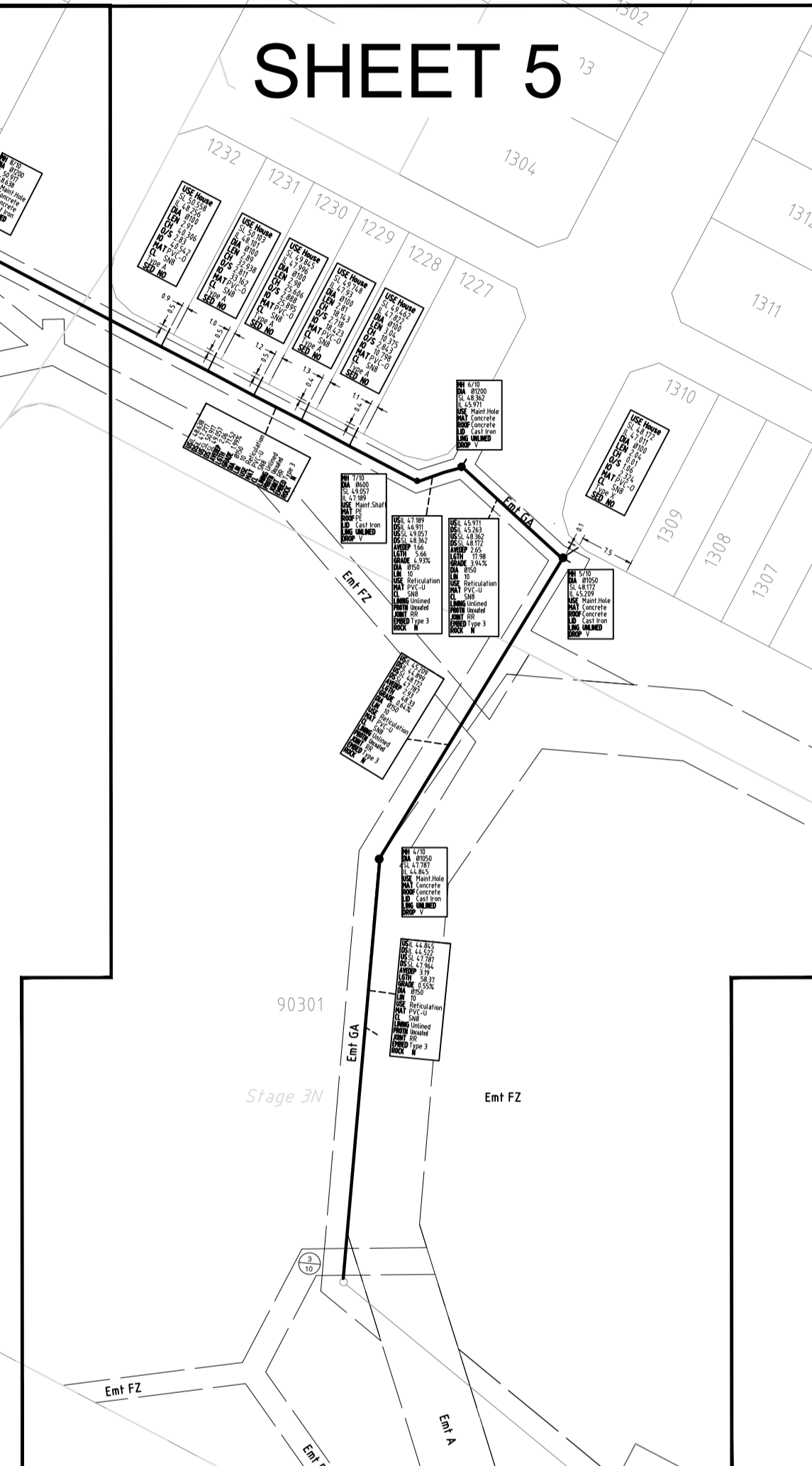

Consulting Engineer's Certification.

I, \_\_\_\_\_ hereby certify that the As Constructed information shown on this plan is a true and correct record of the sizes, types, materials, classes etc., and it corresponds with the relevant approved Engineering Drawings.

Signed..... RPEQ No ..... Dated.....

Registered Surveyor's Certification.

We, VERIS AUSTRALIA P/L hereby certify that the horizontal and vertical locations, and dimensions shown on this plan are a true and correct record of the As Constructed information.

Signed *Alistair Byrom* Cadastrial Reg No 6448  
 Dated 4/02/2022 Surveyor & Delegate

**FLAGSTONE STAGE 2G**  
**PEET FLAGSTONE CITY PTY LTD**

**IMPORTANT NOTES**  
 This Plan has been prepared for PEET FLAGSTONE CITY PTY LTD in Logan City shire for the purpose of recording the As Constructed details of a new service installed under a specific Council Approval and should not be used for any other purpose.  
 No report is made on any other services, nor any services that may exist before or be constructed after the time of survey, or constructed under any other approval.  
 The property boundaries, assessments and lot numbers shown herein may be proposed only and subject to registration by the Department of Natural Resources. All property information should be determined from the registered Survey Plans.  
 All dimensions should be verified and confirmed against the latest information prior to commencement by any person using this plan for building purposes.  
 Veris Australia Pty Ltd accepts no responsibility for any changes made to construction or otherwise, after the date of this plan. Any discrepancies should be clarified in writing with the relevant Authority prior to commencement of the work.  
 Copyright © Veris Australia Pty Ltd, February 2022.  
 THESE ISSUED AND DRAWINGS ARE COPYRIGHT AND ARE NOT TO BE USED OR REPRODUCED WITHOUT THE WRITTEN PERMISSION OF VERIS.  
 Data Sources: 30109-LC Master (C) FSRM 2014.dwg  
 As-con survey: Veris  
 Engineering Design: PEAKURBAN

Revision	Date	Drawn
A	08/02/2022	JMC
B	22/11/2021	JMC
C	08/02/2021	JMC
D	08/02/2021	JMC
E	08/02/2021	JMC
F	08/02/2021	JMC
G	08/02/2021	JMC
H	08/02/2021	JMC
I	08/02/2021	JMC
J	08/02/2021	JMC
K	08/02/2021	JMC
L	08/02/2021	JMC
M	08/02/2021	JMC
N	08/02/2021	JMC
O	08/02/2021	JMC
P	08/02/2021	JMC
Q	08/02/2021	JMC
R	08/02/2021	JMC
S	08/02/2021	JMC
T	08/02/2021	JMC
U	08/02/2021	JMC
V	08/02/2021	JMC
W	08/02/2021	JMC
X	08/02/2021	JMC
Y	08/02/2021	JMC
Z	08/02/2021	JMC

**AS-CONSTRUCTED SEWER RETICULATION**  
 SHEET 1 OF 5

**veris**

BRISBANE 071 966 4700  
 MACKAY 071 4927 9700  
 CAIRNS 071 4322 9400

veris.com.au  
 ACN 615 735 727  
 Veris Australia Pty Ltd

Drawing No. 430109-12071-AS01-F Issue

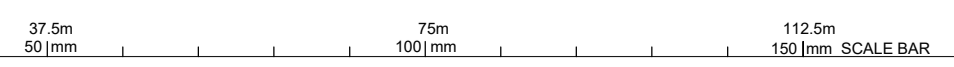



**FLAGSTONE STAGE 2G**  
For  
**PEET FLAGSTONE CITY PTY LTD**

**IMPORTANT NOTES:**  
This Plan has been prepared for PEET FLAGSTONE CITY PTY LTD in accordance with the standards for the purpose of recording the As Constructed details of a sewer service constructed under a specific Council Approval and should not be used for any other purpose.  
No report is made on any other services, nor any services that may exist before or be constructed after, the time of survey, or constructed under any other approval.  
The property boundaries, easements and lot numbers shown hereon may be proposed only and subject to registration by the Department of Natural Resources. All property information should be determined from the registered Survey Plans.  
All dimensions should be verified and confirmed against the latest information prior to commencement of any person using this plan for building purposes.  
Veris Australia Pty Ltd accepts no responsibility for any changes made to construction or otherwise, after the date of this plan. Any discrepancies should be clarified in writing with the relevant Authority prior to commencement of the work.  
Copyright © Veris Australia Pty Ltd, February 2022.  
These drawings and associated data are computer generated and are not to be used or reproduced without the written permission of Veris.

**Data Sources:** 30109-LC Master (C) F594 2014.dwg  
Cadastral Boundaries: Veris  
Engineering Design: PEAMURBAN

Rev	Description	Date	Drawn
F	Program File	28/01/2022	CAF
E	Program File	22/02/2022	JMS
D	Program File	06/02/2021	JMS
C	Program File	29/01/2021	JMS
B	Program File	08/02/2021	JMS
A	Program File	15/06/2021	JMS

**Consulting Engineer's Certification.**  
I, \_\_\_\_\_ hereby certify that the As Constructed information shown on this plan is a true and correct record of the sizes, types, materials, classes etc., and it corresponds with the relevant approved Engineering Drawings.  
Signed \_\_\_\_\_ RPEQ No. \_\_\_\_\_ Dated \_\_\_\_\_

**Registered Surveyor's Certification.**  
We, VERIS AUSTRALIA P/L hereby certify that the horizontal and vertical locations, and dimensions shown on this plan are a true and correct record of the As Constructed information.  
Signed *Alistair Byron* Cadastral Reg. No. 6448  
Dated 4/02/2022 & Delegate

**AS-CONSTRUCTED SEWER RETICULATION**  
SHEET 2 OF 5

**veris**  
BRISBANE 071 960 4100 WHITSUNDAYS 071 462 8600  
MACKAY 071 462 8700 CAIRNS 071 4232 9400  
veris.com.au  
ACN 615 735 727  
Veris Australia Pty Ltd

Drawing No. \_\_\_\_\_ Issue  
430109-12071-AS01 F

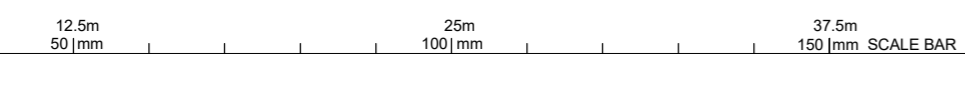



**FLAGSTONE STAGE 2G**  
For  
**PEET FLAGSTONE CITY PTY LTD**

IMPORTANT NOTES:  
This Plan has been prepared for PEET FLAGSTONE CITY PTY LTD in Logan City standards for the purpose of recording the As Constructed details of a new service constructed under a specific Council Approval and should not be used for any other purposes.  
No report is made on any other services, nor any services that may exist before or be constructed after, the time of survey, or constructed under any other approval.  
The property boundaries, easements and lot numbers shown herein may be proposed only and subject to registration by the Department of Natural Resources. All property information should be determined from the registered Survey Plans.  
All dimensions should be verified and confirmed against the latest information prior to commencement by any person using this plan for building purposes.  
Veris Australia Pty Ltd accepts no responsibility for any changes made to construction or otherwise, after the date of this plan. Any discrepancies should be clarified in writing with the relevant Authority prior to commencement of the work.  
Copyright © Veris Australia Pty Ltd. February 2022  
These drawings are prepared under contract and are not to be used or reproduced without the written permission of Veris.  
Data Sources: 30109-1-C-Master (C) F594 2014.dwg  
Cadastral Boundaries: Veris  
Engineering Design: Peeturban

Consulting Engineer's Certification.

I, ....., hereby certify that the As Constructed information shown on this plan is a true and correct record of the sizes, types, materials, classes etc., and it corresponds with the relevant approved Engineering Drawings.

Signed..... RPEQ No ..... Dated.....

Registered Surveyor's Certification.

We, VERIS AUSTRALIA P/L, hereby certify that the horizontal and vertical locations, and dimensions shown on this plan are a true and correct record of the As Constructed information.

Signed *Alistair Byrom* Cadastral Reg No 6448  
Dated: 4/02/2022 Surveyor & Delegate

**AS-CONSTRUCTED SEWER RETICULATION**

SHEET 3 OF 5

Local Authority: LCC  
Horizontal Meridian: MGA  
Vertical Level Datum: AHD D  
Level Origin: PM107142(39 078)  
Scale: 1:250 @ A1  
Surveyed: DE / CS  
Designed: PEETURBAN  
Drawn: JMC  
Checked: JMC  
Plot Date: 04 Feb. 2022  
Computer File Ref: 430109-12071-AS01-F MGA.dwg

**veris**  
BRISBANE 071 960 4700  
MACKAY 071 462 8700  
WHITSUNDAYS 071 462 8600  
CAIRNS 071 4232 9400  
veris.com.au  
ACN 615 735 727  
Veris Australia Pty Ltd

Drawing No. 430109-12071-AS01 F Issue

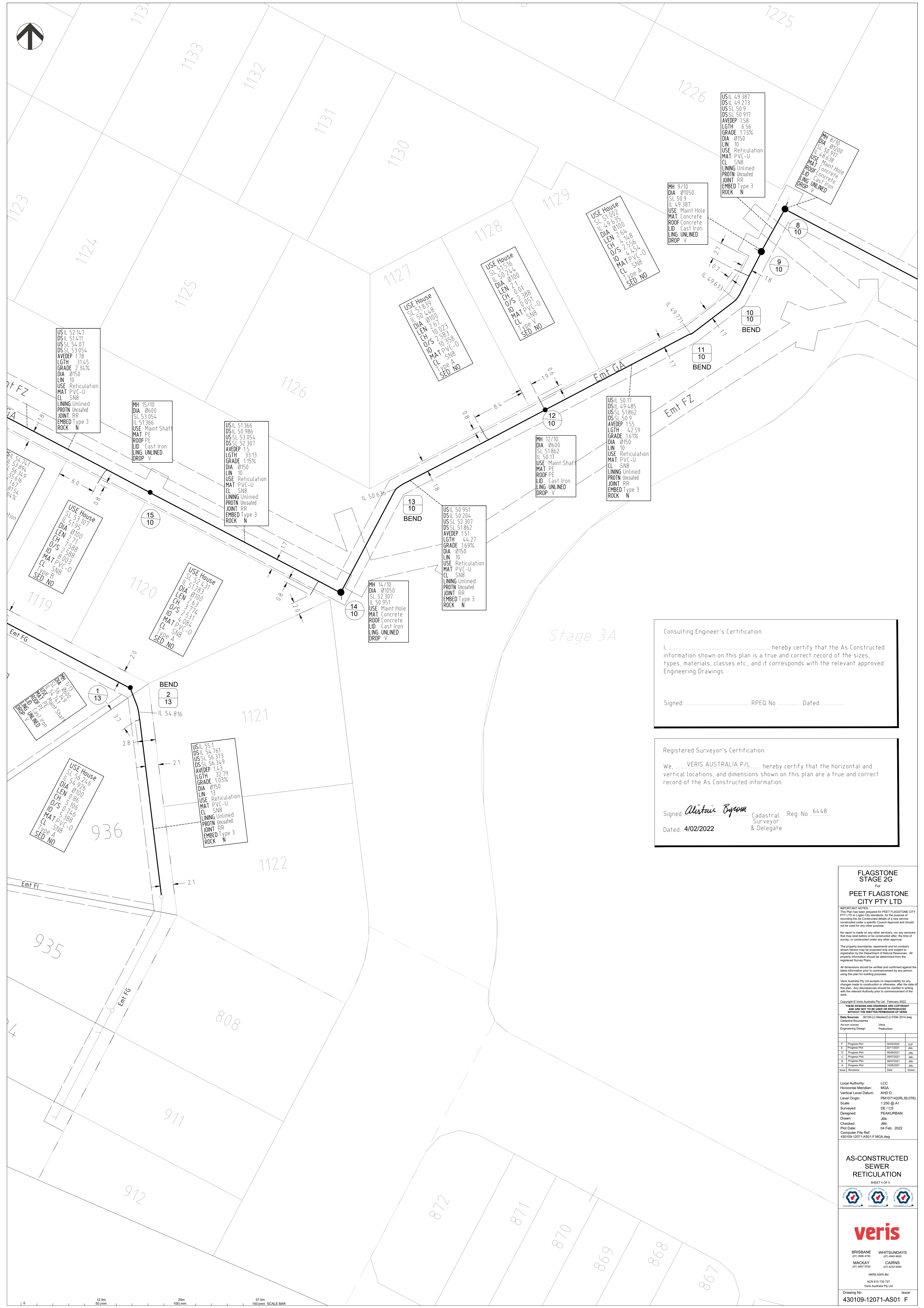

Consulting Engineer's Certification.

I, ..... hereby certify that the As Constructed information shown on this plan is a true and correct record of the sizes, types, materials, classes etc., and it corresponds with the relevant approved Engineering Drawings.

Signed..... RPEQ No ..... Dated.....

Registered Surveyor's Certification.

We, VERIS AUSTRALIA P/L ..... hereby certify that the horizontal and vertical locations, and dimensions shown on this plan are a true and correct record of the As Constructed information.

Signed *Alastair Byrom* ..... Cadastral Reg No 6448  
 Dated 4/02/2022 ..... Surveyor & Delegate

**FLAGSTONE STAGE 2G**  
 For  
**PEET FLAGSTONE CITY PTY LTD**

**IMPORTANT NOTES:**  
 This plan has been prepared for PEET FLAGSTONE CITY PTY LTD in Logan City standards for the purpose of recording the As Constructed details of a new service constructed under a specific Council Approval and should not be used for any other purpose.

No report is made on any other services, nor any services that may exist before or be constructed after, the time of survey, or constructed under any other approval.

The property boundaries, easements and lot numbers shown herein may be proposed only and subject to registration by the Department of Natural Resources. All property information should be determined from the registered Survey Plans.

All dimensions should be verified and confirmed against the latest information prior to commencement by any person using this plan for building purposes.

Veris Australia Pty Ltd accepts no responsibility for any changes made to construction or otherwise, after the date of this plan. Any discrepancies should be clarified in writing with the relevant Authority prior to commencement of the work.

Copyright © Veris Australia Pty Ltd. February 2022  
 THESE DRAWINGS AND DIMENSIONS ARE COMPUTER GENERATED AND ARE NOT TO BE USED OR REPRODUCED WITHOUT THE WRITTEN PERMISSION OF VERIS.

Data Sources	30109-LC-Master(C)-F594-2014.dwg
Cadastral Boundaries	Veris
As-Constructed	Peeturban

Rev	Description	Date	Drawn
F	Progress Plan	04/02/2022	CUJ
E	Progress Plan	02/12/2021	JMS
D	Progress Plan	06/06/2021	JMS
C	Progress Plan	29/01/2021	JMS
B	Progress Plan	08/02/2021	JMS
A	Progress Plan	19/06/2021	JMS

Local Authority: LCC  
 Horizontal Meridian: MGA  
 Vertical Level Datum: AHD D  
 Level Origin: PA107142(RL39.078)  
 Scale: 1:250 @ A1  
 Surveyed: DE / CS  
 Designed: PISAKURBAN  
 Drawn: JMS  
 Checked: JMS  
 Plot Date: 04 Feb, 2022  
 Computer File Ref: 430109-12071-AS01-F MGA.dwg

**AS-CONSTRUCTED SEWER RETICULATION**  
 SHEET 4 OF 5

**veris**  
 BRISBANE (07) 366 4700 WHITSUNDAYS (07) 462 8700  
 MACKAY CAIRNS (07) 462 8700 (07) 4232 9400  
 veris.com.au  
 ACN 615 735 727  
 Veris Australia Pty Ltd

Drawing No. 430109-12071-AS01 F Issue

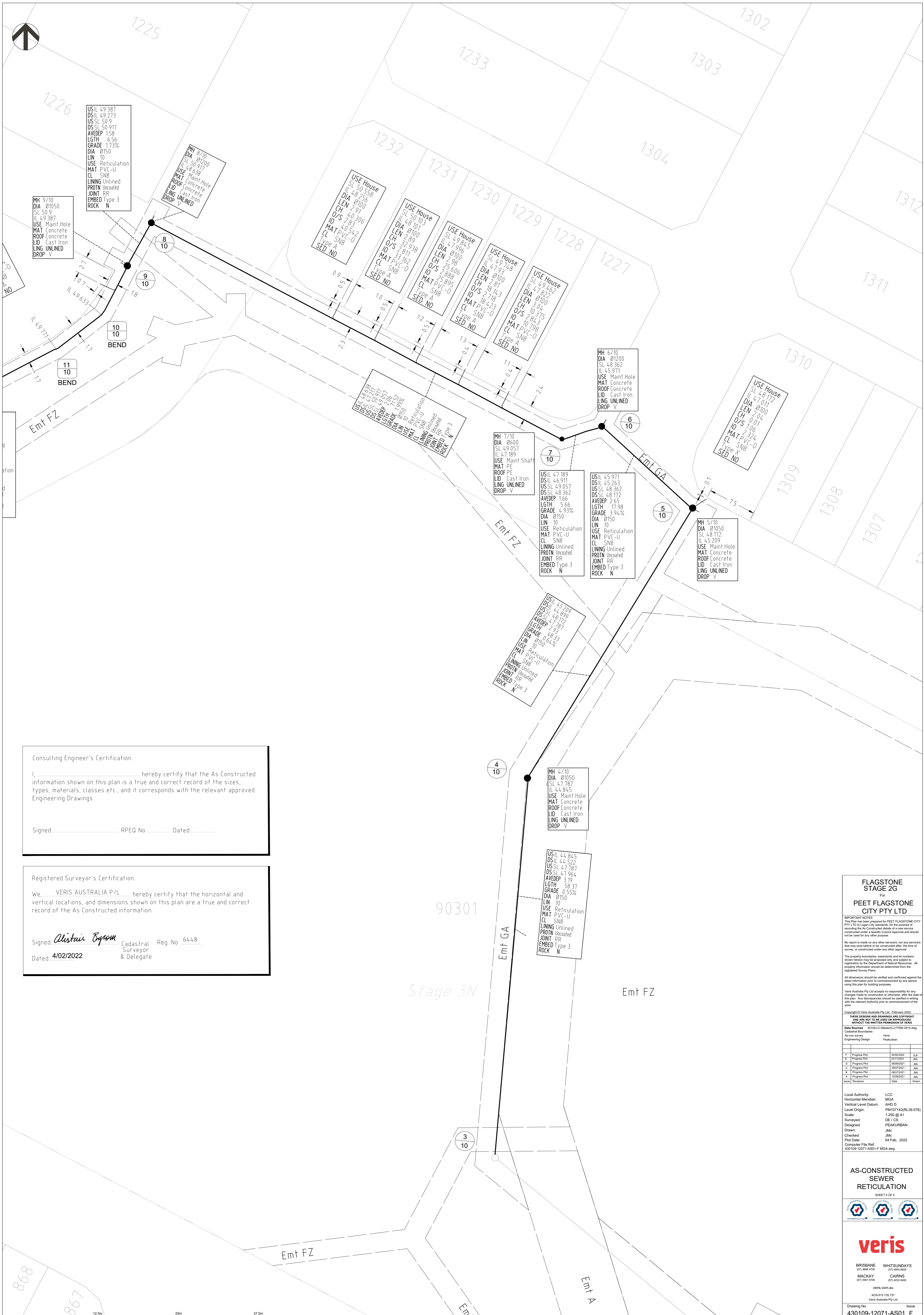

Consulting Engineer's Certification.

I, \_\_\_\_\_ hereby certify that the As Constructed information shown on this plan is a true and correct record of the sizes, types, materials, classes etc., and it corresponds with the relevant approved Engineering Drawings.

Signed \_\_\_\_\_ RPEQ No \_\_\_\_\_ Dated \_\_\_\_\_

Registered Surveyor's Certification.

We, VERIS AUSTRALIA P/L hereby certify that the horizontal and vertical locations, and dimensions shown on this plan are a true and correct record of the As Constructed information.

Signed *Alistair Byrom* Cadastral Reg No 6448  
 Dated 4/02/2022 Surveyor & Delegate

**FLAGSTONE STAGE 2G**  
 For  
**PEET FLAGSTONE CITY PTY LTD**

IMPORTANT NOTES:  
 This plan has been prepared for PEET FLAGSTONE CITY PTY LTD to Logon City standards for the purpose of recording the As Constructed details of a new service constructed under a specific Council Approval and should not be used for any other purpose.  
 No report is made on any other services, nor any services that may exist before or be constructed after, the time of survey, or constructed under any other approval.  
 The property boundaries, easements and lot numbers shown hereon may be proposed only and subject to registration by the Department of Natural Resources. All property information should be determined from the registered Survey Plans.  
 All dimensions should be verified and confirmed against the latest information prior to commencement by any person using this plan for building purposes.  
 Veris Australia Pty Ltd accepts no responsibility for any changes made to construction or otherwise, after the date of this plan. Any discrepancies should be clarified in writing with the relevant Authority prior to commencement of the work.  
 Copyright © Veris Australia Pty Ltd. February 2022  
 THESE DRAWINGS AND DATA ARE CONFIDENTIAL AND ARE NOT TO BE USED OR REPRODUCED WITHOUT THE WRITTEN PERMISSION OF VERIS  
 Data Sources 30109-LC Master (C) F594 2014.dwg  
 Cadastre Boundaries Veris  
 Engineering Design Presurban

Rev	Revision	Date	Drawn
F	Progress Pkz	04/02/2022	CAF
E	Progress Pkz	02/10/2021	JMC
D	Progress Pkz	06/06/2021	JMC
C	Progress Pkz	29/01/2021	JMC
B	Progress Pkz	08/02/2021	JMC
A	Progress Pkz	19/06/2021	JMC

Local Authority: LCC  
 Horizontal Meridian: MGA  
 Vertical Level Datum: AHD D  
 Level Origin: PA107142(RL39 078)  
 Scale: 1:250 @ A1  
 Surveyed: DE / CS  
 Designed: PISAKURBAN  
 Drawn: JMC  
 Checked: JMC  
 Plot Date: 04 Feb, 2022  
 Computer File Ref: 430109-12071-AS01-F MGA.dwg

**AS-CONSTRUCTED SEWER RETICULATION**  
 SHEET 5 OF 5

**veris**  
 BRISBANE (07) 3664 4700 WHITSUNDAYS (07) 4642 0600  
 MACKAY CAIRNS (07) 4667 8700 (07) 4232 9400  
 veris.com.au  
 ACN 615 735 727  
 Veris Australia Pty Ltd

Drawing No Issue  
 430109-12071-AS01 F

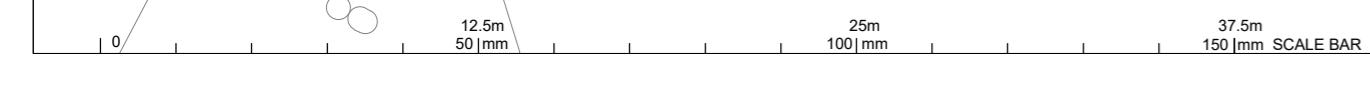



Consulting Engineer's Certification.

I, ..... hereby certify that the As Constructed information shown on this plan is a true and correct record of the sizes, types, materials, classes etc., and it corresponds with the relevant approved Engineering Drawings.

Signed..... RPEQ No ..... Dated.....

Registered Surveyor's Certification.

We, VERIS AUSTRALIA Pty Ltd, hereby certify that the horizontal and vertical locations, and dimensions shown on this plan are a true and correct record of the As Constructed information.

*Alistair Bryan*  
Signed..... Reg.No. 6448... Dated..... 9/05/2022

Cadastral Surveyor /Delegate



**FLAGSTONE STAGE 2G**  
**PEET FLAGSTONE CITY PTY LTD**

**IMPORTANT NOTES**  
This Plan has been prepared for PEET FLAGSTONE CITY PTY LTD in cooperation with the Council of the City of Ipswich for the purpose of recording the As Constructed details of a new service constructed under a specific Council Approval and should not be used for any other purpose.  
No report is made on any other services, nor any services that may exist before or be constructed after the time of survey, or constructed under any other approval.  
The property boundaries, easements and lot numbers shown herein may be proposed only and subject to registration by the Department of Natural Resources. All property information should be determined from the registered Survey Plans.  
All dimensions should be verified and confirmed against the latest information prior to commencement by any person using this plan for building purposes.  
Veris Australia Pty Ltd accepts no responsibility for any changes made to construction or otherwise, after the date of this plan. Any discrepancies should be clarified in writing with the relevant Authority prior to commencement of the work.

Copyright © Veris Australia Pty Ltd, January 2022

These drawings and drawings are copyright and are not to be used or reproduced without the written permission of Veris Australia Pty Ltd.

Drawn	Checked	Date	Drawn
D	JMC	04/05/2022	JMC
E	JMC	21/03/2022	JMC
B	CLP	03/02/2022	CLP
A	JMC	29/10/2021	JMC
Client	Veris		Member

Local Authority: LCC 01/01/2022 JMC  
Horizontal Meridian: MGA  
Vertical Level Datum: AHD D  
Level Origin: PM107142(RL98.078)  
Scale: 1:750 @ A1  
Surveyed: DE LIS  
Designed: MEINHARDT  
Drawn: JMC  
Checked: JMC  
Plot Date: 04 May, 2022  
Computer File Ref: 430109-12071-ASW01-D MGAS6.dwg

**AS-CONSTRUCTED STORMWATER**

SHEET 1 OF 4

**veris**

BRISBANE (07) 966 4700  
MACKAY (07) 4967 9700  
WHITSUNDAYS (07) 466 4600  
CAIRNS (07) 4322 9400

veris.com.au  
ACN 615 735 727  
Veris Australia Pty Ltd

Drawing No. 430109-12071-ASW01 D Issue

0026  
012  
01  
500  
2499  
2498  
2497  
2496  
2495  
2494  
2493  
2492  
2491  
2490  
2489  
2488  
2487  
86  
35

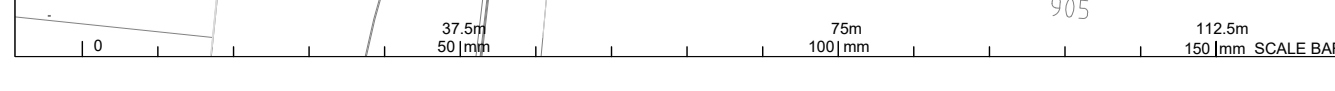

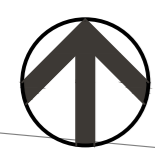

Consulting Engineer's Certification.

I, ..... hereby certify that the As Constructed information shown on this plan is a true and correct record of the sizes, types, materials, classes etc., and if corresponds with the relevant approved Engineering Drawings.

Signed..... RPEQ No ..... Dated.....

Registered Surveyor's Certification.

We, VERIS AUSTRALIA Pty Ltd, hereby certify that the horizontal and vertical locations, and dimensions shown on this plan are a true and correct record of the As Constructed information.

*Alistair Byron*  
Signed..... Reg.No. 64.48 Dated..... 9/05/2022  
Cadastral Surveyor /Delegate



**FLAGSTONE STAGE 2G**  
For  
**PEET FLAGSTONE CITY PTY LTD**

**IMPORTANT NOTES:**  
This Plan has been prepared for PEET FLAGSTONE CITY PTY LTD to Logan City standards, for the purpose of recording the As Constructed details of a new service constructed under a specific Council Approval and should not be used for any other purpose.  
No report is made on any other services, nor any services that may exist below or be constructed after, the time of survey, or constructed under any other approval.  
The property boundaries, easements and lot numbers shown herein may be proposed only and subject to registration by the Department of Natural Resources. All property information should be determined from the registered Survey Plans.  
All dimensions should be verified and confirmed against the latest information prior to commencement with the works.  
Veris Australia Pty Ltd accepts no responsibility for any changes made to construction or otherwise, after the date of this plan. Any discrepancies should be clarified in writing with the relevant Authority prior to commencement of the work.

Copyright © Veris Australia Pty Ltd. All rights reserved.  
THESE DESIGNS AND DRAWINGS ARE COPYRIGHT AND ARE NOT TO BE USED OR REPRODUCED WITHOUT THE WRITTEN PERMISSION OF VERIS.

Date Source: 30/10/14 C:\Master\CS\FSM4 2014.dwg  
Cadastral Boundaries: Veris  
As-on survey: Veris  
Engineering Design: Marshall

Rev	Description	Date	Drawn
D	Progress Plot	04/05/2022	JML
C	Progress Plot	13/03/2022	JML
B	Progress Plot	03/03/2022	CLP
A	Progress Plot	29/01/2021	JML
	Issued		Drawn

Local Authority: LCC  
Horizontal Meridian: MGA  
Vertical Level Datum: AHD D  
Level Origin: PM1107142(RL39.078)  
Scale: 1:250 @ A1  
Surveyed: DE /LS  
Designed: MEINHARDT  
Drawn: JML  
Checked: JML  
Plot Date: 04 May, 2022  
Computer File Ref: 430109-12071-ASW01-D MQAS6.dwg

**AS-CONSTRUCTED**  
**STORMWATER**

SHEET 2 OF 4

**veris**

BRISBANE 071 7864 4700  
MACKAY 071 4567 8700  
WHITSUNDAYS 071 4567 8700  
CAIRNS 071 4252 9400

veris.com.au  
ACN 616 736 727  
Veris Australia Pty Ltd

Drawing No 430109-12071-ASW01 D Issue

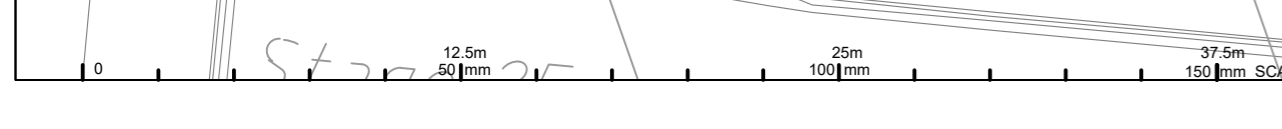

**Consulting Engineer's Certification.**

I, ..... hereby certify that the As Constructed information shown on this plan is a true and correct record of the sizes, types, materials, classes etc., and it corresponds with the relevant approved Engineering Drawings.

Signed..... RPEQ No ..... Dated.....

**Registered Surveyor's Certification.**

We, VERIS AUSTRALIA Pty Ltd hereby certify that the horizontal and vertical locations, and dimensions shown on this plan are a true and correct record of the As Constructed information.

*Alistair  
Byran*

Signed..... Reg.No 64448. Dated..... 9/05/2022

Cadastral Surveyor /Delegate

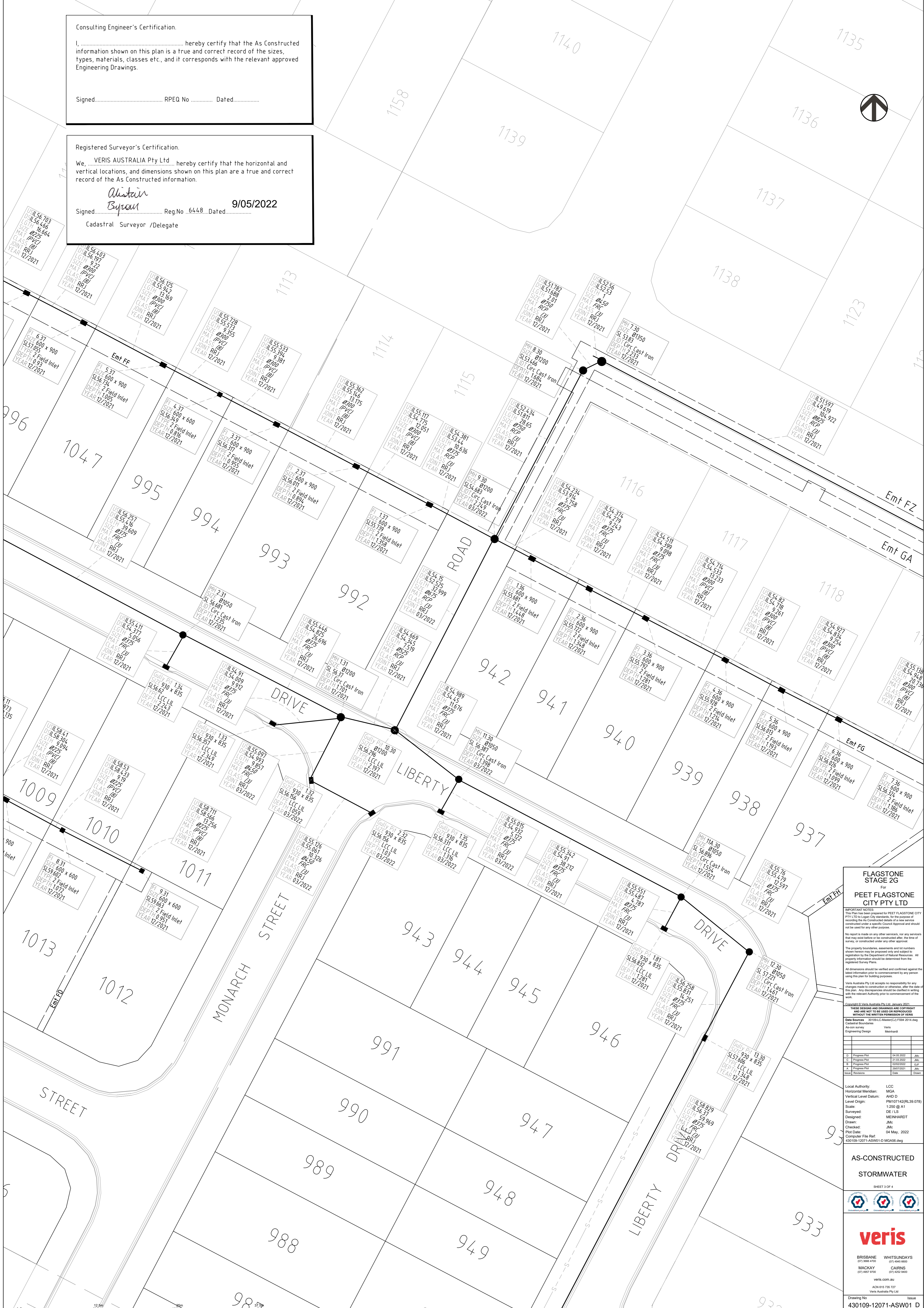
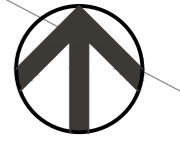

**FLAGSTONE STAGE 2G**  
For  
**PEET FLAGSTONE CITY PTY LTD**

**IMPORTANT NOTES:**  
This Plan has been prepared for PEET FLAGSTONE CITY PTY LTD to Logan City standards, for the purpose of recording the As Constructed information. It is a service constructed under a specific Council Approval and should not be used for any other purpose.  
No report is made on any other services, nor any services that may exist below or be constructed after, the time of survey, or constructed under any other approval.  
The property boundaries, assessments and lot numbers shown herein may be proposed only and subject to registration by the Department of Natural Resources. All property information should be determined from the registered Survey Plans.  
All dimensions should be verified and confirmed against the latest information prior to commencement by any person using this plan for building purposes.  
Veris Australia Pty Ltd accepts no responsibility for any changes made to construction or otherwise, after the date of this plan. Any discrepancies should be clarified in writing with the relevant Authority prior to commencement of the work.

Copyright © Veris Australia Pty Ltd. 2022  
THESE DESIGNS AND DRAWINGS ARE COPYRIGHT AND ARE NOT TO BE USED OR REPRODUCED WITHOUT THE WRITTEN PERMISSION OF VERIS

Date Source: 30/10/21-C-Master(C) FS04 2014.dwg  
Cadastral Boundary: .....  
As-on survey: Veris  
Engineering Design: Marshall

Revision	Description	Date	By	Check
D	Progress Plan	04/05/2022	JM	
C	Progress Plan	13/03/2022	JM	
B	Progress Plan	03/03/2022	CLP	
A	Progress Plan	28/01/2021	JM	
Issue	Revised	Issue	Issue	Issue

Local Authority: LCC  
Horizontal Meridian: MGA  
Vertical Level Datum: AHD D  
Level Origin: PM1107142(RL39.078)  
Scale: 1:250 @ A1  
Surveyed: DE /LS  
Designed: MEINHARDT  
Drawn: JM  
Checked: JM  
Plot Date: 04 May, 2022  
Computer File Ref: 430109-12071-ASW01-D MQAS6.dwg

**AS-CONSTRUCTED**  
**STORMWATER**  
SHEET 3 OF 4

BRISBANE 071 786 4700 WHITSUNDAYS 071 464 8000  
MACKAY 071 465 8700 CAIRNS 071 4252 9400  
veris.com.au  
ACN 615 735 727  
Veris Australia Pty Ltd

Drawing No 430109-12071-ASW01 D Issue

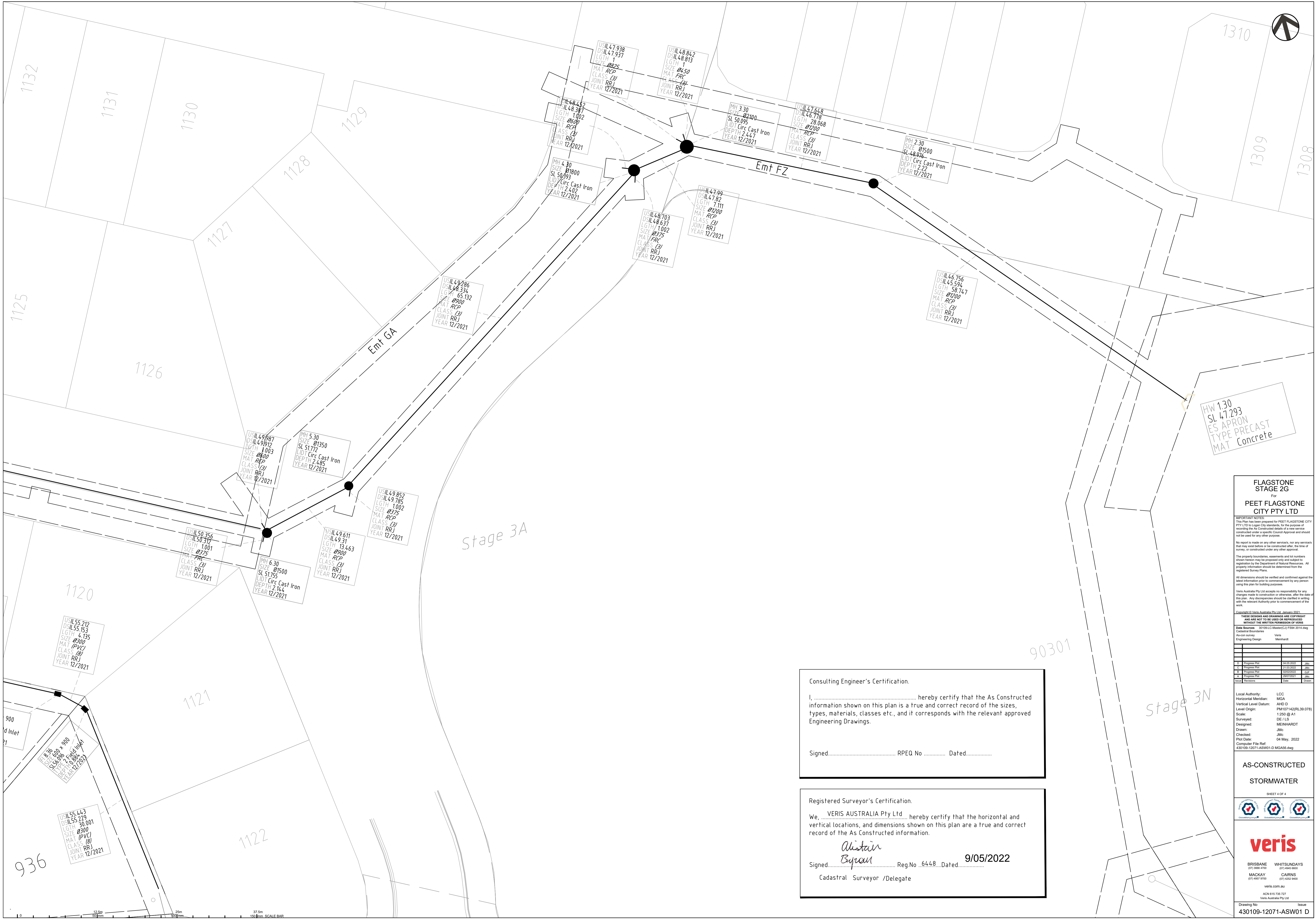

HW 130  
SL 47293  
ES APRON  
TYPE PRECAST  
MAT Concrete

**FLAGSTONE  
STAGE 2G**  
**PEET FLAGSTONE  
CITY PTY LTD**

**IMPORTANT NOTES:**  
This Plan has been prepared for PEET FLAGSTONE CITY PTY LTD in Logan City shire for the purpose of recording the As Constructed details of a new service considered under a specific Council Approval and should not be used for any other purpose.  
No report is made on any other services, nor any services that may exist before or be constructed after the time of survey, or constructed under any other approval.  
The property boundaries, assessments and lot numbers shown herein may be proposed only and subject to registration by the Department of Natural Resources. All property information should be determined from the registered Survey Plans.  
All dimensions should be verified and confirmed against the latest information prior to commencement by any person using this plan for building purposes.  
Veris Australia Pty Ltd accepts no responsibility for any changes made to construction or otherwise, after the date of this plan. Any discrepancies should be clarified in writing with the relevant Authority prior to commencement of the work.  
Copyright © Veris Australia Pty Ltd, January 2022  
THESE ISSUES AND DRAWINGS ARE COPYRIGHT AND ARE NOT TO BE USED OR REPRODUCED WITHOUT THE WRITTEN PERMISSION OF VERIS AUSTRALIA PTY LTD

Revision	Description	Date	By
0	Proposed Plan	04/05/2022	JM
1	As-Constructed	09/05/2022	JM

Local Authority: LCC  
Horizontal Meridian: MGA  
Vertical Level Datum: AHD D  
Level Origin: PM107142(RL98.078)  
Scale: 1:250 @ A1  
Surveyed: DE/LS  
Designed: MEINHARDT  
Drawn: JM  
Checked: JM  
Plot Date: 04 May, 2022  
Computer File Ref: 430109-12071-ASW01-D MGA56.dwg

**AS-CONSTRUCTED  
STORMWATER**

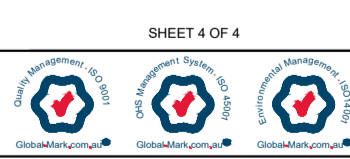

**veris**

BRISBANE (07) 9664 4700  
MACKAY (07) 4967 9700  
WHITSUNDAYS (07) 4664 6600  
CAIRNS (07) 4322 9400

veris.com.au  
ACN 615 735 727  
Veris Australia Pty Ltd

Drawing No. 430109-12071-ASW01 D Issue

Consulting Engineer's Certification.

I, ..... hereby certify that the As Constructed information shown on this plan is a true and correct record of the sizes, types, materials, classes etc., and it corresponds with the relevant approved Engineering Drawings.

Signed..... RPEQ No ..... Dated.....

Registered Surveyor's Certification.

We, VERIS AUSTRALIA Pty Ltd ..... hereby certify that the horizontal and vertical locations, and dimensions shown on this plan are a true and correct record of the As Constructed information.

*Alistair Byrnes*  
Signed..... Reg.No. 6448 ..... Dated..... 9/05/2022  
Cadastral Surveyor /Delegate

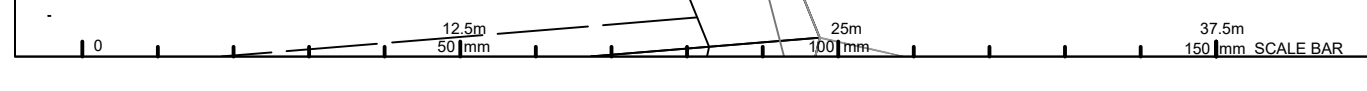



**SHEET 2**

**SHEET 3**

Consulting Engineer's Certification.

I, \_\_\_\_\_ hereby certify that the As Constructed information shown on this plan is a true and correct record of the sizes, types, materials, classes etc, and it corresponds with the relevant approved Engineering Drawings.

Signed..... RPEQ No ..... Dated.....

Registered Surveyor's Certification.

We, VERIS AUSTRALIA P/L, hereby certify that the horizontal and vertical locations, and dimensions shown on this plan are a true and correct record of the As Constructed information.

*Alistair Byron*

Signed..... Reg No. 6448 ..... Dated 22/04/2022 .....

Cadastral Surveyor / Delegate

**LEGEND**

6.25 ——— AS CONSTRUCTED CONTOURS (Interval 0.25m)

————— RETAINING WALL

**FLAGSTONE STAGE 2G**

**PEET FLAGSTONE CITY PTY LTD**

**IMPORTANT NOTES**

This Plan has been prepared for PEET FLAGSTONE CITY PTY LTD in cooperation with the Council for the purpose of recording the As Constructed details of a new service constructed under a specific Council Approval and should not be used for any other purpose.

No report is made on any other services, nor any services that may exist before or be constructed after the time of survey, or constructed under any other approval.

The property boundaries, easements and lot numbers shown herein may be proposed only and subject to registration by the Department of Natural Resources. All property information should be determined from the registered Survey Plans.

All dimensions should be verified and confirmed against the latest information prior to commencement by any person using this plan for building purposes.

Veris Australia Pty Ltd accepts no responsibility for any changes made to construction or otherwise, after the date of this plan. Any discrepancies should be clarified in writing with the relevant Authority prior to commencement of the work.

Copyright © Veris Australia Pty Ltd, January 2022.

THESE ISSUES AND DRAWINGS ARE COPYRIGHT AND ARE NOT TO BE USED OR REPRODUCED WITHOUT THE WRITTEN PERMISSION OF VERIS AUSTRALIA PTY LTD.

Data Sources: 30109-CC Master (C) FS# 2014.dwg  
 Cadastre: \_\_\_\_\_  
 As-con survey: Veris  
 Engineering Design: Veris

A	Progress File	03/02/2022	cu/p
B	Progress File	20/02/2021	JM
C	Revision	_____	Drawn

Local Authority: LCC  
 Horizontal Meridian: MGA  
 Vertical Level Datum: AHD D  
 Level Origin: PM107142(RL98.078)  
 Scale: 1:750 @ A1  
 Surveyed: DEJ/LIS  
 Designed: MEINHARDT  
 Drawn: JM  
 Checked: JM  
 Plot Date: 22 Apr, 2022  
 Computer File Ref: 430109-12071-AE01-A.dwg

**AS-CONSTRUCTED FINALSURFACE**

SHEET 1 OF 3

**veris**

BRISBANE (07) 966 4700  
 MACKAY (07) 4927 9700  
 WHITSUNDAYS (07) 4942 9400  
 CAIRNS (07) 4322 9400

veris.com.au  
 ACN 615 735 727  
 Veris Australia Pty Ltd

Drawing No. 430109-12071-AE01 Issue A



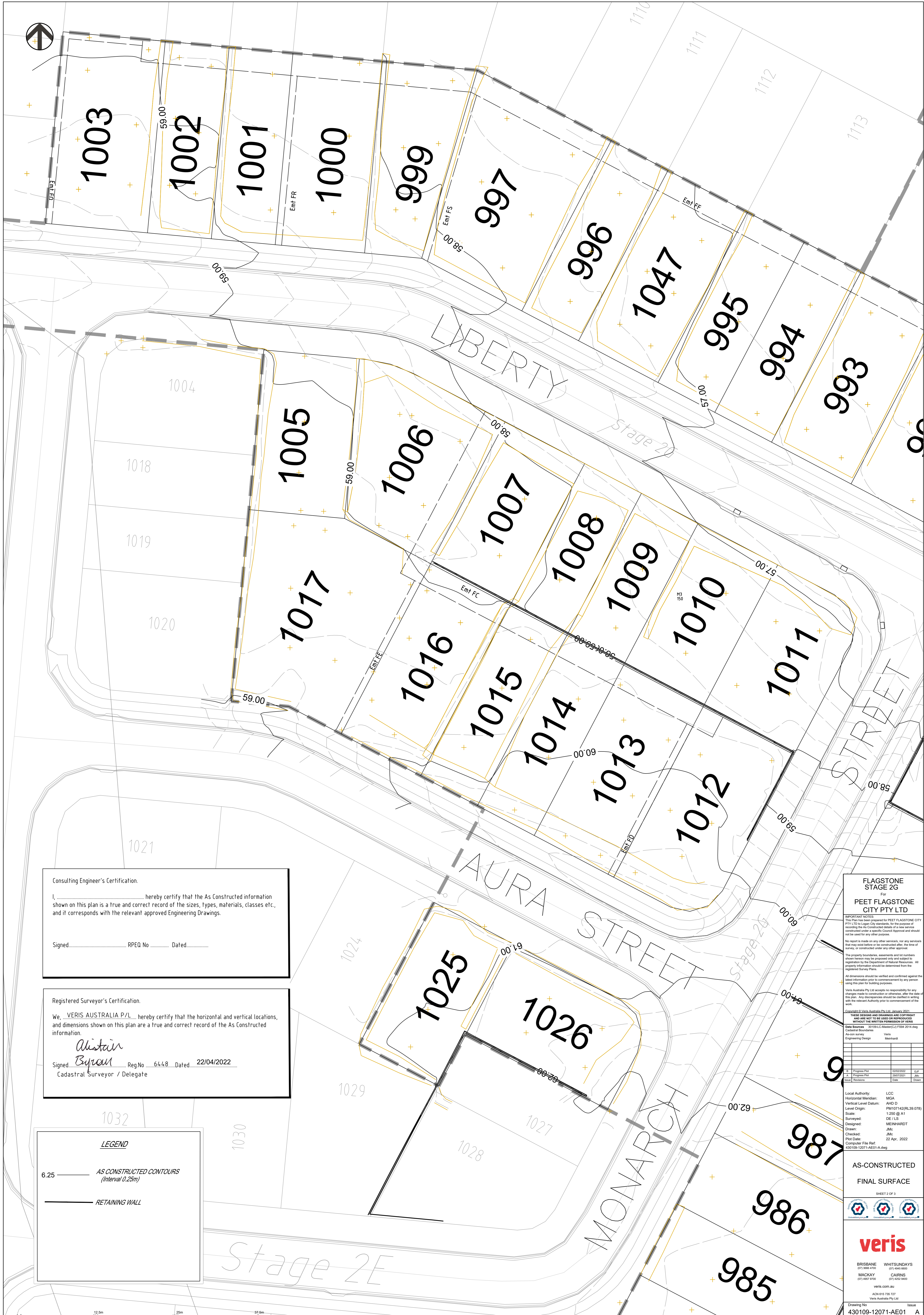

Consulting Engineer's Certification.

I, ..... hereby certify that the As Constructed information shown on this plan is a true and correct record of the sizes, types, materials, classes etc., and it corresponds with the relevant approved Engineering Drawings.

Signed..... RPEQ No..... Dated.....

Registered Surveyor's Certification.

We, VERIS AUSTRALIA P/L, hereby certify that the horizontal and vertical locations, and dimensions shown on this plan are a true and correct record of the As Constructed information.

*Alistair Byron*  
Signed..... Reg No..... 6448..... Dated..... 22/04/2022.....  
Cadastral Surveyor / Delegate

**LEGEND**

6.25 — AS CONSTRUCTED CONTOURS  
(Interval 0.25m)

— RETAINING WALL

**FLAGSTONE STAGE 2G**  
For  
**PEET FLAGSTONE CITY PTY LTD**

**IMPORTANT NOTES**  
This Plan has been prepared for PEET FLAGSTONE CITY PTY LTD to Logan City standards, for the purpose of recording the As Constructed details of a new service constructed under a specific Council Approval and should not be used for any other purpose.  
No report is made on any other services, nor any services that may exist before or be constructed after, the time of survey, or constructed under any other approval.  
The property boundaries, easements and lot numbers shown herein may be proposed only and subject to registration by the Department of Natural Resources. All property information should be determined from the registered Survey Plans.  
All dimensions should be verified and confirmed against the latest information prior to commencement by any person using this plan for building purposes.  
Veris Australia Pty Ltd accepts no responsibility for any changes made to construction or otherwise, after the date of this plan. Any discrepancies should be clarified in writing with the relevant Authority prior to commencement of the work.

Copyright © Veris Australia Pty Ltd, January 2022  
THESE DESIGNS AND DRAWINGS ARE COPYRIGHT AND ARE NOT TO BE USED OR REPRODUCED WITHOUT THE EXPRESS PERMISSION OF VERIS  
Date Source: 30/10/14 (C-Master) (FSM 2014.dwg)  
Cadastral Boundary: .....  
As-on survey: Veris  
Engineering Design: Marshall

8	Progress File	ES020202	CLP
9	Progress File	28012021	JAL
10	Progress File	.....	.....

Local Authority: LCC  
Horizontal Meridian: MGA  
Vertical Level Datum: AHD D  
Level Origin: PM107142(RL39.078)  
Scale: 1:250 @ A1  
Surveyed: DE / LS  
Designed: MEINHARDT  
Drawn: JM  
Checked: JM  
Plot Date: 22 Apr, 2022  
Computer File Ref: 430109-12071-AE01-A.dwg

**AS-CONSTRUCTED FINAL SURFACE**

SHEET 2 OF 3

**veris**

BRISBANE 071 366 4700 WHITSUNDAYS 071 464 8000  
MACKAY 071 465 8700 CAIRNS 071 4252 9400  
veris.com.au  
ACN 615 735 727  
Veris Australia Pty Ltd

Drawing No 430109-12071-AE01 Issue A

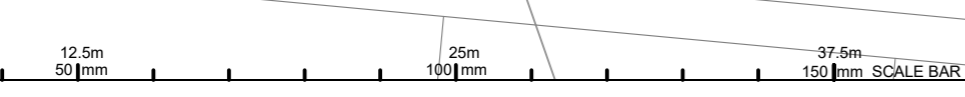

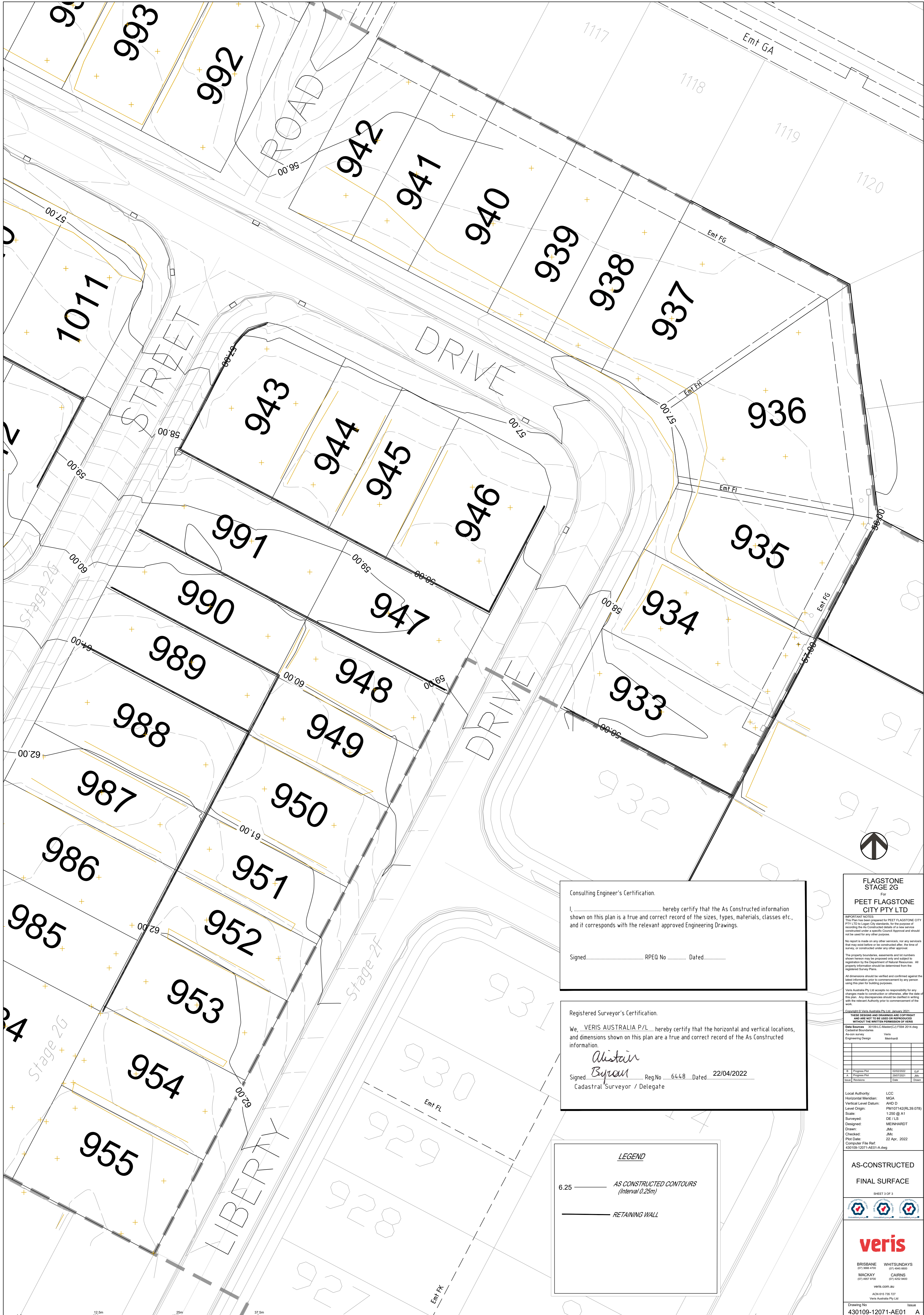

Consulting Engineer's Certification.

I, ..... hereby certify that the As Constructed information shown on this plan is a true and correct record of the sizes, types, materials, classes etc., and it corresponds with the relevant approved Engineering Drawings.

Signed..... RPEQ No ..... Dated.....

Registered Surveyor's Certification.

We, VERIS AUSTRALIA P/L, hereby certify that the horizontal and vertical locations, and dimensions shown on this plan are a true and correct record of the As Constructed information.

Signed *Alistair Bryan* Reg No ..... 6448 ..... Dated..... 22/04/2022  
 Cadastral Surveyor / Delegate

**LEGEND**

6.25 — AS CONSTRUCTED CONTOURS (Interval 0.25m)

— RETAINING WALL

**FLAGSTONE STAGE 2G**  
 For  
**PEET FLAGSTONE CITY PTY LTD**

**IMPORTANT NOTES**  
 This Plan has been prepared for PEET FLAGSTONE CITY PTY LTD to Logan City standards, for the purpose of recording the As Constructed details of a new service constructed under a specific Council Approval and should not be used for any other purpose.  
 No report is made on any other services, nor any services that may exist before or be constructed after, the time of survey, or constructed under any other approval.  
 The property boundaries, easements and lot numbers shown herein may be proposed only and subject to registration by the Department of Natural Resources. All property information should be determined from the registered Survey Plans.  
 All dimensions should be verified and confirmed against the latest information prior to commencement by any person using this plan for building purposes.  
 Veris Australia Pty Ltd accepts no responsibility for any changes made to construction or otherwise, after the date of this plan. Any discrepancies should be clarified in writing with the relevant Authority prior to commencement of the work.  
 Copyright © Veris Australia Pty Ltd, January 2022  
 THESE DESIGNS AND DRAWINGS ARE CONFIDENTIAL AND ARE NOT TO BE USED OR REPRODUCED WITHOUT THE WRITTEN PERMISSION OF VERIS.  
 Date Source: 30/10/14 C:\Master\CS\FS94 2014.dwg  
 Cadastral Boundary: Veris  
 As-on survey: Veris  
 Engineering Design: Markwell

B	Progress File	22/04/2022	CLP
A	Progress File	22/04/2022	JML
	Revised		Drawn

Local Authority: LCC  
 Horizontal Meridian: MGA  
 Vertical Level Datum: AHD D  
 Level Origin: PM107142(RL39.078)  
 Scale: 1:250 @ A1  
 Surveyed: DE / LS  
 Designed: MEINHARDT  
 Drawn: JML  
 Checked: JML  
 Plot Date: 22 Apr, 2022  
 Computer File Ref: 430109-12071-AE01-A.dwg

**AS-CONSTRUCTED**  
**FINAL SURFACE**

SHEET 3 OF 3

**veris**

BRISBANE 071 366 4100 WHITSUNDAYS 071 454 8000  
 MACKAY 071 465 8700 CAIRNS 071 4252 9400  
 veris.com.au  
 ACN 615 735 727  
 Veris Australia Pty Ltd

Drawing No 430109-12071-AE01 Issue A

