



Retaining Wall Lot 2361
 Min Height:- 1.5m
 Max Height:- 1.7m
 Average Height:- 1.6m

PROPOSED
 LOT 2380

Retaining Wall Lot 2361
 Min Height:- 0.7m
 Max Height:- 0.9m
 Average Height:- 0.8m

PROPOSED
 LOT 2379

PROPOSED
 LOT 2362

2361
 471m²

PANORAMA STREET

SANDY CREEK ROAD

ADDITIONAL NOTES:

The LOT dimensions and area shown hereon are subject to final field survey and also to the requirements of Council and any other authority which may have requirements under any relevant legislation

Final surface contours shown hereon have been supplied by Peak Urban.

Location of retaining walls are as shown on Engineering design drawings. Their as-constructed location may differ from their design location. Retaining wall heights have been supplied by Peak Urban. **The engineering detail shown hereon are preliminary only and are subject to change in final design and statutory approvals**

Compaction of any fill material placed on this site shall be completed to level one inspection and testing services in accordance with AS3798-2007.

Depth of fill values are calculated to the pre-development surface.
 Copyright © Veris Australia Pty Ltd
 17/02/2022.

**FLAGSTONE
 PRECINCT 1 STAGE 5A(i)**
 For
**PEET FLAGSTONE
 CITY PTY LTD**

IMPORTANT NOTES:
 (These notes are an integral part of this plan)

This plan has been prepared for **PEET FLAGSTONE CITY PTY LTD** for the purposes of **A Disclosure Plan Under the Land Sales Act 1984 (as amended)**.

It is not to be used by any other person or corporation or for any other purposes and is subject to the following limitations:

Please refer to the approved Development Application for conditions relating to the LOT and to approved Operational Works drawings for services location and possible easements.

THESE DESIGNS AND DRAWINGS ARE COPYRIGHT AND ARE NOT TO BE USED OR REPRODUCED WITHOUT THE WRITTEN PERMISSION OF VERIS

Data Sources
 Cadastral Boundaries
 30109-LC-Master(CU) FS94 2014.dwg
 Engineering Design
 FLAGSTONE - BASE - STAGE 5A 5B - DISCLOSURE INFO - 27 01 2022.dwg
 Final Surface Contours
 FLAGSTONE - BASE - STAGE 5A 5B - DISCLOSURE INFO - 27 01 2022.dwg
 Depth of Fill
 FLAGSTONE - DEPTH RANGE CONTOURS - STAGE 5A 5B - DISCLOSURE INFO - 27 01 2022.dwg

Issue	Revisions	Date	Drawn
A	Original	16.02.2022	BK

Locality: FLAGSTONE
 Local Authority: LOGAN CITY COUNCIL
 Horizontal Meridian: MGA, Zone 56
 Vertical Level Datum: AHD D
 Scale: 1:250 @ A4
 Designed: Peak Urban
 Drawn: BK 16/02/2022
 Checked: DE 17/02/2022
 Plot Date: 17 Feb, 2022
 Computer File Ref: 30109-St5A-DP-(A).dwg

DISCLOSURE PLAN
 of Proposed LOT 2361
 being part of
 Lot 911
 on SP321079



veris

BRISBANE WHITSUNDAYS
 (07) 3688 4700 (07) 4945 6600

MACKAY CAIRNS
 (07) 4957 9700 (07) 4252 9400

veris.com.au
 ACN 615 735 727
 Veris Australia Pty Ltd

Drawing No Issue
30109-DP- 2361 A

LEGEND

Final surface contours based on A.H.D. datum at an interval of 0.5m, shown as: 15.5

Where applicable, areas to be filled are shown as:

Depth of fill, in metres, shown as:- +0.5

Retaining wall and retaining wall height, shown on the lower side of the wall, have been taken from plans supplied by Peak Urban and shown as: (1.2)





Retaining Wall Lot 2362
 Min Height:- 2.4m
 Max Height:- 2.5m
 Average Height:- 2.45m

PROPOSED
 LOT 2378

PROPOSED
 LOT 2379

PROPOSED
 LOT 2380

PROPOSED
 LOT 2363

PROPOSED
 LOT 2361

2362
400m²

SANDY CREEK ROAD

LEGEND

Final surface contours based on A.H.D. datum at an interval of 0.5m, shown as: 15.5

Where applicable, areas to be filled are shown as:

Depth of fill, in metres, shown as:-

Retaining wall and retaining wall height, shown on the lower side of the wall, have been taken from plans supplied by Peak Urban and shown as:

(1.2)



ADDITIONAL NOTES:

The LOT dimensions and area shown hereon are subject to final field survey and also to the requirements of Council and any other authority which may have requirements under any relevant legislation

Final surface contours shown hereon have been supplied by Peak Urban.

Location of retaining walls are as shown on Engineering design drawings. Their as-constructed location may differ from their design location. Retaining wall heights have been supplied by Peak Urban. **The engineering detail shown hereon are preliminary only and are subject to change in final design and statutory approvals**

Compaction of any fill material placed on this site shall be completed to level one inspection and testing services in accordance with AS3798-2007.

Depth of fill values are calculated to the pre-development surface.
 Copyright © Veris Australia Pty Ltd
 17/02/2022.

**FLAGSTONE
 PRECINCT 1 STAGE 5A(i)**
 For
**PEET FLAGSTONE
 CITY PTY LTD**

IMPORTANT NOTES:
 (These notes are an integral part of this plan)

This plan has been prepared for **PEET FLAGSTONE CITY PTY LTD** for the purposes of **A Disclosure Plan Under the Land Sales Act 1984 (as amended)**.

It is not to be used by any other person or corporation or for any other purposes and is subject to the following limitations:

Please refer to the approved Development Application for conditions relating to the LOT and to approved Operational Works drawings for services location and possible easements.

THESE DESIGNS AND DRAWINGS ARE COPYRIGHT AND ARE NOT TO BE USED OR REPRODUCED WITHOUT THE WRITTEN PERMISSION OF VERIS

Data Sources
 Cadastral Boundaries
 30109-LC-Master(CU) F594 2014.dwg
 Engineering Design
 FLAGSTONE - BASE - STAGE 5A 5B - DISCLOSURE INFO - 27 01 2022.dwg
 Final Surface Contours
 FLAGSTONE - BASE - STAGE 5A 5B - DISCLOSURE INFO - 27 01 2022.dwg
 Depth of Fill
 FLAGSTONE - DEPTH RANGE CONTOURS - STAGE 5A 5B - DISCLOSURE INFO - 27 01 2022.dwg

Issue	Revisions	Date	BK	Drawn
A	Original	16.02.2022	BK	

Locality: FLAGSTONE
 Local Authority: LOGAN CITY COUNCIL
 Horizontal Meridian: MGA, Zone 56
 Vertical Level Datum: AHD D
 Scale: 1:250 @ A4
 Designed: Peak Urban
 Drawn: BK 16/02/2022
 Checked: DE 17/02/2022
 Plot Date: 17 Feb, 2022
 Computer File Ref: 30109-St5A-DP-(A).dwg

DISCLOSURE PLAN
 of Proposed LOT 2362
 being part of
 Lot 911
 on SP321079



veris

BRISBANE WHITSUNDAYS
 (07) 3666 4700 (07) 4945 6600

MACKAY CAIRNS
 (07) 4957 9700 (07) 4252 9400

veris.com.au
 ACN 615 735 727
 Veris Australia Pty Ltd

Drawing No Issue
30109-DP- 2362 A



Retaining Wall Lot 2363
 Min Height:- 2.5m
 Max Height:- 2.5m
 Average Height:- 2.5m

Retaining Wall Lot 2364
 Min Height:- 0.8m
 Max Height:- 0.8m
 Average Height:- 0.8m

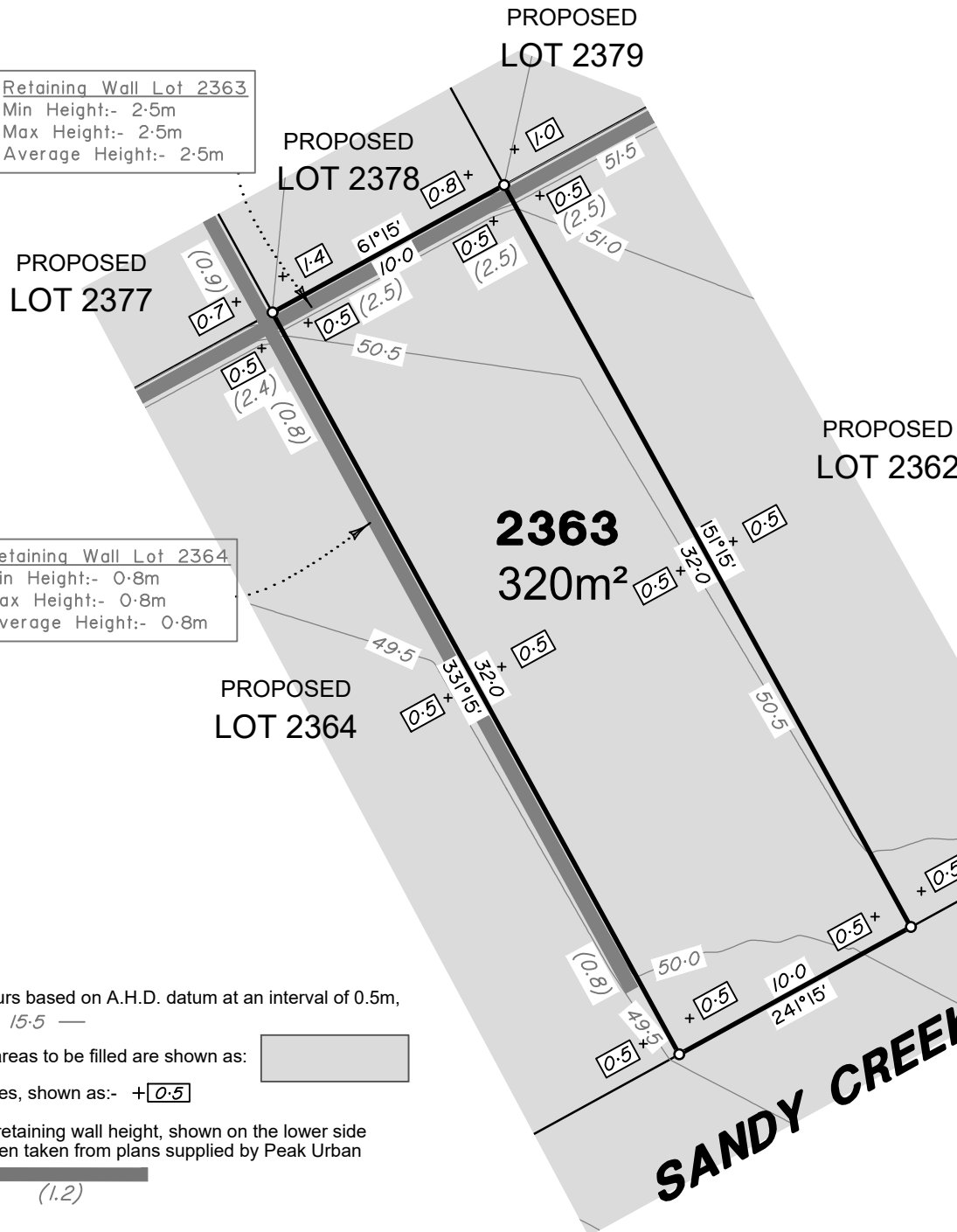

LEGEND

Final surface contours based on A.H.D. datum at an interval of 0.5m, shown as: 15.5

Where applicable, areas to be filled are shown as:

Depth of fill, in metres, shown as:- +0.5

Retaining wall and retaining wall height, shown on the lower side of the wall, have been taken from plans supplied by Peak Urban and shown as: (1.2)



ADDITIONAL NOTES:

The LOT dimensions and area shown hereon are subject to final field survey and also to the requirements of Council and any other authority which may have requirements under any relevant legislation

Final surface contours shown hereon have been supplied by Peak Urban.

Location of retaining walls are as shown on Engineering design drawings. Their as-constructed location may differ from their design location. Retaining wall heights have been supplied by Peak Urban. **The engineering detail shown hereon are preliminary only and are subject to change in final design and statutory approvals**

Compaction of any fill material placed on this site shall be completed to level one inspection and testing services in accordance with AS3798-2007.

Depth of fill values are calculated to the pre-development surface.
 Copyright © Veris Australia Pty Ltd
 17/02/2022.

FLAGSTONE
 PRECINCT 1 STAGE 5A(i)
 For
 PEET FLAGSTONE
 CITY PTY LTD

IMPORTANT NOTES:
 (These notes are an integral part of this plan)

This plan has been prepared for PEET FLAGSTONE CITY PTY LTD for the purposes of a Disclosure Plan Under the Land Sales Act 1984 (as amended).

It is not to be used by any other person or corporation or for any other purposes and is subject to the following limitations:

Please refer to the approved Development Application for conditions relating to the LOT and to approved Operational Works drawings for services location and possible easements.

THESE DESIGNS AND DRAWINGS ARE COPYRIGHT AND ARE NOT TO BE USED OR REPRODUCED WITHOUT THE WRITTEN PERMISSION OF VERIS

Data Sources
 Cadastral Boundaries
 30109-LC-Master(CU) F594 2014.dwg
 Engineering Design
 FLAGSTONE - BASE - STAGE 5A 5B - DISCLOSURE INFO - 27 01 2022.dwg
 Final Surface Contours
 FLAGSTONE - BASE - STAGE 5A 5B - DISCLOSURE INFO - 27 01 2022.dwg
 Depth of Fill
 FLAGSTONE - DEPTH RANGE CONTOURS - STAGE 5A 5B - DISCLOSURE INFO - 27 01 2022.dwg

Issue	Revisions	Date	Drawn
A	Original	16.02.2022	BK

Locality: FLAGSTONE
 Local Authority: LOGAN CITY COUNCIL
 Horizontal Meridian: MGA, Zone 56
 Vertical Level Datum: AHD D
 Scale: 1:250 @ A4
 Designed: Peak Urban
 Drawn: BK 16/02/2022
 Checked: DE 17/02/2022
 Plot Date: 17 Feb, 2022
 Computer File Ref: 30109-St5A-DP-(A).dwg

DISCLOSURE PLAN
 of Proposed LOT 2363
 being part of
 Lot 911
 on SP321079



veris

BRISBANE WHITSUNDAYS
 (07) 3668 4700 (07) 4945 6600

MACKAY CAIRNS
 (07) 4957 9700 (07) 4252 9400

veris.com.au
 ACN 615 735 727
 Veris Australia Pty Ltd

Drawing No Issue
 30109-DP- 2363 A



Retaining Wall Lot 2364
 Min Height:- 2.4m
 Max Height:- 2.5m
 Average Height:- 2.45m

PROPOSED
 LOT 2376

PROPOSED
 LOT 2377

PROPOSED
 LOT 2378

PROPOSED
 LOT 2363

PROPOSED
 LOT 2365

2364
 448m²

Retaining Wall Lot 2364
 Min Height:- 0.8m
 Max Height:- 0.8m
 Average Height:- 0.18m

ADDITIONAL NOTES:

The LOT dimensions and area shown hereon are subject to final field survey and also to the requirements of Council and any other authority which may have requirements under any relevant legislation

Final surface contours shown hereon have been supplied by Peak Urban.

Location of retaining walls are as shown on Engineering design drawings. Their as-constructed location may differ from their design location. Retaining wall heights have been supplied by Peak Urban. **The engineering detail shown hereon are preliminary only and are subject to change in final design and statutory approvals**

Compaction of any fill material placed on this site shall be completed to level one inspection and testing services in accordance with AS3798-2007.

Depth of fill values are calculated to the pre-development surface.
 Copyright © Veris Australia Pty Ltd
 17/02/2022.

FLAGSTONE
 PRECINCT 1 STAGE 5A(i)
 For
 PEET FLAGSTONE
 CITY PTY LTD

IMPORTANT NOTES:
 (These notes are an integral part of this plan)

This plan has been prepared for PEET FLAGSTONE CITY PTY LTD for the purposes of a Disclosure Plan Under the Land Sales Act 1984 (as amended).

It is not to be used by any other person or corporation or for any other purposes and is subject to the following limitations:

Please refer to the approved Development Application for conditions relating to the LOT and to approved Operational Works drawings for services location and possible easements.

THESE DESIGNS AND DRAWINGS ARE COPYRIGHT AND ARE NOT TO BE USED OR REPRODUCED WITHOUT THE WRITTEN PERMISSION OF VERIS

Data Sources
 Cadastral Boundaries
 30109-LC-Master(CU) F594 2014.dwg
 Engineering Design
 FLAGSTONE - BASE - STAGE 5A 5B - DISCLOSURE INFO - 27 01 2022.dwg
 Final Surface Contours
 FLAGSTONE - BASE - STAGE 5A 5B - DISCLOSURE INFO - 27 01 2022.dwg
 Depth of Fill
 FLAGSTONE - DEPTH RANGE CONTOURS - STAGE 5A 5B - DISCLOSURE INFO - 27 01 2022.dwg

Issue	Revisions	Date	BK	Drawn
A	Original	16.02.2022	BK	

Locality: FLAGSTONE
 Local Authority: LOGAN CITY COUNCIL
 Horizontal Meridian: MGA, Zone 56
 Vertical Level Datum: AHD D
 Scale: 1:250 @ A4
 Designed: Peak Urban
 Drawn: BK 16/02/2022
 Checked: DE 17/02/2022
 Plot Date: 17 Feb, 2022
 Computer File Ref: 30109-St5A-DP-(A).dwg

DISCLOSURE PLAN
 of Proposed LOT 2364
 being part of
 Lot 911
 on SP321079



veris

BRISBANE WHITSUNDAYS
 (07) 3666 4700 (07) 4945 6600

MACKAY CAIRNS
 (07) 4957 9700 (07) 4252 9400

veris.com.au
 ACN 615 735 727
 Veris Australia Pty Ltd

Drawing No Issue
 30109-DP- 2364 A

LEGEND

Final surface contours based on A.H.D. datum at an interval of 0.5m, shown as: 15.5

Where applicable, areas to be filled are shown as:

Depth of fill, in metres, shown as:- +0.5

Retaining wall and retaining wall height, shown on the lower side of the wall, have been taken from plans supplied by Peak Urban and shown as:



SANDY CREEK ROAD

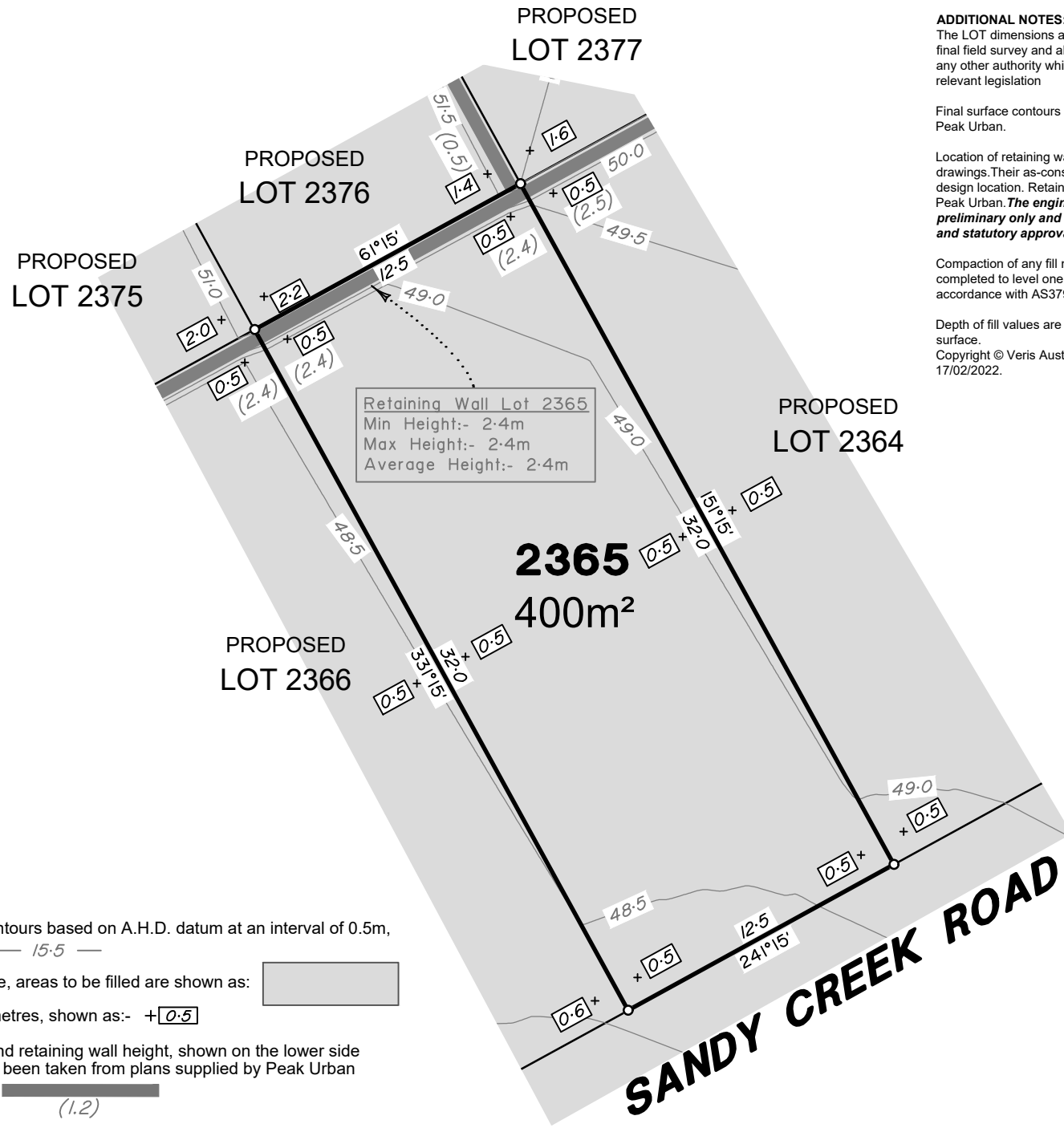

LEGEND

Final surface contours based on A.H.D. datum at an interval of 0.5m, shown as: 15.5

Where applicable, areas to be filled are shown as:

Depth of fill, in metres, shown as:- +0.5

Retaining wall and retaining wall height, shown on the lower side of the wall, have been taken from plans supplied by Peak Urban and shown as: (1.2)



ADDITIONAL NOTES:

The LOT dimensions and area shown hereon are subject to final field survey and also to the requirements of Council and any other authority which may have requirements under any relevant legislation

Final surface contours shown hereon have been supplied by Peak Urban.

Location of retaining walls are as shown on Engineering design drawings. Their as-constructed location may differ from their design location. Retaining wall heights have been supplied by Peak Urban. **The engineering detail shown hereon are preliminary only and are subject to change in final design and statutory approvals**

Compaction of any fill material placed on this site shall be completed to level one inspection and testing services in accordance with AS3798-2007.

Depth of fill values are calculated to the pre-development surface.

Copyright © Veris Australia Pty Ltd
17/02/2022.

FLAGSTONE PRECINCT 1 STAGE 5A(i) For PEET FLAGSTONE CITY PTY LTD

IMPORTANT NOTES:

(These notes are an integral part of this plan)

This plan has been prepared for PEET FLAGSTONE CITY PTY LTD for the purposes of a Disclosure Plan Under the Land Sales Act 1984 (as amended).

It is not to be used by any other person or corporation or for any other purposes and is subject to the following limitations:

Please refer to the approved Development Application for conditions relating to the LOT and to approved Operational Works drawings for services location and possible easements.

THESE DESIGNS AND DRAWINGS ARE COPYRIGHT AND ARE NOT TO BE USED OR REPRODUCED WITHOUT THE WRITTEN PERMISSION OF VERIS

Data Sources
Cadastral Boundaries
30109-LC-Master(CU) F594 2014.dwg
Engineering Design
FLAGSTONE - BASE - STAGE 5A 5B - DISCLOSURE INFO - 27 01 2022.dwg
Final Surface Contours
FLAGSTONE - BASE - STAGE 5A 5B - DISCLOSURE INFO - 27 01 2022.dwg
Depth of Fill
FLAGSTONE - DEPTH RANGE CONTOURS - STAGE 5A 5B - DISCLOSURE INFO - 27 01 2022.dwg

Issue	Revisions	Date	BK	Drawn
A	Original	16.02.2022	BK	

Locality: FLAGSTONE
Local Authority: LOGAN CITY COUNCIL
Horizontal Meridian: MGA, Zone 56
Vertical Level Datum: AHD D
Scale: 1:250 @ A4
Designed: Peak Urban
Drawn: BK 16/02/2022
Checked: DE 17/02/2022
Plot Date: 17 Feb, 2022
Computer File Ref: 30109-St5A-DP-(A).dwg

DISCLOSURE PLAN of Proposed LOT 2365 being part of Lot 911 on SP321079



veris

BRISBANE (07) 3666 4700 WHITSUNDAYS (07) 4945 6600

MACKAY (07) 4957 9700 CAIRNS (07) 4252 9400

veris.com.au
ACN 615 735 727
Veris Australia Pty Ltd

Drawing No Issue
30109-DP- 2365 A



Retaining Wall Lot 2366
 Min Height:- 2.4m
 Max Height:- 2.4m
 Average Height:- 2.4m



LEGEND

Final surface contours based on A.H.D. datum at an interval of 0.5m, shown as: 15.5

Where applicable, areas to be filled are shown as:

Depth of fill, in metres, shown as:- +0.5

Retaining wall and retaining wall height, shown on the lower side of the wall, have been taken from plans supplied by Peak Urban and shown as: (1.2)

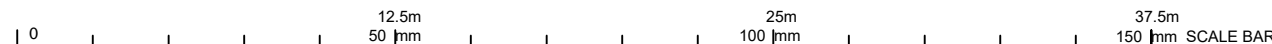

ADDITIONAL NOTES:

The LOT dimensions and area shown hereon are subject to final field survey and also to the requirements of Council and any other authority which may have requirements under any relevant legislation

Final surface contours shown hereon have been supplied by Peak Urban.

Location of retaining walls are as shown on Engineering design drawings. Their as-constructed location may differ from their design location. Retaining wall heights have been supplied by Peak Urban. **The engineering detail shown hereon are preliminary only and are subject to change in final design and statutory approvals**

Compaction of any fill material placed on this site shall be completed to level one inspection and testing services in accordance with AS3798-2007.

Depth of fill values are calculated to the pre-development surface.
 Copyright © Veris Australia Pty Ltd
 17/02/2022.

**FLAGSTONE
 PRECINCT 1 STAGE 5A(i)**
 For
**PEET FLAGSTONE
 CITY PTY LTD**

IMPORTANT NOTES:
 (These notes are an integral part of this plan)

This plan has been prepared for PEET FLAGSTONE CITY PTY LTD for the purposes of a Disclosure Plan Under the Land Sales Act 1984 (as amended).

It is not to be used by any other person or corporation or for any other purposes and is subject to the following limitations:

Please refer to the approved Development Application for conditions relating to the LOT and to approved Operational Works drawings for services location and possible easements.

THESE DESIGNS AND DRAWINGS ARE COPYRIGHT AND ARE NOT TO BE USED OR REPRODUCED WITHOUT THE WRITTEN PERMISSION OF VERIS

Data Sources
 Cadastral Boundaries
 30109-LC-Master(CU) F594 2014.dwg
 Engineering Design
 FLAGSTONE - BASE - STAGE 5A 5B - DISCLOSURE INFO - 27 01 2022.dwg
 Final Surface Contours
 FLAGSTONE - BASE - STAGE 5A 5B - DISCLOSURE INFO - 27 01 2022.dwg
 Depth of Fill
 FLAGSTONE - DEPTH RANGE CONTOURS - STAGE 5A 5B - DISCLOSURE INFO - 27 01 2022.dwg

Issue	Revisions	Date	Drawn
A	Original	16.02.2022	BK

Locality: FLAGSTONE
 Local Authority: LOGAN CITY COUNCIL
 Horizontal Meridian: MGA, Zone 56
 Vertical Level Datum: AHD D
 Scale: 1:250 @ A4
 Designed: Peak Urban
 Drawn: BK 16/02/2022
 Checked: DE 17/02/2022
 Plot Date: 17 Feb, 2022
 Computer File Ref: 30109-St5A1-DP-(A).dwg

DISCLOSURE PLAN
 of Proposed LOT 2366
 being part of
 Lot 911
 on SP321079



veris

BRISBANE WHITSUNDAYS
 (07) 3666 4700 (07) 4945 6600

MACKAY CAIRNS
 (07) 4957 9700 (07) 4252 9400

veris.com.au
 ACN 615 735 727
 Veris Australia Pty Ltd

Drawing No Issue
30109-DP- 2366 A



Retaining Wall Lot 2367
 Min Height:- 2.4m
 Max Height:- 2.4m
 Average Height:- 2.4m

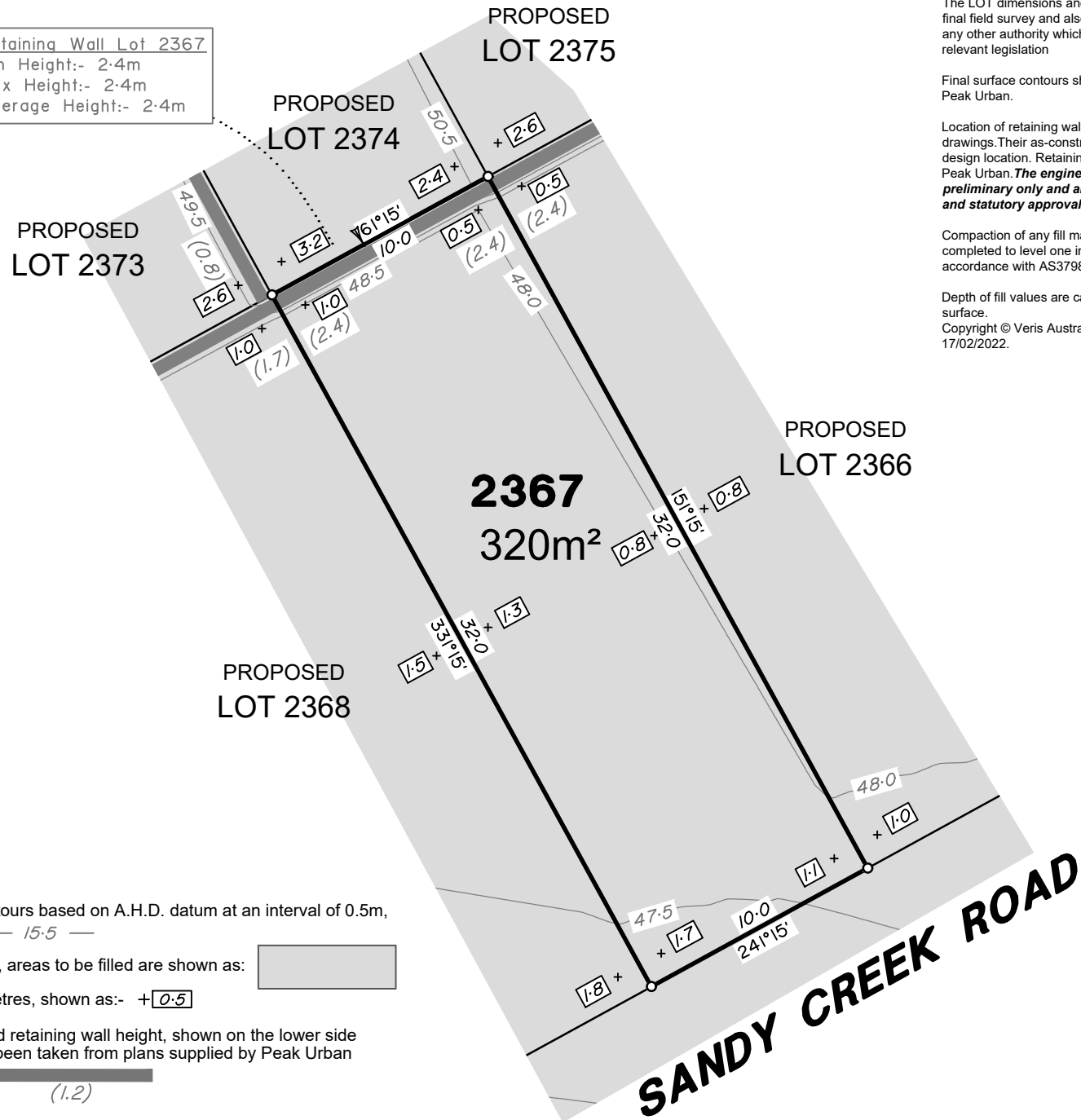

LEGEND

Final surface contours based on A.H.D. datum at an interval of 0.5m, shown as: 15.5

Where applicable, areas to be filled are shown as:

Depth of fill, in metres, shown as:- + 0.5

Retaining wall and retaining wall height, shown on the lower side of the wall, have been taken from plans supplied by Peak Urban and shown as: (1.2)



ADDITIONAL NOTES:

The LOT dimensions and area shown hereon are subject to final field survey and also to the requirements of Council and any other authority which may have requirements under any relevant legislation

Final surface contours shown hereon have been supplied by Peak Urban.

Location of retaining walls are as shown on Engineering design drawings. Their as-constructed location may differ from their design location. Retaining wall heights have been supplied by Peak Urban. **The engineering detail shown hereon are preliminary only and are subject to change in final design and statutory approvals**

Compaction of any fill material placed on this site shall be completed to level one inspection and testing services in accordance with AS3798-2007.

Depth of fill values are calculated to the pre-development surface.
 Copyright © Veris Australia Pty Ltd
 17/02/2022.

FLAGSTONE
 PRECINCT 1 STAGE 5A(i)
 For
 PEET FLAGSTONE
 CITY PTY LTD

IMPORTANT NOTES:
 (These notes are an integral part of this plan)

This plan has been prepared for PEET FLAGSTONE CITY PTY LTD for the purposes of a **Disclosure Plan Under the Land Sales Act 1984 (as amended)**.

It is not to be used by any other person or corporation or for any other purposes and is subject to the following limitations:

Please refer to the approved Development Application for conditions relating to the LOT and to approved Operational Works drawings for services location and possible easements.

THESE DESIGNS AND DRAWINGS ARE COPYRIGHT AND ARE NOT TO BE USED OR REPRODUCED WITHOUT THE WRITTEN PERMISSION OF VERIS

Data Sources
 Cadastral Boundaries
 30109-LC-Master(CU) F594 2014.dwg
 Engineering Design
 FLAGSTONE - BASE - STAGE 5A 5B - DISCLOSURE INFO - 27 01 2022.dwg
 Final Surface Contours
 FLAGSTONE - BASE - STAGE 5A 5B - DISCLOSURE INFO - 27 01 2022.dwg
 Depth of Fill
 FLAGSTONE - DEPTH RANGE CONTOURS - STAGE 5A 5B - DISCLOSURE INFO - 27 01 2022.dwg

Issue	Revisions	Date	BK	Drawn
A	Original	16.02.2022	BK	

Locality: FLAGSTONE
 Local Authority: LOGAN CITY COUNCIL
 Horizontal Meridian: MGA, Zone 56
 Vertical Level Datum: AHD D
 Scale: 1:250 @ A4
 Designed: Peak Urban
 Drawn: BK 16/02/2022
 Checked: DE 17/02/2022
 Plot Date: 17 Feb, 2022
 Computer File Ref: 30109-St5Ai-DP-(A).dwg

DISCLOSURE PLAN
 of Proposed LOT 2367
 being part of
 Lot 911
 on SP321079



veris

BRISBANE WHITSUNDAYS
 (07) 3666 4700 (07) 4945 6600

MACKAY CAIRNS
 (07) 4957 9700 (07) 4252 9400

veris.com.au
 ACN 615 735 727
 Veris Australia Pty Ltd

Drawing No Issue
 30109-DP- 2367 A

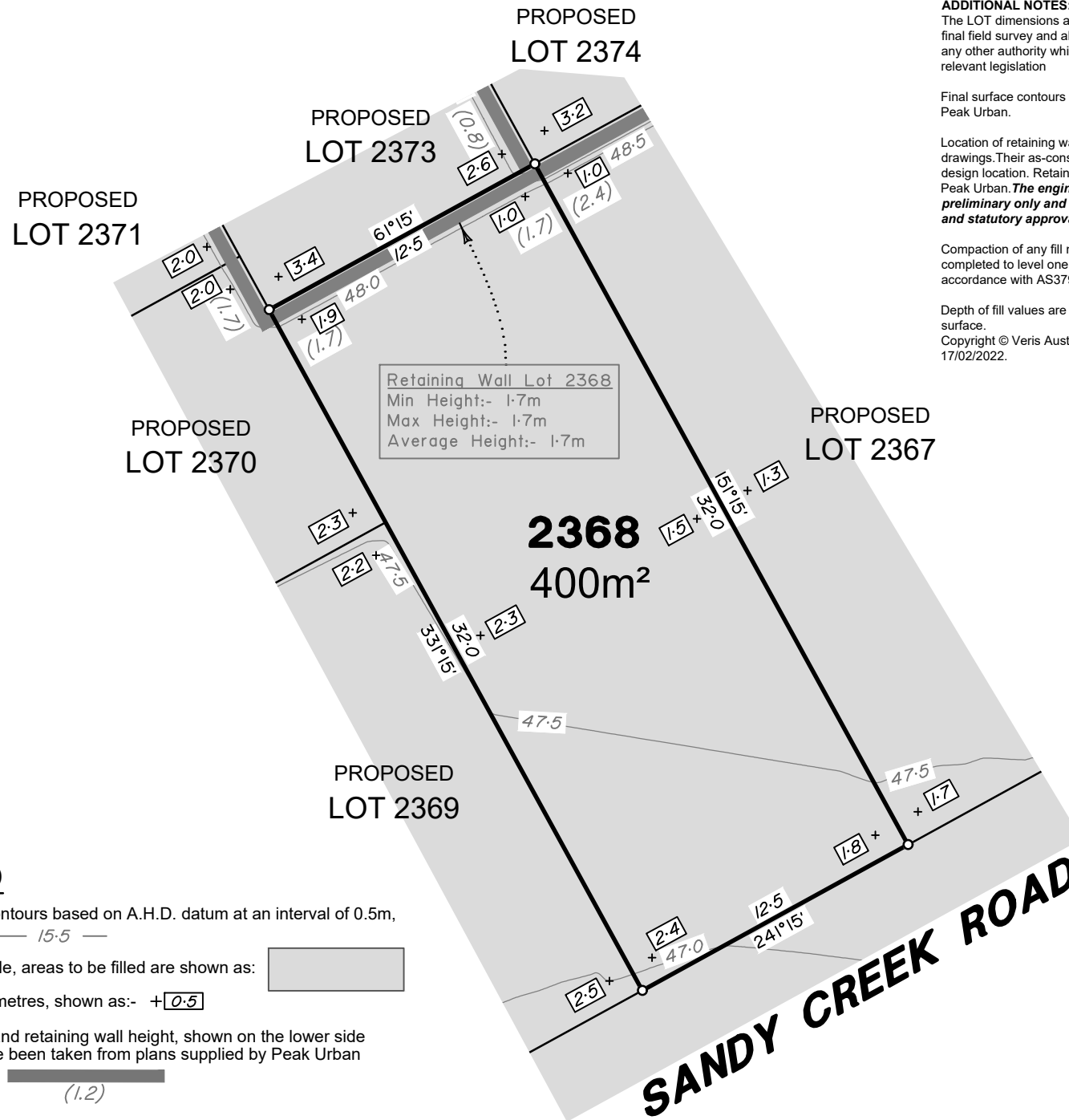

LEGEND

Final surface contours based on A.H.D. datum at an interval of 0.5m, shown as: 15.5

Where applicable, areas to be filled are shown as:

Depth of fill, in metres, shown as:- + 0.5

Retaining wall and retaining wall height, shown on the lower side of the wall, have been taken from plans supplied by Peak Urban and shown as: (1.2)



ADDITIONAL NOTES:

The LOT dimensions and area shown hereon are subject to final field survey and also to the requirements of Council and any other authority which may have requirements under any relevant legislation

Final surface contours shown hereon have been supplied by Peak Urban.

Location of retaining walls are as shown on Engineering design drawings. Their as-constructed location may differ from their design location. Retaining wall heights have been supplied by Peak Urban. **The engineering detail shown hereon are preliminary only and are subject to change in final design and statutory approvals**

Compaction of any fill material placed on this site shall be completed to level one inspection and testing services in accordance with AS3798-2007.

Depth of fill values are calculated to the pre-development surface.
Copyright © Veris Australia Pty Ltd
17/02/2022.

FLAGSTONE PRECINCT 1 STAGE 5A(i) For PEET FLAGSTONE CITY PTY LTD

IMPORTANT NOTES: (These notes are an integral part of this plan)

This plan has been prepared for PEET FLAGSTONE CITY PTY LTD for the purposes of a Disclosure Plan Under the Land Sales Act 1984 (as amended).

It is not to be used by any other person or corporation or for any other purposes and is subject to the following limitations:

Please refer to the approved Development Application for conditions relating to the LOT and to approved Operational Works drawings for services location and possible easements.

THESE DESIGNS AND DRAWINGS ARE COPYRIGHT AND ARE NOT TO BE USED OR REPRODUCED WITHOUT THE WRITTEN PERMISSION OF VERIS

Data Sources
Cadastral Boundaries
30109-LC-Master(CU) F594 2014.dwg
Engineering Design
FLAGSTONE - BASE - STAGE 5A 5B - DISCLOSURE INFO - 27 01 2022.dwg
Final Surface Contours
FLAGSTONE - BASE - STAGE 5A 5B - DISCLOSURE INFO - 27 01 2022.dwg
Depth of Fill
FLAGSTONE - DEPTH RANGE CONTOURS - STAGE 5A 5B - DISCLOSURE INFO - 27 01 2022.dwg

Issue	Revisions	Date	BK	Drawn
A	Original	16.02.2022	BK	

Locality: FLAGSTONE
Local Authority: LOGAN CITY COUNCIL
Horizontal Meridian: MGA, Zone 56
Vertical Level Datum: AHD D
Scale: 1:250 @ A4
Designed: Peak Urban
Drawn: BK 16/02/2022
Checked: DE 17/02/2022
Plot Date: 17 Feb, 2022
Computer File Ref: 30109-St5A-DP-(A).dwg

DISCLOSURE PLAN
of Proposed LOT 2368
being part of
Lot 911
on SP321079



veris

BRISBANE WHITSUNDAYS
(07) 3666 4700 (07) 4945 6600

MACKAY CAIRNS
(07) 4957 9700 (07) 4252 9400

veris.com.au
ACN 615 735 727
Veris Australia Pty Ltd

Drawing No Issue
30109-DP- 2368 A



SANDY CREEK ROAD

SANDY CREEK ROAD

PROPOSED
LOT 2370

PROPOSED
LOT 2368

2369
604m²

ADDITIONAL NOTES:

The LOT dimensions and area shown hereon are subject to final field survey and also to the requirements of Council and any other authority which may have requirements under any relevant legislation

Final surface contours shown hereon have been supplied by Peak Urban.

Location of retaining walls are as shown on Engineering design drawings. Their as-constructed location may differ from their design location. Retaining wall heights have been supplied by Peak Urban. **The engineering detail shown hereon are preliminary only and are subject to change in final design and statutory approvals**

Compaction of any fill material placed on this site shall be completed to level one inspection and testing services in accordance with AS3798-2007.

Depth of fill values are calculated to the pre-development surface.

Copyright © Veris Australia Pty Ltd
17/02/2022.

**FLAGSTONE
PRECINCT 1 STAGE 5A(i)**

For
**PEET FLAGSTONE
CITY PTY LTD**

IMPORTANT NOTES:
(These notes are an integral part of this plan)

This plan has been prepared for **PEET FLAGSTONE CITY PTY LTD** for the purposes of **A Disclosure Plan Under the Land Sales Act 1984 (as amended)**.

It is not to be used by any other person or corporation or for any other purposes and is subject to the following limitations:

Please refer to the approved Development Application for conditions relating to the LOT and to approved Operational Works drawings for services location and possible easements.

THESE DESIGNS AND DRAWINGS ARE COPYRIGHT AND ARE NOT TO BE USED OR REPRODUCED WITHOUT THE WRITTEN PERMISSION OF VERIS

Data Sources
Cadastral Boundaries
30109-LC-Master(CU) F594 2014.dwg
Engineering Design
FLAGSTONE - BASE - STAGE 5A 5B - DISCLOSURE INFO - 27 01 2022.dwg
Final Surface Contours
FLAGSTONE - BASE - STAGE 5A 5B - DISCLOSURE INFO - 27 01 2022.dwg
Depth of Fill
FLAGSTONE - DEPTH RANGE CONTOURS - STAGE 5A 5B - DISCLOSURE INFO - 27 01 2022.dwg

Issue	Revisions	Date	Drawn
A	Original	16.02.2022	BK

Locality: FLAGSTONE
Local Authority: LOGAN CITY COUNCIL
Horizontal Meridian: MGA, Zone 56
Vertical Level Datum: AHD D
Scale: 1:250 @ A4
Designed: Peak Urban
Drawn: BK 16/02/2022
Checked: DE 17/02/2022
Plot Date: 17 Feb, 2022
Computer File Ref: 30109-St5A-DP-(A).dwg

DISCLOSURE PLAN
of Proposed LOT 2369

being part of
Lot 911
on SP321079



veris

BRISBANE (07) 3686 4700 WHITSUNDAYS (07) 4945 6600

MACKAY (07) 4957 9700 CAIRNS (07) 4252 9400

veris.com.au
ACN 615 735 727
Veris Australia Pty Ltd

Drawing No
30109-DP- 2369

Issue
A

LEGEND

Final surface contours based on A.H.D. datum at an interval of 0.5m, shown as: 15.5

Where applicable, areas to be filled are shown as:

Depth of fill, in metres, shown as:- + 0.5

Retaining wall and retaining wall height, shown on the lower side of the wall, have been taken from plans supplied by Peak Urban and shown as:

(1.2)





SANDY CREEK ROAD

PROPOSED LOT 2371

PROPOSED LOT 2373

PROPOSED LOT 2368

PROPOSED LOT 2369

2370
375m²

Retaining Wall Lot 2370
Min Height:- 1.7m
Max Height:- 1.7m
Average Height:- 1.7m

ADDITIONAL NOTES:

The LOT dimensions and area shown hereon are subject to final field survey and also to the requirements of Council and any other authority which may have requirements under any relevant legislation

Final surface contours shown hereon have been supplied by Peak Urban.

Location of retaining walls are as shown on Engineering design drawings. Their as-constructed location may differ from their design location. Retaining wall heights have been supplied by Peak Urban. **The engineering detail shown hereon are preliminary only and are subject to change in final design and statutory approvals**

Compaction of any fill material placed on this site shall be completed to level one inspection and testing services in accordance with AS3798-2007.

Depth of fill values are calculated to the pre-development surface.

Copyright © Veris Australia Pty Ltd
17/02/2022.

**FLAGSTONE
PRECINCT 1 STAGE 5A(i)**

For
**PEET FLAGSTONE
CITY PTY LTD**

IMPORTANT NOTES:
(These notes are an integral part of this plan)

This plan has been prepared for **PEET FLAGSTONE CITY PTY LTD** for the purposes of **A Disclosure Plan Under the Land Sales Act 1984 (as amended)**.

It is not to be used by any other person or corporation or for any other purposes and is subject to the following limitations:

Please refer to the approved Development Application for conditions relating to the LOT and to approved Operational Works drawings for services location and possible easements.

THESE DESIGNS AND DRAWINGS ARE COPYRIGHT AND ARE NOT TO BE USED OR REPRODUCED WITHOUT THE WRITTEN PERMISSION OF VERIS

Data Sources
Cadastral Boundaries
30109-LC-Master(CU) F594 2014.dwg
Engineering Design
FLAGSTONE - BASE - STAGE 5A 5B - DISCLOSURE INFO - 27 01 2022.dwg
Final Surface Contours
FLAGSTONE - BASE - STAGE 5A 5B - DISCLOSURE INFO - 27 01 2022.dwg
Depth of Fill
FLAGSTONE - DEPTH RANGE CONTOURS - STAGE 5A 5B - DISCLOSURE INFO - 27 01 2022.dwg

Issue	Revisions	Date	BK	Drawn
A	Original	16.02.2022	BK	

Locality: FLAGSTONE
Local Authority: LOGAN CITY COUNCIL
Horizontal Meridian: MGA, Zone 56
Vertical Level Datum: AHD D
Scale: 1:250 @ A4
Designed: Peak Urban
Drawn: BK 16/02/2022
Checked: DE 17/02/2022
Plot Date: 17 Feb, 2022
Computer File Ref: 30109-St5A-DP-(A).dwg

**DISCLOSURE PLAN
of Proposed LOT 2370**

being part of
Lot 911
on SP321079



veris

BRISBANE (07) 3686 4700 WHITSUNDAYS (07) 4945 6600

MACKAY (07) 4957 9700 CAIRNS (07) 4252 9400

veris.com.au
ACN 615 735 727
Veris Australia Pty Ltd

Drawing No
30109-DP- 2370

Issue
A

LEGEND

Final surface contours based on A.H.D. datum at an interval of 0.5m, shown as: 15.5

Where applicable, areas to be filled are shown as:

Depth of fill, in metres, shown as:- + 0.5

Retaining wall and retaining wall height, shown on the lower side of the wall, have been taken from plans supplied by Peak Urban and shown as: 1.2



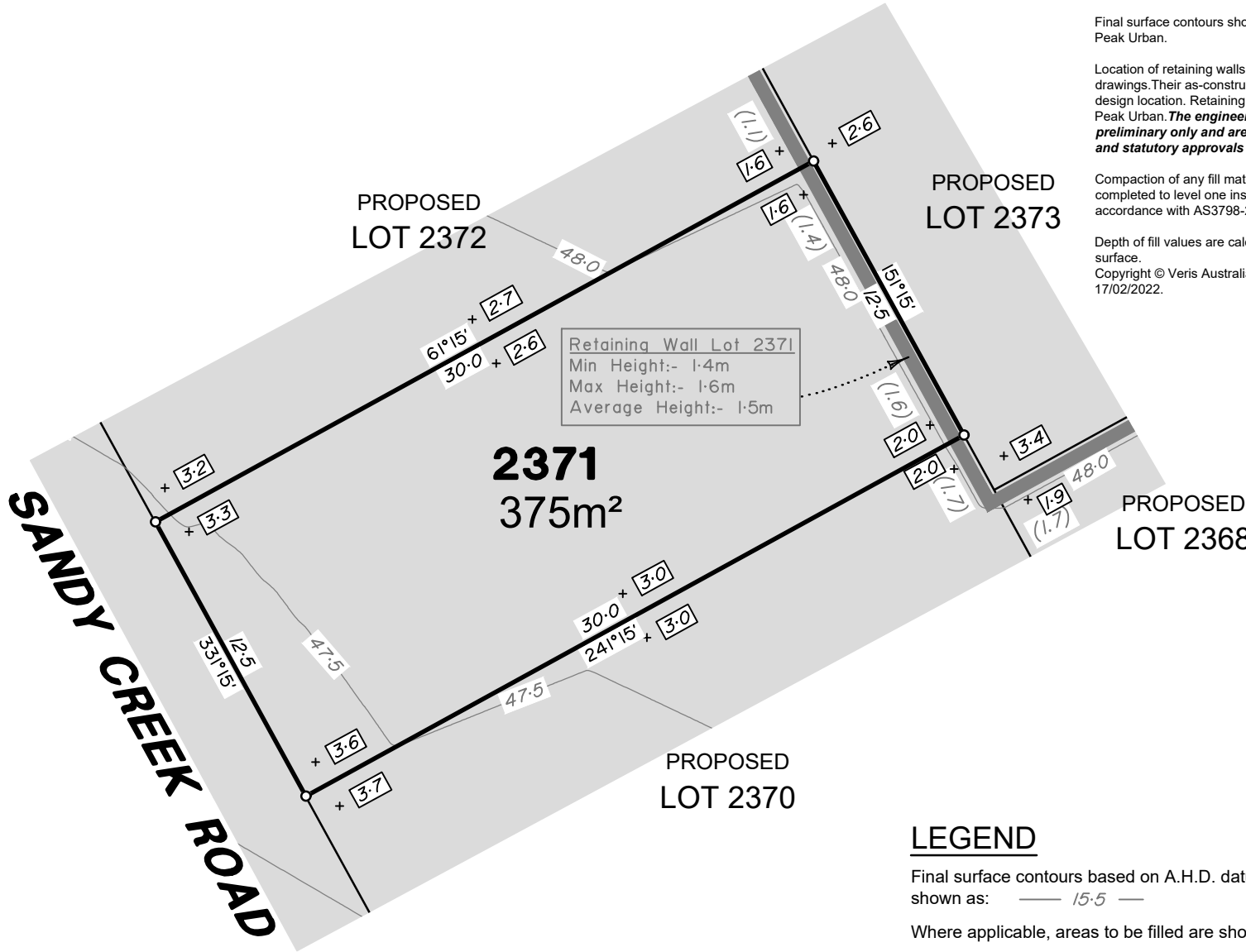

Retaining Wall Lot 2371
 Min Height:- 1.4m
 Max Height:- 1.6m
 Average Height:- 1.5m

ADDITIONAL NOTES:

The LOT dimensions and area shown hereon are subject to final field survey and also to the requirements of Council and any other authority which may have requirements under any relevant legislation

Final surface contours shown hereon have been supplied by Peak Urban.

Location of retaining walls are as shown on Engineering design drawings. Their as-constructed location may differ from their design location. Retaining wall heights have been supplied by Peak Urban. **The engineering detail shown hereon are preliminary only and are subject to change in final design and statutory approvals**

Compaction of any fill material placed on this site shall be completed to level one inspection and testing services in accordance with AS3798-2007.

Depth of fill values are calculated to the pre-development surface.

Copyright © Veris Australia Pty Ltd
 17/02/2022.

**FLAGSTONE
 PRECINCT 1 STAGE 5A(i)**
 For
**PEET FLAGSTONE
 CITY PTY LTD**

IMPORTANT NOTES:
 (These notes are an integral part of this plan)

This plan has been prepared for **PEET FLAGSTONE CITY PTY LTD** for the purposes of **A Disclosure Plan Under the Land Sales Act 1984 (as amended)**.

It is not to be used by any other person or corporation or for any other purposes and is subject to the following limitations:

Please refer to the approved Development Application for conditions relating to the LOT and to approved Operational Works drawings for services location and possible easements.

THESE DESIGNS AND DRAWINGS ARE COPYRIGHT AND ARE NOT TO BE USED OR REPRODUCED WITHOUT THE WRITTEN PERMISSION OF VERIS

Data Sources
 Cadastral Boundaries
 30109-LC-Master(CU) F594 2014.dwg
 Engineering Design
 FLAGSTONE - BASE - STAGE 5A 5B - DISCLOSURE INFO - 27 01 2022.dwg
 Final Surface Contours
 FLAGSTONE - BASE - STAGE 5A 5B - DISCLOSURE INFO - 27 01 2022.dwg
 Depth of Fill
 FLAGSTONE - DEPTH RANGE CONTOURS - STAGE 5A 5B - DISCLOSURE INFO - 27 01 2022.dwg

Issue	Revisions	Date	BK	Drawn
A	Original	16.02.2022	BK	

Locality: FLAGSTONE
 Local Authority: LOGAN CITY COUNCIL
 Horizontal Meridian: MGA, Zone 56
 Vertical Level Datum: AHD D
 Scale: 1:250 @ A4
 Designed: Peak Urban
 Drawn: BK 16/02/2022
 Checked: DE 17/02/2022
 Plot Date: 17 Feb, 2022
 Computer File Ref: 30109-St5A-DP-(A).dwg

**DISCLOSURE PLAN
 of Proposed LOT 2371**
 being part of
 Lot 911
 on SP321079



BRISBANE (07) 3688 4700
 WHITSUNDAYS (07) 4945 6600
 MACKAY (07) 4957 9700
 CAIRNS (07) 4252 9400

veris.com.au
 ACN 615 735 727
 Veris Australia Pty Ltd

Drawing No 30109-DP- 2371 Issue A

LEGEND

Final surface contours based on A.H.D. datum at an interval of 0.5m, shown as: 15.5

Where applicable, areas to be filled are shown as:

Depth of fill, in metres, shown as:- + 0.5

Retaining wall and retaining wall height, shown on the lower side of the wall, have been taken from plans supplied by Peak Urban and shown as: (1.2)

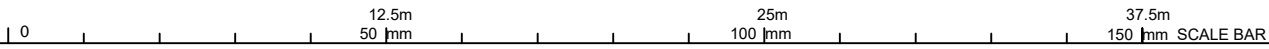

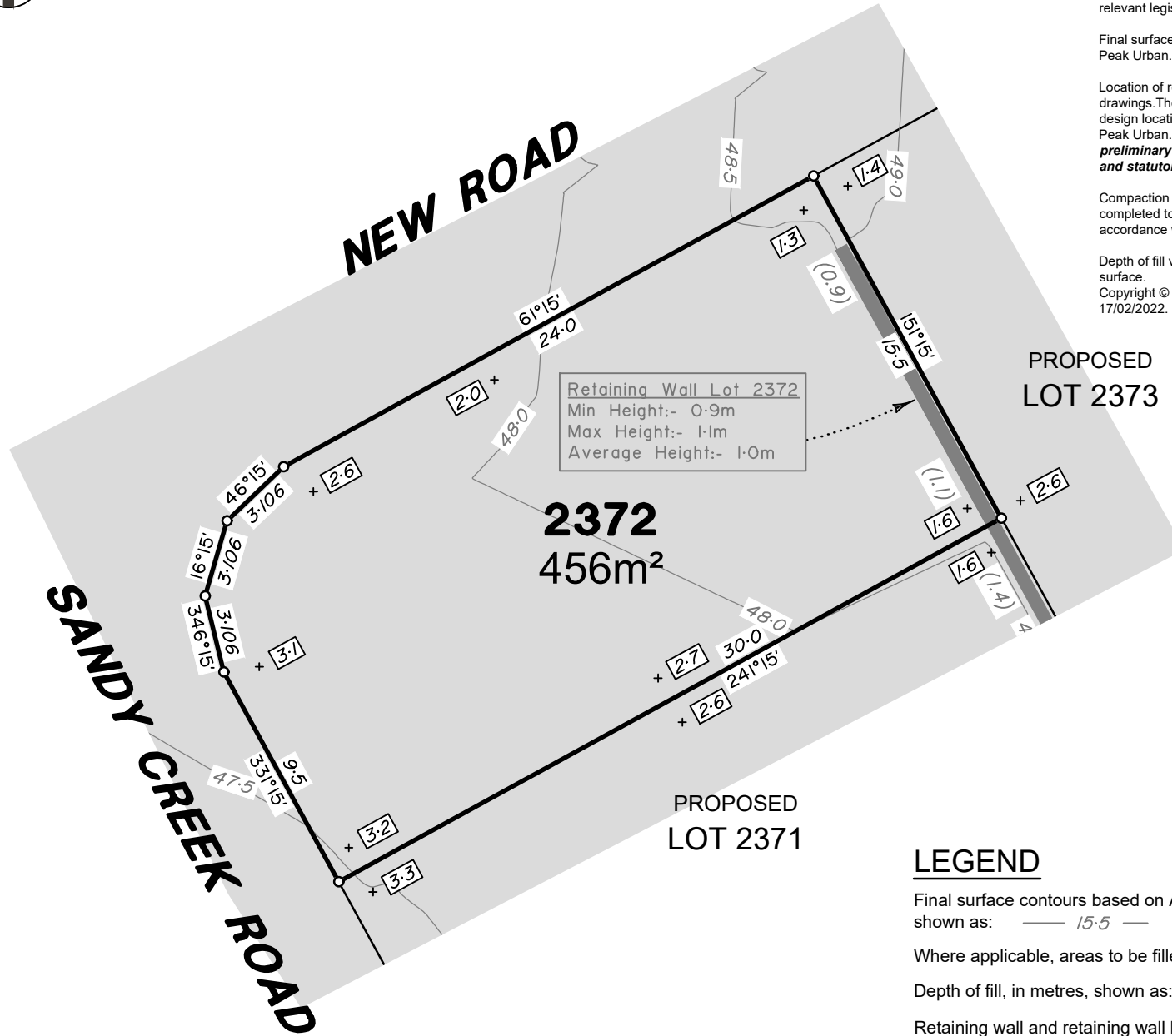

ADDITIONAL NOTES:

The LOT dimensions and area shown hereon are subject to final field survey and also to the requirements of Council and any other authority which may have requirements under any relevant legislation

Final surface contours shown hereon have been supplied by Peak Urban.

Location of retaining walls are as shown on Engineering design drawings. Their as-constructed location may differ from their design location. Retaining wall heights have been supplied by Peak Urban. **The engineering detail shown hereon are preliminary only and are subject to change in final design and statutory approvals**

Compaction of any fill material placed on this site shall be completed to level one inspection and testing services in accordance with AS3798-2007.

Depth of fill values are calculated to the pre-development surface.
 Copyright © Veris Australia Pty Ltd
 17/02/2022.

LEGEND

Final surface contours based on A.H.D. datum at an interval of 0.5m, shown as: 15.5

Where applicable, areas to be filled are shown as:

Depth of fill, in metres, shown as:- + 0.5

Retaining wall and retaining wall height, shown on the lower side of the wall, have been taken from plans supplied by Peak Urban and shown as: (1.2)



**FLAGSTONE
 PRECINCT 1 STAGE 5A(i)**
 For
**PEET FLAGSTONE
 CITY PTY LTD**

IMPORTANT NOTES:
 (These notes are an integral part of this plan)

This plan has been prepared for PEET FLAGSTONE CITY PTY LTD for the purposes of A Disclosure Plan Under the Land Sales Act 1984 (as amended).

It is not to be used by any other person or corporation or for any other purposes and is subject to the following limitations:

Please refer to the approved Development Application for conditions relating to the LOT and to approved Operational Works drawings for services location and possible easements.

THESE DESIGNS AND DRAWINGS ARE COPYRIGHT AND ARE NOT TO BE USED OR REPRODUCED WITHOUT THE WRITTEN PERMISSION OF VERIS

Data Sources
 Cadastral Boundaries
 30109-LC-Master(CU) F594 2014.dwg
 Engineering Design
 FLAGSTONE - BASE - STAGE 5A 5B - DISCLOSURE INFO - 27 01 2022.dwg
 Final Surface Contours
 FLAGSTONE - BASE - STAGE 5A 5B - DISCLOSURE INFO - 27 01 2022.dwg
 Depth of Fill
 FLAGSTONE - DEPTH RANGE CONTOURS - STAGE 5A 5B - DISCLOSURE INFO - 27 01 2022.dwg

Issue	Revisions	Date	BK	Drawn
A	Original	16.02.2022		

Locality: FLAGSTONE
 Local Authority: LOGAN CITY COUNCIL
 Horizontal Meridian: MGA, Zone 56
 Vertical Level Datum: AHD D
 Scale: 1:250 @ A4
 Designed: Peak Urban
 Drawn: BK 16/02/2022
 Checked: DE 17/02/2022
 Plot Date: 17 Feb, 2022
 Computer File Ref: 30109-St5Ai-DP-(A).dwg

**DISCLOSURE PLAN
 of Proposed LOT 2372**
 being part of
 Lot 911
 on SP321079



BRISBANE (07) 3688 4700 WHITSUNDAYS (07) 4945 6600

MACKAY (07) 4957 9700 CAIRNS (07) 4252 9400

veris.com.au
 ACN 615 735 727
 Veris Australia Pty Ltd

Drawing No 30109-DP- 2372 Issue A



NEW ROAD

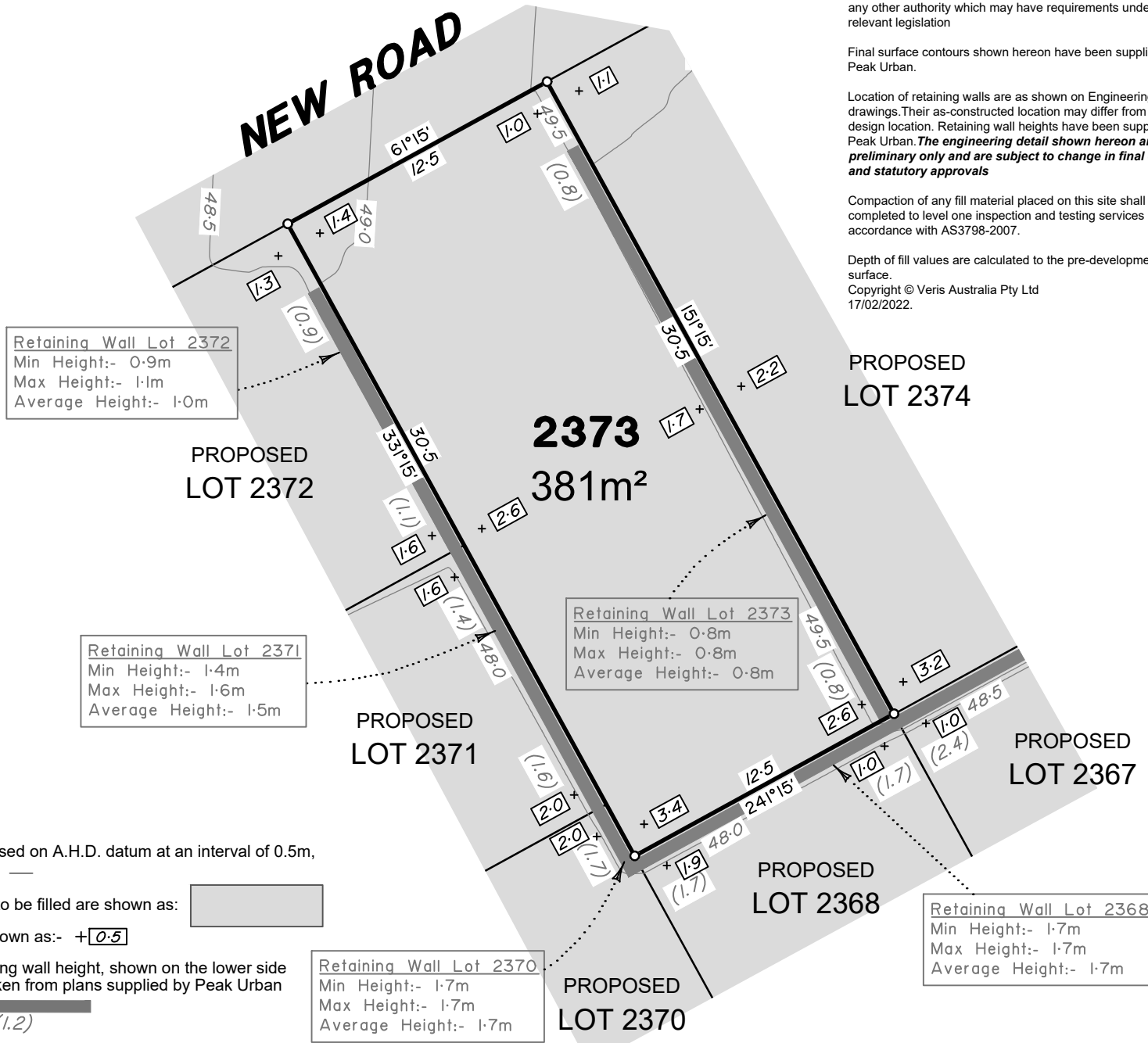

Retaining Wall Lot 2372
 Min Height:- 0.9m
 Max Height:- 1.1m
 Average Height:- 1.0m

Retaining Wall Lot 2371
 Min Height:- 1.4m
 Max Height:- 1.6m
 Average Height:- 1.5m

Retaining Wall Lot 2373
 Min Height:- 0.8m
 Max Height:- 0.8m
 Average Height:- 0.8m

Retaining Wall Lot 2370
 Min Height:- 1.7m
 Max Height:- 1.7m
 Average Height:- 1.7m

Retaining Wall Lot 2368
 Min Height:- 1.7m
 Max Height:- 1.7m
 Average Height:- 1.7m

ADDITIONAL NOTES:

The LOT dimensions and area shown hereon are subject to final field survey and also to the requirements of Council and any other authority which may have requirements under any relevant legislation

Final surface contours shown hereon have been supplied by Peak Urban.

Location of retaining walls are as shown on Engineering design drawings. Their as-constructed location may differ from their design location. Retaining wall heights have been supplied by Peak Urban. **The engineering detail shown hereon are preliminary only and are subject to change in final design and statutory approvals**

Compaction of any fill material placed on this site shall be completed to level one inspection and testing services in accordance with AS3798-2007.

Depth of fill values are calculated to the pre-development surface.
 Copyright © Veris Australia Pty Ltd
 17/02/2022.

PROPOSED LOT 2374

LEGEND

Final surface contours based on A.H.D. datum at an interval of 0.5m, shown as: 15.5

Where applicable, areas to be filled are shown as:

Depth of fill, in metres, shown as:- +0.5

Retaining wall and retaining wall height, shown on the lower side of the wall, have been taken from plans supplied by Peak Urban and shown as:

(1.2)



FLAGSTONE PRECINCT 1 STAGE 5A(i) For PEET FLAGSTONE CITY PTY LTD

IMPORTANT NOTES: (These notes are an integral part of this plan)

This plan has been prepared for PEET FLAGSTONE CITY PTY LTD for the purposes of a Disclosure Plan Under the Land Sales Act 1984 (as amended).

It is not to be used by any other person or corporation or for any other purposes and is subject to the following limitations:

Please refer to the approved Development Application for conditions relating to the LOT and to approved Operational Works drawings for services location and possible easements.

THESE DESIGNS AND DRAWINGS ARE COPYRIGHT AND ARE NOT TO BE USED OR REPRODUCED WITHOUT THE WRITTEN PERMISSION OF VERIS

Data Sources
 Cadastral Boundaries
 30109-LC-Master(CU) F594 2014.dwg
 Engineering Design
 FLAGSTONE - BASE - STAGE 5A 5B - DISCLOSURE INFO - 27 01 2022.dwg
 Final Surface Contours
 FLAGSTONE - BASE - STAGE 5A 5B - DISCLOSURE INFO - 27 01 2022.dwg
 Depth of Fill
 FLAGSTONE - DEPTH RANGE CONTOURS - STAGE 5A 5B - DISCLOSURE INFO - 27 01 2022.dwg

Issue	Revisions	Date	BK	Drawn
A	Original	16.02.2022		

Locality: FLAGSTONE
 Local Authority: LOGAN CITY COUNCIL
 Horizontal Meridian: MGA, Zone 56
 Vertical Level Datum: AHD D
 Scale: 1:250 @ A4
 Designed: Peak Urban
 Drawn: BK 16/02/2022
 Checked: DE 17/02/2022
 Plot Date: 17 Feb, 2022
 Computer File Ref: 30109-St5A-DP-(A).dwg

DISCLOSURE PLAN of Proposed LOT 2373

being part of
 Lot 911
 on SP321079



BRISBANE WHITSUNDAYS
 (07) 3668 4700 (07) 4945 6600

MACKAY CAIRNS
 (07) 4957 9700 (07) 4252 9400

veris.com.au
 ACN 615 735 727
 Veris Australia Pty Ltd

Drawing No
 30109-DP- 2373
 Issue
 A

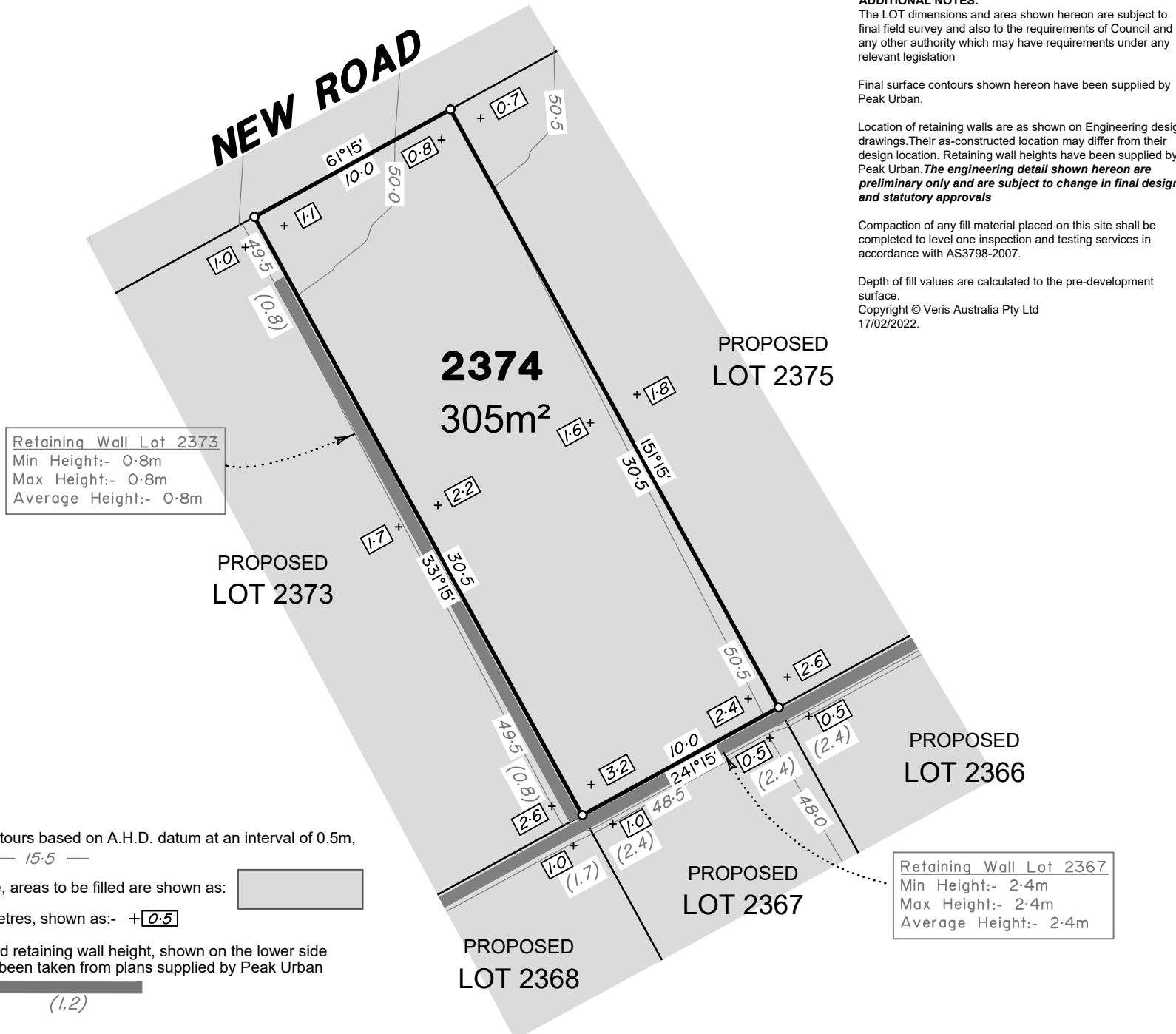

Retaining Wall Lot 2373
 Min Height:- 0.8m
 Max Height:- 0.8m
 Average Height:- 0.8m

Retaining Wall Lot 2367
 Min Height:- 2.4m
 Max Height:- 2.4m
 Average Height:- 2.4m

LEGEND

Final surface contours based on A.H.D. datum at an interval of 0.5m, shown as: 15.5

Where applicable, areas to be filled are shown as:

Depth of fill, in metres, shown as:- + 0.5

Retaining wall and retaining wall height, shown on the lower side of the wall, have been taken from plans supplied by Peak Urban and shown as: (1.2)

ADDITIONAL NOTES:

The LOT dimensions and area shown hereon are subject to final field survey and also to the requirements of Council and any other authority which may have requirements under any relevant legislation

Final surface contours shown hereon have been supplied by Peak Urban.

Location of retaining walls are as shown on Engineering design drawings. Their as-constructed location may differ from their design location. Retaining wall heights have been supplied by Peak Urban. **The engineering detail shown hereon are preliminary only and are subject to change in final design and statutory approvals**

Compaction of any fill material placed on this site shall be completed to level one inspection and testing services in accordance with AS3798-2007.

Depth of fill values are calculated to the pre-development surface.
 Copyright © Veris Australia Pty Ltd
 17/02/2022.

FLAGSTONE PRECINCT 1 STAGE 5A(i) For PEET FLAGSTONE CITY PTY LTD

IMPORTANT NOTES:

(These notes are an integral part of this plan)

This plan has been prepared for PEET FLAGSTONE CITY PTY LTD for the purposes of a Disclosure Plan Under the Land Sales Act 1984 (as amended).

It is not to be used by any other person or corporation or for any other purposes and is subject to the following limitations:

Please refer to the approved Development Application for conditions relating to the LOT and to approved Operational Works drawings for services location and possible easements.

THESE DESIGNS AND DRAWINGS ARE COPYRIGHT AND ARE NOT TO BE USED OR REPRODUCED WITHOUT THE WRITTEN PERMISSION OF VERIS

Data Sources
 Cadastral Boundaries
 30109-LC-Master(CU) FS94 2014.dwg
 Engineering Design
 FLAGSTONE - BASE - STAGE 5A 5B - DISCLOSURE INFO - 27 01 2022.dwg
 Final Surface Contours
 FLAGSTONE - BASE - STAGE 5A 5B - DISCLOSURE INFO - 27 01 2022.dwg
 Depth of Fill
 FLAGSTONE - DEPTH RANGE CONTOURS - STAGE 5A 5B - DISCLOSURE INFO - 27 01 2022.dwg

Issue	Original	Revisions	Date	BK	Drawn
A			16.02.2022		

Locality: FLAGSTONE
 Local Authority: LOGAN CITY COUNCIL
 Horizontal Meridian: MGA, Zone 56
 Vertical Level Datum: AHD D
 Scale: 1:250 @ A4
 Designed: Peak Urban
 Drawn: BK 16/02/2022
 Checked: DE 17/02/2022
 Plot Date: 17 Feb, 2022
 Computer File Ref: 30109-St5A-DP-(A).dwg

DISCLOSURE PLAN of Proposed LOT 2374 being part of Lot 911 on SP321079



BRISBANE (07) 3688 4700 WHITSUNDAYS (07) 4945 6600

MACKAY (07) 4957 9700 CAIRNS (07) 4252 9400

veris.com.au
 ACN 615 735 727
 Veris Australia Pty Ltd

Drawing No 30109-DP- 2374 Issue A

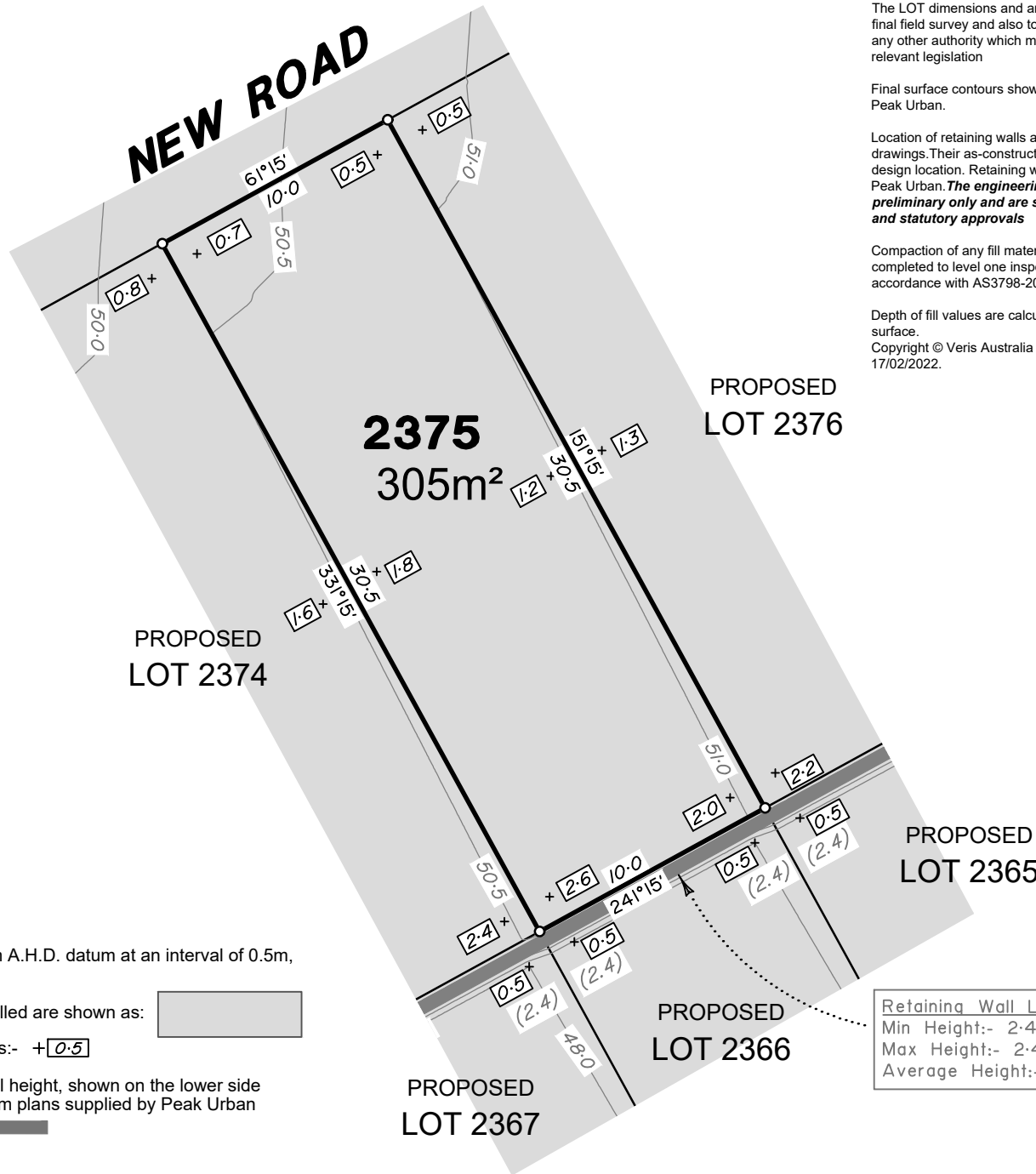

LEGEND

Final surface contours based on A.H.D. datum at an interval of 0.5m, shown as: 15.5

Where applicable, areas to be filled are shown as:

Depth of fill, in metres, shown as:- + 0.5

Retaining wall and retaining wall height, shown on the lower side of the wall, have been taken from plans supplied by Peak Urban and shown as: (1.2)

ADDITIONAL NOTES:

The LOT dimensions and area shown hereon are subject to final field survey and also to the requirements of Council and any other authority which may have requirements under any relevant legislation

Final surface contours shown hereon have been supplied by Peak Urban.

Location of retaining walls are as shown on Engineering design drawings. Their as-constructed location may differ from their design location. Retaining wall heights have been supplied by Peak Urban. **The engineering detail shown hereon are preliminary only and are subject to change in final design and statutory approvals**

Compaction of any fill material placed on this site shall be completed to level one inspection and testing services in accordance with AS3798-2007.

Depth of fill values are calculated to the pre-development surface.
Copyright © Veris Australia Pty Ltd
17/02/2022.

**FLAGSTONE
PRECINCT 1 STAGE 5A(i)**
For
**PEET FLAGSTONE
CITY PTY LTD**

IMPORTANT NOTES:
(These notes are an integral part of this plan)

This plan has been prepared for PEET FLAGSTONE CITY PTY LTD for the purposes of **A Disclosure Plan Under the Land Sales Act 1984 (as amended)**.

It is not to be used by any other person or corporation or for any other purposes and is subject to the following limitations:

Please refer to the approved Development Application for conditions relating to the LOT and to approved Operational Works drawings for services location and possible easements.

THESE DESIGNS AND DRAWINGS ARE COPYRIGHT AND ARE NOT TO BE USED OR REPRODUCED WITHOUT THE WRITTEN PERMISSION OF VERIS

- Data Sources**
Cadastral Boundaries
30109-LC-Master(CU) F594 2014.dwg
Engineering Design
FLAGSTONE - BASE - STAGE 5A 5B - DISCLOSURE INFO - 27 01 2022.dwg
Final Surface Contours
FLAGSTONE - BASE - STAGE 5A 5B - DISCLOSURE INFO - 27 01 2022.dwg
Depth of Fill
FLAGSTONE - DEPTH RANGE CONTOURS - STAGE 5A 5B - DISCLOSURE INFO - 27 01 2022.dwg

Issue	Revisions	Date	Drawn
A	Original	16.02.2022	BK

Locality: FLAGSTONE
Local Authority: LOGAN CITY COUNCIL
Horizontal Meridian: MGA, Zone 56
Vertical Level Datum: AHD D
Scale: 1:250 @ A4
Designed: Peak Urban
Drawn: BK 16/02/2022
Checked: DE 17/02/2022
Plot Date: 17 Feb, 2022
Computer File Ref: 30109-St5A-DP-(A).dwg

DISCLOSURE PLAN
of Proposed LOT 2375
being part of
Lot 911
on SP321079



veris

BRISBANE (07) 3688 4700 WHITSUNDAYS (07) 4945 6600

MACKAY (07) 4957 9700 CAIRNS (07) 4252 9400

veris.com.au
ACN 615 735 727
Veris Australia Pty Ltd

Drawing No
30109-DP- 2375

Issue
A





NEW ROAD

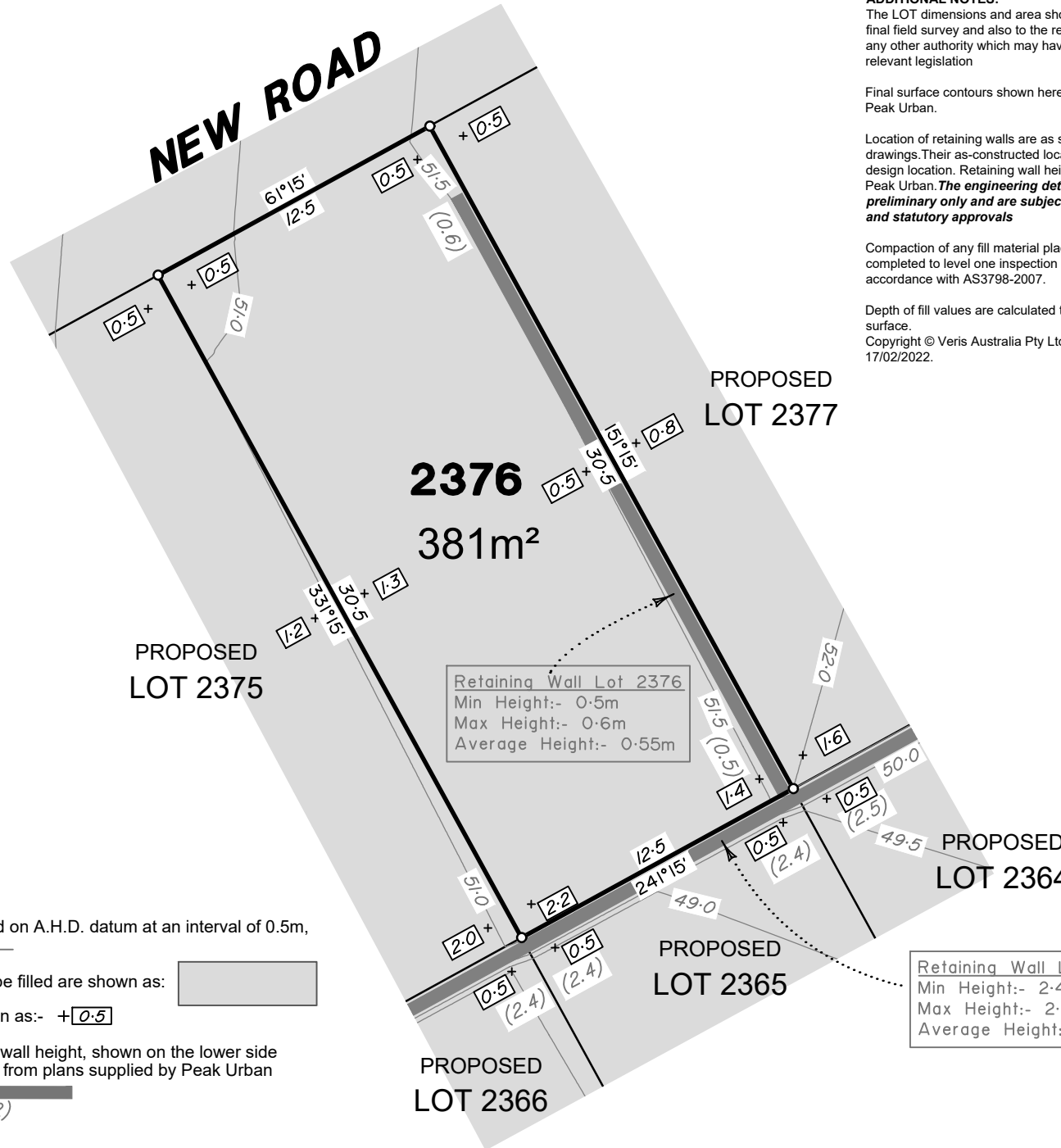

ADDITIONAL NOTES:

The LOT dimensions and area shown hereon are subject to final field survey and also to the requirements of Council and any other authority which may have requirements under any relevant legislation

Final surface contours shown hereon have been supplied by Peak Urban.

Location of retaining walls are as shown on Engineering design drawings. Their as-constructed location may differ from their design location. Retaining wall heights have been supplied by Peak Urban. **The engineering detail shown hereon are preliminary only and are subject to change in final design and statutory approvals**

Compaction of any fill material placed on this site shall be completed to level one inspection and testing services in accordance with AS3798-2007.

Depth of fill values are calculated to the pre-development surface.

Copyright © Veris Australia Pty Ltd
17/02/2022.

FLAGSTONE PRECINCT 1 STAGE 5A(i) For PEET FLAGSTONE CITY PTY LTD

IMPORTANT NOTES:

(These notes are an integral part of this plan)

This plan has been prepared for PEET FLAGSTONE CITY PTY LTD for the purposes of a Disclosure Plan Under the Land Sales Act 1984 (as amended).

It is not to be used by any other person or corporation or for any other purposes and is subject to the following limitations:

Please refer to the approved Development Application for conditions relating to the LOT and to approved Operational Works drawings for services location and possible easements.

THESE DESIGNS AND DRAWINGS ARE COPYRIGHT AND ARE NOT TO BE USED OR REPRODUCED WITHOUT THE WRITTEN PERMISSION OF VERIS

Data Sources
Cadastral Boundaries
30109-LC-Master(CU) F594 2014.dwg
Engineering Design
FLAGSTONE - BASE - STAGE 5A 5B - DISCLOSURE INFO - 27 01 2022.dwg
Final Surface Contours
FLAGSTONE - BASE - STAGE 5A 5B - DISCLOSURE INFO - 27 01 2022.dwg
Depth of Fill
FLAGSTONE - DEPTH RANGE CONTOURS - STAGE 5A 5B - DISCLOSURE INFO - 27 01 2022.dwg

Issue	Revisions	Date	BK	Drawn
A	Original	16.02.2022		

Locality: FLAGSTONE
Local Authority: LOGAN CITY COUNCIL
Horizontal Meridian: MGA, Zone 56
Vertical Level Datum: AHD D
Scale: 1:250 @ A4
Designed: Peak Urban
Drawn: BK 16/02/2022
Checked: DE 17/02/2022
Plot Date: 17 Feb, 2022
Computer File Ref: 30109-St5A-DP-(A).dwg

DISCLOSURE PLAN of Proposed LOT 2376 being part of Lot 911 on SP321079



BRISBANE (07) 3688 4700 WHITSUNDAYS (07) 4945 6600

MACKAY (07) 4957 9700 CAIRNS (07) 4252 9400

veris.com.au
ACN 615 735 727
Veris Australia Pty Ltd

Drawing No: 30109-DP- 2376 Issue: A

LEGEND

Final surface contours based on A.H.D. datum at an interval of 0.5m, shown as: 15.5

Where applicable, areas to be filled are shown as:

Depth of fill, in metres, shown as:- +0.5

Retaining wall and retaining wall height, shown on the lower side of the wall, have been taken from plans supplied by Peak Urban and shown as:



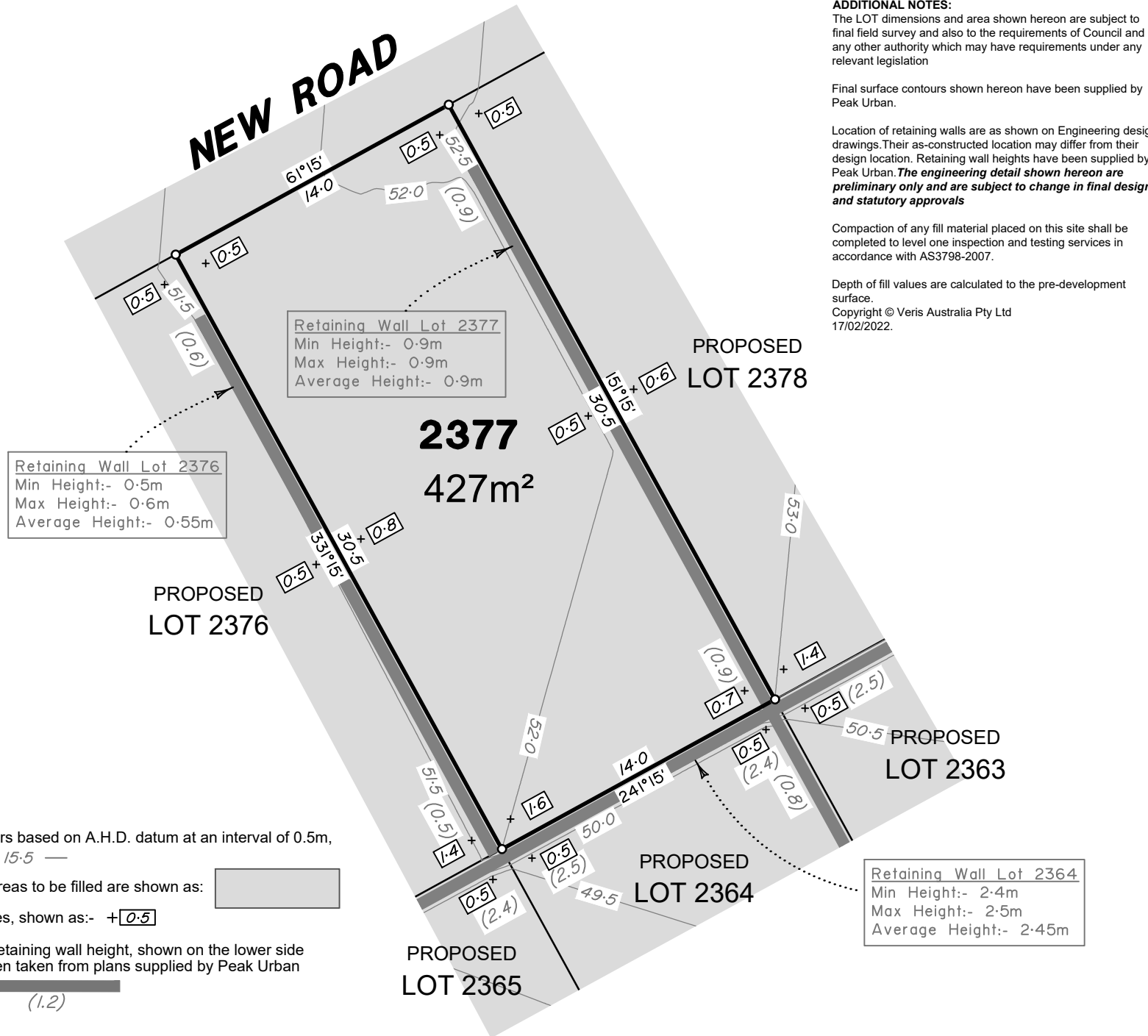

LEGEND

Final surface contours based on A.H.D. datum at an interval of 0.5m, shown as: $\text{---} 15.5 \text{---}$

Where applicable, areas to be filled are shown as:

Depth of fill, in metres, shown as: $\text{---} +0.5 \text{---}$

Retaining wall and retaining wall height, shown on the lower side of the wall, have been taken from plans supplied by Peak Urban and shown as:

(1.2)

12.5m
50 mm

25m
100 mm

37.5m
150 mm SCALE BAR

ADDITIONAL NOTES:

The LOT dimensions and area shown hereon are subject to final field survey and also to the requirements of Council and any other authority which may have requirements under any relevant legislation

Final surface contours shown hereon have been supplied by Peak Urban.

Location of retaining walls are as shown on Engineering design drawings. Their as-constructed location may differ from their design location. Retaining wall heights have been supplied by Peak Urban. **The engineering detail shown hereon are preliminary only and are subject to change in final design and statutory approvals**

Compaction of any fill material placed on this site shall be completed to level one inspection and testing services in accordance with AS3798-2007.

Depth of fill values are calculated to the pre-development surface.

Copyright © Veris Australia Pty Ltd
17/02/2022.

FLAGSTONE PRECINCT 1 STAGE 5A(i) For PEET FLAGSTONE CITY PTY LTD

IMPORTANT NOTES:

(These notes are an integral part of this plan)

This plan has been prepared for PEET FLAGSTONE CITY PTY LTD for the purposes of a Disclosure Plan Under the Land Sales Act 1984 (as amended).

It is not to be used by any other person or corporation or for any other purposes and is subject to the following limitations:

Please refer to the approved Development Application for conditions relating to the LOT and to approved Operational Works drawings for services location and possible easements.

THESE DESIGNS AND DRAWINGS ARE COPYRIGHT AND ARE NOT TO BE USED OR REPRODUCED WITHOUT THE WRITTEN PERMISSION OF VERIS

Data Sources
Cadastral Boundaries
30109-LC-Master(CU) F594 2014.dwg
Engineering Design
FLAGSTONE - BASE - STAGE 5A 5B - DISCLOSURE INFO - 27 01 2022.dwg
Final Surface Contours
FLAGSTONE - BASE - STAGE 5A 5B - DISCLOSURE INFO - 27 01 2022.dwg
Depth of Fill
FLAGSTONE - DEPTH RANGE CONTOURS - STAGE 5A 5B - DISCLOSURE INFO - 27 01 2022.dwg

Issue	Revisions	Date	BK	Drawn
A	Original	16.02.2022		

Locality: FLAGSTONE
Local Authority: LOGAN CITY COUNCIL
Horizontal Meridian: MGA, Zone 56
Vertical Level Datum: AHD D
Scale: 1:250 @ A4
Designed: Peak Urban
Drawn: BK 16/02/2022
Checked: DE 17/02/2022
Plot Date: 17 Feb, 2022
Computer File Ref: 30109-St5A-DP-(A).dwg

DISCLOSURE PLAN of Proposed LOT 2377 being part of Lot 911 on SP321079



veris

BRISBANE WHITSUNDAYS
(07) 3688 4700 (07) 4945 6600

MACKAY CAIRNS
(07) 4957 9700 (07) 4252 9400

veris.com.au
ACN 615 735 727
Veris Australia Pty Ltd

Drawing No Issue
30109-DP- 2377 A

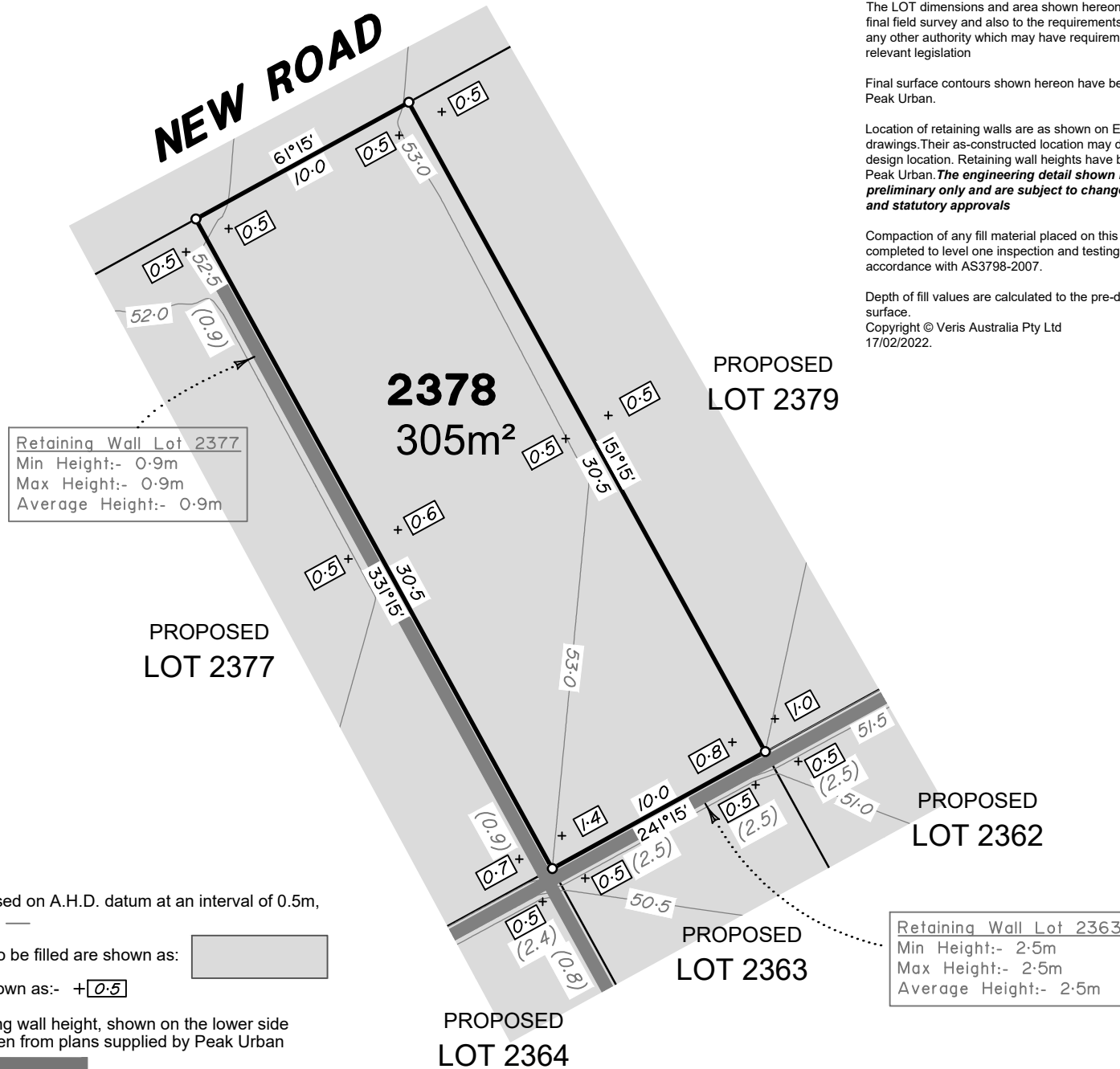

Retaining Wall Lot 2377
 Min Height:- 0.9m
 Max Height:- 0.9m
 Average Height:- 0.9m

ADDITIONAL NOTES:

The LOT dimensions and area shown hereon are subject to final field survey and also to the requirements of Council and any other authority which may have requirements under any relevant legislation

Final surface contours shown hereon have been supplied by Peak Urban.

Location of retaining walls are as shown on Engineering design drawings. Their as-constructed location may differ from their design location. Retaining wall heights have been supplied by Peak Urban. **The engineering detail shown hereon are preliminary only and are subject to change in final design and statutory approvals**

Compaction of any fill material placed on this site shall be completed to level one inspection and testing services in accordance with AS3798-2007.

Depth of fill values are calculated to the pre-development surface.
 Copyright © Veris Australia Pty Ltd
 17/02/2022.

**FLAGSTONE
 PRECINCT 1 STAGE 5A(i)**
 For
**PEET FLAGSTONE
 CITY PTY LTD**

IMPORTANT NOTES:
 (These notes are an integral part of this plan)

This plan has been prepared for PEET FLAGSTONE CITY PTY LTD for the purposes of a Disclosure Plan Under the Land Sales Act 1984 (as amended).

It is not to be used by any other person or corporation or for any other purposes and is subject to the following limitations:

Please refer to the approved Development Application for conditions relating to the LOT and to approved Operational Works drawings for services location and possible easements.

THESE DESIGNS AND DRAWINGS ARE COPYRIGHT AND ARE NOT TO BE USED OR REPRODUCED WITHOUT THE WRITTEN PERMISSION OF VERIS

- Data Sources**
 Cadastral Boundaries
 30109-LC-Master(CU) F594 2014.dwg
 Engineering Design
 FLAGSTONE - BASE - STAGE 5A 5B - DISCLOSURE INFO - 27 01 2022.dwg
 Final Surface Contours
 FLAGSTONE - BASE - STAGE 5A 5B - DISCLOSURE INFO - 27 01 2022.dwg
 Depth of Fill
 FLAGSTONE - DEPTH RANGE CONTOURS - STAGE 5A 5B - DISCLOSURE INFO - 27 01 2022.dwg

Issue	Revisions	Date	Drawn
A	Original	16.02.2022	BK

Locality: FLAGSTONE
 Local Authority: LOGAN CITY COUNCIL
 Horizontal Meridian: MGA, Zone 56
 Vertical Level Datum: AHD D
 Scale: 1:250 @ A4
 Designed: Peak Urban
 Drawn: BK 16/02/2022
 Checked: DE 17/02/2022
 Plot Date: 17 Feb, 2022
 Computer File Ref: 30109-St5A-DP-(A).dwg

**DISCLOSURE PLAN
 of Proposed LOT 2378**
 being part of
 Lot 911
 on SP321079



BRISBANE (07) 3668 4700 WHITSUNDAYS (07) 4945 6600

MACKAY (07) 4957 9700 CAIRNS (07) 4252 9400

veris.com.au
 ACN 615 735 727
 Veris Australia Pty Ltd

Drawing No 30109-DP- 2378 Issue A

LEGEND

Final surface contours based on A.H.D. datum at an interval of 0.5m, shown as: 15.5

Where applicable, areas to be filled are shown as:

Depth of fill, in metres, shown as:- +0.5

Retaining wall and retaining wall height, shown on the lower side of the wall, have been taken from plans supplied by Peak Urban and shown as: (1.2)





NEW ROAD



LEGEND

Final surface contours based on A.H.D. datum at an interval of 0.5m, shown as: 15.5

Where applicable, areas to be filled are shown as:

Depth of fill, in metres, shown as:- +0.5

Retaining wall and retaining wall height, shown on the lower side of the wall, have been taken from plans supplied by Peak Urban and shown as: (1.2)

ADDITIONAL NOTES:

The LOT dimensions and area shown hereon are subject to final field survey and also to the requirements of Council and any other authority which may have requirements under any relevant legislation

Final surface contours shown hereon have been supplied by Peak Urban.

Location of retaining walls are as shown on Engineering design drawings. Their as-constructed location may differ from their design location. Retaining wall heights have been supplied by Peak Urban. **The engineering detail shown hereon are preliminary only and are subject to change in final design and statutory approvals**

Compaction of any fill material placed on this site shall be completed to level one inspection and testing services in accordance with AS3798-2007.

Depth of fill values are calculated to the pre-development surface.
Copyright © Veris Australia Pty Ltd
17/02/2022.

FLAGSTONE PRECINCT 1 STAGE 5A(i) For PEET FLAGSTONE CITY PTY LTD

IMPORTANT NOTES:

(These notes are an integral part of this plan)

This plan has been prepared for PEET FLAGSTONE CITY PTY LTD for the purposes of a Disclosure Plan Under the Land Sales Act 1984 (as amended).

It is not to be used by any other person or corporation or for any other purposes and is subject to the following limitations:

Please refer to the approved Development Application for conditions relating to the LOT and to approved Operational Works drawings for services location and possible easements.

THESE DESIGNS AND DRAWINGS ARE COPYRIGHT AND ARE NOT TO BE USED OR REPRODUCED WITHOUT THE WRITTEN PERMISSION OF VERIS

Data Sources
Cadastral Boundaries
30109-LC-Master(CU) F594 2014.dwg
Engineering Design
FLAGSTONE - BASE - STAGE 5A 5B - DISCLOSURE INFO - 27 01 2022.dwg
Final Surface Contours
FLAGSTONE - BASE - STAGE 5A 5B - DISCLOSURE INFO - 27 01 2022.dwg
Depth of Fill
FLAGSTONE - DEPTH RANGE CONTOURS - STAGE 5A 5B - DISCLOSURE INFO - 27 01 2022.dwg

Issue	Revisions	Date	BK	Drawn
A	Original	16.02.2022		BK

Locality: FLAGSTONE
Local Authority: LOGAN CITY COUNCIL
Horizontal Meridian: MGA, Zone 56
Vertical Level Datum: AHD D
Scale: 1:250 @ A4
Designed: Peak Urban
Drawn: BK 16/02/2022
Checked: DE 17/02/2022
Plot Date: 17 Feb, 2022
Computer File Ref: 30109-St5Ai-DP-(A).dwg

DISCLOSURE PLAN of Proposed LOT 2379 being part of Lot 911 on SP321079



veris

BRISBANE (07) 3666 4700 WHITSUNDAYS (07) 4945 6600

MACKAY (07) 4957 9700 CAIRNS (07) 4252 9400

veris.com.au
ACN 615 735 727
Veris Australia Pty Ltd

Drawing No 30109-DP- 2379 Issue A





NEW ROAD

PANORAMA STREET

2380
449m²

PROPOSED
LOT 2379

PROPOSED
LOT 2361

PROPOSED
LOT 2362

ADDITIONAL NOTES:

The LOT dimensions and area shown hereon are subject to final field survey and also to the requirements of Council and any other authority which may have requirements under any relevant legislation

Final surface contours shown hereon have been supplied by Peak Urban.

Location of retaining walls are as shown on Engineering design drawings. Their as-constructed location may differ from their design location. Retaining wall heights have been supplied by Peak Urban. **The engineering detail shown hereon are preliminary only and are subject to change in final design and statutory approvals**

Compaction of any fill material placed on this site shall be completed to level one inspection and testing services in accordance with AS3798-2007.

Depth of fill values are calculated to the pre-development surface.

Copyright © Veris Australia Pty Ltd
17/02/2022.

**FLAGSTONE
PRECINCT 1 STAGE 5A(i)**

For
**PEET FLAGSTONE
CITY PTY LTD**

IMPORTANT NOTES:
(These notes are an integral part of this plan)

This plan has been prepared for **PEET FLAGSTONE CITY PTY LTD** for the purposes of **A Disclosure Plan Under the Land Sales Act 1984 (as amended)**.

It is not to be used by any other person or corporation or for any other purposes and is subject to the following limitations:

Please refer to the approved Development Application for conditions relating to the LOT and to approved Operational Works drawings for services location and possible easements.

THESE DESIGNS AND DRAWINGS ARE COPYRIGHT AND ARE NOT TO BE USED OR REPRODUCED WITHOUT THE WRITTEN PERMISSION OF VERIS

Data Sources
Cadastral Boundaries
30109-LC-Master(CU) F594 2014.dwg
Engineering Design
FLAGSTONE - BASE - STAGE 5A 5B - DISCLOSURE INFO - 27 01 2022.dwg
Final Surface Contours
FLAGSTONE - BASE - STAGE 5A 5B - DISCLOSURE INFO - 27 01 2022.dwg
Depth of Fill
FLAGSTONE - DEPTH RANGE CONTOURS - STAGE 5A 5B - DISCLOSURE INFO - 27 01 2022.dwg

Issue	Revisions	Date	Drawn
A	Original	16.02.2022	BK

Locality: FLAGSTONE
Local Authority: LOGAN CITY COUNCIL
Horizontal Meridian: MGA, Zone 56
Vertical Level Datum: AHD D
Scale: 1:250 @ A4
Designed: Peak Urban
Drawn: BK 16/02/2022
Checked: DE 17/02/2022
Plot Date: 17 Feb, 2022
Computer File Ref: 30109-St5A-DP-(A).dwg

**DISCLOSURE PLAN
of Proposed LOT 2380**

being part of
Lot 911
on SP321079



veris

BRISBANE WHITSUNDAYS
(07) 3686 4700 (07) 4945 6600

MACKAY CAIRNS
(07) 4957 9700 (07) 4252 9400

veris.com.au
ACN 615 735 727
Veris Australia Pty Ltd

Drawing No Issue
30109-DP- 2380 A

LEGEND

Final surface contours based on A.H.D. datum at an interval of 0.5m, shown as: 15.5

Where applicable, areas to be filled are shown as:

Depth of fill, in metres, shown as:- 0.5

Retaining wall and retaining wall height, shown on the lower side of the wall, have been taken from plans supplied by Peak Urban and shown as: (1.2)

Retaining Wall Lot 2361
Min Height:- 1.5m
Max Height:- 1.7m
Average Height:- 1.6m



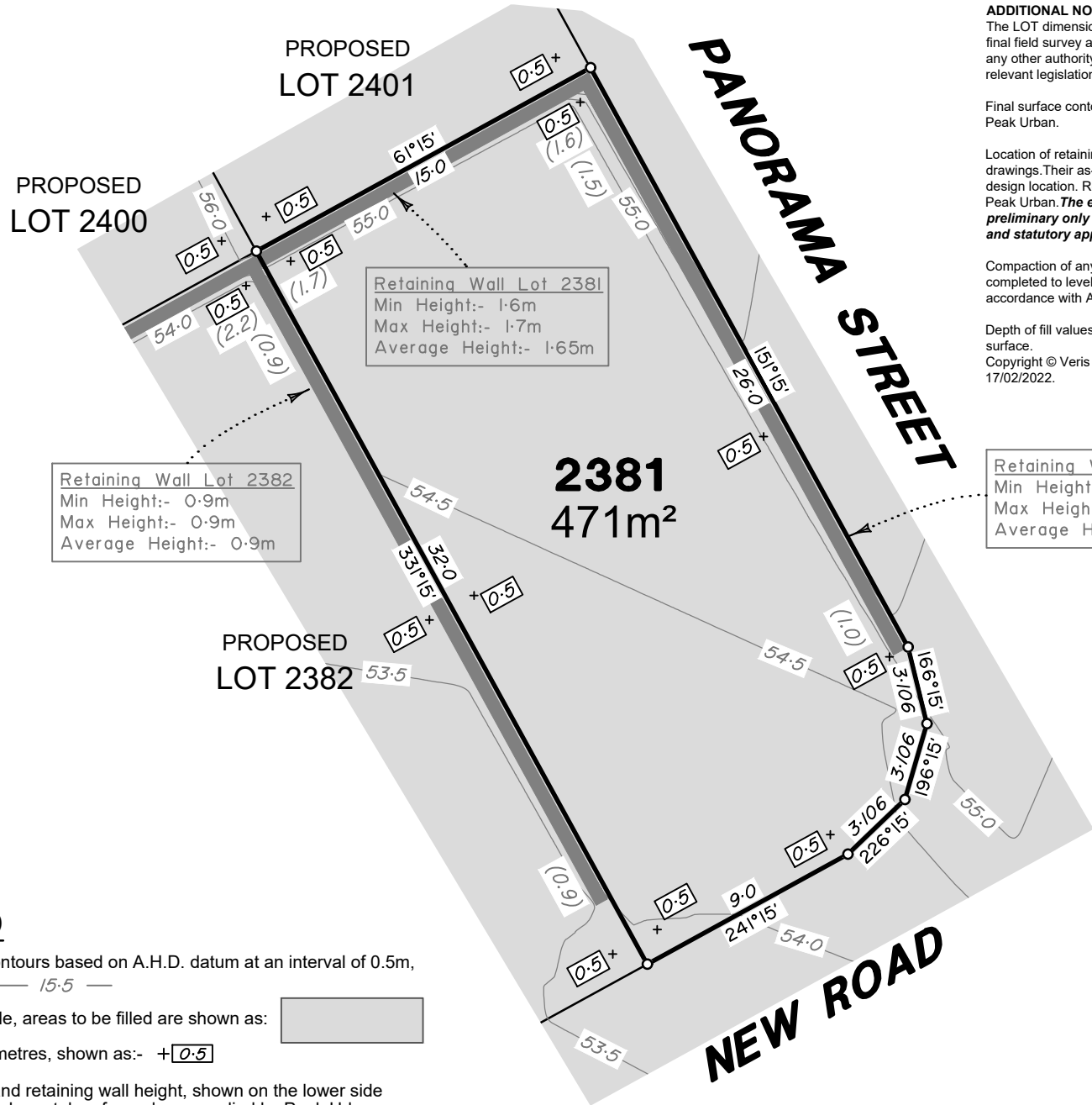

ADDITIONAL NOTES:

The LOT dimensions and area shown hereon are subject to final field survey and also to the requirements of Council and any other authority which may have requirements under any relevant legislation

Final surface contours shown hereon have been supplied by Peak Urban.

Location of retaining walls are as shown on Engineering design drawings. Their as-constructed location may differ from their design location. Retaining wall heights have been supplied by Peak Urban. **The engineering detail shown hereon are preliminary only and are subject to change in final design and statutory approvals**

Compaction of any fill material placed on this site shall be completed to level one inspection and testing services in accordance with AS3798-2007.

Depth of fill values are calculated to the pre-development surface.
Copyright © Veris Australia Pty Ltd
17/02/2022.

**FLAGSTONE
PRECINCT 1 STAGE 5A(i)**
For
**PEET FLAGSTONE
CITY PTY LTD**

IMPORTANT NOTES:
(These notes are an integral part of this plan)

This plan has been prepared for **PEET FLAGSTONE CITY PTY LTD** for the purposes of **A Disclosure Plan Under the Land Sales Act 1984 (as amended)**.

It is not to be used by any other person or corporation or for any other purposes and is subject to the following limitations:

Please refer to the approved Development Application for conditions relating to the LOT and to approved Operational Works drawings for services location and possible easements.

THESE DESIGNS AND DRAWINGS ARE COPYRIGHT AND ARE NOT TO BE USED OR REPRODUCED WITHOUT THE WRITTEN PERMISSION OF VERIS

Data Sources
Cadastral Boundaries
30109-LC-Master(CU) F594 2014.dwg
Engineering Design
FLAGSTONE - BASE - STAGE 5A 5B - DISCLOSURE INFO - 27 01 2022.dwg
Final Surface Contours
FLAGSTONE - BASE - STAGE 5A 5B - DISCLOSURE INFO - 27 01 2022.dwg
Depth of Fill
FLAGSTONE - DEPTH RANGE CONTOURS - STAGE 5A 5B - DISCLOSURE INFO - 27 01 2022.dwg

Issue	Revisions	Date	BK	Drawn
A	Original	16.02.2022		

Locality: FLAGSTONE
Local Authority: LOGAN CITY COUNCIL
Horizontal Meridian: MGA, Zone 56
Vertical Level Datum: AHD D
Scale: 1:250 @ A4
Designed: Peak Urban
Drawn: BK 16/02/2022
Checked: DE 17/02/2022
Plot Date: 17 Feb, 2022
Computer File Ref: 30109-St5A-DP-(A).dwg

**DISCLOSURE PLAN
of Proposed LOT 2381**
being part of
Lot 911
on SP321079



BRISBANE WHITSUNDAYS
(07) 3688 4700 (07) 4945 6600

MACKAY CAIRNS
(07) 4957 9700 (07) 4252 9400

veris.com.au
ACN 615 735 727
Veris Australia Pty Ltd

Drawing No Issue
30109-DP- 2381 A

LEGEND

Final surface contours based on A.H.D. datum at an interval of 0.5m, shown as: 15.5

Where applicable, areas to be filled are shown as:

Depth of fill, in metres, shown as:- +0.5

Retaining wall and retaining wall height, shown on the lower side of the wall, have been taken from plans supplied by Peak Urban and shown as:



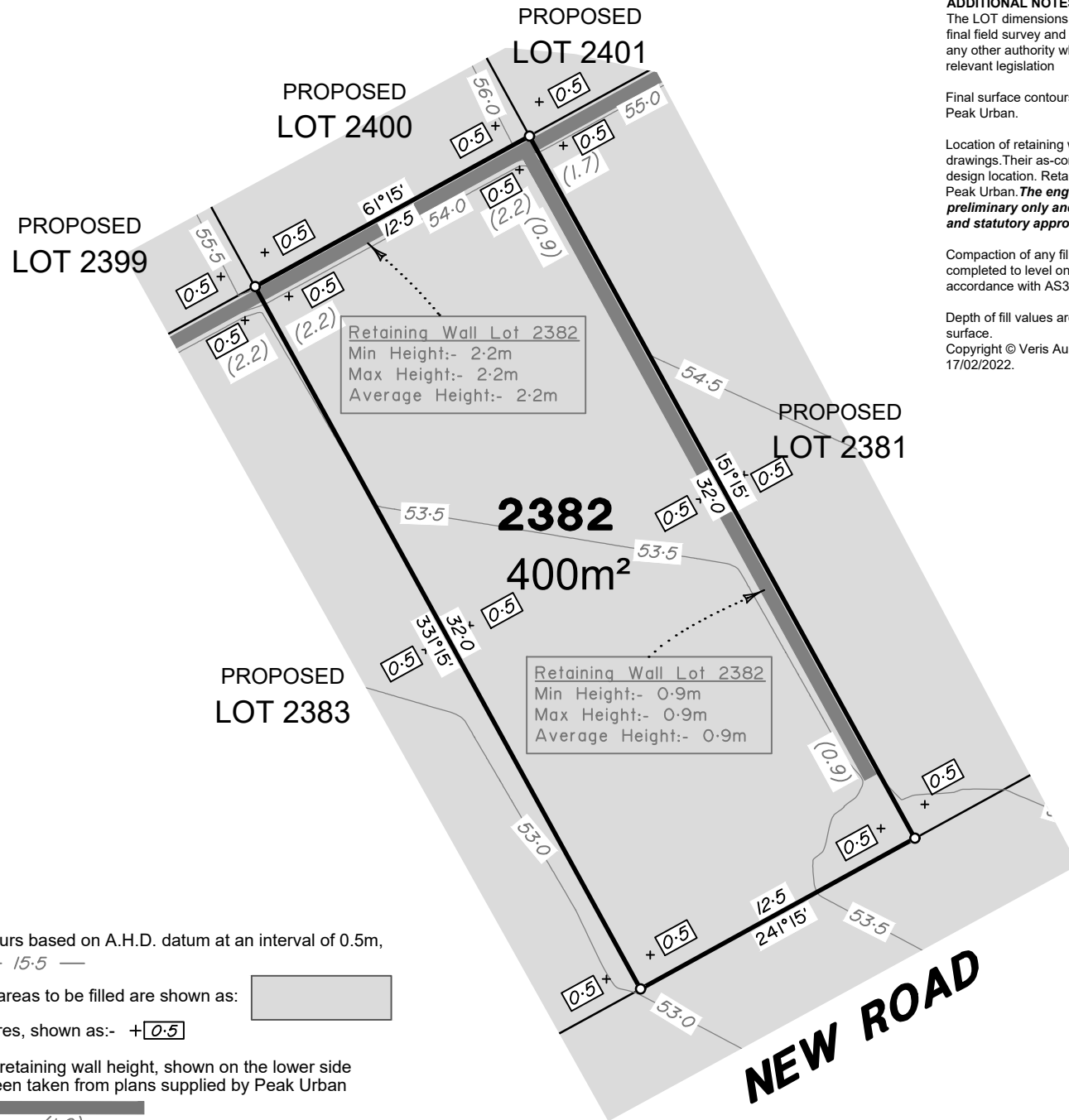

LEGEND

Final surface contours based on A.H.D. datum at an interval of 0.5m, shown as: 15.5

Where applicable, areas to be filled are shown as:

Depth of fill, in metres, shown as:- +0.5

Retaining wall and retaining wall height, shown on the lower side of the wall, have been taken from plans supplied by Peak Urban and shown as: (1.2)



ADDITIONAL NOTES:

The LOT dimensions and area shown hereon are subject to final field survey and also to the requirements of Council and any other authority which may have requirements under any relevant legislation

Final surface contours shown hereon have been supplied by Peak Urban.

Location of retaining walls are as shown on Engineering design drawings. Their as-constructed location may differ from their design location. Retaining wall heights have been supplied by Peak Urban. **The engineering detail shown hereon are preliminary only and are subject to change in final design and statutory approvals**

Compaction of any fill material placed on this site shall be completed to level one inspection and testing services in accordance with AS3798-2007.

Depth of fill values are calculated to the pre-development surface.
Copyright © Veris Australia Pty Ltd
17/02/2022.

**FLAGSTONE
PRECINCT 1 STAGE 5A(i)**
For
**PEET FLAGSTONE
CITY PTY LTD**

IMPORTANT NOTES:
(These notes are an integral part of this plan)

This plan has been prepared for **PEET FLAGSTONE CITY PTY LTD** for the purposes of **A Disclosure Plan Under the Land Sales Act 1984 (as amended)**.

It is not to be used by any other person or corporation or for any other purposes and is subject to the following limitations:

Please refer to the approved Development Application for conditions relating to the LOT and to approved Operational Works drawings for services location and possible easements.

THESE DESIGNS AND DRAWINGS ARE COPYRIGHT AND ARE NOT TO BE USED OR REPRODUCED WITHOUT THE WRITTEN PERMISSION OF VERIS

Data Sources
Cadastral Boundaries
30109-LC-Master(CU) F594 2014.dwg
Engineering Design
FLAGSTONE - BASE - STAGE 5A 5B - DISCLOSURE INFO - 27 01 2022.dwg
Final Surface Contours
FLAGSTONE - BASE - STAGE 5A 5B - DISCLOSURE INFO - 27 01 2022.dwg
Depth of Fill
FLAGSTONE - DEPTH RANGE CONTOURS - STAGE 5A 5B - DISCLOSURE INFO - 27 01 2022.dwg

Issue	Revisions	Date	BK	Drawn
A	Original	16.02.2022		

Locality: FLAGSTONE
Local Authority: LOGAN CITY COUNCIL
Horizontal Meridian: MGA, Zone 56
Vertical Level Datum: AHD D
Scale: 1:250 @ A4
Designed: Peak Urban
Drawn: BK 16/02/2022
Checked: DE 17/02/2022
Plot Date: 17 Feb, 2022
Computer File Ref: 30109-St5A-DP-(A).dwg

DISCLOSURE PLAN
of Proposed LOT 2382
being part of
Lot 911
on SP321079



veris

BRISBANE WHITSUNDAYS
(07) 3666 4700 (07) 4945 6600

MACKAY CAIRNS
(07) 4957 9700 (07) 4252 9400

veris.com.au
ACN 615 735 727
Veris Australia Pty Ltd

Drawing No Issue
30109-DP- 2382 A



Retaining Wall Lot 2383
 Min Height:- 2.2m
 Max Height:- 2.2m
 Average Height:- 2.2m

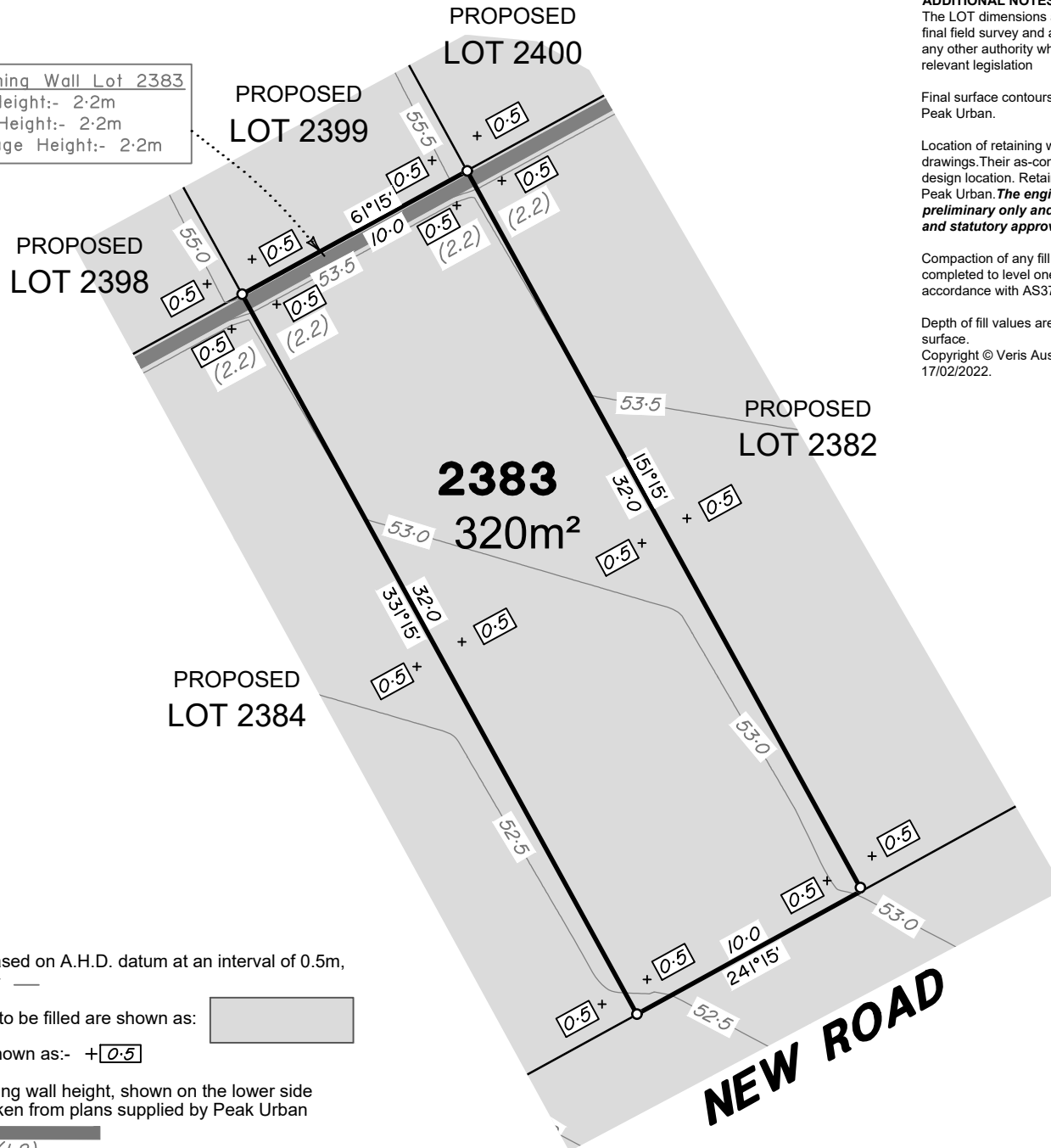

LEGEND

Final surface contours based on A.H.D. datum at an interval of 0.5m, shown as: 15.5

Where applicable, areas to be filled are shown as:

Depth of fill, in metres, shown as:- +0.5

Retaining wall and retaining wall height, shown on the lower side of the wall, have been taken from plans supplied by Peak Urban and shown as: (1.2)



ADDITIONAL NOTES:

The LOT dimensions and area shown hereon are subject to final field survey and also to the requirements of Council and any other authority which may have requirements under any relevant legislation

Final surface contours shown hereon have been supplied by Peak Urban.

Location of retaining walls are as shown on Engineering design drawings. Their as-constructed location may differ from their design location. Retaining wall heights have been supplied by Peak Urban. **The engineering detail shown hereon are preliminary only and are subject to change in final design and statutory approvals**

Compaction of any fill material placed on this site shall be completed to level one inspection and testing services in accordance with AS3798-2007.

Depth of fill values are calculated to the pre-development surface.
 Copyright © Veris Australia Pty Ltd
 17/02/2022.

FLAGSTONE
 PRECINCT 1 STAGE 5A(i)
 For
 PEET FLAGSTONE
 CITY PTY LTD

IMPORTANT NOTES:
 (These notes are an integral part of this plan)

This plan has been prepared for PEET FLAGSTONE CITY PTY LTD for the purposes of A Disclosure Plan Under the Land Sales Act 1984 (as amended).

It is not to be used by any other person or corporation or for any other purposes and is subject to the following limitations:

Please refer to the approved Development Application for conditions relating to the LOT and to approved Operational Works drawings for services location and possible easements.

THESE DESIGNS AND DRAWINGS ARE COPYRIGHT AND ARE NOT TO BE USED OR REPRODUCED WITHOUT THE WRITTEN PERMISSION OF VERIS

Data Sources
 Cadastral Boundaries
 30109-LC-Master(CU) F594 2014.dwg
 Engineering Design
 FLAGSTONE - BASE - STAGE 5A 5B - DISCLOSURE INFO - 27 01 2022.dwg
 Final Surface Contours
 FLAGSTONE - BASE - STAGE 5A 5B - DISCLOSURE INFO - 27 01 2022.dwg
 Depth of Fill
 FLAGSTONE - DEPTH RANGE CONTOURS - STAGE 5A 5B - DISCLOSURE INFO - 27 01 2022.dwg

Issue	Revisions	Date	BK	Drawn
A	Original	16.02.2022		

Locality: FLAGSTONE
 Local Authority: LOGAN CITY COUNCIL
 Horizontal Meridian: MGA, Zone 56
 Vertical Level Datum: AHD D
 Scale: 1:250 @ A4
 Designed: Peak Urban
 Drawn: BK 16/02/2022
 Checked: DE 17/02/2022
 Plot Date: 17 Feb, 2022
 Computer File Ref: 30109-St5Ai-DP-(A).dwg

DISCLOSURE PLAN
 of Proposed LOT 2383
 being part of
 Lot 911
 on SP321079



veris

BRISBANE WHITSUNDAYS
 (07) 3668 4700 (07) 4945 6600

MACKAY CAIRNS
 (07) 4957 9700 (07) 4252 9400

veris.com.au
 ACN 615 735 727
 Veris Australia Pty Ltd

Drawing No Issue
 30109-DP- 2383 A

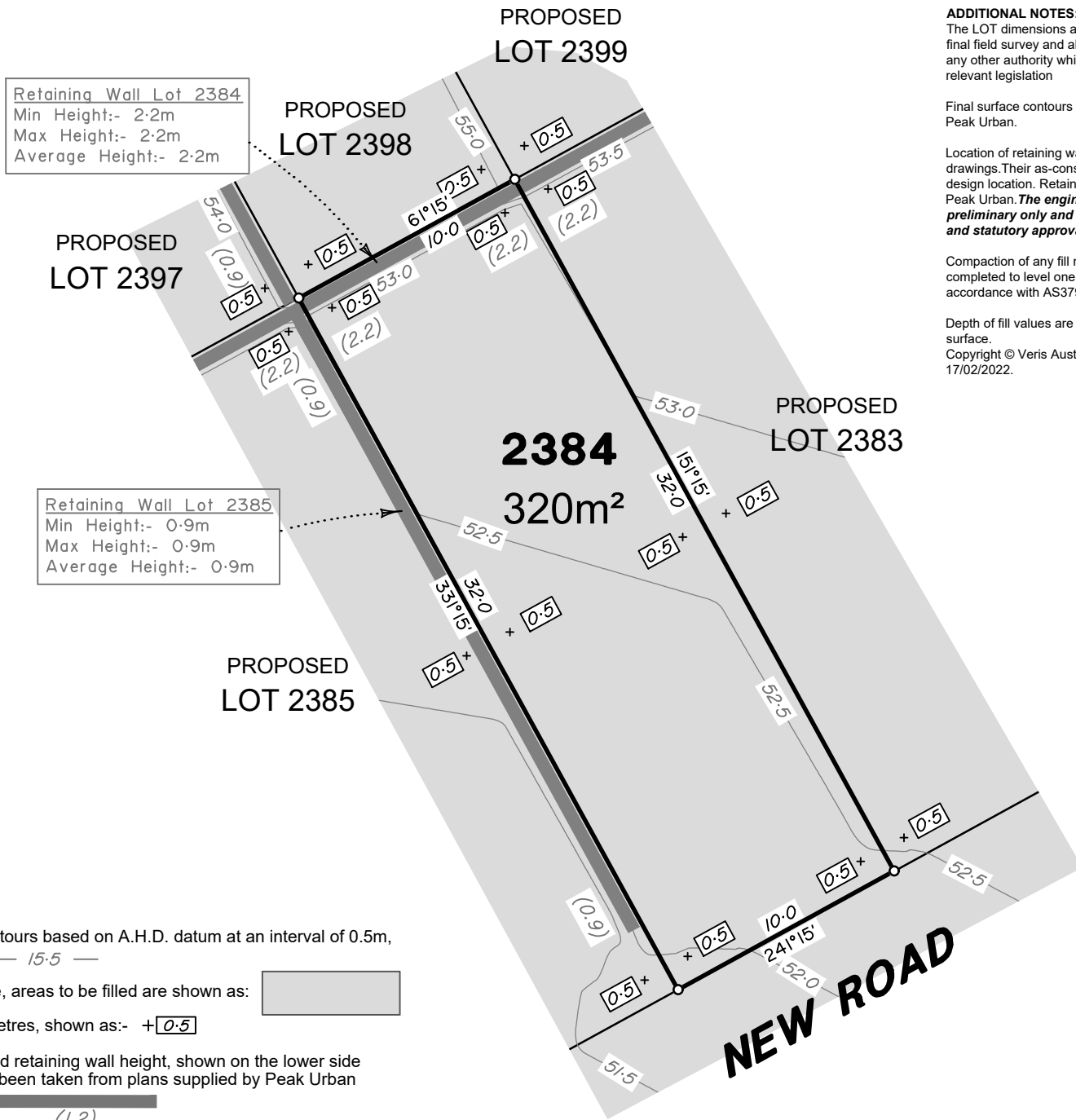

Retaining Wall Lot 2384
 Min Height:- 2.2m
 Max Height:- 2.2m
 Average Height:- 2.2m

Retaining Wall Lot 2385
 Min Height:- 0.9m
 Max Height:- 0.9m
 Average Height:- 0.9m

PROPOSED LOT 2399

PROPOSED LOT 2398

PROPOSED LOT 2397

2384
320m²

PROPOSED LOT 2383

PROPOSED LOT 2385

NEW ROAD

LEGEND

Final surface contours based on A.H.D. datum at an interval of 0.5m, shown as: 15.5

Where applicable, areas to be filled are shown as:

Depth of fill, in metres, shown as:- 0.5

Retaining wall and retaining wall height, shown on the lower side of the wall, have been taken from plans supplied by Peak Urban and shown as: (1.2)

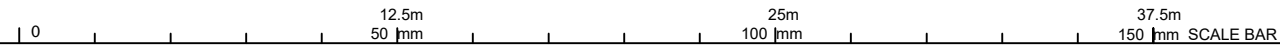

ADDITIONAL NOTES:

The LOT dimensions and area shown hereon are subject to final field survey and also to the requirements of Council and any other authority which may have requirements under any relevant legislation

Final surface contours shown hereon have been supplied by Peak Urban.

Location of retaining walls are as shown on Engineering design drawings. Their as-constructed location may differ from their design location. Retaining wall heights have been supplied by Peak Urban. **The engineering detail shown hereon are preliminary only and are subject to change in final design and statutory approvals**

Compaction of any fill material placed on this site shall be completed to level one inspection and testing services in accordance with AS3798-2007.

Depth of fill values are calculated to the pre-development surface.

Copyright © Veris Australia Pty Ltd
 17/02/2022.

**FLAGSTONE
 PRECINCT 1 STAGE 5A(i)**
 For
**PEET FLAGSTONE
 CITY PTY LTD**

IMPORTANT NOTES:
 (These notes are an integral part of this plan)

This plan has been prepared for **PEET FLAGSTONE CITY PTY LTD** for the purposes of **A Disclosure Plan Under the Land Sales Act 1984 (as amended)**.

It is not to be used by any other person or corporation or for any other purposes and is subject to the following limitations:

Please refer to the approved Development Application for conditions relating to the LOT and to approved Operational Works drawings for services location and possible easements.

THESE DESIGNS AND DRAWINGS ARE COPYRIGHT AND ARE NOT TO BE USED OR REPRODUCED WITHOUT THE WRITTEN PERMISSION OF VERIS

Data Sources
 Cadastral Boundaries
 30109-LC-Master(CU) F594 2014.dwg
 Engineering Design
 FLAGSTONE - BASE - STAGE 5A 5B - DISCLOSURE INFO - 27 01 2022.dwg
 Final Surface Contours
 FLAGSTONE - BASE - STAGE 5A 5B - DISCLOSURE INFO - 27 01 2022.dwg
 Depth of Fill
 FLAGSTONE - DEPTH RANGE CONTOURS - STAGE 5A 5B - DISCLOSURE INFO - 27 01 2022.dwg

Issue	Revisions	Date	Drawn
A	Original	16.02.2022	BK

Locality: FLAGSTONE
 Local Authority: LOGAN CITY COUNCIL
 Horizontal Meridian: MGA, Zone 56
 Vertical Level Datum: AHD D
 Scale: 1:250 @ A4
 Designed: Peak Urban
 Drawn: BK 16/02/2022
 Checked: DE 17/02/2022
 Plot Date: 17 Feb, 2022
 Computer File Ref: 30109-St5A-DP-(A).dwg

DISCLOSURE PLAN
 of Proposed LOT 2384
 being part of
 Lot 911
 on SP321079



veris

BRISBANE WHITSUNDAYS
 (07) 3666 4700 (07) 4945 6600

MACKAY CAIRNS
 (07) 4957 9700 (07) 4252 9400

veris.com.au
 ACN 615 735 727
 Veris Australia Pty Ltd

Drawing No
30109-DP- 2384
 Issue
A



Retaining Wall Lot 2385
 Min Height:- 2.2m
 Max Height:- 2.2m
 Average Height:- 2.2m

PROPOSED
 LOT 2396

PROPOSED
 LOT 2397

PROPOSED
 LOT 2398

PROPOSED
 LOT 2386

PROPOSED
 LOT 2384

2385
 400m²

Retaining Wall Lot 2385
 Min Height:- 0.9m
 Max Height:- 0.9m
 Average Height:- 0.9m

ADDITIONAL NOTES:

The LOT dimensions and area shown hereon are subject to final field survey and also to the requirements of Council and any other authority which may have requirements under any relevant legislation

Final surface contours shown hereon have been supplied by Peak Urban.

Location of retaining walls are as shown on Engineering design drawings. Their as-constructed location may differ from their design location. Retaining wall heights have been supplied by Peak Urban. **The engineering detail shown hereon are preliminary only and are subject to change in final design and statutory approvals**

Compaction of any fill material placed on this site shall be completed to level one inspection and testing services in accordance with AS3798-2007.

Depth of fill values are calculated to the pre-development surface.
 Copyright © Veris Australia Pty Ltd
 17/02/2022.

FLAGSTONE
 PRECINCT 1 STAGE 5A(i)
 For
 PEET FLAGSTONE
 CITY PTY LTD

IMPORTANT NOTES:
 (These notes are an integral part of this plan)

This plan has been prepared for PEET FLAGSTONE CITY PTY LTD for the purposes of a Disclosure Plan Under the Land Sales Act 1984 (as amended).

It is not to be used by any other person or corporation or for any other purposes and is subject to the following limitations:

Please refer to the approved Development Application for conditions relating to the LOT and to approved Operational Works drawings for services location and possible easements.

THESE DESIGNS AND DRAWINGS ARE COPYRIGHT AND ARE NOT TO BE USED OR REPRODUCED WITHOUT THE WRITTEN PERMISSION OF VERIS

Data Sources
 Cadastral Boundaries
 30109-LC-Master(CU) F594 2014.dwg
 Engineering Design
 FLAGSTONE - BASE - STAGE 5A 5B - DISCLOSURE INFO - 27 01 2022.dwg
 Final Surface Contours
 FLAGSTONE - BASE - STAGE 5A 5B - DISCLOSURE INFO - 27 01 2022.dwg
 Depth of Fill
 FLAGSTONE - DEPTH RANGE CONTOURS - STAGE 5A 5B - DISCLOSURE INFO - 27 01 2022.dwg

Issue	Revisions	Date	BK	Drawn
A	Original	16.02.2022	BK	

Locality: FLAGSTONE
 Local Authority: LOGAN CITY COUNCIL
 Horizontal Meridian: MGA, Zone 56
 Vertical Level Datum: AHD D
 Scale: 1:250 @ A4
 Designed: Peak Urban
 Drawn: BK 16/02/2022
 Checked: DE 17/02/2022
 Plot Date: 17 Feb, 2022
 Computer File Ref: 30109-St5Ai-DP-(A).dwg

DISCLOSURE PLAN
 of Proposed LOT 2385
 being part of
 Lot 911
 on SP321079



veris

BRISBANE WHITSUNDAYS
 (07) 3688 4700 (07) 4945 6600

MACKAY CAIRNS
 (07) 4957 9700 (07) 4252 9400

veris.com.au
 ACN 615 735 727
 Veris Australia Pty Ltd

Drawing No Issue
 30109-DP- 2385 A

LEGEND

Final surface contours based on A.H.D. datum at an interval of 0.5m, shown as: 15.5

Where applicable, areas to be filled are shown as:

Depth of fill, in metres, shown as:- +0.5

Retaining wall and retaining wall height, shown on the lower side of the wall, have been taken from plans supplied by Peak Urban and shown as:





Retaining Wall Lot 2386
 Min Height:- 2.2m
 Max Height:- 2.3m
 Average Height:- 2.25m

Retaining Wall Lot 2387
 Min Height:- 0.7m
 Max Height:- 0.7m
 Average Height:- 0.7m

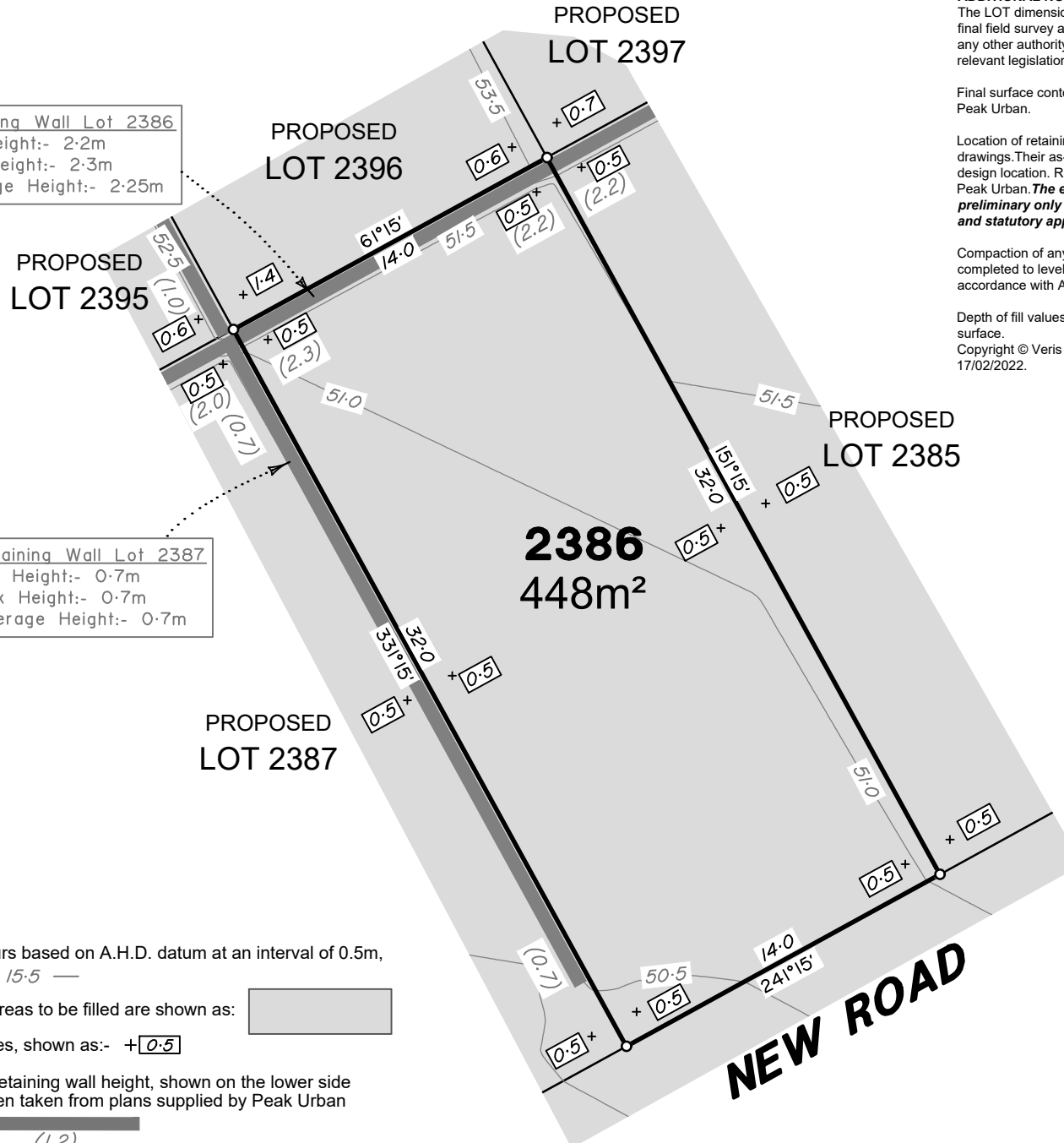

LEGEND

Final surface contours based on A.H.D. datum at an interval of 0.5m, shown as: 15.5

Where applicable, areas to be filled are shown as:

Depth of fill, in metres, shown as:- +0.5

Retaining wall and retaining wall height, shown on the lower side of the wall, have been taken from plans supplied by Peak Urban and shown as: (1.2)

ADDITIONAL NOTES:

The LOT dimensions and area shown hereon are subject to final field survey and also to the requirements of Council and any other authority which may have requirements under any relevant legislation

Final surface contours shown hereon have been supplied by Peak Urban.

Location of retaining walls are as shown on Engineering design drawings. Their as-constructed location may differ from their design location. Retaining wall heights have been supplied by Peak Urban. **The engineering detail shown hereon are preliminary only and are subject to change in final design and statutory approvals**

Compaction of any fill material placed on this site shall be completed to level one inspection and testing services in accordance with AS3798-2007.

Depth of fill values are calculated to the pre-development surface.
 Copyright © Veris Australia Pty Ltd
 17/02/2022.

FLAGSTONE PRECINCT 1 STAGE 5A(i) For PEET FLAGSTONE CITY PTY LTD

IMPORTANT NOTES:

(These notes are an integral part of this plan)

This plan has been prepared for PEET FLAGSTONE CITY PTY LTD for the purposes of a Disclosure Plan Under the Land Sales Act 1984 (as amended).

It is not to be used by any other person or corporation or for any other purposes and is subject to the following limitations:

Please refer to the approved Development Application for conditions relating to the LOT and to approved Operational Works drawings for services location and possible easements.

THESE DESIGNS AND DRAWINGS ARE COPYRIGHT AND ARE NOT TO BE USED OR REPRODUCED WITHOUT THE WRITTEN PERMISSION OF VERIS

Data Sources
 Cadastral Boundaries
 30109-LC-Master(CU) F594 2014.dwg
 Engineering Design
 FLAGSTONE - BASE - STAGE 5A 5B - DISCLOSURE INFO - 27 01 2022.dwg
 Final Surface Contours
 FLAGSTONE - BASE - STAGE 5A 5B - DISCLOSURE INFO - 27 01 2022.dwg
 Depth of Fill
 FLAGSTONE - DEPTH RANGE CONTOURS - STAGE 5A 5B - DISCLOSURE INFO - 27 01 2022.dwg

Issue	Revisions	Date	BK	Drawn
A	Original	16.02.2022		

Locality: FLAGSTONE
 Local Authority: LOGAN CITY COUNCIL
 Horizontal Meridian: MGA, Zone 56
 Vertical Level Datum: AHD D
 Scale: 1:250 @ A4
 Designed: Peak Urban
 Drawn: BK 16/02/2022
 Checked: DE 17/02/2022
 Plot Date: 17 Feb, 2022
 Computer File Ref: 30109-St5Ai-DP-(A).dwg

DISCLOSURE PLAN of Proposed LOT 2386 being part of Lot 911 on SP321079



BRISBANE WHITSUNDAYS
 (07) 3686 4700 (07) 4945 6600

MACKAY CAIRNS
 (07) 4957 9700 (07) 4252 9400

veris.com.au
 ACN 615 735 727
 Veris Australia Pty Ltd

Drawing No Issue
 30109-DP- 2386 A



Retaining Wall Lot 2387
 Min Height:- 2.0m
 Max Height:- 2.0m
 Average Height:- 2.0m

PROPOSED
 LOT 2394

PROPOSED
 LOT 2395

PROPOSED
 LOT 2396

Retaining Wall Lot 2387
 Min Height:- 0.7m
 Max Height:- 0.7m
 Average Height:- 0.70m

PROPOSED
 LOT 2386

2387
400m²

PROPOSED
 LOT 2388

NEW ROAD

ADDITIONAL NOTES:

The LOT dimensions and area shown hereon are subject to final field survey and also to the requirements of Council and any other authority which may have requirements under any relevant legislation

Final surface contours shown hereon have been supplied by Peak Urban.

Location of retaining walls are as shown on Engineering design drawings. Their as-constructed location may differ from their design location. Retaining wall heights have been supplied by Peak Urban. **The engineering detail shown hereon are preliminary only and are subject to change in final design and statutory approvals**

Compaction of any fill material placed on this site shall be completed to level one inspection and testing services in accordance with AS3798-2007.

Depth of fill values are calculated to the pre-development surface.
 Copyright © Veris Australia Pty Ltd
 17/02/2022.

**FLAGSTONE
 PRECINCT 1 STAGE 5A(i)**
 For
**PEET FLAGSTONE
 CITY PTY LTD**

IMPORTANT NOTES:
 (These notes are an integral part of this plan)

This plan has been prepared for **PEET FLAGSTONE CITY PTY LTD** for the purposes of **A Disclosure Plan Under the Land Sales Act 1984 (as amended)**.

It is not to be used by any other person or corporation or for any other purposes and is subject to the following limitations:

Please refer to the approved Development Application for conditions relating to the LOT and to approved Operational Works drawings for services location and possible easements.

THESE DESIGNS AND DRAWINGS ARE COPYRIGHT AND ARE NOT TO BE USED OR REPRODUCED WITHOUT THE WRITTEN PERMISSION OF VERIS

Data Sources
 Cadastral Boundaries
 30109-LC-Master(CU) F594 2014.dwg
 Engineering Design
 FLAGSTONE - BASE - STAGE 5A 5B - DISCLOSURE INFO - 27 01 2022.dwg
 Final Surface Contours
 FLAGSTONE - BASE - STAGE 5A 5B - DISCLOSURE INFO - 27 01 2022.dwg
 Depth of Fill
 FLAGSTONE - DEPTH RANGE CONTOURS - STAGE 5A 5B - DISCLOSURE INFO - 27 01 2022.dwg

Issue	Revisions	Date	BK	Drawn
A	Original	16.02.2022	BK	

Locality: FLAGSTONE
 Local Authority: LOGAN CITY COUNCIL
 Horizontal Meridian: MGA, Zone 56
 Vertical Level Datum: AHD D
 Scale: 1:250 @ A4
 Designed: Peak Urban
 Drawn: BK 16/02/2022
 Checked: DE 17/02/2022
 Plot Date: 17 Feb, 2022
 Computer File Ref: 30109-St5Ai-DP-(A).dwg

**DISCLOSURE PLAN
 of Proposed LOT 2387**
 being part of
 Lot 911
 on SP321079



BRISBANE WHITSUNDAYS
 (07) 3666 4700 (07) 4945 6600
 MACKAY CAIRNS
 (07) 4957 9700 (07) 4252 9400
 veris.com.au
 ACN 615 735 727
 Veris Australia Pty Ltd

Drawing No Issue
30109-DP- 2387 A

LEGEND

Final surface contours based on A.H.D. datum at an interval of 0.5m, shown as: 15.5

Where applicable, areas to be filled are shown as:

Depth of fill, in metres, shown as:- +0.5

Retaining wall and retaining wall height, shown on the lower side of the wall, have been taken from plans supplied by Peak Urban and shown as:

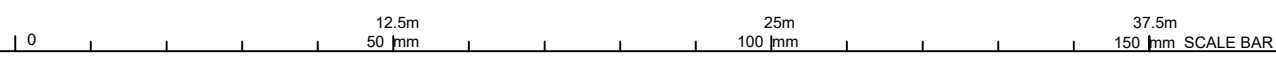



Retaining Wall Lot 2388
 Min Height:- 2.0m
 Max Height:- 2.0m
 Average Height:- 2.0m

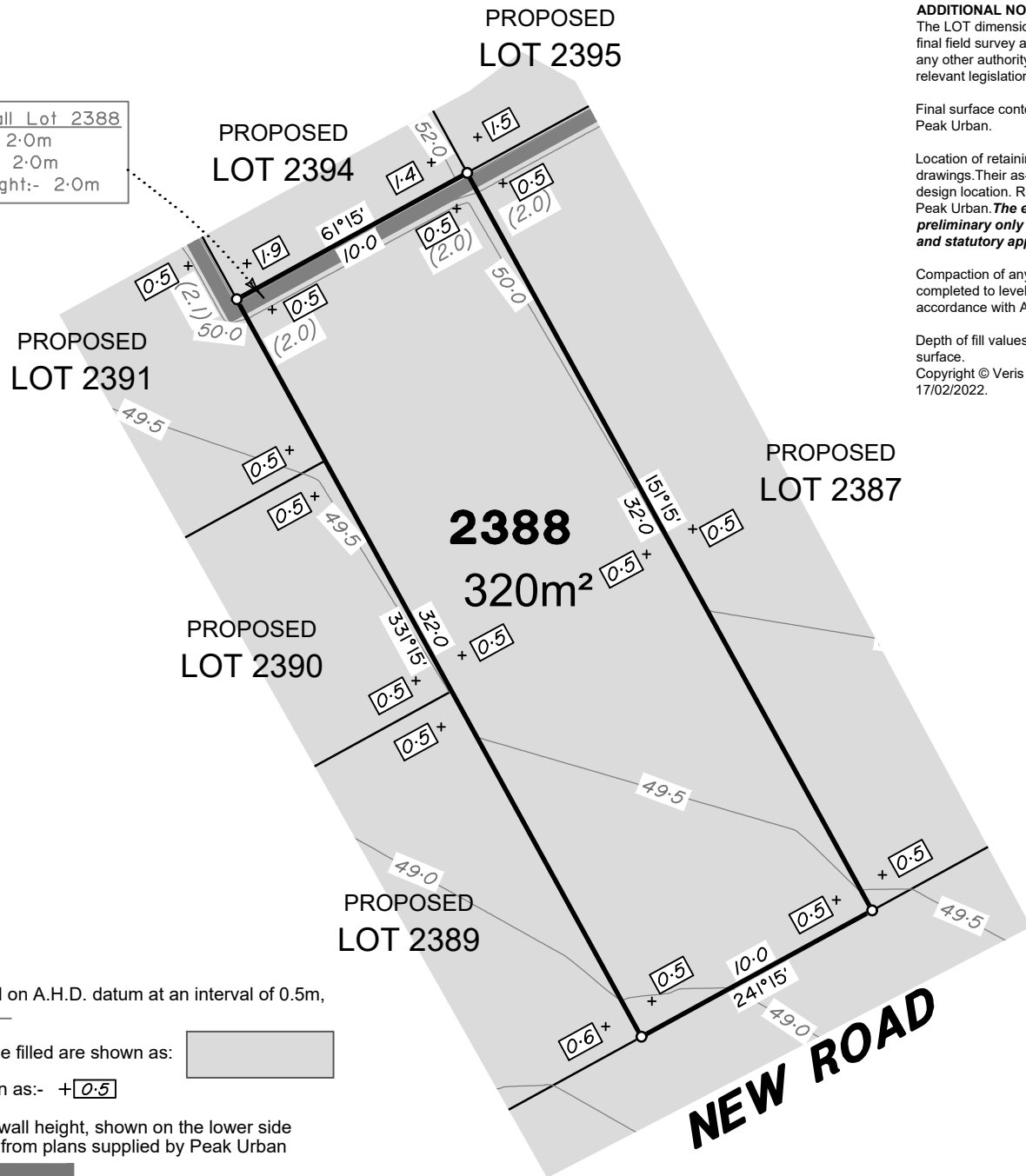

PROPOSED
 LOT 2395

PROPOSED
 LOT 2394

PROPOSED
 LOT 2391

PROPOSED
 LOT 2387

PROPOSED
 LOT 2390

PROPOSED
 LOT 2389

2388
 320m²

NEW ROAD

ADDITIONAL NOTES:

The LOT dimensions and area shown hereon are subject to final field survey and also to the requirements of Council and any other authority which may have requirements under any relevant legislation

Final surface contours shown hereon have been supplied by Peak Urban.

Location of retaining walls are as shown on Engineering design drawings. Their as-constructed location may differ from their design location. Retaining wall heights have been supplied by Peak Urban. **The engineering detail shown hereon are preliminary only and are subject to change in final design and statutory approvals**

Compaction of any fill material placed on this site shall be completed to level one inspection and testing services in accordance with AS3798-2007.

Depth of fill values are calculated to the pre-development surface.
 Copyright © Veris Australia Pty Ltd
 17/02/2022.

**FLAGSTONE
 PRECINCT 1 STAGE 5A(i)**
 For
**PEET FLAGSTONE
 CITY PTY LTD**

IMPORTANT NOTES:
 (These notes are an integral part of this plan)

This plan has been prepared for **PEET FLAGSTONE CITY PTY LTD** for the purposes of **A Disclosure Plan Under the Land Sales Act 1984 (as amended)**.

It is not to be used by any other person or corporation or for any other purposes and is subject to the following limitations:

Please refer to the approved Development Application for conditions relating to the LOT and to approved Operational Works drawings for services location and possible easements.

THESE DESIGNS AND DRAWINGS ARE COPYRIGHT AND ARE NOT TO BE USED OR REPRODUCED WITHOUT THE WRITTEN PERMISSION OF VERIS

Data Sources
 Cadastral Boundaries
 30109-LC-Master(CU) F594 2014.dwg
 Engineering Design
 FLAGSTONE - BASE - STAGE 5A 5B - DISCLOSURE INFO - 27 01 2022.dwg
 Final Surface Contours
 FLAGSTONE - BASE - STAGE 5A 5B - DISCLOSURE INFO - 27 01 2022.dwg
 Depth of Fill
 FLAGSTONE - DEPTH RANGE CONTOURS - STAGE 5A 5B - DISCLOSURE INFO - 27 01 2022.dwg

Issue	Revisions	Date	BK	Drawn
A	Original	16.02.2022	BK	

Locality: FLAGSTONE
 Local Authority: LOGAN CITY COUNCIL
 Horizontal Meridian: MGA, Zone 56
 Vertical Level Datum: AHD D
 Scale: 1:250 @ A4
 Designed: Peak Urban
 Drawn: BK 16/02/2022
 Checked: DE 17/02/2022
 Plot Date: 17 Feb, 2022
 Computer File Ref: 30109-St5A-DP-(A).dwg

**DISCLOSURE PLAN
 of Proposed LOT 2388**
 being part of
 Lot 911
 on SP321079



veris

BRISBANE (07) 3686 4700 WHITSUNDAYS (07) 4945 6600

MACKAY (07) 4957 9700 CAIRNS (07) 4252 9400

veris.com.au
 ACN 615 735 727
 Veris Australia Pty Ltd

Drawing No
30109-DP- 2388 Issue
A

LEGEND

Final surface contours based on A.H.D. datum at an interval of 0.5m, shown as: 15.5

Where applicable, areas to be filled are shown as:

Depth of fill, in metres, shown as:- +0.5

Retaining wall and retaining wall height, shown on the lower side of the wall, have been taken from plans supplied by Peak Urban and shown as: (1.2)

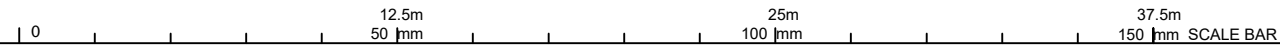



ADDITIONAL NOTES:

The LOT dimensions and area shown hereon are subject to final field survey and also to the requirements of Council and any other authority which may have requirements under any relevant legislation

Final surface contours shown hereon have been supplied by Peak Urban.

Location of retaining walls are as shown on Engineering design drawings. Their as-constructed location may differ from their design location. Retaining wall heights have been supplied by Peak Urban. *The engineering detail shown hereon are preliminary only and are subject to change in final design and statutory approvals*

Compaction of any fill material placed on this site shall be completed to level one inspection and testing services in accordance with AS3798-2007.

Depth of fill values are calculated to the pre-development surface.

Copyright © Veris Australia Pty Ltd
17/02/2022.

**FLAGSTONE
PRECINCT 1 STAGE 5A(i)**
For
**PEET FLAGSTONE
CITY PTY LTD**

IMPORTANT NOTES:
(These notes are an integral part of this plan)

This plan has been prepared for PEET FLAGSTONE CITY PTY LTD for the purposes of a Disclosure Plan Under the Land Sales Act 1984 (as amended).

It is not to be used by any other person or corporation or for any other purposes and is subject to the following limitations:

Please refer to the approved Development Application for conditions relating to the LOT and to approved Operational Works drawings for services location and possible easements.

THESE DESIGNS AND DRAWINGS ARE COPYRIGHT AND ARE NOT TO BE USED OR REPRODUCED WITHOUT THE WRITTEN PERMISSION OF VERIS

Data Sources
Cadastral Boundaries
30109-LC-Master(CU) F594 2014.dwg
Engineering Design
FLAGSTONE - BASE - STAGE 5A 5B - DISCLOSURE INFO - 27 01 2022.dwg
Final Surface Contours
FLAGSTONE - BASE - STAGE 5A 5B - DISCLOSURE INFO - 27 01 2022.dwg
Depth of Fill
FLAGSTONE - DEPTH RANGE CONTOURS - STAGE 5A 5B - DISCLOSURE INFO - 27 01 2022.dwg

Issue	Revisions	Date	Drawn
A	Original	16.02.2022	BK

Locality: FLAGSTONE
Local Authority: LOGAN CITY COUNCIL
Horizontal Meridian: MGA, Zone 56
Vertical Level Datum: AHD D
Scale: 1:250 @ A4
Designed: Peak Urban
Drawn: BK 16/02/2022
Checked: DE 17/02/2022
Plot Date: 17 Feb, 2022
Computer File Ref: 30109-St5A-DP-(A).dwg

**DISCLOSURE PLAN
of Proposed LOT 2389**
being part of
Lot 911
on SP321079



BRISBANE (07) 3686 4700 WHITSUNDAYS (07) 4945 6600

MACKAY (07) 4957 9700 CAIRNS (07) 4252 9400

veris.com.au
ACN 615 735 727
Veris Australia Pty Ltd

Drawing No 30109-DP- 2389 Issue A

LEGEND

Final surface contours based on A.H.D. datum at an interval of 0.5m, shown as: 15.5

Where applicable, areas to be filled are shown as:

Depth of fill, in metres, shown as:- + 0.5

Retaining wall and retaining wall height, shown on the lower side of the wall, have been taken from plans supplied by Peak Urban and shown as: (1.2)

