

FOR CONTINUATION SEE SHEET 2

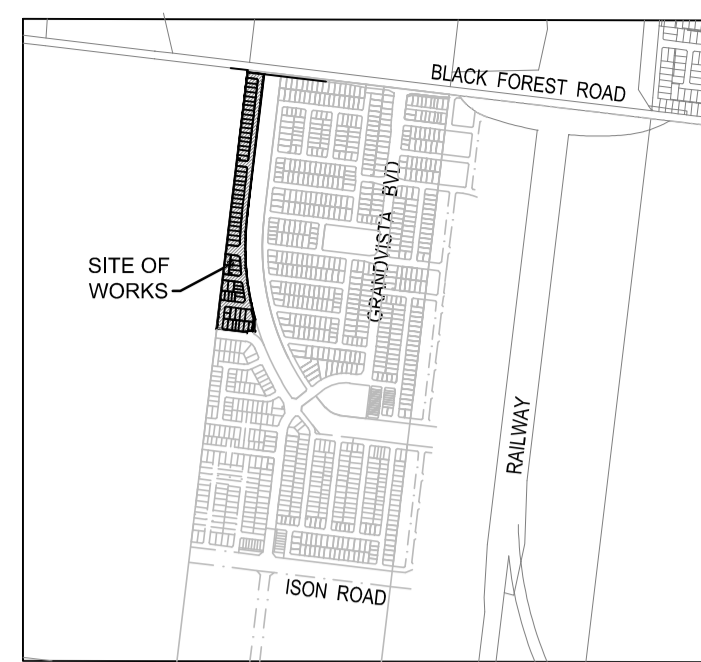

LOCALITY PLAN  
1:20,000

**Planning and Environment Act 1987  
Wyndham Planning Scheme**

**Approved Plan As Required  
under Condition 29  
Permit No WYP8911/15  
Date 23/11/2023**

LOCATION	GAS	WATER		COMMUNICATIONS		ELECTRICITY		BOK	Road Width	Joint Trenching
		NDW	DW	Cables	Pits	Cables	Poles			
MIDFORD AVENUE (\$17 works)	2.25 S	2.70 S	3.30 S	1.85 N	1.85 S	2.60 N	1.00 BOK	4.35S/9.65N	25.50	W & G, F & E
TUFF STREET	2.25 W	2.70 W	3.20 W	0.65 E	1.85 W	1.40 E	1.00 BOK	4.35W/2.55E	14.50	W & G, F & E
TUFF STREET (Lots 2248-2252)	2.25 N	2.70 N	3.20 N	1.85 S	1.85 N	2.60 S	1.00 BOK	4.35N/4.05S	16.00	W & G, F & E
HORSES STREET	2.25 S	2.70 S	3.20 S	2.30 N	1.85 S	3.20 N	-	4.35S/4.05N	16.00	W & G, F & E
DECORATION AVENUE	1.70 S	2.20 S	2.80 S	3.50 S	1.85 N	4.15 S	1.00 BOK	6.60S/6.60N	25.00	W & G, F & E
PANTON STREET	2.25 N	2.70 N	3.20 N	1.85 S	1.85 N	2.60 S	1.00 BOK	4.35N/4.05S	16.00	W & G, F & E
TUFF STREET (Lots 2257-2259)	2.25 E	2.70 E	3.20 E	1.85 E	-	1.30 W	0.80 BOK	4.35E/2.55W	14.50	W & G, F & E

SHT. No.	VER	DRAWING INDEX	
		DESCRIPTION	
1	P4	LAYOUT PLAN AND DETAILS - SHEET 1	
2	P4	LAYOUT PLAN AND DETAILS - SHEET 2	
3	P4	NOTES AND TYPICAL CROSS SECTIONS	
4	P4	INTERSECTION DETAILS - SHEET 1	
5	P4	INTERSECTION DETAILS - SHEET 2	
6	P4	INTERSECTION DETAILS - SHEET 3	
7	P4	LONGITUDINAL SECTION - TUFF STREET	
8	P4	LONGITUDINAL & CROSS SECTIONS - TUFF STREET	
9	P4	CROSS SECTIONS - TUFF STREET	
10	P4	CROSS SECTIONS - TUFF STREET	
11	P4	CROSS SECTIONS - TUFF STREET	
12	P4	LONGITUDINAL & CROSS SECTIONS - HORSES STREET	
13	P4	LONGITUDINAL & CROSS SECTIONS - DECORATION AVENUE, PANTON STREET	
14	P4	DRAINAGE LONGITUDINAL SECTIONS - SHEET 1	
15	P4	DRAINAGE LONGITUDINAL SECTIONS - SHEET 2	
16	P4	DRAINAGE LONGITUDINAL SECTIONS - SHEET 3	
17	P4	DRAINAGE LONGITUDINAL SECTIONS - SHEET 4	
18	P4	DRAINAGE LONGITUDINAL SECTIONS - SHEET 5	
19	P4	SIGNAGE & LINEMARKING PLAN	
20	P4	SEDIMENT BASIN PLAN	



**WARNING**  
BEWARE OF UNDERGROUND SERVICES  
THE LOCATIONS OF UNDERGROUND SERVICES ARE APPROXIMATE ONLY AND THEIR EXACT POSITION SHOULD BE PROVEN ON SITE. NO GUARANTEE IS GIVEN THAT ALL EXISTING SERVICES ARE SHOWN.

- ATTENTION TO CONTRACTOR**
- IT IS THE CONTRACTORS RESPONSIBILITY TO ENSURE THAT THE DIGITAL PLAN, PROVIDED FOR SETOUT PURPOSES, MATCHES THE TBM COORDINATES SHOWN.
  - CONTRACTOR TO ENSURE THAT THE SITE IS PEGGED AND OR SET OUT CHECKED BY THE LICENCED SURVEYOR RESPONSIBLE FOR CERTIFYING THE PLAN OF SUBDIVISION PRIOR TO UNDERGROUND INFRASTRUCTURE BEING INSTALLED.
  - WHERE CONCRETE WORKS ABOUT A SEWER ACCESS CHAMBER SURROUND OR SIMILAR STRUCTURE, AN EXPANSION JOINT OF APPROVED MATERIAL SHALL BE PROVIDED BETWEEN THE TWO FACES.

**SYMBOL LEGEND**

Prop	Prev Stage	Ex/Natural/FS Level	+28.57	+NS28.57	+FS28.57
S	S	FS @ Building Line	+28.28.57		
W	W	Top/Toe of Batter	+10P28.57	+10E28.57	
NW	NW	Top/Bottom RW Level	+TW28.57	+BW28.57	
H	H	100yr Flood Level	+FL28.57		
PSM	PSM	Fill Proposed (<0.3m/±0.3m)			
Rock Ret Wall		Cut Proposed			
Sleeper Ret Wall		Asphalt Surface Prop			
Conduits 50mm	gw	Concrete Surface Prop			
Conduits 100mm	wtd	Concrete Surface Prop			
Street Tree without/with Passive Irrigation (Refer Detail)		Tree To Be Removed			
Ex Drains	Ex W	Tree To Be Retained with Tree Protection Zone (TPZ)			
Ex Water DW/NDW	Ex S				
Ex Sewer/Gas	Ex G				
Ex Elect/Telecomm	Ex E				

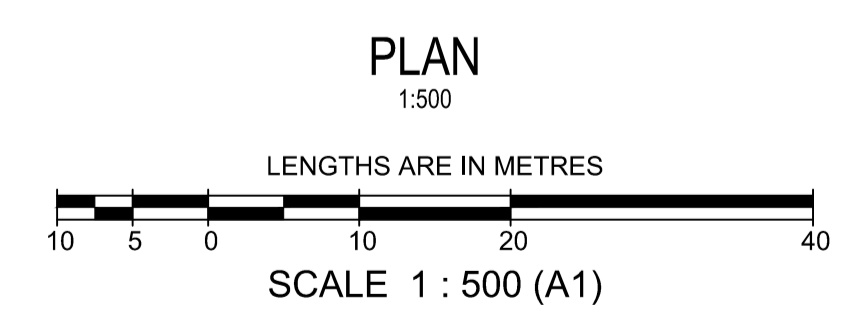

AMENDMENTS		MELWAY REF. 204-G-8		breese pitt dixon pty. ltd. land surveyors civil engineers		1/19 cato street hawthorn east, 3123 telephone 8823 2300 fax no. 8823 2310	
DATE		SURVEY BPD		CORNERSTONE ESTATE STAGE 22		MUNICIPALITY WYNDHAM	
REMARKS		DESIGN BPD		LAYOUT PLAN AND DETAILS - SHEET 1		REFERENCE 8890 E/22	
CHECKED		DRAWN DG		SCALE As Shown DATUM AHD DATE Nov/23		SHEET 1 OF 20 P5	

T:\Projects\BPD\8890 Cornerstone\CAD\Drawings\Stage 22\8890\_E22\_R01-02\_DET.dwg (R01)



FOR CONTINUATION SEE BOTTOM RIGHT

FOR CONTINUATION SEE SHEET 1

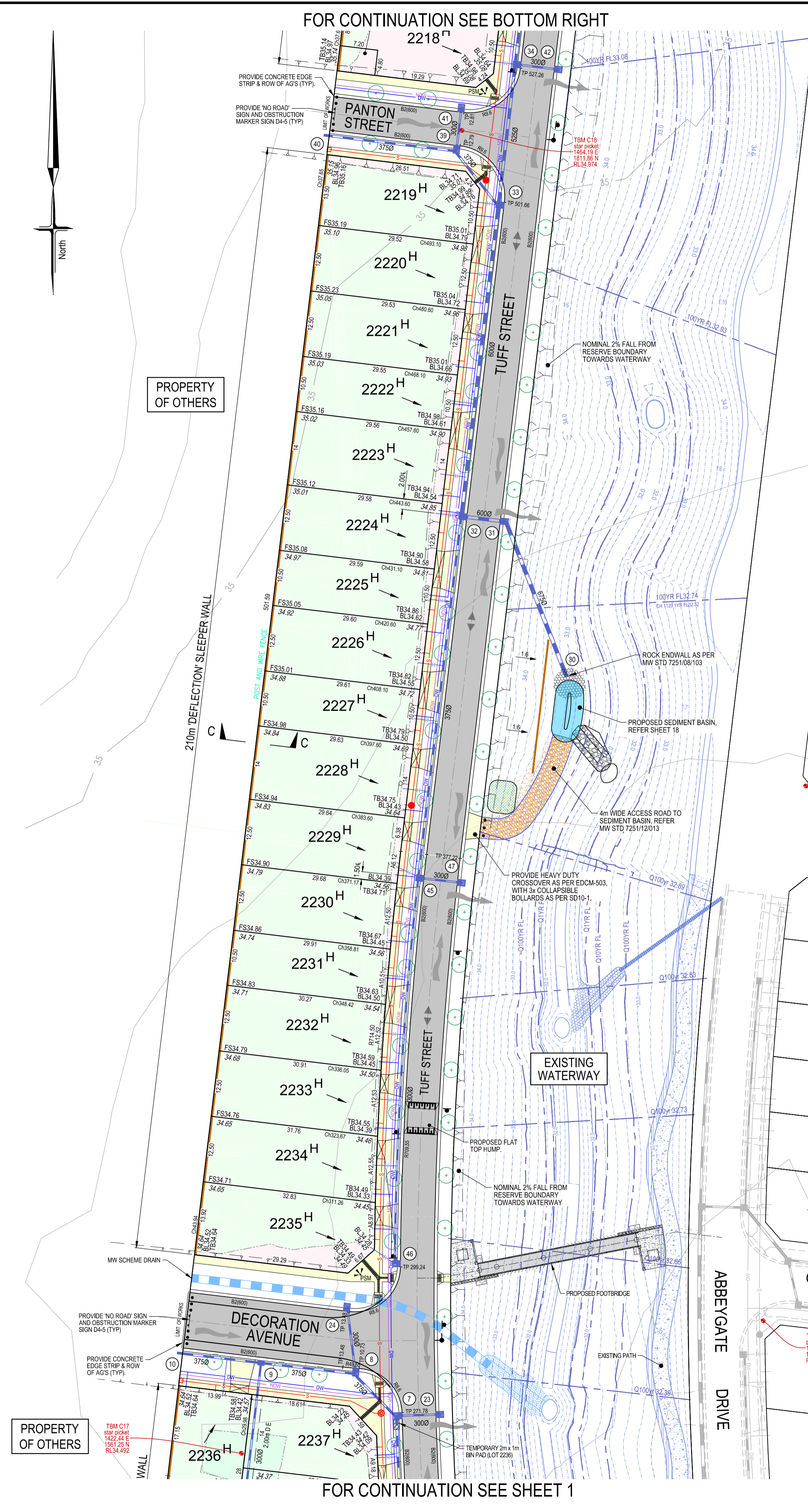

FOR CONTINUATION SEE TOP LEFT

FOR CONTINUATION SEE TOP LEFT

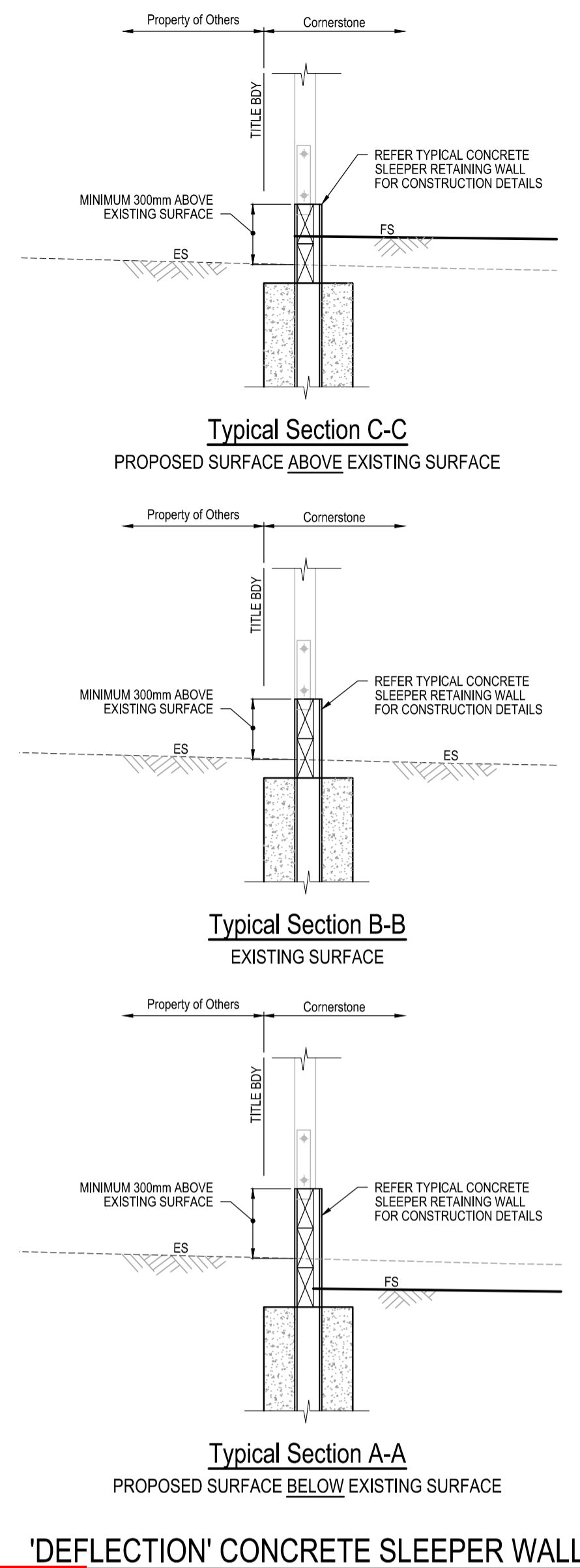
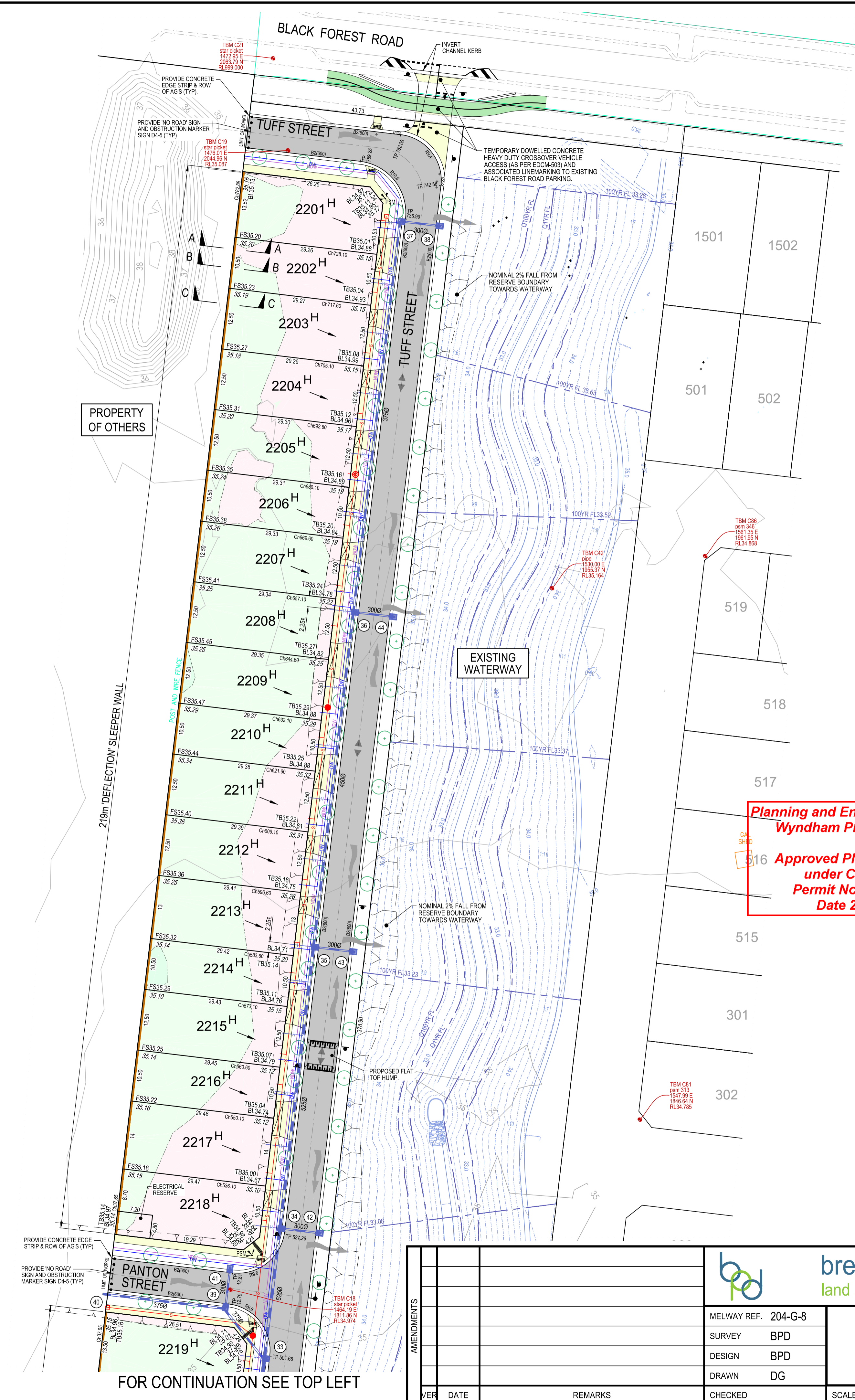

**Planning and Environment Act 1987**  
**Wyndham Planning Scheme**  
 516 Approved Plan As Required  
 under Condition 29  
 Permit No WYP8911/15  
 Date 23/11/2023

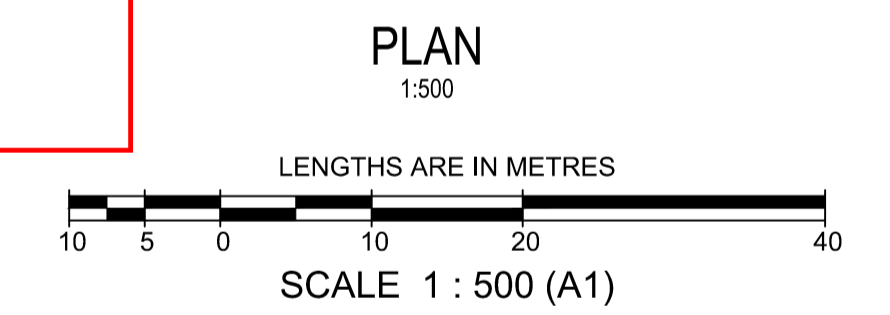

SYMBOL LEGEND		SYMBOL LEGEND	
Prop	Prop Stage	Ex/Natural/FS Level	+28.57 +NS28.57 +FS28.57
S	S	FS @ Building Line	+BL28.57
W	W	Top/Toe of Batter	+TOP28.57 +TOE28.57
NDW	NDW	Top/Bottom RW Level	+TW28.57 +BW28.57
H	H	100yr Flood Level	+FL28.57
PSM	PSM	Fill Proposed (<0.3m/±0.3m)	
Rock Ret Wall	Rock Ret Wall	Cut Proposed	
Sleeper Ret Wall	Sleeper Ret Wall	Asphalt Surface Prop	
Conduits 50mm	Conduits 50mm	Concrete Surface Prop	
Conduits 100mm	Conduits 100mm	(Paths/Driveways/Slabs)	
Street Tree without/with Passive Irrigation (Refer Detail)	Street Tree without/with Passive Irrigation (Refer Detail)	Tree To Be Removed	
Ex Drains	Ex Drains	Tree To Be Retained with Tree Protection Zone (TPZ)	
Ex Water DW/NDW	Ex Water DW/NDW		
Ex Sewer/Gas	Ex Sewer/Gas		
Ex Elect/Telecomm	Ex Elect/Telecomm		

AMENDMENTS		breese pitt dixon pty. ltd. land surveyors civil engineers		1/19 cato street hawthorn east, 3123 telephone 8823 2300 fax no. 8823 2310	
MELWAY REF.	204-G-8	<b>CORNERSTONE ESTATE</b>		MUNICIPALITY	
SURVEY	BPD	<b>STAGE 22</b>		WYNDHAM	
DESIGN	BPD	LAYOUT PLAN AND DETAILS - SHEET 2		REFERENCE	
DRAWN	DG	SCALE As Shown		8890 E/22	
CHECKED	DG	DATUM AHD		SHEET 2 OF 20	
DATE	Nov/23	DATE		P5	