

SERVICES OFFSET SCHEDULE										
STREET NAME	ROAD RESERVE	BACK OF KERB	SEWER	GAS	NON DRINKING WATER	DRINKING WATER	COMMUNICATIONS	ELECTRICITY	LIGHT POLES	TREES
BANDICOOT WAY	15.00	4.55 W / 2.85 E		2.25 W	2.70 W	3.20 W	1.00 E	1.60 E	2.05 E	3.70 W
BANKSIDE DRIVE (RESERVE)	19.00	5.70		2.15 N	2.70 N	3.20 N	2.85 S	3.50 S	4.90 S	3.70 N / 4.0 S
BANKSIDE DRIVE (LOT 131-137)	19.00	5.70		2.15 N	2.70 N	3.20 N	1.85 S	2.60 S	4.90 S	3.70
BERRYBANK TCE (EASTWEST)	24.00	10.70 N / 5.70 S		2.25 S	2.70 S	3.20 S	6.85 N	7.60 N	9.90 N	9.05 N / 3.70 S
BERRYBANK TCE (HERITAGE RESERVE)	18.00	5.20	1.30 E	2.25 W	2.70 W	3.20 W	2.30 E	3.90 E		
BERRYBANK TCE (STH. OF HERITAGE RES.)	18.00	5.20	1.30 E	2.25 W	2.70 W	3.20 W	2.30 E	2.90 E	4.40 E	3.70
BOTTLE TREE ROAD	18.00	5.20	1.00 S	2.25 S	2.70 S	3.20 S	1.85 N	2.60 N	4.40 N	3.70
COCKATOO STREET	18.00	5.20		2.25 S	2.70 S	3.20 S	1.85 N	2.60 N	4.40 N	3.70
CRAIG ROAD	21.30			3.10 E		Ex 1.95-2.25 W	2.40 E	3.40 W		
GUMLEAF PLACE (LOT 155-152)	15.00	2.85 W / 4.55 E		2.25 E	2.70 E	3.20 E	1.00 W	1.60 W	2.05 W	3.70 E
GUMLEAF PLACE (LOT 156-162)	18.00	5.20		2.25 N	2.70 N	3.20 N	1.85 S	2.60 S	4.40 S	3.70
GUMLEAF PLACE (LOT 148-149)	13.00	3.00 W / 2.10 E		2.30 W	0.60 E	1.00 E	0.50 W	1.00 W		
GUMLEAF PLACE (LOT 162-163)	13.00	3.00 W / 2.10 E		2.30 W	1.10 E	1.50 E	0.50 W	1.00 W		
LEMONGRASS LINK	18.00	5.20		2.25 W	2.70 W	3.20 W	1.85 E	2.60 E	4.40 E	3.70
RIVERRUN DRIVE	15.00	4.55 W / 2.85 E		2.25 W	2.70 W	3.20 W	0.40 E	1.10 E	2.05 E	3.70 W

TBM TABLE				
No.	TYPE	EASTING	NORTHING	LEVEL
C1PML	BRASS PLAQUE	350407.38	5776826.93	45.85
C7SSPL	STEEL STAR PICKET	350320.27	5776124.82	41.43
C3SSPL	STEEL STAR PICKET	350222.97	5776696.61	40.69
C4SSPL	STEEL STAR PICKET	350223.96	5776528.10	37.87
C3SSPL	STEEL STAR PICKET	350404.57	5776652.58	39.83
C3SSPL	STEEL STAR PICKET	350335.52	5776377.17	42.47
C7SSPL	STEEL STAR PICKET	350273.73	5776836.73	43.06
C3SSPL	STEEL STAR PICKET	350066.23	5776734.29	42.42

**These plans are design plans and are indicative only and parties must not make any objection, requisition or claim for compensation in relation to the plans. The final condition of lots upon completion may vary from the condition described in the plans.**

**The Property may have been filled, raised, levelled, compacted or cut prior to the Vendor becoming registered proprietor of the Property and the condition of the Property may change after completion of works due to circumstances beyond the Vendor's control. No warranty or representation is given or to be construed in respect of such works or changes in condition. Parties should review the plans carefully, make their own inquiries and obtain independent advice before taking any action in relation to the Property.**

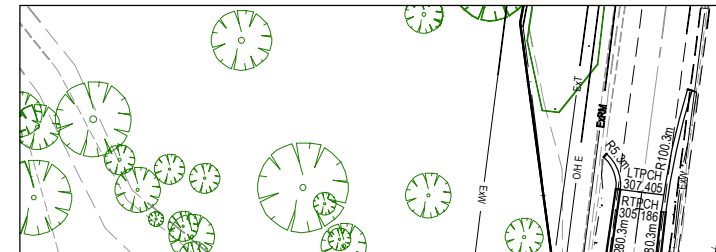

**WARNING**  
**BEWARE OF UNDERGROUND SERVICES**  
 The locations of underground services are approximate only and their exact position should be proven on site.  
 No guarantee is given that all existing services are shown. Locate all underground services before commencement of works.  
**DIAL 1100 BEFORE YOU DIG**  
 www.1100.com.au

**NOTE: FENCING**  
 1. CONSTRUCT FENCE ALONG COMMON BOUNDARY OF LOTS 147, 148 & 163 WITH A RESERVE.  
 2. VEHICLE EXCLUSION MEASURES WHERE ROADS ABOUT A RESERVE ARE TO FORM PART OF THE LANDSCAPE WORKS.

**NOTE: SHARE PATHS**  
 PATHS THROUGH RESERVES ARE INDICATIVE ONLY. FINAL ALIGNMENT TO BE CONFIRMED WITH WETLANDS AND LANDSCAPE DESIGN.

**NOTE: OVERHEAD ELECTRICITY**  
 EXISTING OVERHEAD ELECTRICITY IN CRAIG ROAD TO BE UNDER GROUND PRIOR TO STAGE 1 CONSTRUCTION.

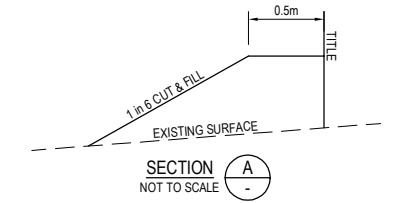

FOR CONTINUATION REFER BELOW LEFT

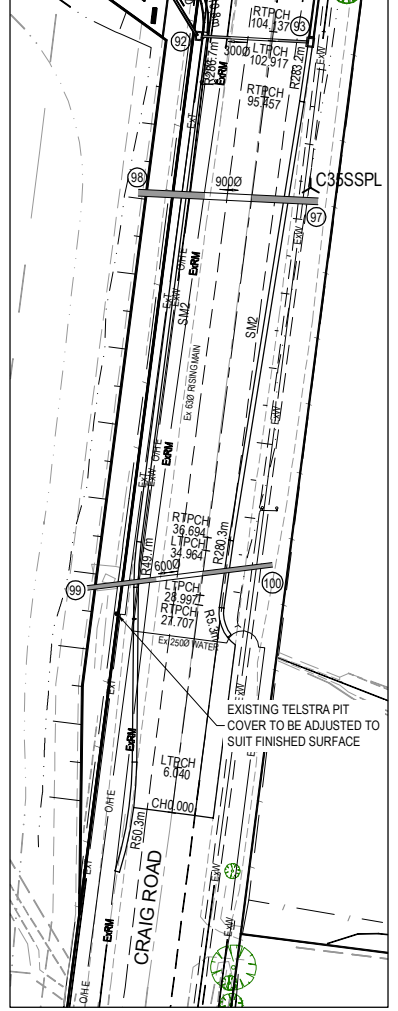

Rev	Amendment	Des/Dt	App'd	Date	Legend
A	Initial Issue	GP/AW	MG	06/05/15	Existing Drain — Ex D —> Drain & Property Inlet —> Existing Surface Level at Title 135.12
B	Council & road name amendments	GP/AW	MG	14/07/15	Existing House Drain — H —> House Drain —> Finished Surface at Title FS135.12
C	Bankside Drive threshold added	MG/AW	MG	28/07/15	Existing Sewer — Ex S —> Level at Top/Toe of Batter/Ridge FT135.12
1	Approved for construction	GP/AW	MG	11/09/15	Existing Gas — Ex G —> Gas & Water Conduits —> Centreline Chirriage CH50.37
2	Driveway lot 138 & drain 91-93 amended	GP/AW	MG	21/10/15	Existing Electricity U/G — Ex E —> PSM / TBM —> Tree to be Removed
3	Driveway, conduit & service offset amendments	GP/AW	MG	13/01/16	Existing Electricity OH — OH E —> Direction of Lot Fall —> Retaining Wall
4	As constructed	GP/AW	MG	23/06/16	Existing Communications — Ex T —> Direction of Overland Flow —> Pavement Treatment
					Existing Water — Ex W —> Allotment to be Evenly Graded —> Structural Fill > 200mm
					Existing Swale Drain —> Vehicle Crossings —> Ex. Structural Fill > 200mm

Principal

Peet Botanic Village Syndicate Ltd  
 Level 3, 492 St Kilda Road  
 Melbourne VIC 3004

Project

**City of Casey**

**Acacia, Botanic Ridge Stage 1**

Title

**Layout Plan Sheet 1 of 2**

Designed: G.Pratt  
 Drafted: A.Wilkins

Council

City of Casey

Project

**Acacia, Botanic Ridge Stage 1**

Title

**Layout Plan Sheet 1 of 2**

Designed: G.Pratt  
 Drafted: A.Wilkins

Scale @ A1: 1:500

Drawing No.

**0055-01-R02**

Sheet

02 of 50

Rev

**4**



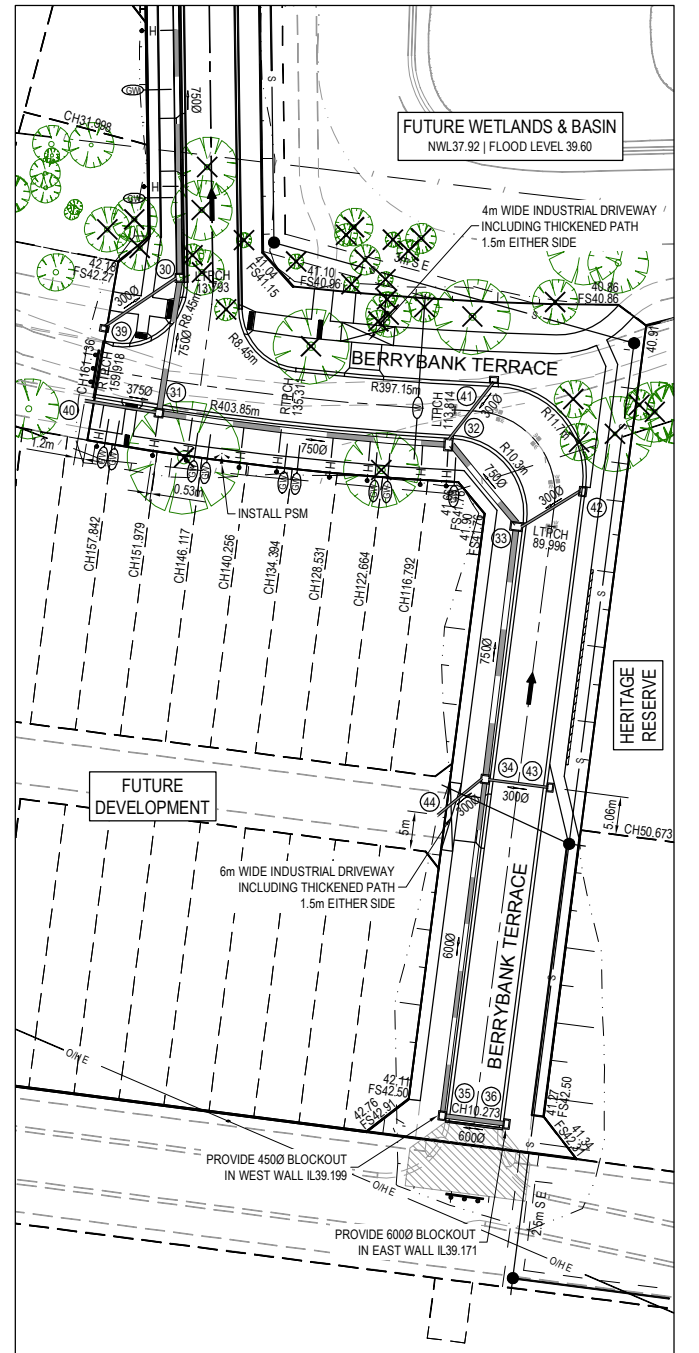
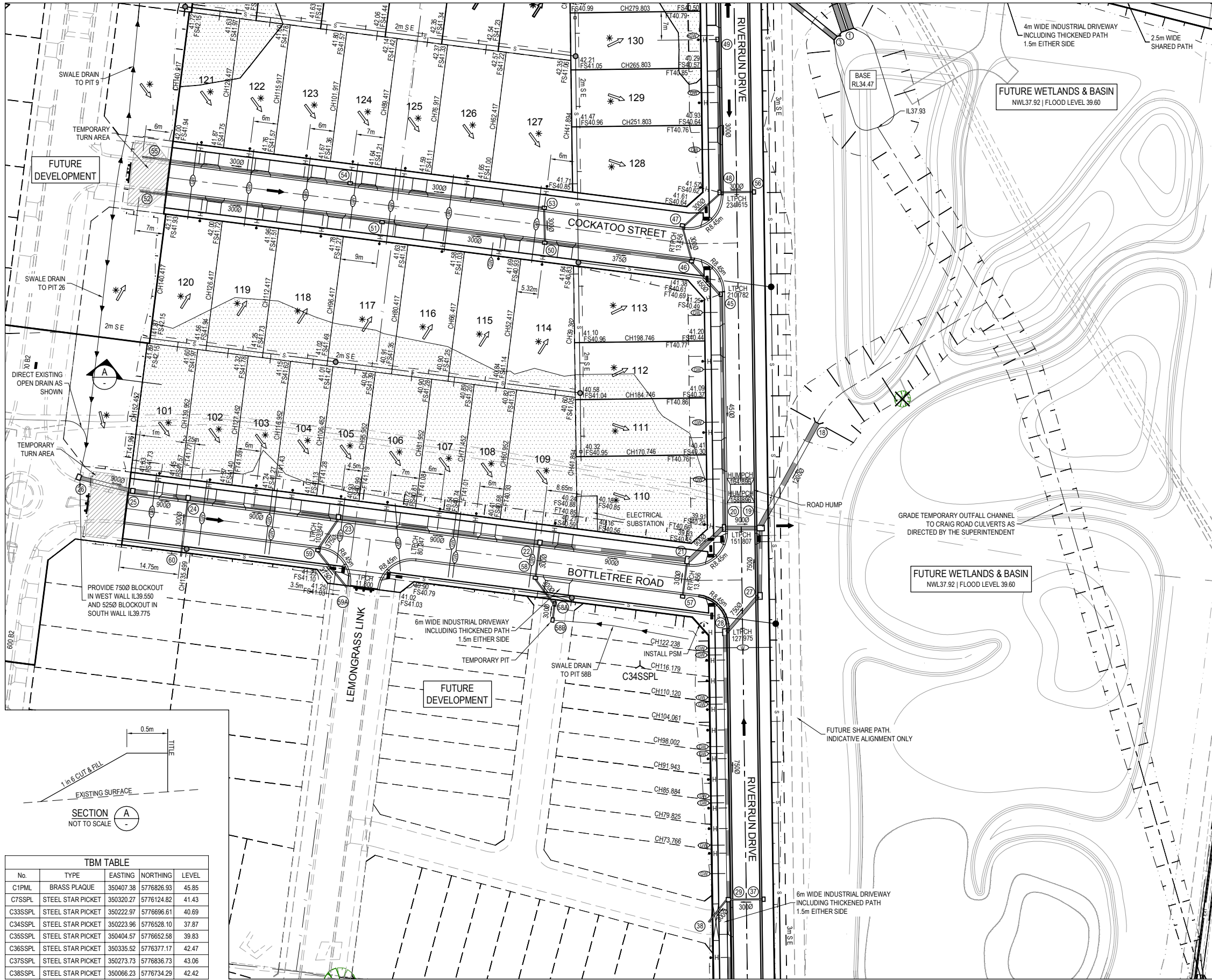

FUTURE DEVELOPMENT

FUTURE WETLANDS & BASIN  
NWL37.92 | FLOOD LEVEL 39.60

FUTURE WETLANDS & BASIN  
NWL37.92 | FLOOD LEVEL 39.60

FUTURE WETLANDS & BASIN  
NWL37.92 | FLOOD LEVEL 39.60

FUTURE DEVELOPMENT

**NOTE: OPEN DRAINS**  
EXISTING OPEN DRAIN IN LOT 101 TO 110 TO BE EXCAVATED TO A SOUND BASE AND FILLED AS SPECIFIED.

**NOTE: FENCING**  
1. CONSTRUCT FENCE ALONG COMMON BOUNDARY OF LOTS 147, 148 & 163 WITH A RESERVE.  
2. VEHICLE EXCLUSION MEASURES WHERE ROADS ABOUT A RESERVE ARE TO FORM PART OF THE LANDSCAPE WORKS.

**NOTE: SHARE PATHS**  
PATHS THROUGH RESERVES ARE INDICATIVE ONLY. FINAL ALIGNMENT TO BE CONFIRMED WITH WETLANDS AND LANDSCAPE DESIGN.

**WARNING**  
**BEWARE OF UNDERGROUND SERVICES**  
The locations of underground services are approximate only and their exact position should be proven on site. No guarantee is given that all existing services are shown. Locate all underground services before commencement of works.  
**DIAL 1100 BEFORE YOU DIG**  
www.1100.com.au

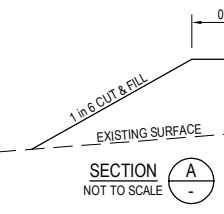

TBM TABLE				
No.	TYPE	EASTING	NORTHING	LEVEL
C1PML	BRASS PLAQUE	350407.38	5776826.93	45.85
C7SSPL	STEEL STAR PICKET	350320.27	5776124.82	41.43
C33SSPL	STEEL STAR PICKET	350222.97	5776696.61	40.69
C34SSPL	STEEL STAR PICKET	350223.96	5776528.10	37.87
C35SSPL	STEEL STAR PICKET	350404.57	5776652.58	39.83
C36SSPL	STEEL STAR PICKET	350335.52	5776377.17	42.47
C37SSPL	STEEL STAR PICKET	350273.73	5776836.73	43.06
C38SSPL	STEEL STAR PICKET	350066.23	5776734.29	42.42

Rev	Amendment	Des/Dtr	App'd	Date	Legend
A	Initial Issue	GP/AW	MG	06/05/15	Existing Drain — Ex D — Drain & Property Inlet — Existing Surface Level at Title 135.12
B	Council, road name & future village housing amendments	GP/AW	MG	14/07/15	Existing House Drain — H — House Drain — Finished Surface at Title FS135.12
1	Approved for construction	GP/AW	MG	11/09/15	Existing Sewer — Ex S — Sewer — Level at Top/Toe of Batter/Ridge FT135.12
2	Driveway lot 127 amended	GP/AW	MG	21/10/15	Existing Gas — Ex G — Gas & Water Conduits — Centreline Chaining CH50.37
3	Driveway, conduit and path adjacent to heritage reserve amendments	GP/AW	MG	13/01/16	Existing Electricity U/G — Ex E — PSM / TBM — Tree to be Removed
4	As constructed	GP/AW	MG	23/06/16	Existing Electricity OH — OH E — Direction of Lot Fall — Retaining Wall — Direction of Overland Flow — Pavement Treatment — Existing Water — Ex W — Allotment to be Evenly Graded — Structural Fill > 200mm — Existing Swale Drain — Vehicle Crossings — Ex. Structural Fill > 200mm

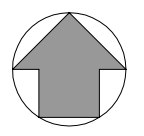

Principal

**acacia**  
BOTANIC RIDGE

Peet Botanic Village Syndicate Ltd  
Level 3, 492 St Kilda Road  
Melbourne VIC 3004

**GPR Consulting**

GPR Consulting Pty Ltd  
ABN 98 140 136 205  
Suite 217, 202 Jells Road  
Wheeters Hill Vic 3150  
Telephone (03) 8544 8400  
© GPR Consulting Pty Ltd

Council	City of Casey	Scale @ A1:	1:500
Project	<b>Acacia, Botanic Ridge Stage 1</b>	0 5 10 15 20 25	
Title	Layout Plan Sheet 2 of 2	Drawing No.	<b>0055-01-R03</b>
Designed:	G.Pratt	Authorised:	M.Graham
Drafted:	A.Wilkins	Date:	May 2015
Sheet	03 of 50	Rev	<b>4</b>