

# Acacia, Botanic Ridge

## Stage 8



*These plans are design plans and are indicative only and parties must not make any objection, requisition or claim for compensation in relation to the plans. The final condition of lots upon completion may vary from the condition described in the plans. The Property may have been filled, raised, levelled, compacted or cut prior to the Vendor becoming registered proprietor of the Property and the condition of the Property may change after completion of works due to circumstances beyond the Vendor's control. No warranty or representation is given or to be construed in respect of such works or changes in condition. Parties should review the plans carefully, make their own inquiries and obtain independent advice before taking any action in relation to the Property.*

DRAWING INDEX		DRAWING No.
REFERENCE		
Locality Plan, Drawing Index & General Notes		0055-08-R01
Layout Plan		0055-08-R02 to R03
Allotment Benching Plans		0055-08-R04
Typical Sections, Pavement Compositions & Details		0055-08-R05
Road Longitudinal Sections	Broadgreen Street	0055-08-R06
	Origin Avenue	0055-08-R06
	Principle Drive	0055-08-R07
	Ravensbourne Grove	0055-08-R07
	Reserve	0055-08-R07
Cross Sections	Broadgreen Street	0055-08-R08 to R10
	Origin Avenue	0055-08-R11 to R12
	Principle Drive	0055-08-R13
	Ravensbourne Grove	0055-08-R14
	Reserve	0055-08-R15
Intersection Details		0055-08-R16 to R17
Signage & Linemarking Plan		0055-08-R18
Drainage Longitudinal Sections		0055-08-R19 to R21
Pit Schedule		0055-08-R22

### GENERAL NOTES

- The works shall be constructed in accordance with the current Engineering Design and Construction Manual (EDCM) standard drawings and Council specifications. Works to be carried out to the satisfaction of Council's supervising officer.
- The contractor is responsible for safety of work on site in accordance with appropriate legislation. The contractor shall ensure that the site is maintained in a safe manner at all times.
- The contractor shall:
  - Comply with the requirements of the Occupational Health and Safety Act 2007.
  - Notify Workcover of their intention to commence trenching operations where trenches are 1.5 metres or deeper.
  - Ensure that the mine manager or his deputy as required by the Act is in attendance when trenching operations are in progress.
- The contractor is to notify council and all service authorities seven (7) days prior to commencement of construction.
- The location of existing services should be determined by the contractor prior to commencing any excavation by contacting all relevant service authorities. Any existing services shown on the drawings are offered as a guide only and are not guaranteed as correct.
- Removal or retention of existing trees or vegetation must be in accordance with the approved landscape plan (otherwise approval will be required from the Landscape Approval Officer).
- Approval will be required from Conservation Officer for alteration, removal or excavation of any significant existing features, buildings, structures or vegetation.
- No surplus trees, vegetation or other materials are to be burnt on site.
- All road chainages are measured along the road centreline except kerb returns and courtheads, where lip of kerb chainages are specified. All dimensions and radii are given to the lip of kerb. Do not scale off these drawings, written dimensions only shall be used.
- All levels are to Australian Height Datum (AHD). All coordinates are to Map Grid of Australia (MGA).
- Any existing pavement or drainage works damaged during construction or the maintenance period to be reinstated to the satisfaction of the Council.
- Upon the completion of construction, the whole site shall be cleaned up and graded over. All rubbish is to be removed and the site is to be left in a clean and tidy condition to the satisfaction of the superintendent.

### EARTHWORKS NOTES

- Erosion control measures must be undertaken to the satisfaction of the Council.
- Appropriate siltation control is to be carried out during the construction and maintenance periods.
- Filling in all properties & road reserves is to be carried out using approved clay fill. Topsoil & all vegetable matter to be stripped from site prior to filling. All filling to be carried out in 150mm layers and compacted to 95% of max. dry density. All filling to comply with AS 3798-2007, Section 8.2, Level 1. A fill report must be submitted from NATA registered soil testing laboratory.
- The nature strips and cut or filled areas are to be topsoiled with 100mm of approved material. If the existing topsoil is unsuitable then approved topsoil shall be imported at the contractor's expense.
- Batters into allotments shall not be steeper than 1 in 6 unless shown otherwise. Cut batters are to be grassed and mulched with a mixture of chopped grass, straw and bitumen emulsion.
- Blocks shall be graded to ensure a minimum grade of 1 in 150 to the point of drainage, unless shown otherwise.
- No topsoil to be removed from site without the approval of council.
- If any existing substandard filling is encountered on the site it must be removed and replaced with approved fill material properly compacted to Council requirements. A geo-technical report must be submitted showing details of depth, type of material and density of the fill areas concerned.

### PAVEMENT NOTES

- Where road pavement or paths are above stripped surface, they are to be filled with approved structural material to the bottom of the boxing.
- Where pavement excavation is in rock, all loose material (including rocks and clay) are to be removed and subgrade regulated with approved structural material.
- Pavement sub-base and bedding to kerb and channel is to extend 300mm behind the back of kerb as per EDCM 202.
- Pavement depths may need to be modified during construction depending on the site conditions as directed by Council's construction engineer or works supervisor.
- Single driveways are to be 3.5m wide and located 0.75m from side boundary or easement unless noted otherwise. They are to be constructed in accordance with standard drawing Figure 010. Double driveways are to be constructed in accordance with standard drawing Figure 011.
- Footpath to be 125mm depth reinforced concrete in accordance with standard drawing EDCM 401.
- Pram crossings to include tactile pavers in accordance with Australian Standards. Design for access and mobility Part 4.1 and Vicroads road design note 06-06, Guidelines for the placement of Tactile Ground Surface Indicators.

### DRAINAGE NOTES

- Pits within the road reserve are not to be set out using digital information.
- Stormwater drains under road pavements, driveways, footpaths, parking bays and behind kerb and channel to be backfilled with crushed rock as specified.
- Stormwater drains less than or equal to 750mm are to be Class 2 RCP with rubber ring joints unless noted otherwise. All other drains are to be Class 2 RCP with flush joints and external sealing bands unless noted otherwise.
- All drainage lines are to be CCTV tested and a report provided to Council prior to issue of practical completion.
- Terra firma or fibre glass type pit lids are required for all drainage pits (refer S-302). All grates for drainage pits are to be "Class D" to comply with AS 3996-2006.
- House drains and property inlets are to be constructed in accordance with EDCM 701 to 704.
- House drains are to be offset 5.50m from the low side boundary (or driveway side for lots narrower than 11.0m) unless noted otherwise. They are to be constructed at a minimum depth of 600mm below the lowest corner level. The house drain location is to be inscribed with a 50mm high "H" on the back of kerb.
- Property inlets are to be offset 1.00m from low side boundary unless noted otherwise. They are to be constructed at a minimum depth of 600mm below finished surface level.
- Subsoil drains shall be installed behind all kerb and channel in accordance with standard drawing EDCM 202 for non-expansive subgrades.
- No stormwater drainage pipes shall be subjected to construction traffic loading during construction unless the pipe strength characteristics have been computed and approved by the contractors engineer. Computations are to accord with AS3725-1989 Loads on Buried Pipes.
- Concrete pipes damaged due to construction loads shall be repaired at the contractors cost.

### SERVICES NOTES

- The contractor shall co-operate with all service authorities and shall ensure that all services are installed prior to the final pavement course.
- All service trenches under road pavements, vehicle crossings and footpaths to be backfilled with crushed rock in accordance with Council's specification.
- The contractor shall check with the superintendent the exact location of all services prior to the installation of conduits.
- Conduit locations are subject to amendment and conduits shall not be laid until written approval is given by the superintendent.
- Gas conduits are to be 50mm PVC and water conduits are to be 100mm PVC laid at a minimum depth of 600mm below road finished surface levels to the satisfaction of the superintendent. Water conduits are to end in the road reserve 300mm from the title boundary.
- Gas mains, fittings and marker tape are to be supplied by the gas authority. Excavation, supply and placement of required backfill to be by others.
- Two weeks notification of commencement of excavation works shall be given to the gas authority.
- Concrete is to be placed around electrical distribution pits to a minimum depth of 200mm. Distribution pits are to be a minimum of 300mm within the edge of pathways.
- Communications conduits and pits are to be provided in accordance with the approved FTTP plans.
- Both kerbs are to be marked with the letters G, W, E and T above the conduit locations.
- Council reserves must be provided with connections for drainage, sewerage, electricity & other services.

### SIGNS AND PAVEMENT MARKINGS

- All pavement markings, signing & traffic control devices for this project to be in accordance with Australian Standard AS1742.
- All line marking to be long life road marking, with longitudinal lines in thermoplastic and transverse markings in cold applied.
- All street signs are to be in accordance with standard drawing S-803.
- Street numbers to be painted in yellow road marking paint on kerb face in front of each allotment. Numbers to be a minimum 100mm in height.
- Install blue raised reflective pavement marker (BRRPM) on road centre line and 'ground ball' marker post to indicate location of fire hydrants.

Rev	Amendment	Des/Dr	App'd	Date
A	Initial Issue	GP/AW	MG	26/02/18

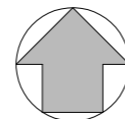

Principal

acacia  
BOTANIC RIDGE

Peet Botanic Village Syndicate Ltd  
Level 4, 380 St Kilda Road  
Melbourne VIC 3004

GPR Consulting Pty Ltd  
ABN 98 140 136 205  
Suite 217, 202 Jells Road  
Wheeters Hill Vic 3150  
Telephone (03) 8544 8400  
© GPR Consulting Pty Ltd

Council City of Casey	
Project <b>Acacia, Botanic Ridge Stage 8</b>	
Title Locality Plan, Drawing Index & General Notes	
Designed: G.Pratt	Authorised: M.Graham
Drafted: A.Wilkins	Date: February 2018

Scale @ A1: 1:5000	
0 50 100 150 200 250	
Drawing No. <b>0055-08-R01</b>	
Sheet 01 of 22	Rev <b>A</b>



**NOTE: OPEN DRAINS**  
 EXISTING OPEN DRAINS TO BE EXCAVATED TO A SOUND BASE AND FILLED AS SPECIFIED.

**NOTE: HOUSE DRAINS**  
 1. HOUSE DRAIN TO LOTS 812 TO BE CONNECTED TO EXISTING DRAINAGE.  
 2. HOUSE DRAINS TO LOTS 824 IS TO BE OFFSET 2.0m FROM SIDE BOUNDARY.  
 3. HOUSE DRAINS TO LOTS 811, 820, 825 AND 838 ARE TO BE OFFSET 6.0m FROM SIDE BOUNDARY.

**NOTE: TREES**  
 EXISTING TREE TO BE REMOVED.

**WARNING**  
**BEWARE OF UNDERGROUND SERVICES**  
 The locations of underground services are approximate only and their exact position should be proven on site.  
 No guarantee is given that all existing services are shown. Locate all underground services before commencement of works.  
**DIAL 1100 BEFORE YOU DIG**  
 www.1100.com.au

Rev	Amendment	Des/Dt	App'd	Date	Legend	
A	Initial Issue	GP/AW	MG	26/02/18	Existing Drain	Ex D
					Existing House Drain	Ex H
					Existing Sewer	Ex S
					Existing Gas	Ex G
					Existing Electricity U/G	Ex E
					Existing Electricity O/H	Ex O
					Existing Communications	Ex T
					Existing Drinking Water	Ex DW
					Existing Swale Drain	Ex SW
					Drain & Property Inlet	Ex D
					House Drain	Ex H
					Sewer	Ex S
					Swale Drain	Ex SW
					Gas & Water Conduits	Ex G
					Direction of Lot Fall	Ex O
					Direction of Overland Flow	Ex T
					Allotment to be Evenly Graded	Ex DW
					Vehicle Crossings	Ex SW
					Existing Surface Level at Title	FS 135.12
					Finished Surface at Title	FS 135.12
					Level at Top/Toe of Batter/Ridge	FT 135.12
					Centreline Chaining	CH 50.37
					Retaining Wall	GW
					PSM / TBM	PSM / TBM
					Pavement Treatment	Pavement Treatment
					Structural Fill > 200mm	Structural Fill > 200mm
					Concrete Infill	Concrete Infill

Principal

Peet Botanic Village Syndicate Ltd  
 Level 4, 380 St Kilda Road  
 Melbourne VIC 3004

GPR Consulting Pty Ltd  
 ABN 98 140 136 205  
 Suite 217, 202 Jells Road  
 Wheelers Hill Vic 3150  
 Telephone (03) 8544 8400  
 © GPR Consulting Pty Ltd

Council City of Casey

Project **Acacia, Botanic Ridge Stage 8**

Title **Layout Plan Sheet 1 of 2**

Designed: G.Pratt  
 Drafted: A.Wilkins

Authorised: M.Graham  
 Date: February 2018

Scale @ A1: 1:500

Drawing No. **0055-08-R02**

Sheet 02 of 22

Rev **A**



FOR CONTINUATION REFER 0055-08-R02

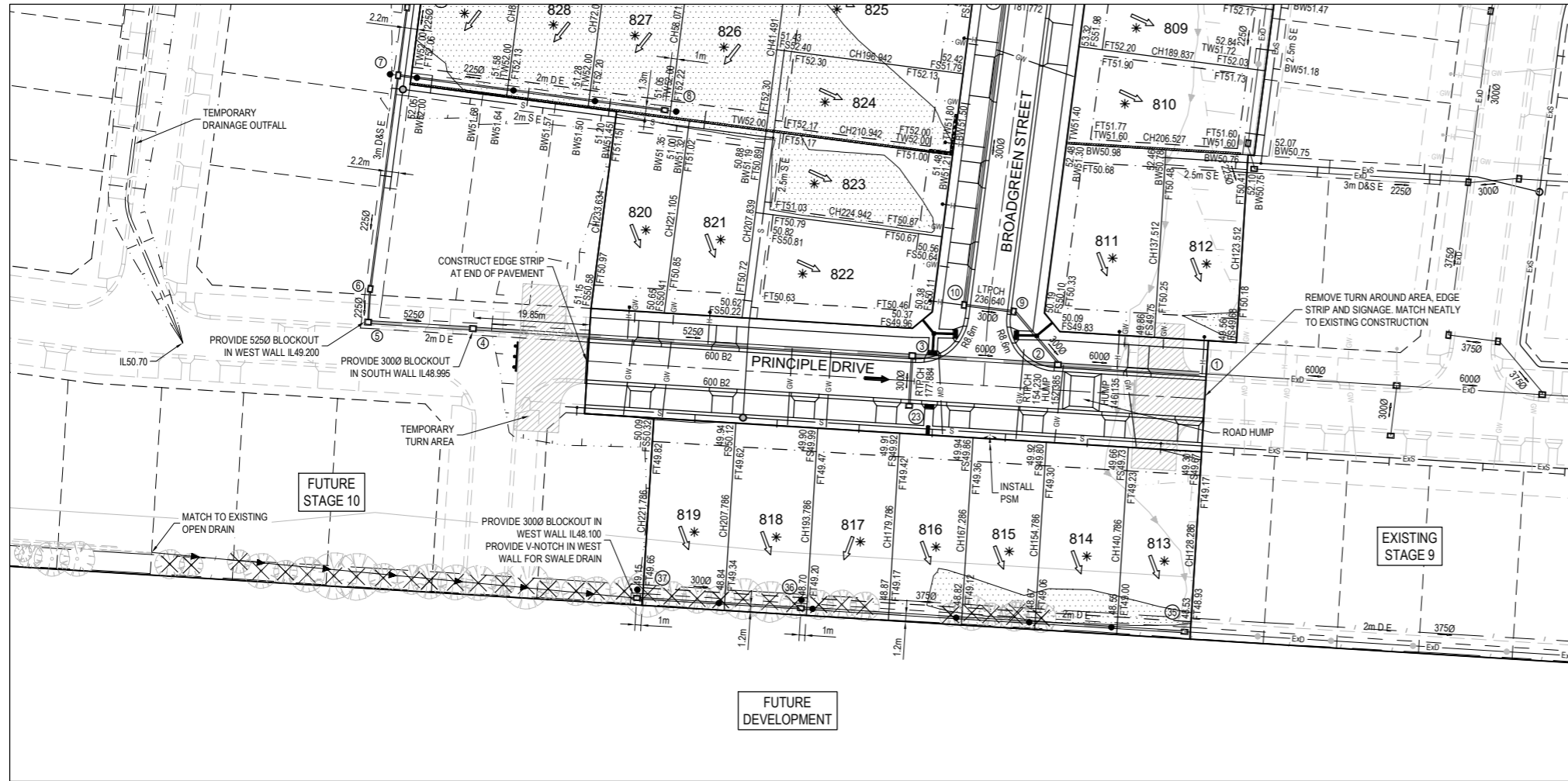

SERVICES OFFSET SCHEDULE									
STREET NAME	ROAD RESERVE	BACK OF KERB	SEWER	GAS	NON DRINKING WATER	DRINKING WATER	COMMUNICATIONS	ELECTRICITY	LIGHT POLES
BROADGREEN STREET	19.00	5.70	-	2.10 W	2.60 W	3.10 W	1.85 E	2.60 E	4.80 E
ORIGIN AVENUE	18.00	5.20	-	2.10 N	2.60 N	3.10 N	1.85 S	2.60 S	4.30 S
PRINCIPLE DRIVE (LOT 812 TO 811)	19.00	6.20 N / 5.20 S	1.00 S	2.10 N	2.60 N	3.10 N	1.85 S	2.60 S	4.30 S
PRINCIPLE DRIVE (LOT 822 TO 820)	18.00	5.20	1.00 S	2.10 N	2.60 N	3.10 N	1.85 S	2.60 S	4.30 S
RAVENSBORNE GROVE	18.00	5.20	-	2.10 N	2.60 N	3.10 N	1.85 S	2.60 S	4.30 S

**NOTE: OPEN DRAINS**  
EXISTING OPEN DRAINS TO BE EXCAVATED TO A SOUND BASE AND FILLED AS SPECIFIED.

**NOTE: HOUSE DRAINS**  
1. HOUSE DRAIN TO LOTS 812 TO BE CONNECTED TO EXISTING DRAINAGE.  
2. HOUSE DRAINS TO LOTS 824 IS TO BE OFFSET 2.0m FROM SIDE BOUNDARY.  
3. HOUSE DRAINS TO LOTS 811, 820, 825 AND 838 ARE TO BE OFFSET 6.0m FROM SIDE BOUNDARY.

**NOTE: TREES**  
EXISTING TREE TO BE REMOVED.

**WARNING**  
**BEWARE OF UNDERGROUND SERVICES**  
The locations of underground services are approximate only and their exact position should be proven on site.  
No guarantee is given that all existing services are shown. Locate all underground services before commencement of works.  
**DIAL 1100 BEFORE YOU DIG**  
www.1100.com.au

Rev	Amendment	Des/Dft	App'd	Date	Legend									
A	Initial Issue	GP/AW	MG	26/02/18	Existing Drain	Ex D	Drain & Property Inlet	Existing Surface Level at Title	135.12	Existing House Drain	H	House Drain	Finished Surface at Title	FS135.12
					Existing Sewer	Ex S	Sewer	Level at Top/Toe of Batter/Ridge	FT135.12	Existing Gas	Ex G	Gas & Water Conduits	Retaining Wall	
					Existing Electricity U/G	Ex E	Direction of Lot Fall	PSM / TBM		Existing Electricity O/H	Ex E	Direction of Overland Flow	Pavement Treatment	
					Existing Communications	Ex T	Allotment to be Evenly Graded	Structural Fill > 200mm		Existing Drinking Water	Ex DW	Vehicle Crossings	Concrete Infill	
					Existing Swale Drain	Ex SW								

	<b>Principal</b>  Peet Botanic Village Syndicate Ltd Level 4, 380 St Kilda Road Melbourne VIC 3004	 GPR Consulting Pty Ltd ABN 98 140 136 205 Suite 217, 202 Jells Road Wheelers Hill Vic 3150 Telephone (03) 8544 8400 © GPR Consulting Pty Ltd	Council: City of Casey	Scale @ A1: 1:500 
			Project: <b>Acacia, Botanic Ridge Stage 8</b>	Title: <b>Layout Plan Sheet 2 of 2</b>
Designed: G.Pratt Drafted: A.Wilkins	Authorised: M.Graham Date: February 2018	Sheet: 03 of 22 Rev: <b>A</b>		

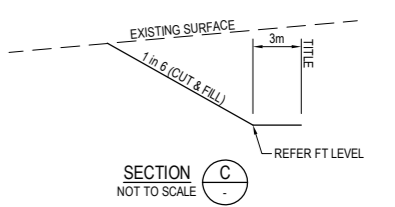
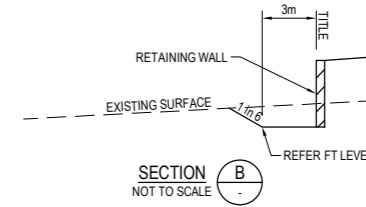
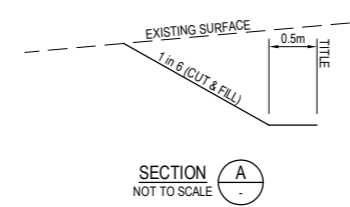
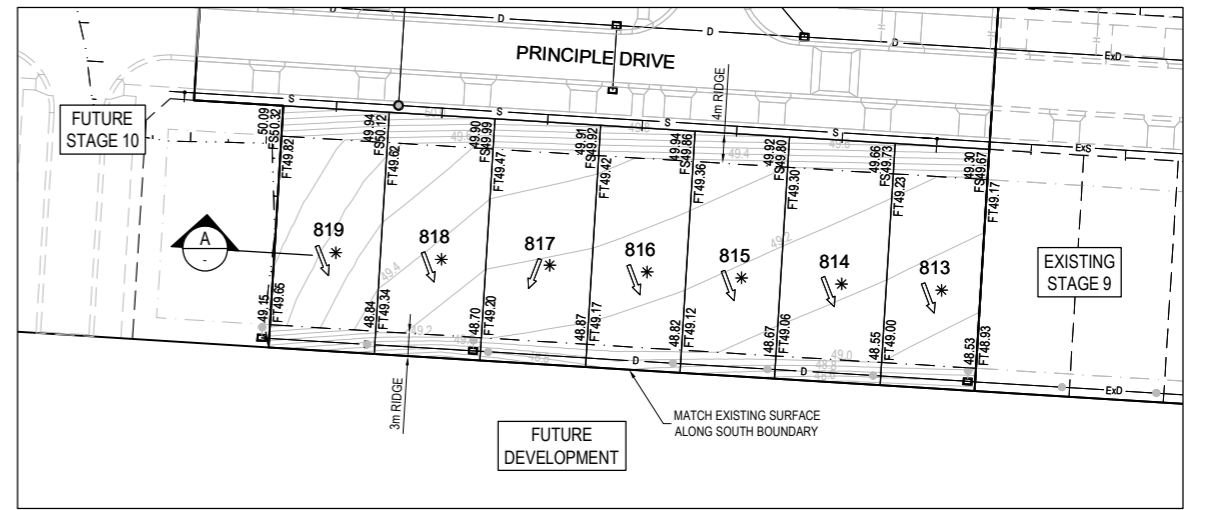

**NOTE: WALL SUBSOIL DRAIN**

- NO SUBSOIL DRAINS ARE TO CROSS A TITLE BOUNDARY.
- HIGH SIDE LOTS ARE TO CONNECT TO THE PROPERTY INLET IN THE LOW CORNER.
- LOW SIDE LOTS ARE TO CONNECT TO THE HOUSE DRAIN AT THE FRONT.
- WHERE SHOWN ON THE PLANS, THE SUBSOIL DRAIN IS TO CONNECT TO A 450x450 IPEX PIT OR APPROVED EQUIVALENT WITH A 1000 STUB FOR FUTURE CONNECTION BY THE BUILDER.

**NOTES: SEWERS**

- REFER TO STANDARD DRAWING MRWA-S-209 FOR REQUIREMENTS OF SEWERS IN THE VICINITY OF RETAINING WALLS.
- PIERS ARE TO BE LOCATED SO THE SEWER CROSSING OF THE WALL IS CENTRALLY BETWEEN PIERS WITH A MINIMUM 0.8m CLEARANCE.

**NOTE: RETAINING WALL**

- REFER TO IRWINCONSULT RETAINING WALL PLANS FOR DETAILS.
- A BUILDING PERMIT IS TO BE PROVIDED TO THE SUPERINTENDENT PRIOR TO CONSTRUCTION.
- CERTIFICATION FROM A QUALIFIED STRUCTURAL ENGINEER IS REQUIRED POST CONSTRUCTION.
- PIERS TO ALIGN WITH TITLE BOUNDARIES ALONG HIGH SIDE OF WALL.

**NOTE: RIDGES**

RIDGES ALONG SIDE BOUNDARIES ARE 1.0m WIDE UNLESS NOTED OTHERWISE.

**WARNING**

**BEWARE OF UNDERGROUND SERVICES**

The locations of underground services are approximate only and their exact position should be proven on site. No guarantee is given that all existing services are shown. Locate all underground services before commencement of works.

**DIAL 1100 BEFORE YOU DIG**

www.1100.com.au

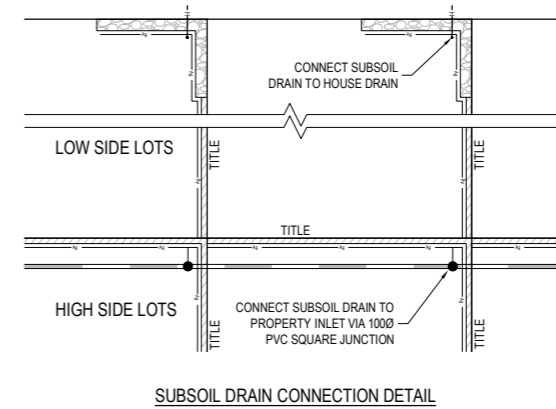

Rev	Amendment	Des/Drt	App'd	Date	Legend	
A	Initial Issue	GP/AW	MG	26/02/18	Drain & Property Inlet	Existing Surface Level at Title 47.01
					House Drain	Finished Surface at Title FS47.01
					Sewer	Level at Top/Toe of Batter/Ridge FT47.01
					Swale Drain	Top of Wall Level TW47.01
					Existing Drain	Bottom of Wall Level BW47.01
					Existing House Drain	Design Contours 47.01
					Existing Sewer	Existing Contours 47.01
					Existing Swale Drain	Batter
					Vehicle Crossings	Ridge

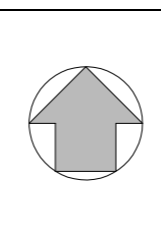

Principal

**acacia**  
BOTANIC RIDGE

Peet Botanic Village Syndicate Ltd  
Level 4, 380 St Kilda Road  
Melbourne VIC 3004

**GPR Consulting**

GPR Consulting Pty Ltd  
ABN 98 140 136 205  
Suite 217, 202 Jells Road  
Wheeters Hill Vic 3150  
Telephone (03) 8544 8400  
© GPR Consulting Pty Ltd

Council City of Casey

Project **Acacia, Botanic Ridge Stage 8**

Title Allotment Benching Plan

Designed: G.Pratt  
Drafted: A.Wilkins

Authorised: M.Graham  
Date: February 2018

Scale @ A1: 1:500

Drawing No. **0055-08-R04**

Sheet 04 of 22

Rev **A**



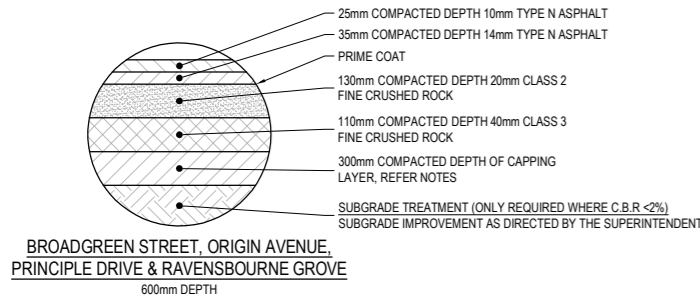

**BROADGREEN STREET, ORIGIN AVENUE,  
PRINCIPLE DRIVE & RAVENSBORNE GROVE**  
600mm DEPTH

**PAVEMENT COMPOSITIONS**

- NOTE:**
- REFER TO CARDNO GEOTECHNICAL INVESTIGATION (REFERENCE 212003Report01.2) FOR ADDITIONAL DETAILS ON PAVEMENT MATERIALS, COMPACTION ETC.
  - CAPPING LAYER TO COMPRISE OF EITHER 40mm CLASS 3 RECYCLED CONCRETE, IMPORTED TYPE A SELECT MATERIAL OR SUBGRADE STABILISATION AS DIRECTED BY COUNCIL & THE SUPERINTENDENT. CAPPING LAYER TO HAVE A MINIMUM SOAKED CBR OF 10% COMPACTED TO 98% STANDARD DRY DENISTY RATIO WITH 1% OF STANDARD OPTIMUM MOISTURE CONTENT AND A PERCENTAGE SWELL OF LESS THAN 1.5%.
  - WHERE SILTY SAND IS ENCOUNTERED AT SUBGRADE, THE SUPERINTENDENT IS TO BE CONTACTED PRIOR TO PROCEEDING. SUBGRADE PREPARATION IS TO BE AS FOLLOWS:
    - THE SILTY SAND IS TO BE REMOVED TO THE UNDERLAYING CLAY OR CLAYEY SAND.
    - WHERE THE DEPTH OF SILTY SAND MAKES THIS IMPRACTICAL, THE INSITU CBR IS TO BE CHECKED, SUBGRADE PROOF ROLLED AND COVERED WITH A GEOTEXTILE TO PREVENT SAND PUMPING OR MIGRATION INTO THE SUBGRADE. DRAINAGE OF THE SAND SUBGRADE WILL BE ESSENTIAL IN THESE LOCATIONS. AT THE INTERFACE OF THE TWO DIFFERENT PAVEMENT PROFILES, A HIGH STRENGTH ASPHALT REINFORCEMENT PRODUCT, SUCH AS GLASGRID, IS TO BE PLACED BETWEEN THE ASPHALT WEARING AND STRUCTURAL COURSE EXTENDING 1.0m EACH SIDE OF JOINT.

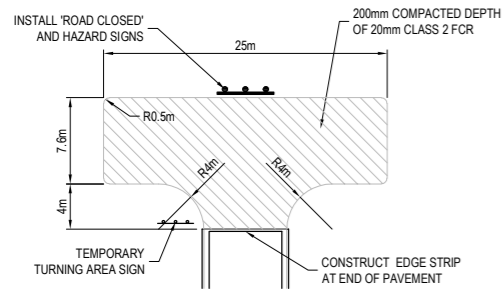

**TEMPORARY TURN AROUND AREA DETAIL**  
NOT TO SCALE

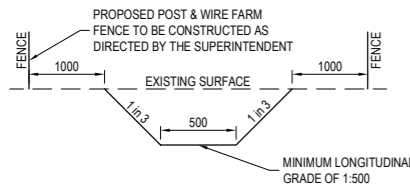

**TEMPORARY OUTFALL CHANNEL DETAIL**  
NOT TO SCALE

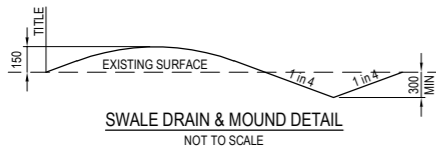

**SWALE DRAIN & MOUND DETAIL**  
NOT TO SCALE

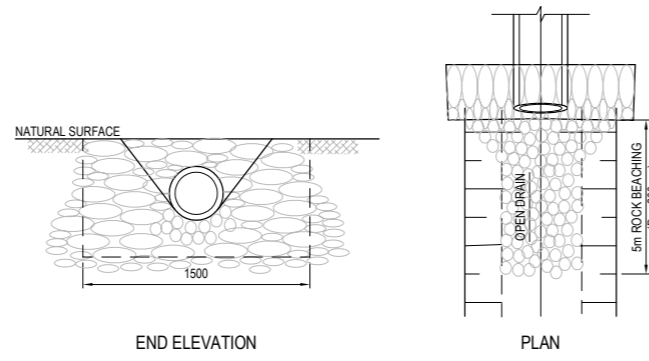

**PLAN  
SANDBAG ENDWALL DETAIL**  
NOT TO SCALE

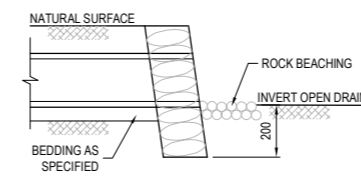

**SIDE ELEVATION**

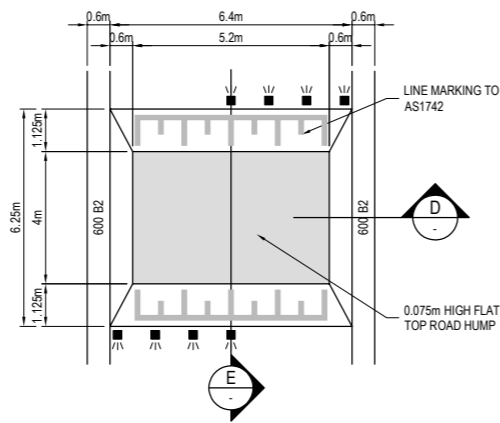

**ROAD HUMP DETAIL**  
NOT TO SCALE

- NOTE: ROAD HUMPS**
- FLAT TOP TO BE PROVIDED WITH HIGH FRICTION SURFACE TREATMENT COLOURED YELLOW. INSTALLATION TO COMPLY WITH VICROADS STANDARD SECTION 430 FOR HIGH FRICTION SURFACE TREATMENT TO MANUFACTURERES SPECIFICATION.
  - FOR TYPE 1 HUMPS THE YELLOW SURFACE IS TO EXTEND AS SHOWN ON THE INTERSECTION DETAILS.

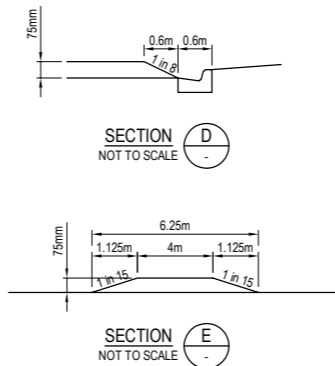

**SECTION D**  
NOT TO SCALE

**SECTION E**  
NOT TO SCALE

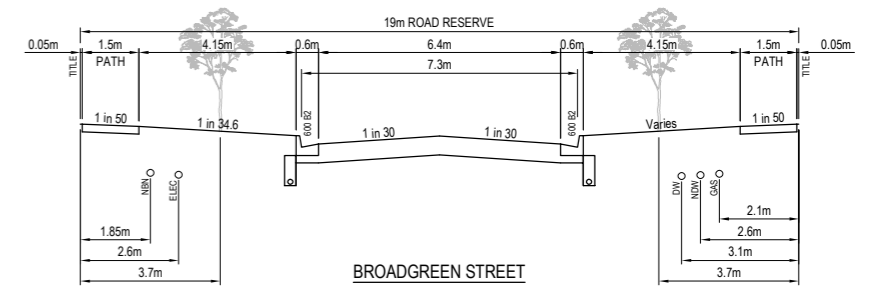

**BROADGREEN STREET**

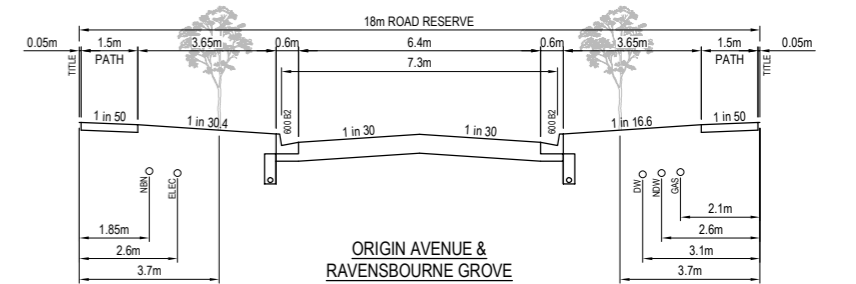

**ORIGIN AVENUE &  
RAVENSBORNE GROVE**

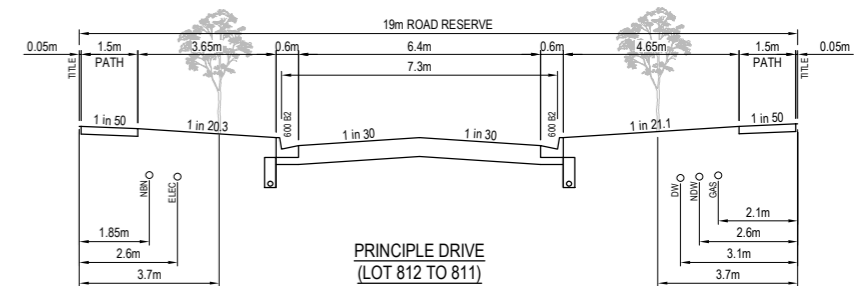

**PRINCIPLE DRIVE  
(LOT 812 TO 811)**

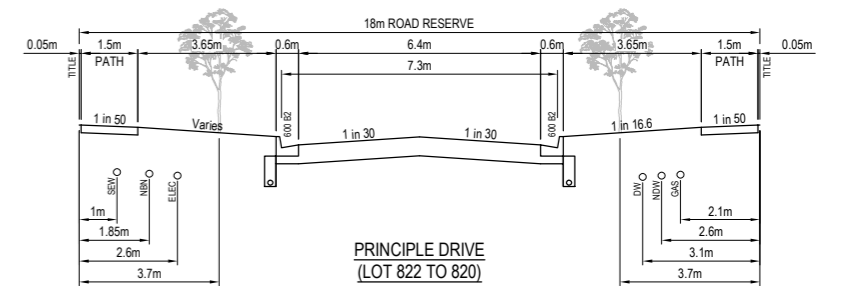

**PRINCIPLE DRIVE  
(LOT 822 TO 820)**

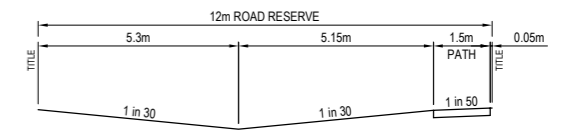

**RESERVE  
(END OF POINT MEWS)**

Rev	Amendment	Des/Dt	App'd	Date
A	Initial Issue	GP/AW	MG	26/02/18

Principal	<b>acacia</b> BOTANIC RIDGE	<b>GPR Consulting</b>	Council City of Casey	Scale @ A1: As Shown
Peet Botanic Village Syndicate Ltd Level 4, 380 St Kilda Road Melbourne VIC 3004		GPR Consulting Pty Ltd ABN 98 140 136 205 Suite 217, 202 Jells Road Wheeters Hill Vic 3150 Telephone (03) 8544 8400 © GPR Consulting Pty Ltd	Project <b>Acacia, Botanic Ridge Stage 8</b>	Drawing No. <b>0055-08-R05</b>
			Title Typical Sections, Pavement Compositions & Details	Sheet 05 of 22
			Designed: G.Pratt Drafted: A.Wilkins	Rev <b>A</b>
			Authorised: M.Graham Date: February 2018	

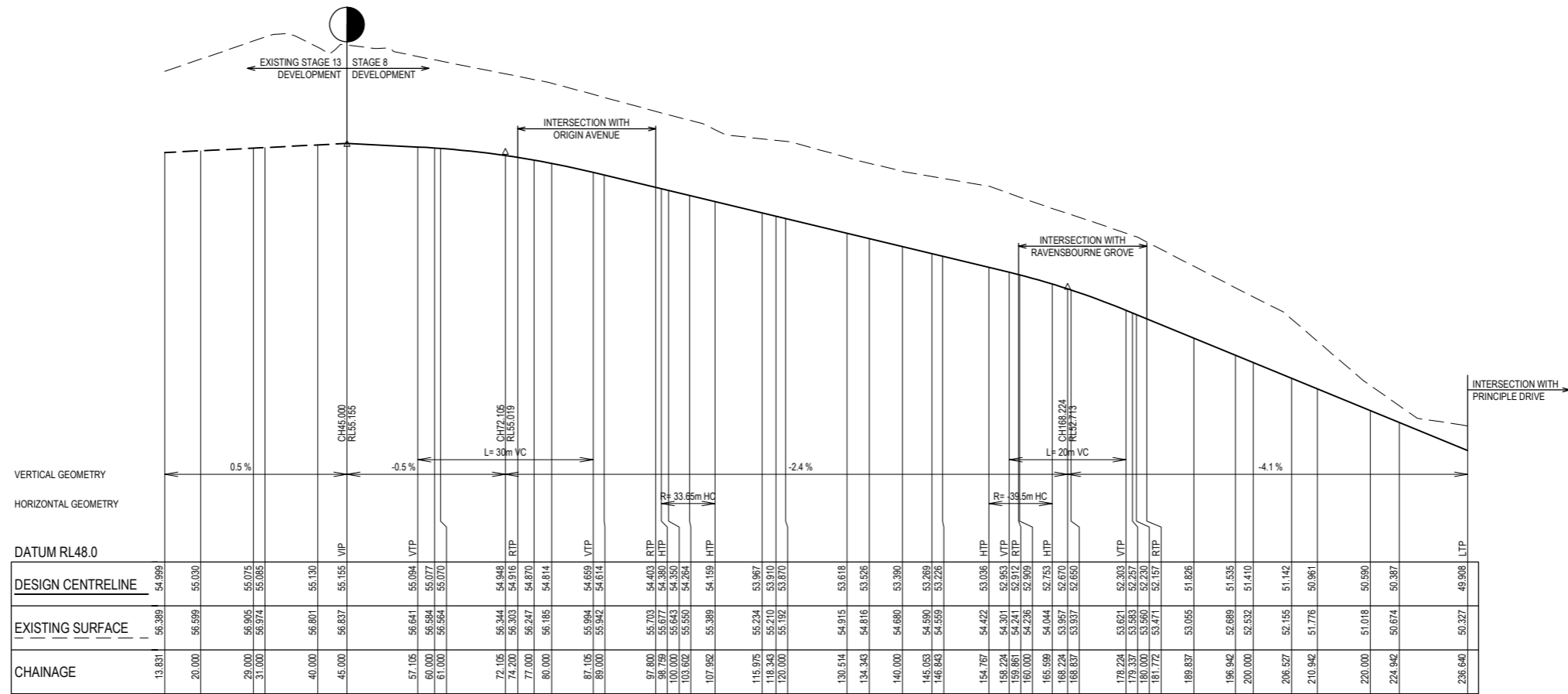

BROADGREEN STREET LONGITUDINAL SECTION

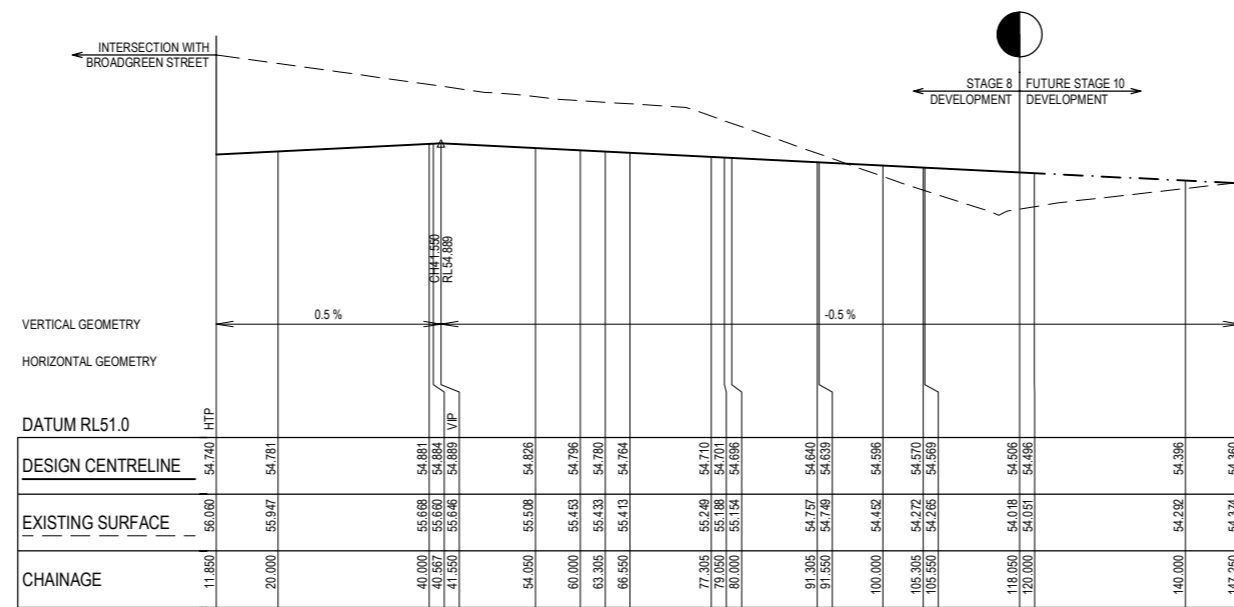

ORIGIN AVENUE LONGITUDINAL SECTION

Rev	Amendment	Des/Dt	App'd	Date	Legend
A	Initial Issue	GP/AW	MG	26/02/18	Existing Surface Design Line Existing Design Line Future Design Line Left Building Line Left Lip of Kerb Right Building Line Right Lip of Kerb

Principal

acacia  
BOTANIC RIDGE

Peet Botanic Village Syndicate Ltd  
Level 4, 380 St Kilda Road  
Melbourne VIC 3004

GPR Consulting Pty Ltd  
ABN 98 140 136 205  
Suite 217, 202 Jells Road  
Wheeters Hill Vic 3150  
Telephone (03) 8544 8400  
© GPR Consulting Pty Ltd

Council City of Casey

Project **Acacia, Botanic Ridge Stage 8**

Title Longitudinal Sections  
Sheet 1 of 2

Designed: G.Pratt  
Drafted: A.Wilkins

Authorised: M.Graham  
Date: February 2018

Scale @ A1: H1:500 V1:50

Drawing No. **0055-08-R06**

Sheet 06 of 22  
Rev **A**

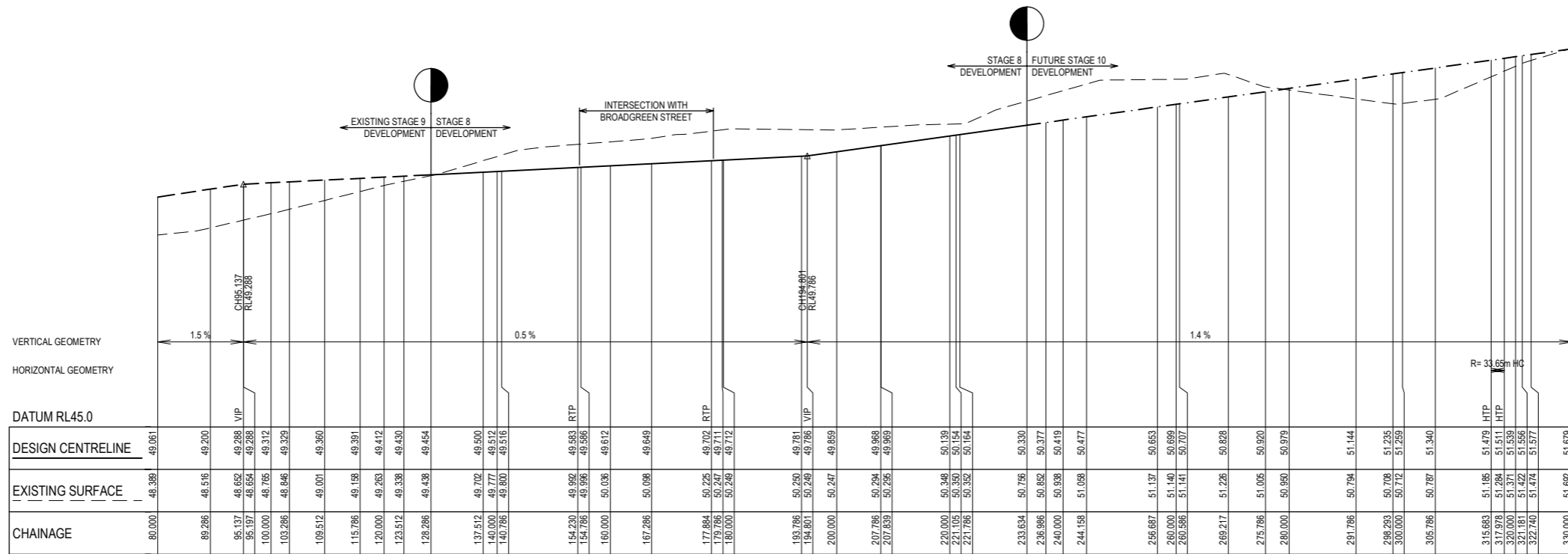

PRINCIPLE DRIVE LONGITUDINAL SECTION

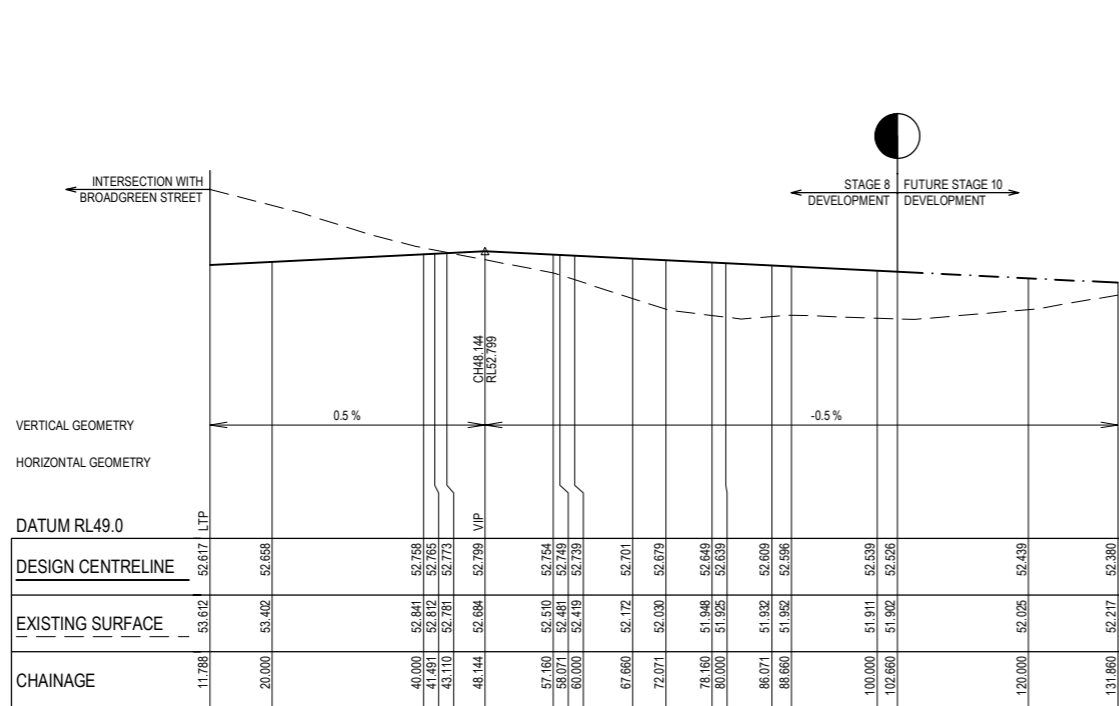

RAVENSBORNE GROVE LONGITUDINAL SECTION

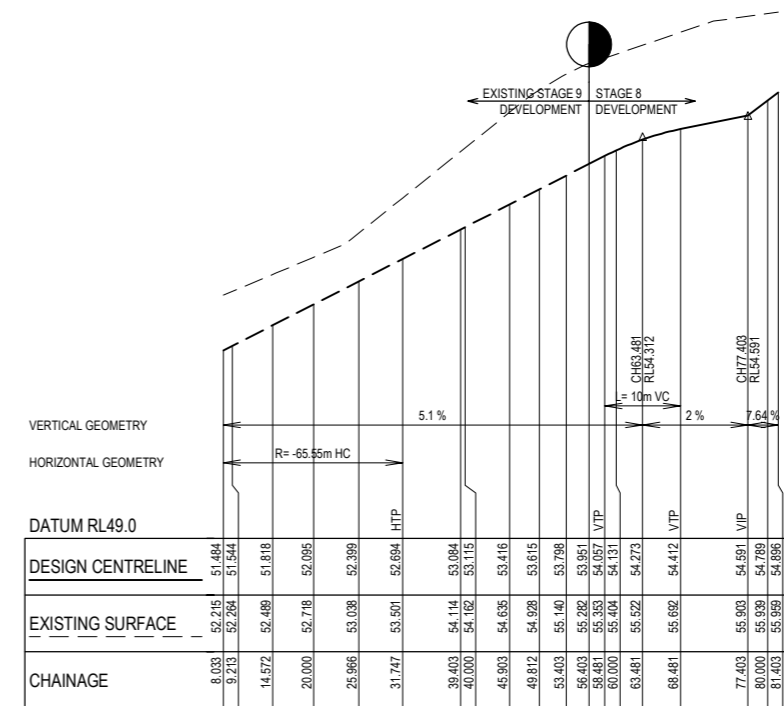

RESERVE LONGITUDINAL SECTION

Rev	Amendment	Des/Dt	App'd	Date	Legend
A	Initial Issue	GP/AW	MG	26/02/18	Existing Surface Design Line Existing Design Line Future Design Line Left Building Line Left Lip of Kerb Right Building Line Right Lip of Kerb

Principal

acacia  
BOTANIC RIDGE

Peet Botanic Village Syndicate Ltd  
Level 4, 380 St Kilda Road  
Melbourne VIC 3004

GPR Consulting Pty Ltd  
ABN 98 140 136 205  
Suite 217, 202 Wells Road  
Wheeters Hill Vic 3150  
Telephone (03) 8544 8400  
© GPR Consulting Pty Ltd

Council City of Casey

Project **Acacia, Botanic Ridge Stage 8**

Title Longitudinal Sections  
Sheet 2 of 2

Designed: G.Pratt  
Drafted: A.Wilkins

Authorised: M.Graham  
Date: February 2018

Scale @ A1: H1:500 V1:50

Drawing No. **0055-08-R07**

Sheet 07 of 22

Rev **A**

**NOTE:**  
WHERE ROAD PAVEMENT OR FOOTPATH IS ABOVE THE STRIPPED SURFACE IT IS TO BE FILLED WITH APPROVED TYPE A MATERIAL WITH A 45° ANGLE OF REPOSE.

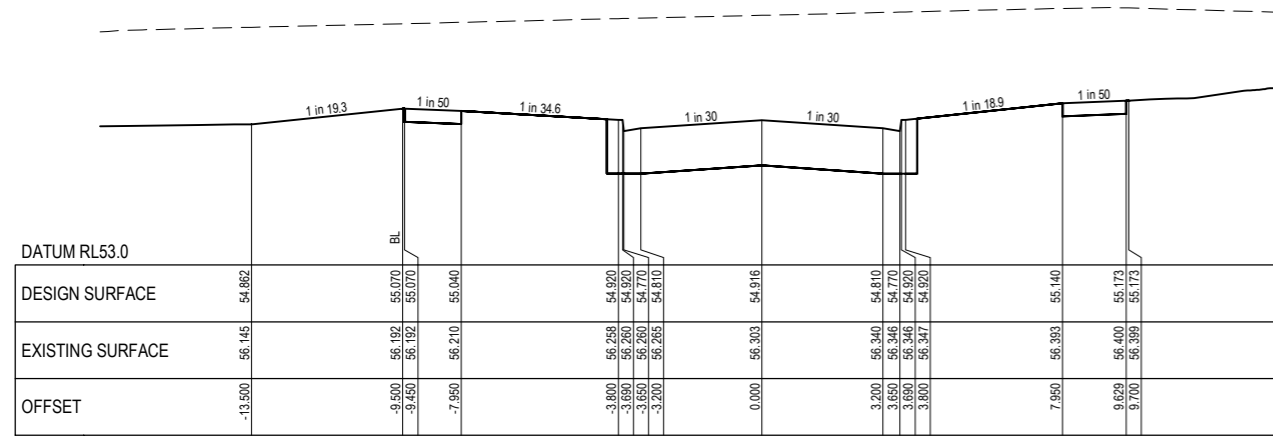

RTPCH 74.200

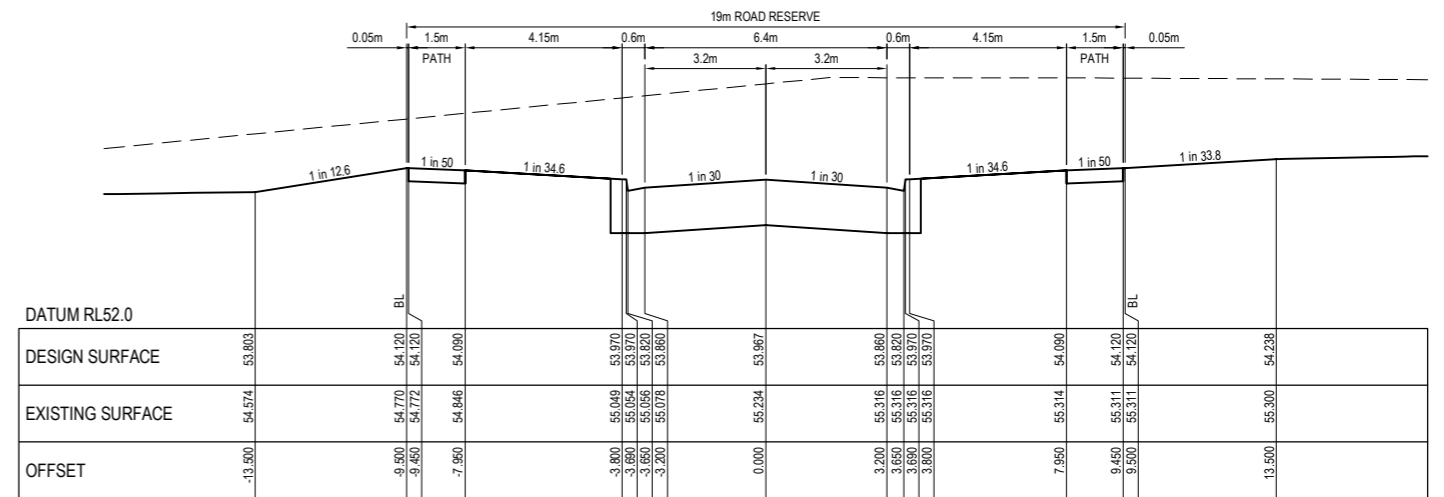

CH 115.975

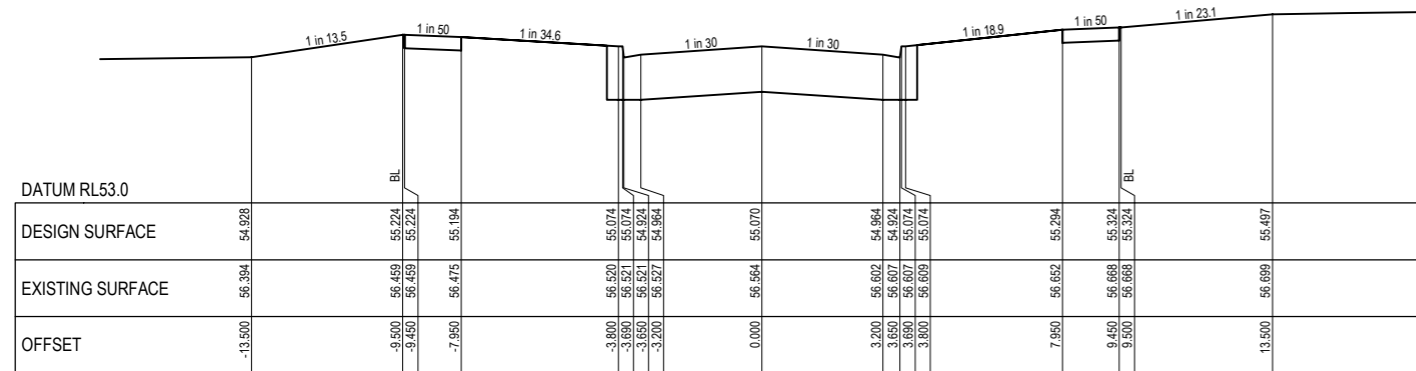

CH 61.000

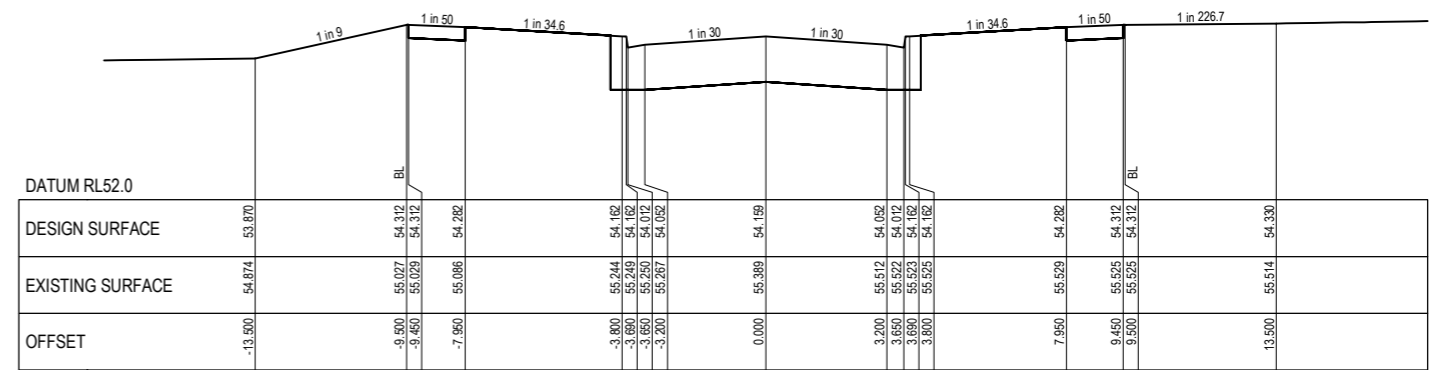

TPCH 107.952

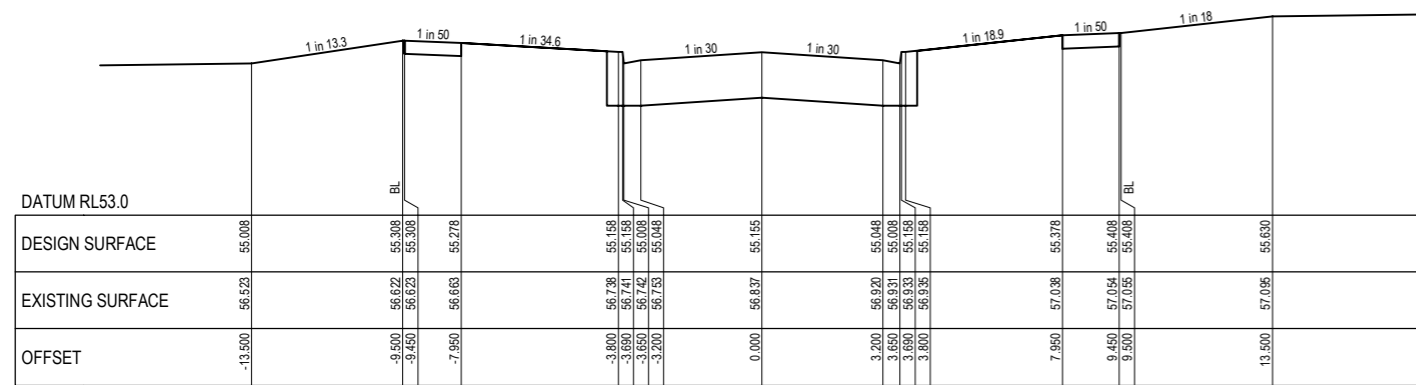

CH 45.000

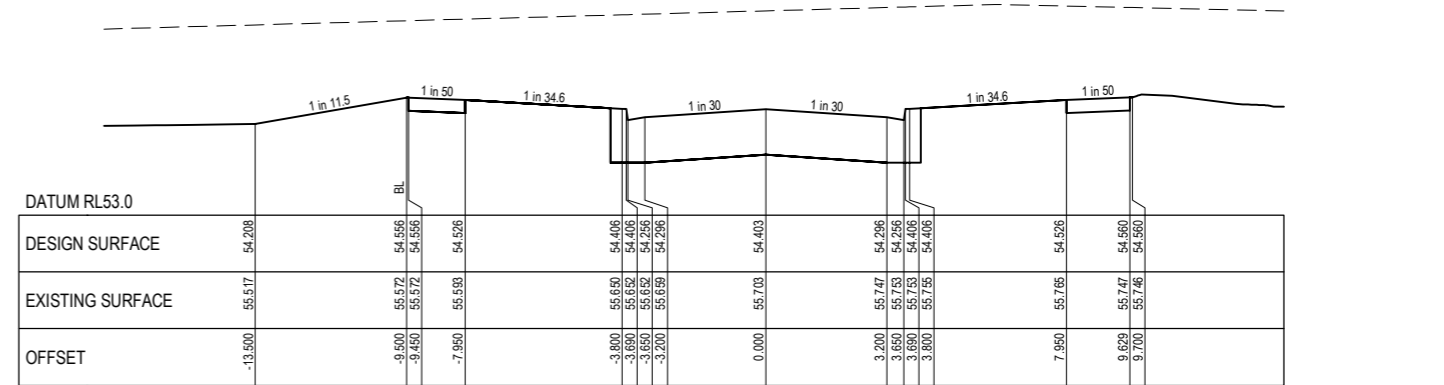

RTPCH 97.800

Rev	Amendment	Des/Dt	App'd	Date	Legend
A	Initial Issue	GP/AW	MG	26/02/18	Existing Surface --- Design Line ——— Future Surface - - - 100 Yr Flood Level ——— FL131.65 Freeboard Level ——— F132.25 Retaining Wall [Hatched]

Principal  
**acacia**  
BOTANIC RIDGE  
Peet Botanic Village Syndicate Ltd  
Level 4, 380 St Kilda Road  
Melbourne VIC 3004

**GPR Consulting**  
GPR Consulting Pty Ltd  
ABN 98 140 136 205  
Suite 217, 202 Wells Road  
Wheeters Hill Vic 3150  
Telephone (03) 8544 8400  
© GPR Consulting Pty Ltd

Council City of Casey  
Project **Acacia, Botanic Ridge Stage 8**  
Title Cross Sections  
Broadgreen Street - Sheet 1 of 3  
Designed: G.Pratt  
Drafted: A.Wilkins  
Authorised: M.Graham  
Date: February 2018

Scale @ A1: H1:100 V1:50  
Drawing No. **0055-08-R08**  
Sheet 08 of 22  
Rev **A**



NOTE:  
WHERE ROAD PAVEMENT OR FOOTPATH IS ABOVE THE STRIPPED SURFACE IT IS TO BE FILLED WITH APPROVED TYPE A MATERIAL WITH A 45° ANGLE OF REPOSE.

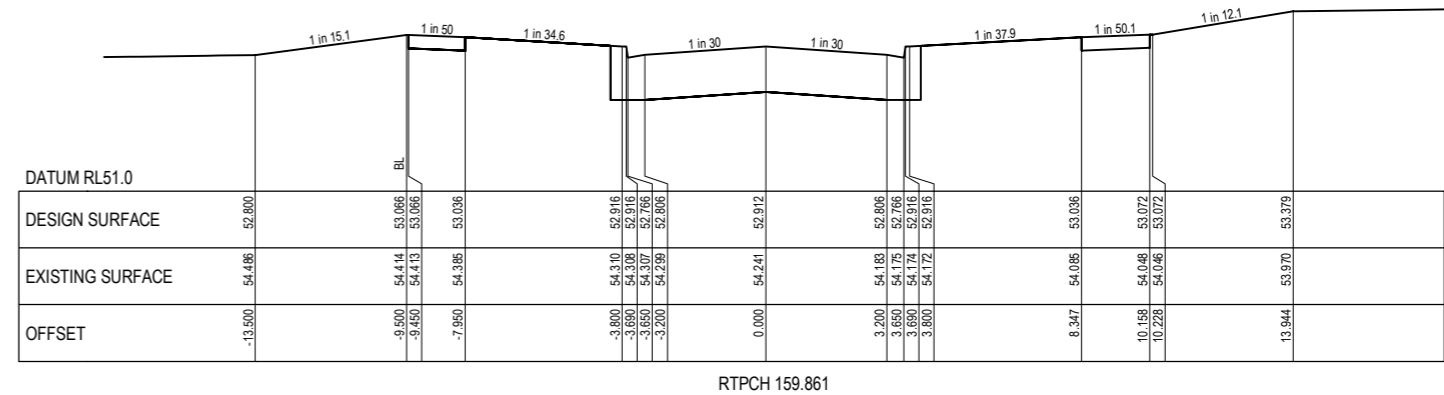
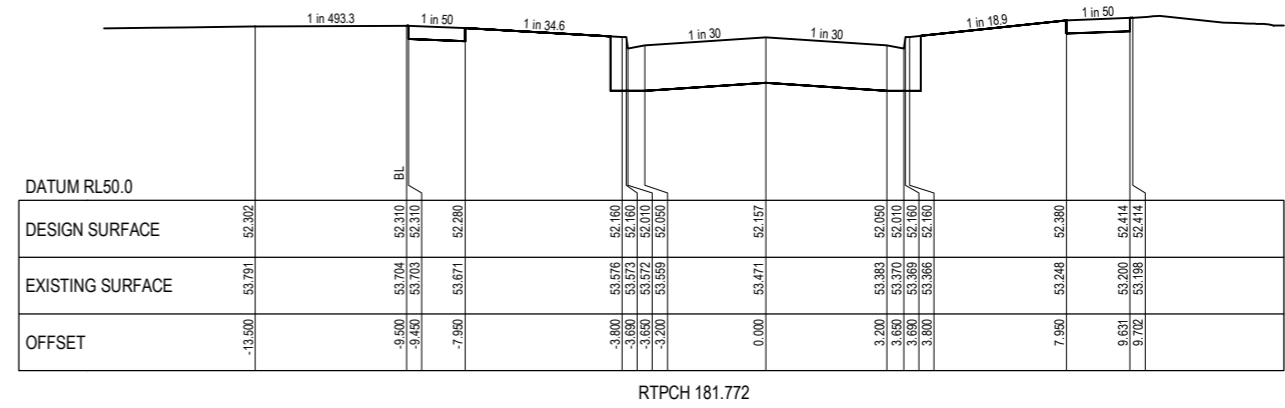
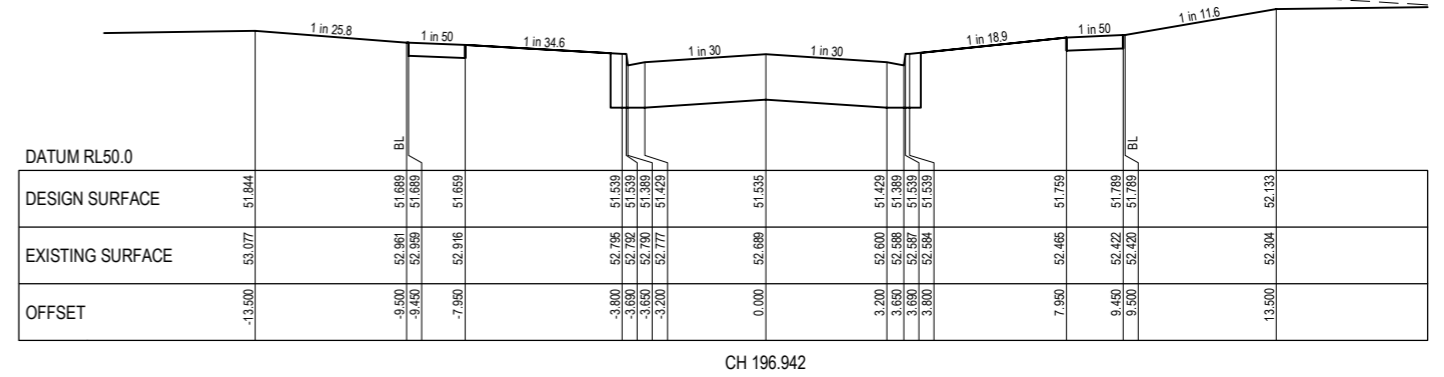
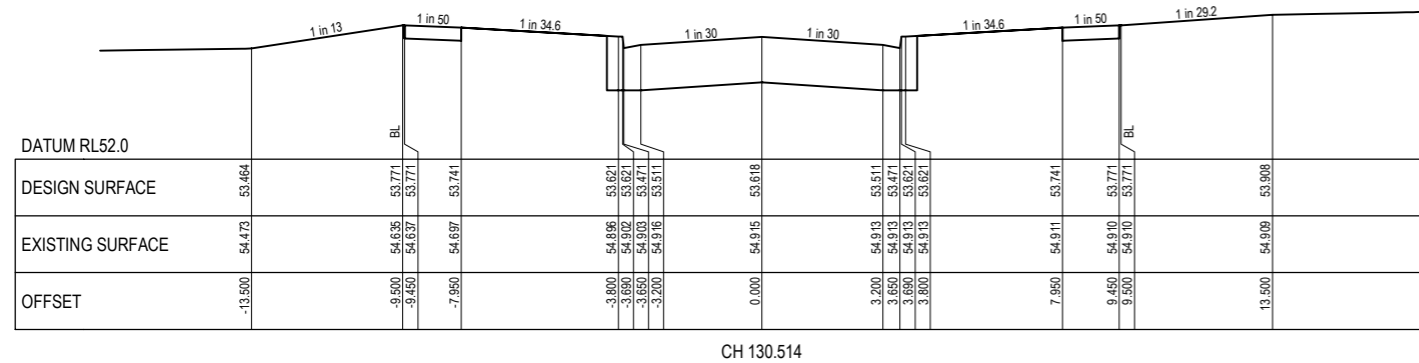
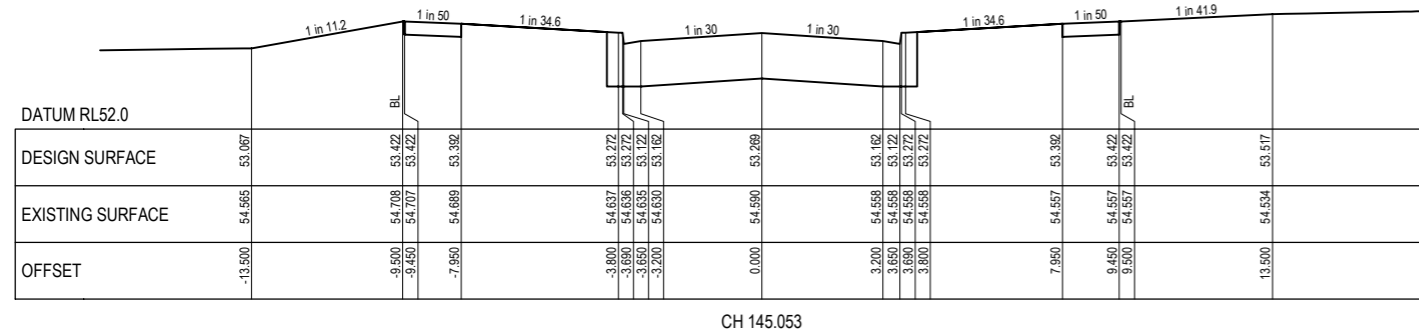
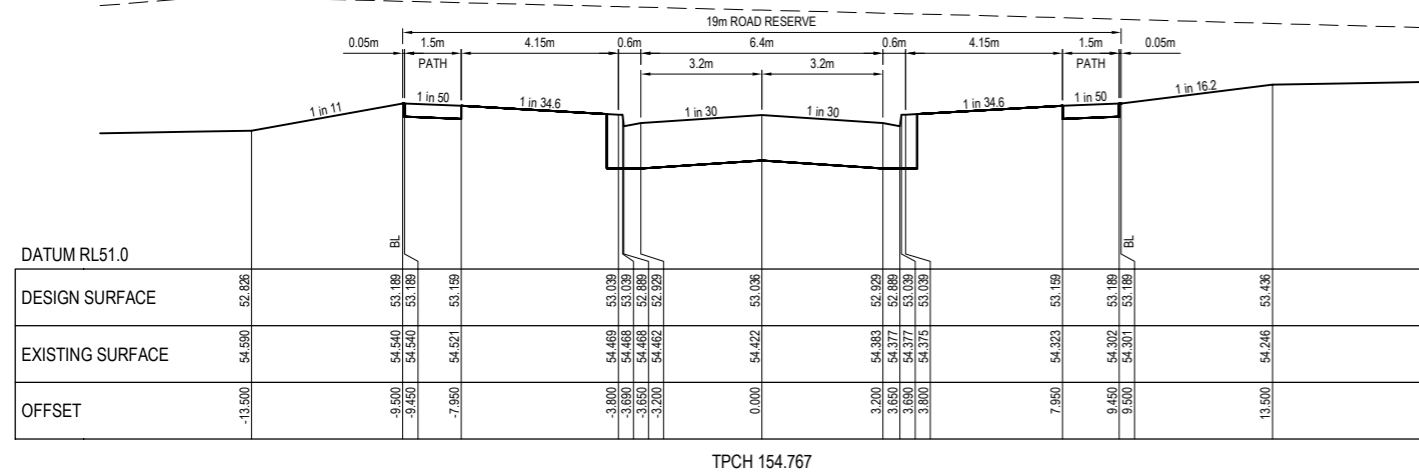

Rev	Amendment	Des/Dt	App'd	Date	Legend
A	Initial Issue	GP/AW	MG	26/02/18	Existing Surface --- Design Line ——— Future Surface - - - 100 Yr Flood Level ——— FL131.65 Freeboard Level ——— FL132.25 Retaining Wall [Hatched]

Principal	acacia BOTANIC RIDGE
Peet Botanic Village Syndicate Ltd Level 4, 380 St Kilda Road Melbourne VIC 3004	

**GPR Consulting**

GPR Consulting Pty Ltd  
ABN 98 140 136 205  
Suite 217, 202, Wells Road  
Wheeters Hill Vic 3150  
Telephone (03) 8544 8400  
© GPR Consulting Pty Ltd

Council City of Casey

Project **Acacia, Botanic Ridge Stage 8**

Title **Cross Sections Broadgreen Street - Sheet 2 of 3**

Designed: G.Pratt  
Drafted: A.Wilkins

Authorised: M.Graham  
Date: February 2018

Scale @ A1: H1:100 V1:50

H 0 1 2 3 4 5  
V 0 0.5 1 1.5 2 2.5

Drawing No. **0055-08-R09**

Sheet 09 of 22  
Rev **A**



**NOTE:**  
WHERE ROAD PAVEMENT OR FOOTPATH IS ABOVE THE STRIPPED SURFACE IT IS TO BE FILLED WITH APPROVED TYPE A MATERIAL WITH A 45° ANGLE OF REPOSE.

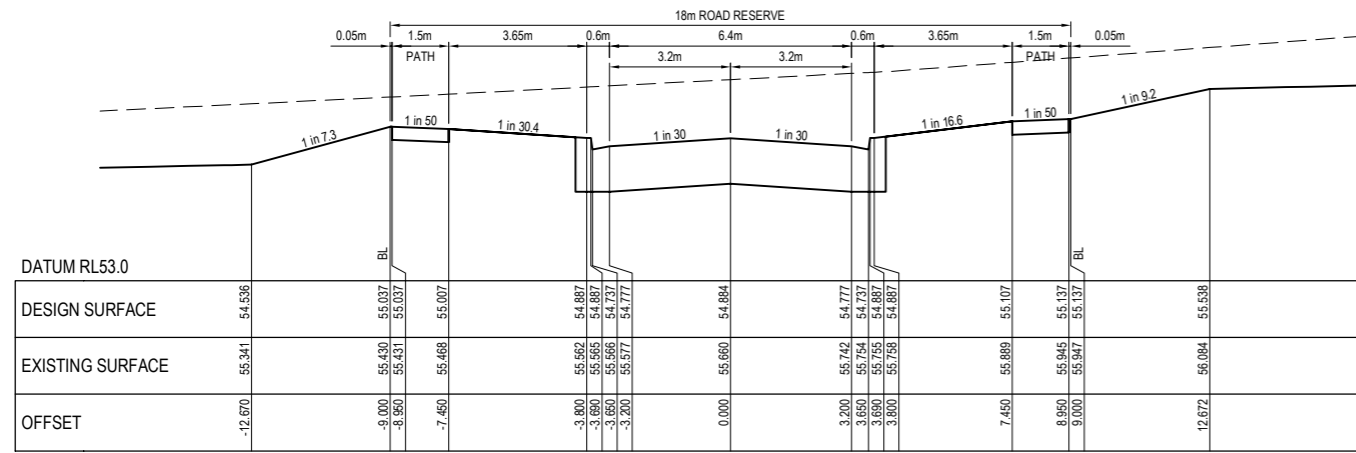

CH 40.567

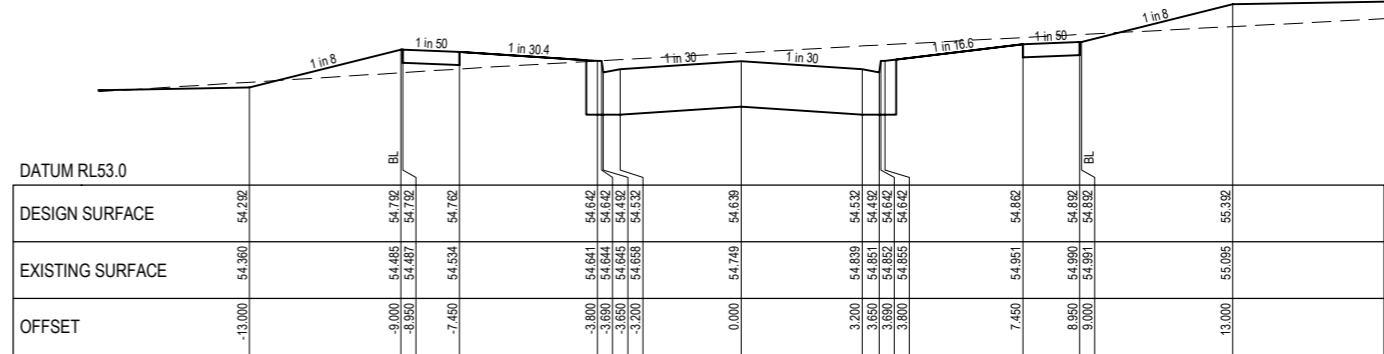

CH 91.550

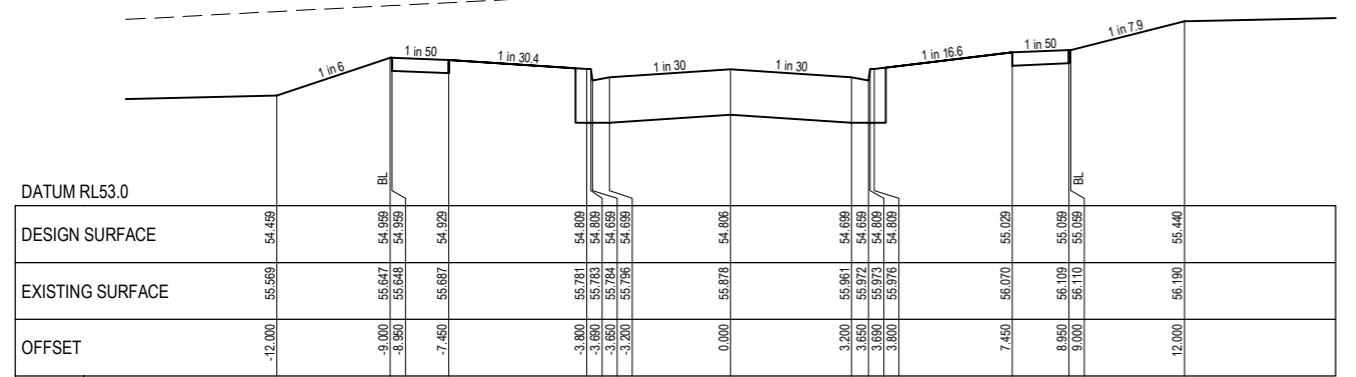

CH 25.000

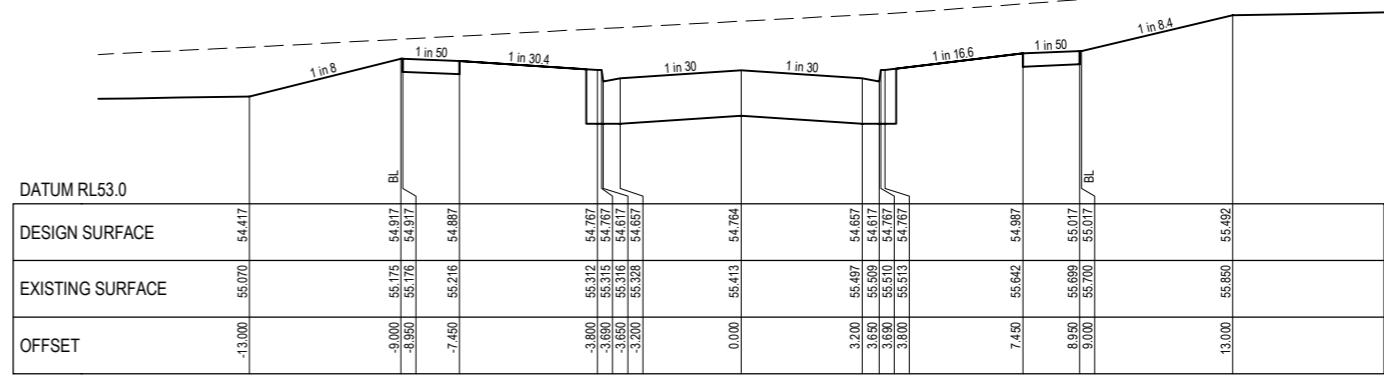

CH 66.550

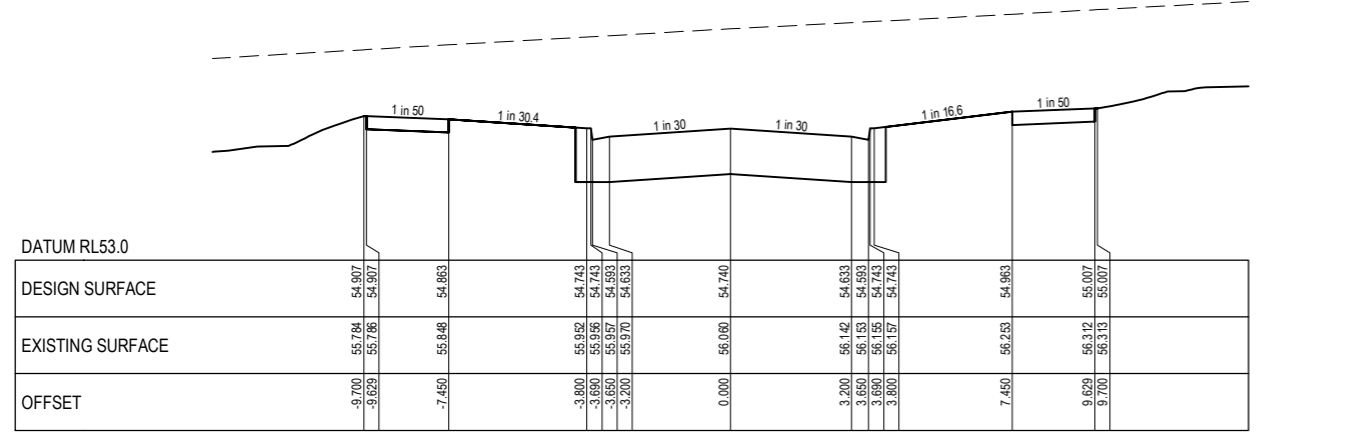

TPCH 11.850

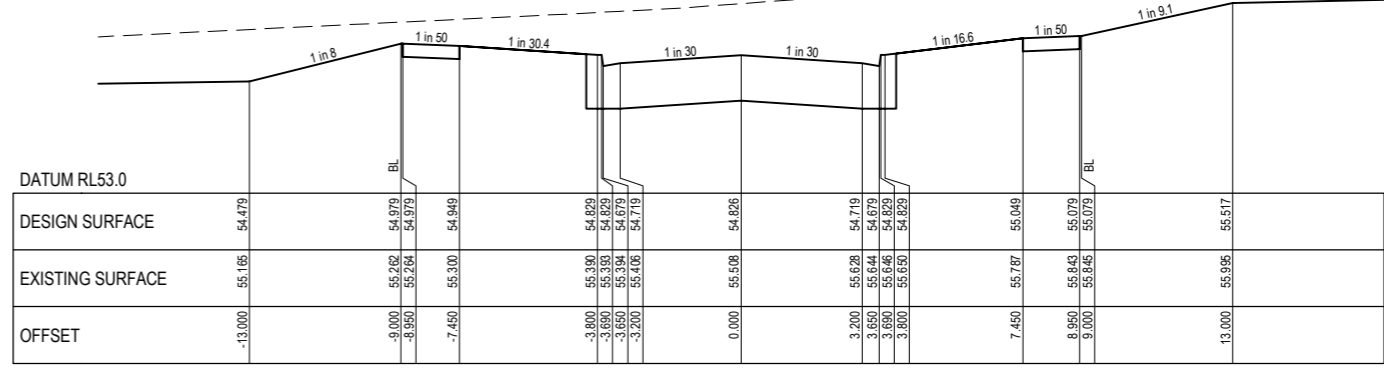

CH 54.050

Rev	Amendment	Des/Dt	App'd	Date	Legend
A	Initial Issue	GP/AW	MG	26/02/18	Existing Surface --- Design Line --- Future Surface --- 100 Yr Flood Level --- FL131.65 Freeboard Level --- F132.25 Retaining Wall [Hatched Box]

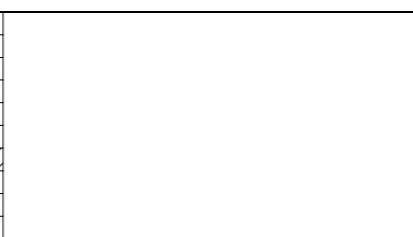

Principal  
**acacia**  
BOTANIC RIDGE  
Peet Botanic Village Syndicate Ltd  
Level 4, 380 St Kilda Road  
Melbourne VIC 3004

**GPR Consulting**  
GPR Consulting Pty Ltd  
ABN 98 140 136 205  
Suite 217, 202, Wells Road  
Wheeters Hill Vic 3150  
Telephone (03) 8544 8400  
© GPR Consulting Pty Ltd

Council City of Casey  
Project **Acacia, Botanic Ridge Stage 8**  
Title Cross Sections  
Origin Avenue - Sheet 1 of 2  
Designed: G.Pratt  
Drafted: A.Wilkins  
Authorised: M.Graham  
Date: February 2018

Scale @ A1: H1:100 V1:50  
Drawing No. **0055-08-R11**  
Sheet 11 of 22  
Rev **A**



**NOTE:**  
WHERE ROAD PAVEMENT OR FOOTPATH IS ABOVE THE STRIPPED SURFACE IT IS TO BE FILLED WITH APPROVED TYPE A MATERIAL WITH A 45° ANGLE OF REPOSE.

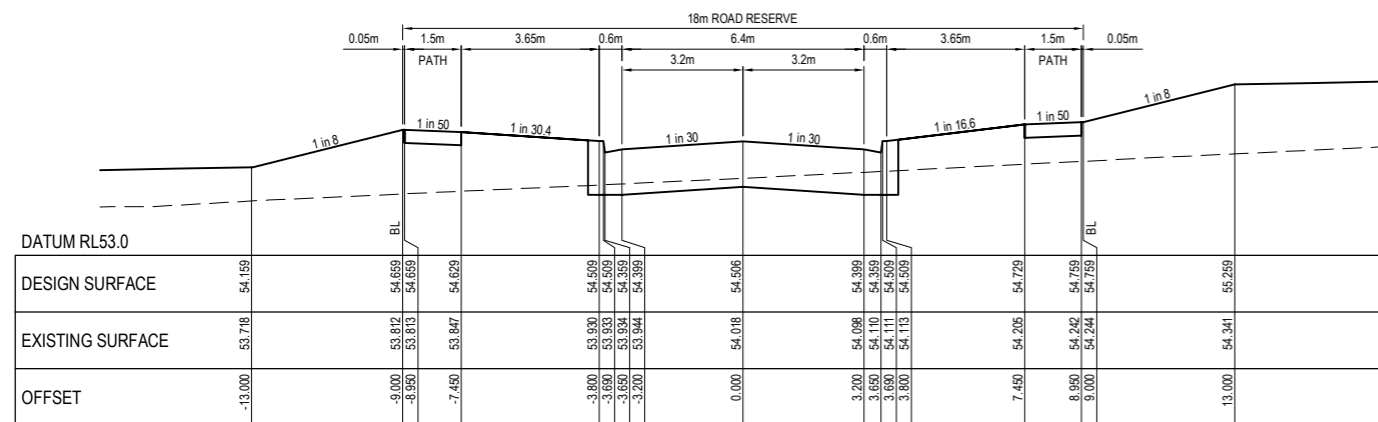

CH 118.050

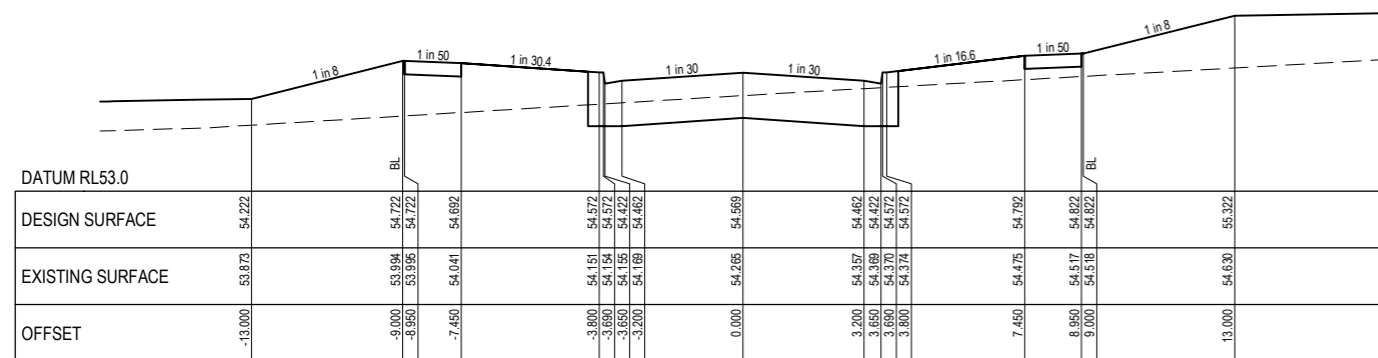

CH 105.550

Rev	Amendment	Des/Dt	App'd	Date	Legend
A	Initial Issue	GP/AW	MG	26/02/18	Existing Surface --- Design Line ——— Future Surface - - - 100 Yr Flood Level ——— FL131.65 Freeboard Level ——— F132.25 Retaining Wall [Hatched]

Principal
acacia BOTANIC RIDGE
Peet Botanic Village Syndicate Ltd Level 4, 380 St Kilda Road Melbourne VIC 3004

**GPR Consulting**

GPR Consulting Pty Ltd  
ABN 98 140 136 205  
Suite 217, 202 Jells Road  
Wheeters Hill Vic 3150  
Telephone (03) 8544 8400  
© GPR Consulting Pty Ltd

Council	City of Casey
Project	Acacia, Botanic Ridge Stage 8
Title	Cross Sections Origin Avenue - Sheet 2 of 2
Designed: G.Pratt	Authorised: M.Graham
Drafted: A.Wilkins	Date: February 2018

Scale @ A1:	H1:100 V1:50
Drawing No.	0055-08-R12
Sheet	12 of 22
Rev	A

**NOTE:**  
 1. WHERE ROAD PAVEMENT OR FOOTPATH IS ABOVE THE STRIPPED SURFACE IT IS TO BE FILLED WITH APPROVED TYPE A MATERIAL WITH A 45° ANGLE OF REPOSE.  
 2. TRANSITION LEFT NATURE STRIP CROSSFALL BETWEEN CH193.786 AND CH207.786.

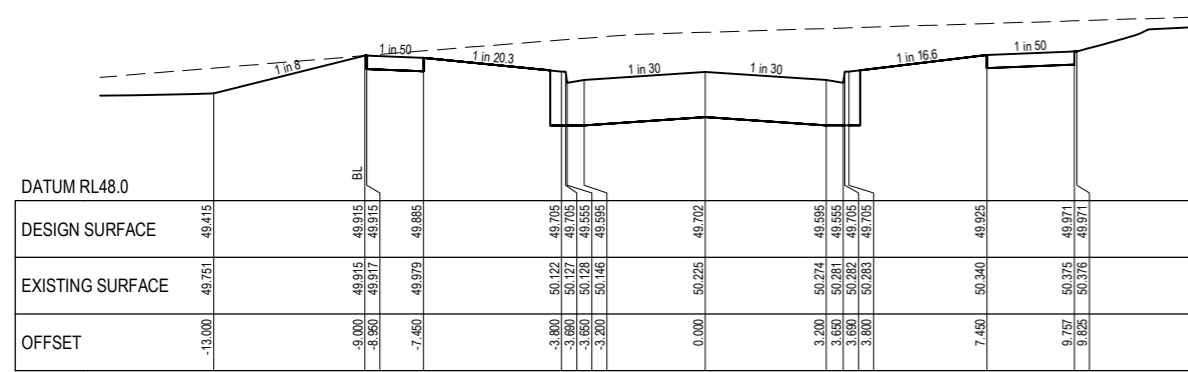

RTPCH 177.884

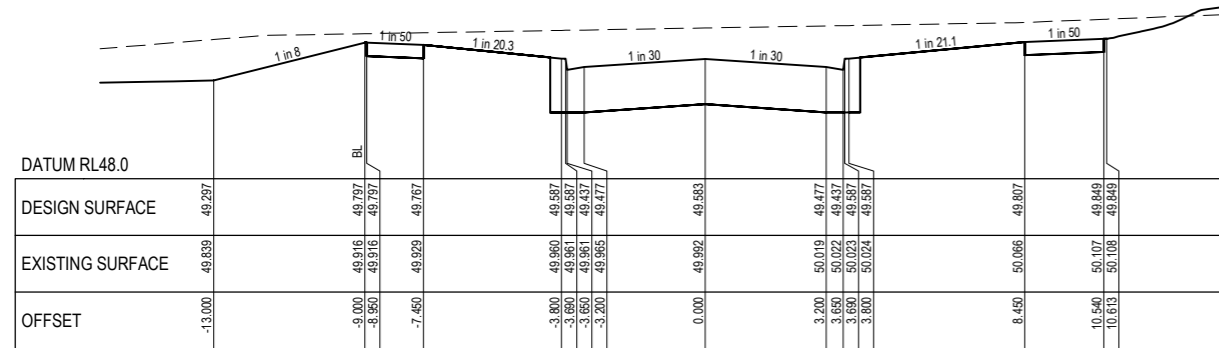

RTPCH 154.230

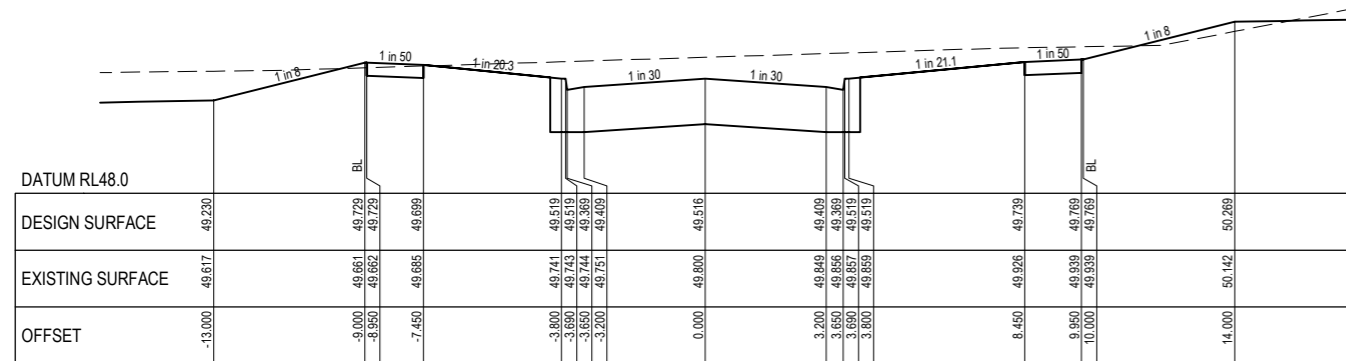

CH 140.786

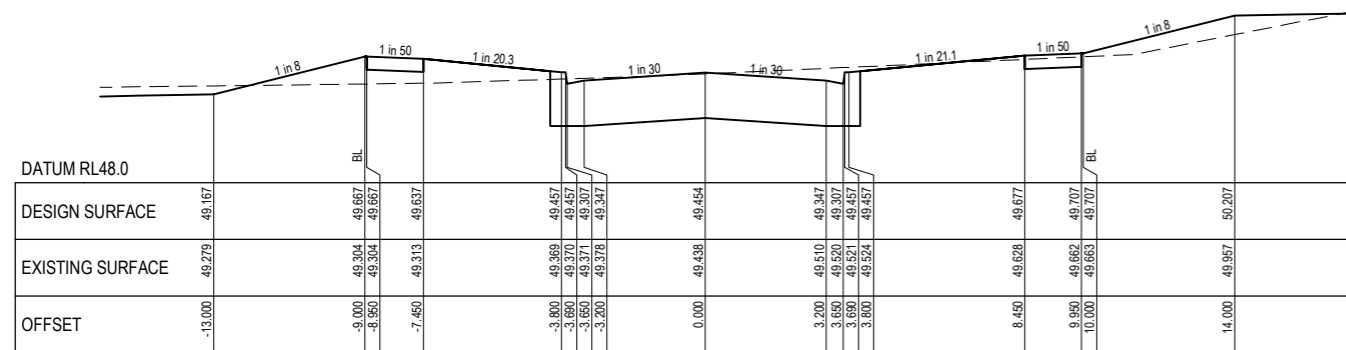

CH 128.286

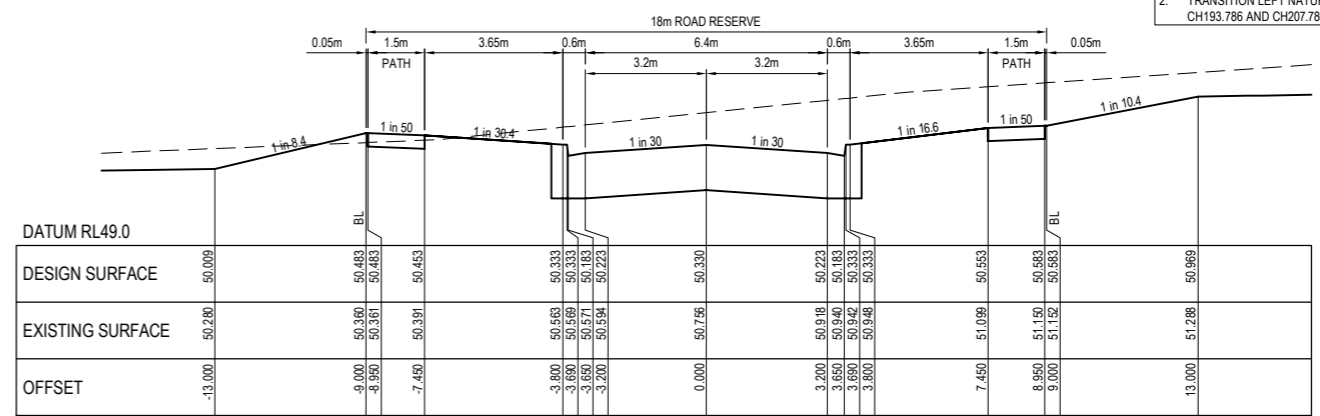

CH 233.634

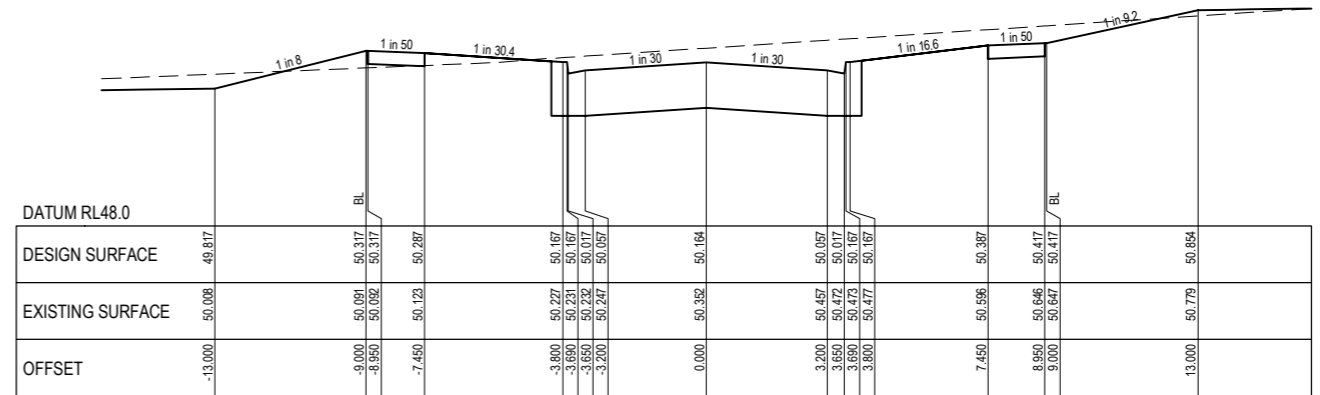

CH 221.786

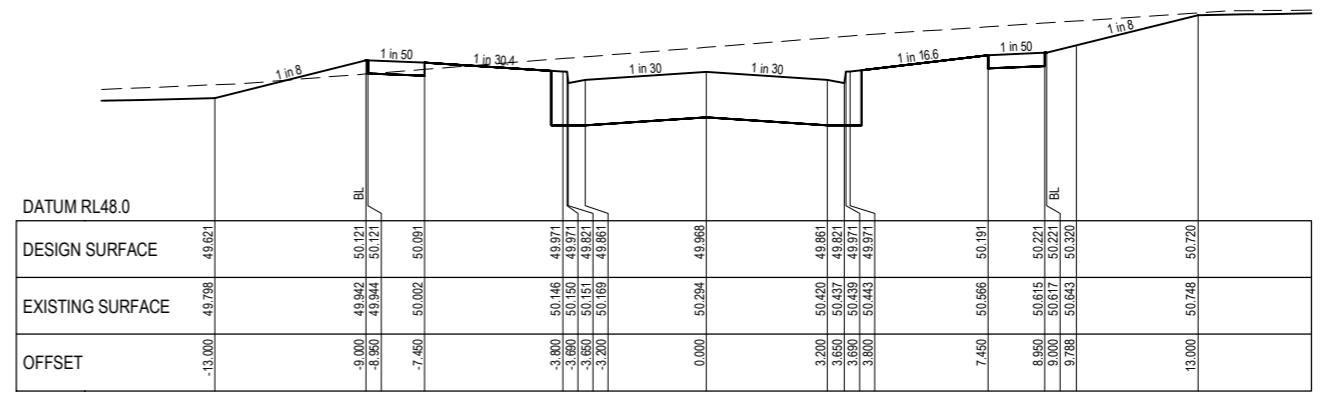

CH 207.786

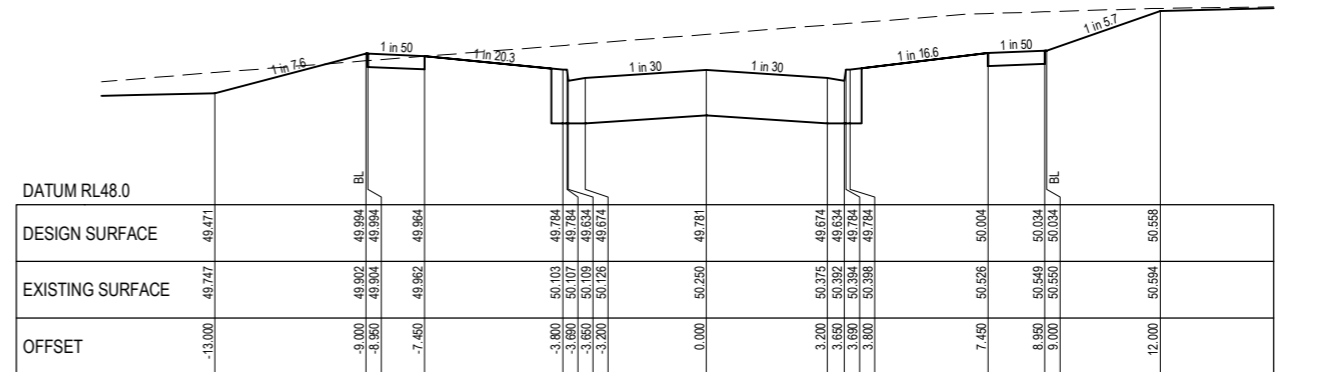

CH 193.786

Rev	Amendment	Des/Dt	App'd	Date	Legend
A	Initial Issue	GP/AW	MG	26/02/18	Existing Surface Design Line Future Surface 100 Yr Flood Level Freeboard Level Retaining Wall

Principal
acacia BOTANIC RIDGE
Peet Botanic Village Syndicate Ltd Level 4, 380 St Kilda Road Melbourne VIC 3004

**GPR Consulting**

GPR Consulting Pty Ltd  
 ABN 98 140 136 205  
 Suite 217, 202, Wells Road  
 Wheelers Hill Vic 3150  
 Telephone (03) 8544 8400  
 © GPR Consulting Pty Ltd

Council	City of Casey
Project	Acacia, Botanic Ridge Stage 8
Title	Cross Sections Principle Drive
Designed:	G.Pratt
Drafted:	A.Wilkins
Authorised:	M.Graham
Date:	February 2018

Scale @ A1:	H1:100 V1:50
Drawing No.	0055-08-R13
Sheet	13 of 22
Rev	A

NOTE:  
WHERE ROAD PAVEMENT OR FOOTPATH IS ABOVE THE STRIPPED SURFACE IT IS TO BE FILLED WITH APPROVED TYPE A MATERIAL WITH A 45° ANGLE OF REPOSE.

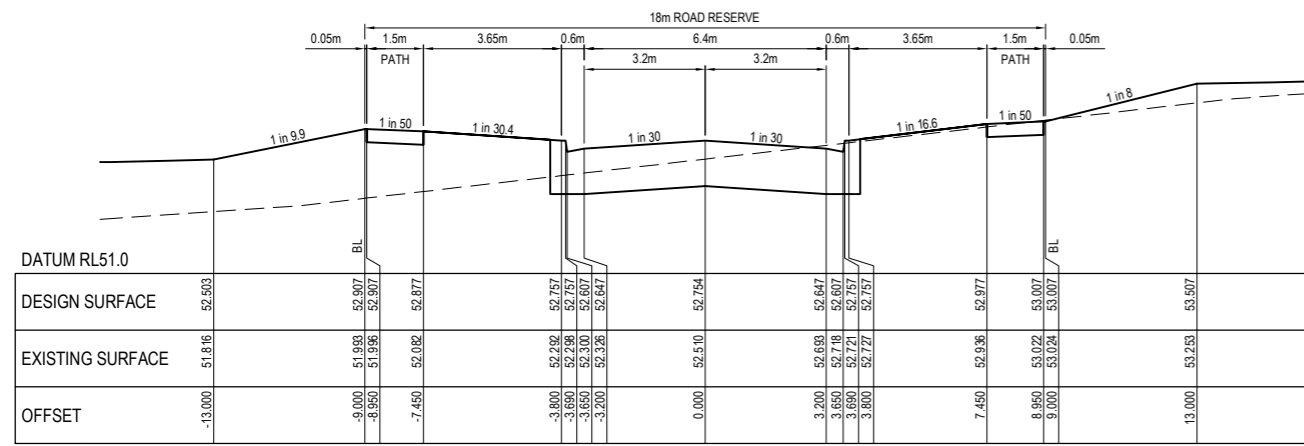

CH 57.160

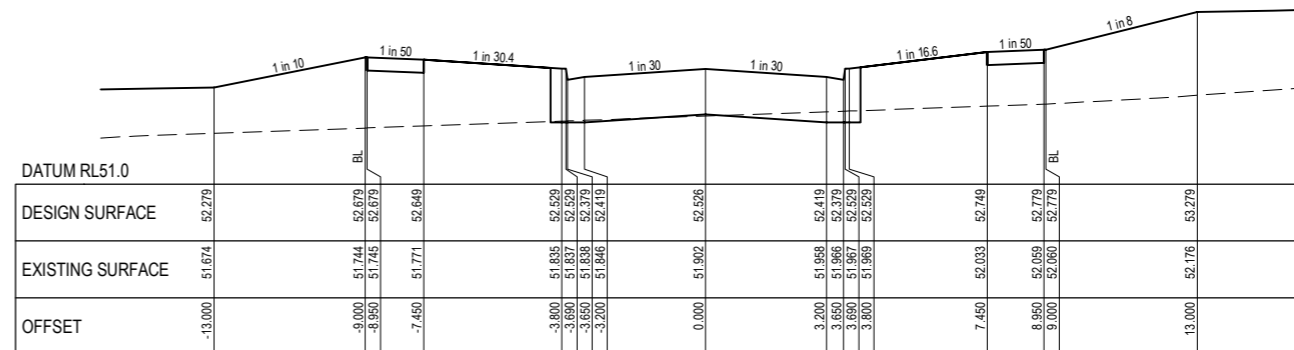

CH 102.660

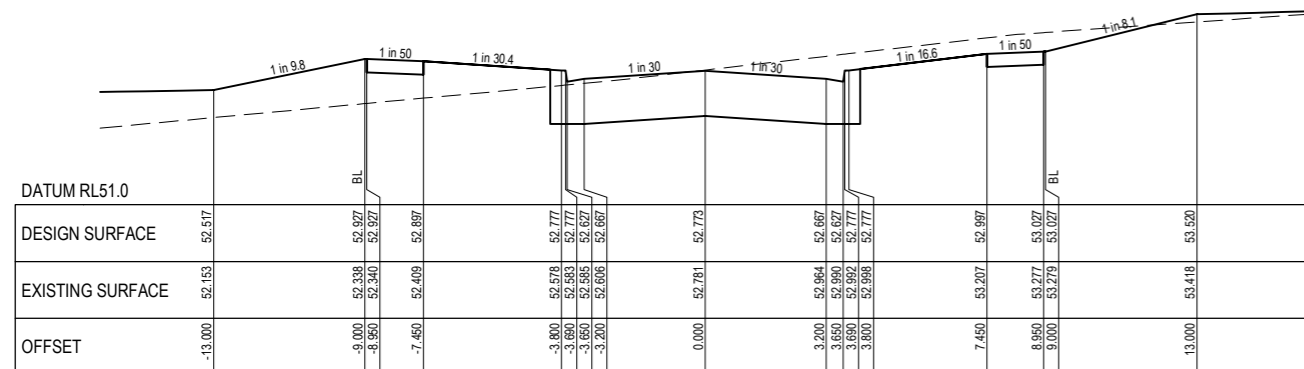

CH 43.110

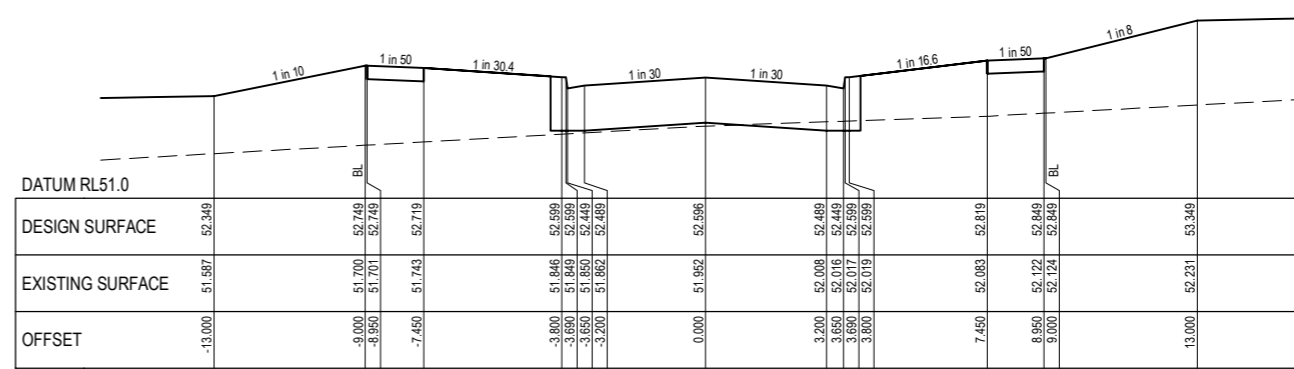

CH 88.660

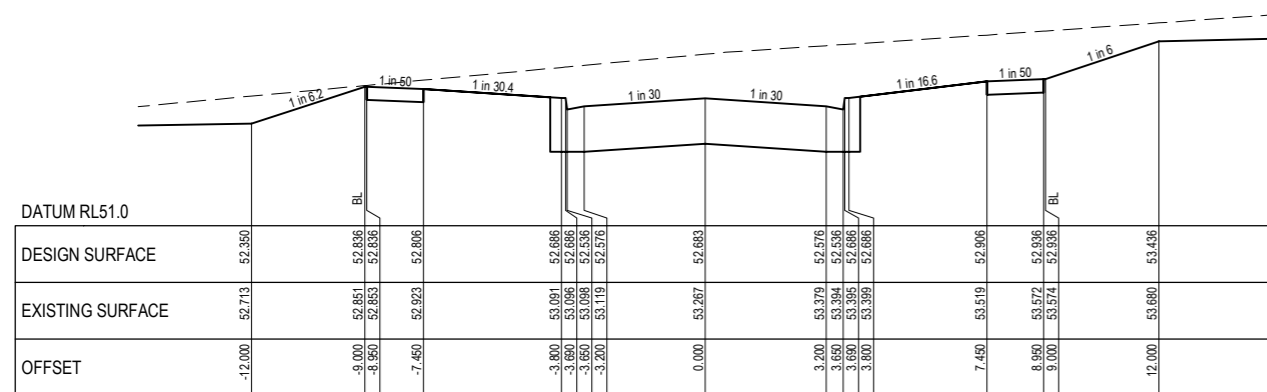

CH 25.000

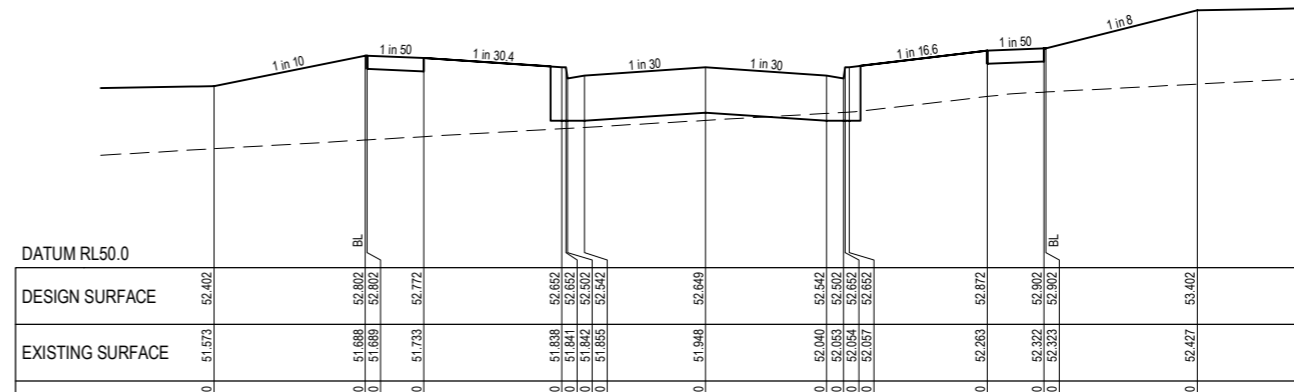

CH 78.160

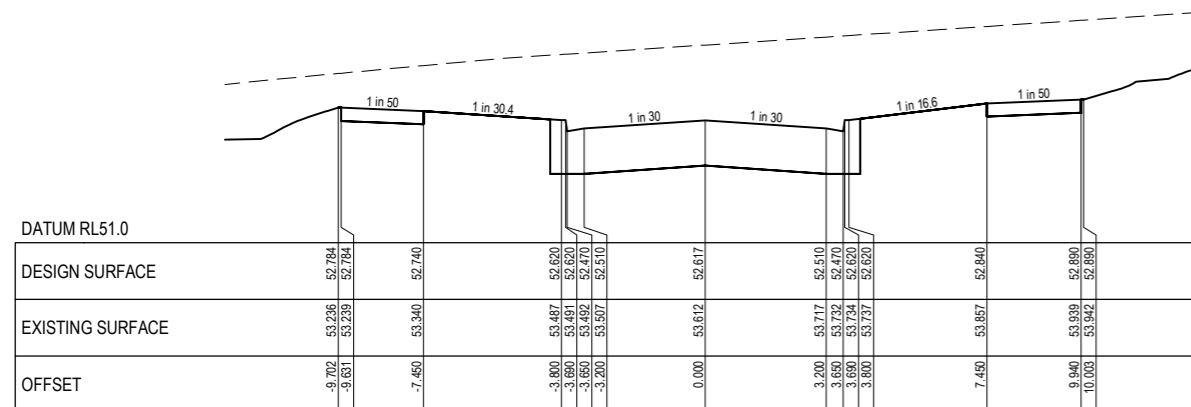

LTPCH 11.788

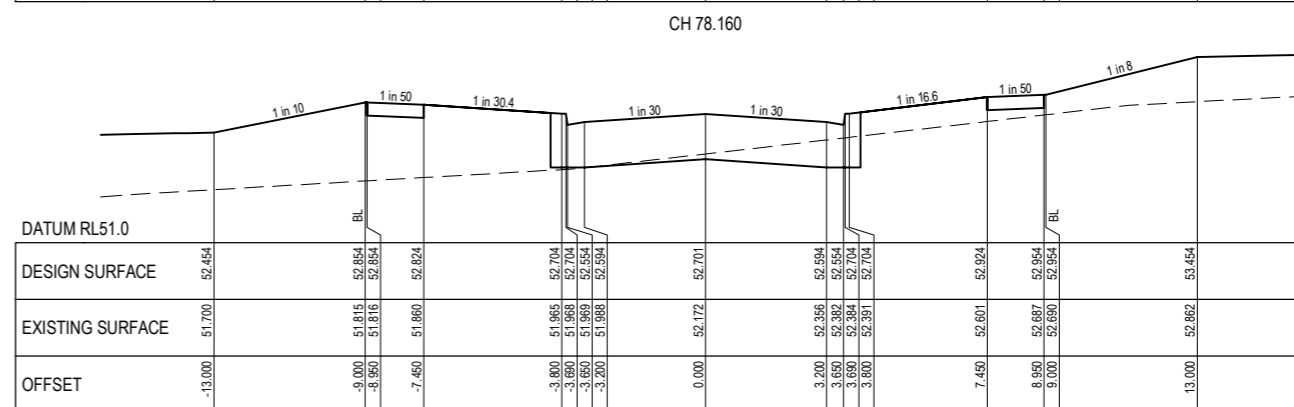

CH 67.660

Rev	Amendment	Des/Dt	App'd	Date	Legend
A	Initial Issue	GP/AW	MG	26/02/18	Existing Surface --- Design Line --- Future Surface --- 100 Yr Flood Level FL131.65 --- Freeboard Level --- Retaining Wall [Hatched]

Principal  
**acacia**  
BOTANIC RIDGE  
Peet Botanic Village Syndicate Ltd  
Level 4, 380 St Kilda Road  
Melbourne VIC 3004

**GPR Consulting**  
GPR Consulting Pty Ltd  
ABN 98 140 136 205  
Suite 217, 202 Jells Road  
Wheeters Hill Vic 3150  
Telephone (03) 8544 8400  
© GPR Consulting Pty Ltd

Council City of Casey  
Project **Acacia, Botanic Ridge Stage 8**  
Title Cross Sections Ravensbourne Grove  
Designed: G.Pratt  
Drafted: A.Wilkins  
Authorised: M.Graham  
Date: February 2018

Scale @ A1: H1:100 V1:50  
Drawing No. **0055-08-R14**  
Sheet 14 of 22  
Rev **A**



**NOTE:**  
WHERE ROAD PAVEMENT OR FOOTPATH IS ABOVE THE STRIPPED SURFACE IT IS TO BE FILLED WITH APPROVED TYPE A MATERIAL WITH A 45° ANGLE OF REPOSE.

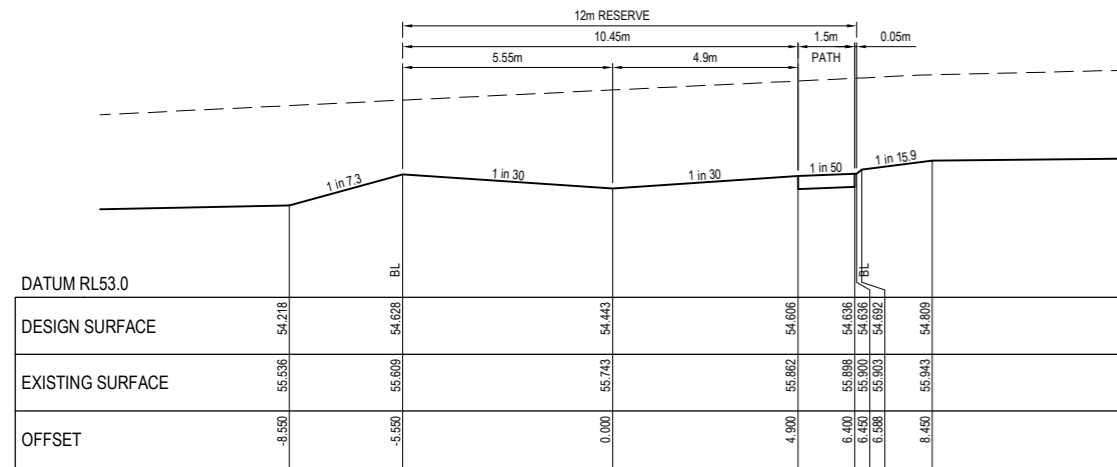

CH 70.000

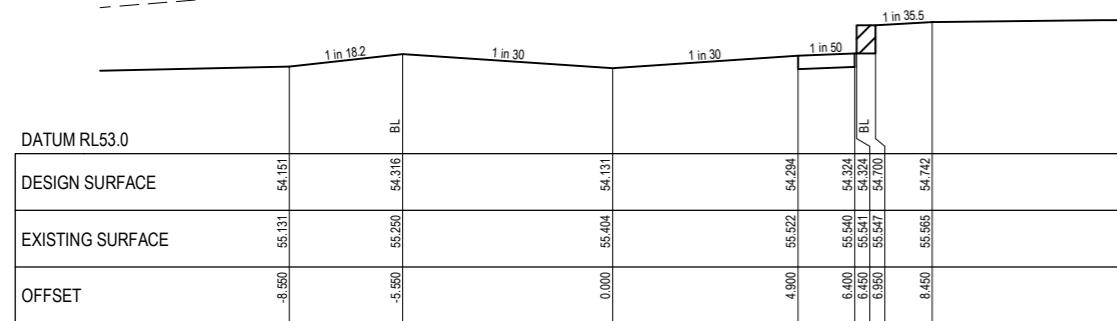

CH 60.000

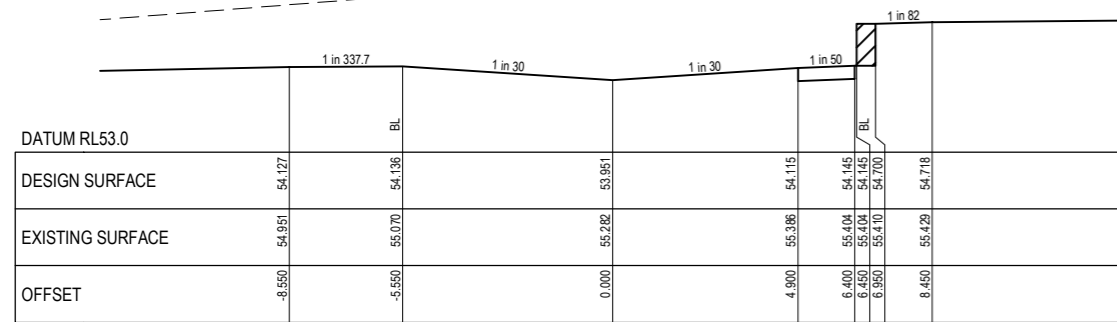

CH 56.403

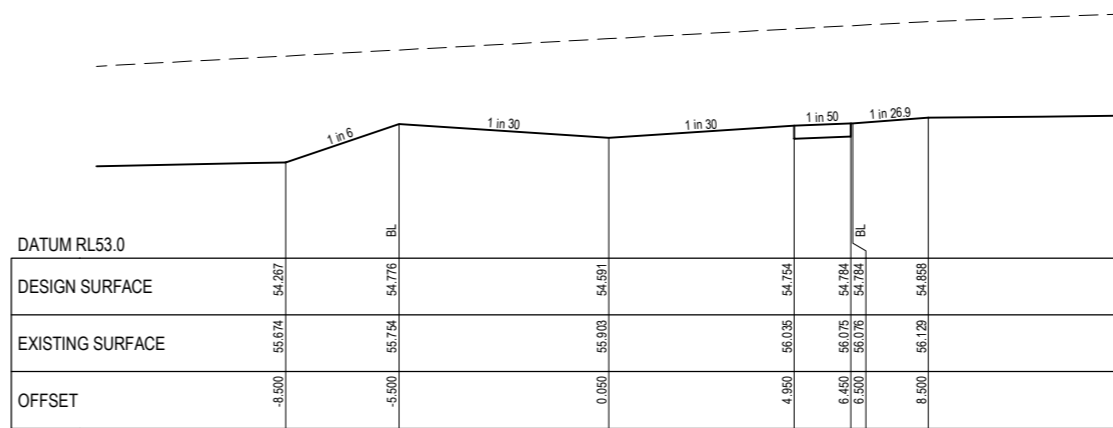

CH 77.403

Rev	Amendment	Des/Dt	App'd	Date	Legend
A	Initial Issue	GP/AW	MG	26/02/18	Existing Surface --- Design Line ——— Future Surface - - - 100 Yr Flood Level ——— FL131.65 Freeboard Level ——— F132.25 Retaining Wall [Hatched]

Principal  
**acacia**  
BOTANIC RIDGE  
Peet Botanic Village Syndicate Ltd  
Level 4, 380 St Kilda Road  
Melbourne VIC 3004

**GPR Consulting**  
GPR Consulting Pty Ltd  
ABN 98 140 136 205  
Suite 217, 202 Jells Road  
Wheeters Hill Vic 3150  
Telephone (03) 8544 8400  
© GPR Consulting Pty Ltd

Council	City of Casey
Project	Acacia, Botanic Ridge Stage 8
Title	Cross Sections Reserve
Designed:	G.Pratt
Authorised:	M.Graham
Drafted:	A.Wilkins
Date:	February 2018

Scale @ A1:	H1:100 V1:50
Drawing No.	0055-08-R15
Sheet	15 of 22
Rev	<b>A</b>

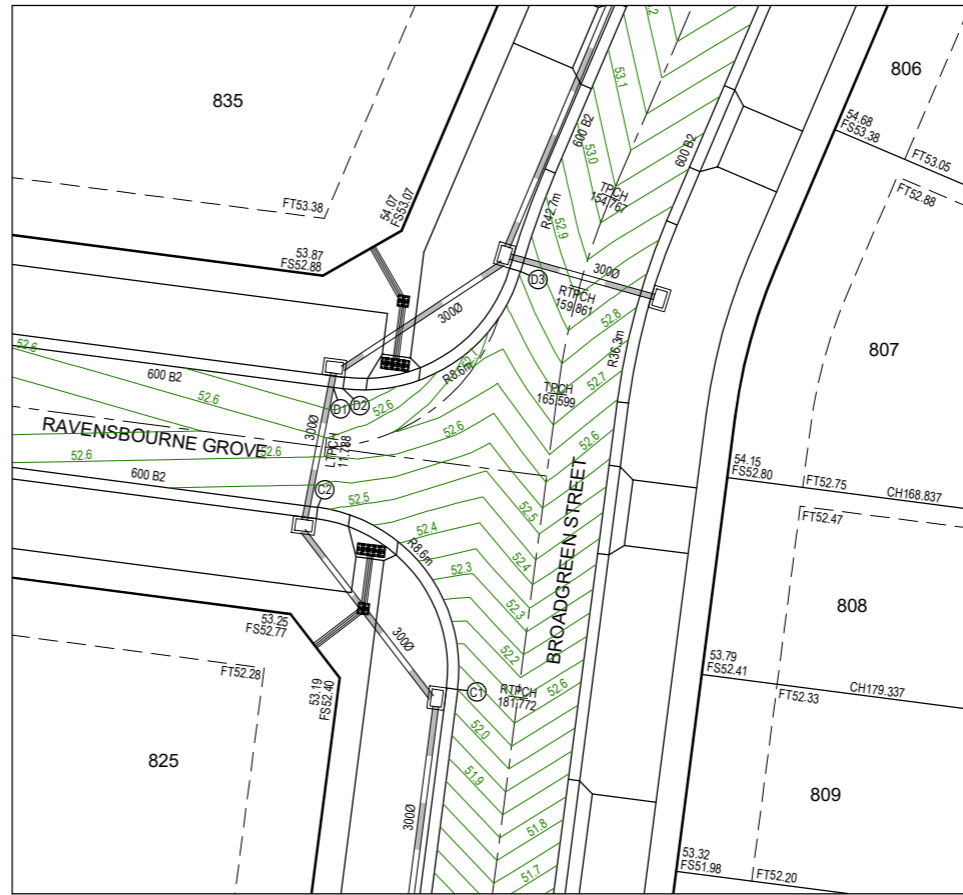
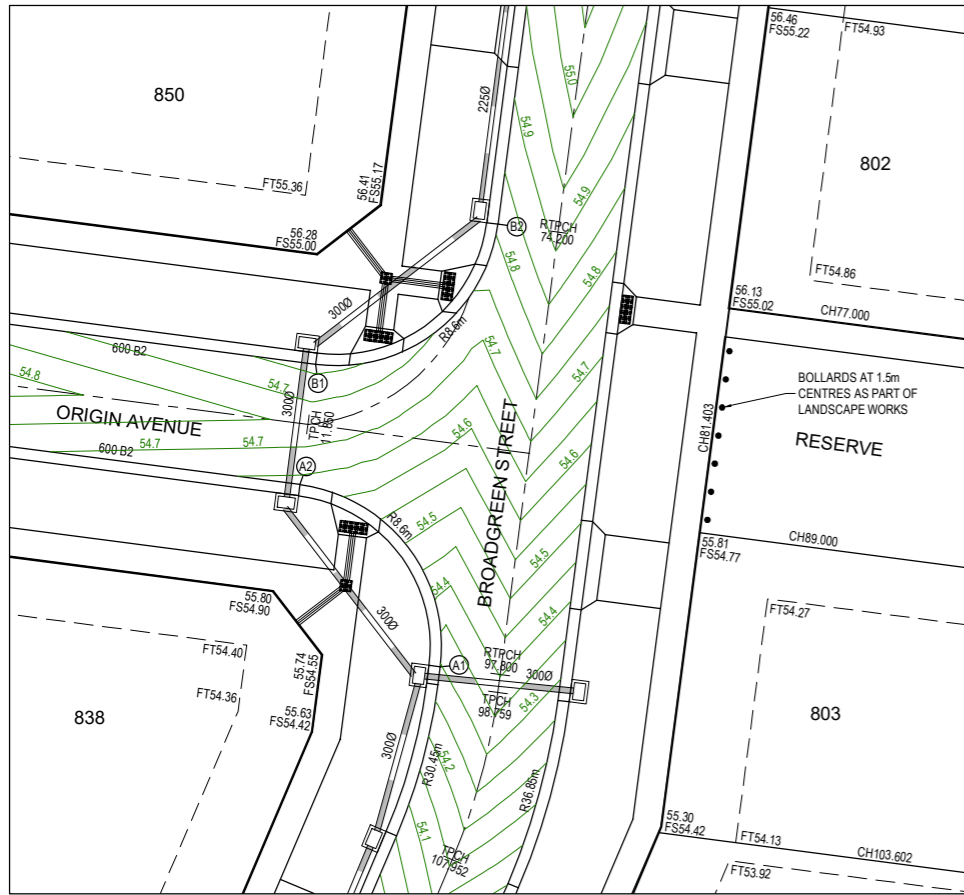

**WARNING**  
**BEWARE OF UNDERGROUND SERVICES**  
 The locations of underground services are approximate only and their exact position should be proven on site.  
 No guarantee is given that all existing services are shown.  
 Locate all underground services before commencement of works.  
**DIAL 1100 BEFORE YOU DIG**  
 www.1100.com.au

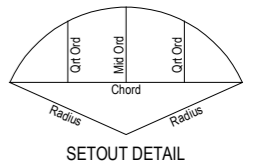

ALIGNMENT A					ALIGNMENT B				
POINT NO	EASTING	NORTHING	RL		POINT NO	EASTING	NORTHING	RL	
A1	349658.778	5776347.708	54.296		B1	349652.194	5776363.696	54.633	
A2	349651.365	5776357.350	54.633		B2	349661.836	5776371.110	54.810	

  

CURVE NO	RADIUS	CHORD	MID ORD	QTR ORD	MID ORD RL	CURVE NO	RADIUS	CHORD	MID ORD	QTR ORD	MID ORD RL
A1 - A2	8.600	12.162	2.519	1.963	54.494	B1 - B2	8.600	12.162	2.519	1.963	54.703

ALIGNMENT C					ALIGNMENT D				
POINT NO	EASTING	NORTHING	RL		POINT NO	EASTING	NORTHING	RL	
C1	349632.959	5776268.394	52.050		D1	349626.373	5776284.373	52.510	
C2	349625.544	5776278.027	52.510		D2	349626.885	5776284.306	52.513	
					D3	349636.278	5776290.505	52.806	

CURVE NO	RADIUS	CHORD	MID ORD	QTR ORD	MID ORD RL	CURVE NO	RADIUS	CHORD	MID ORD	QTR ORD	MID ORD RL
C1 - C2	8.600	12.156	2.516	1.961	52.327	D2 - D3	8.600	11.254	2.096	1.623	52.630

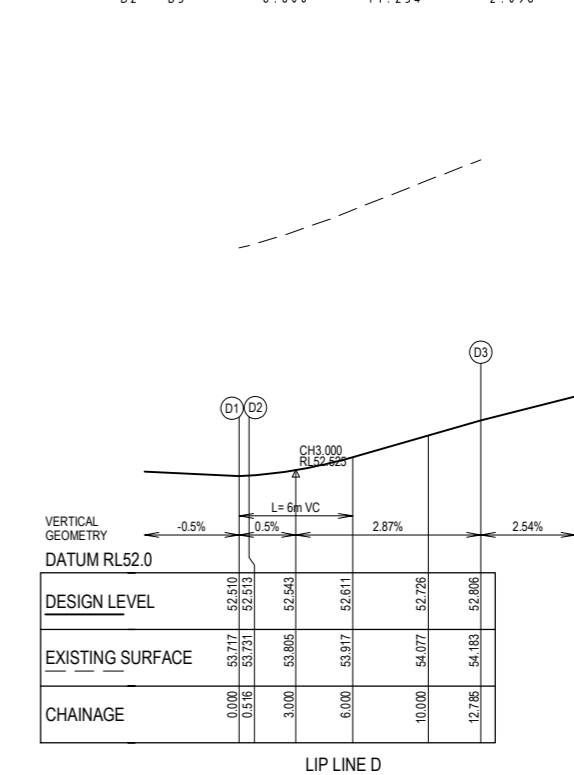
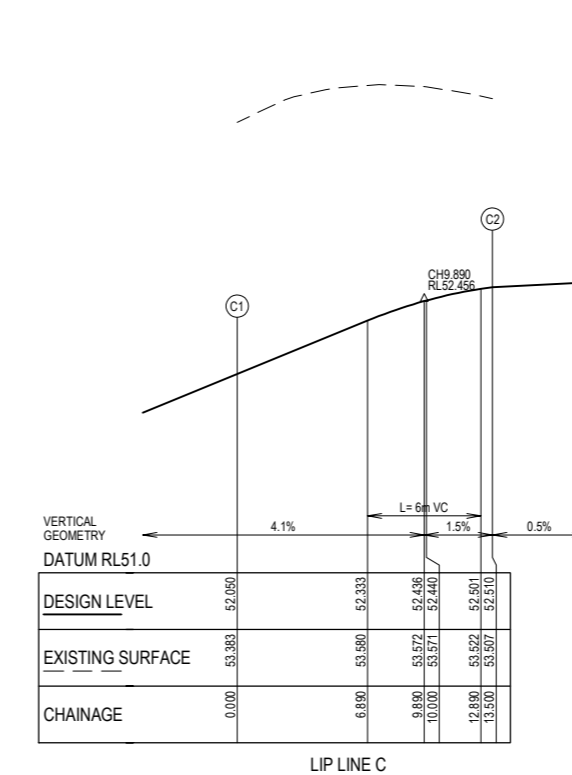
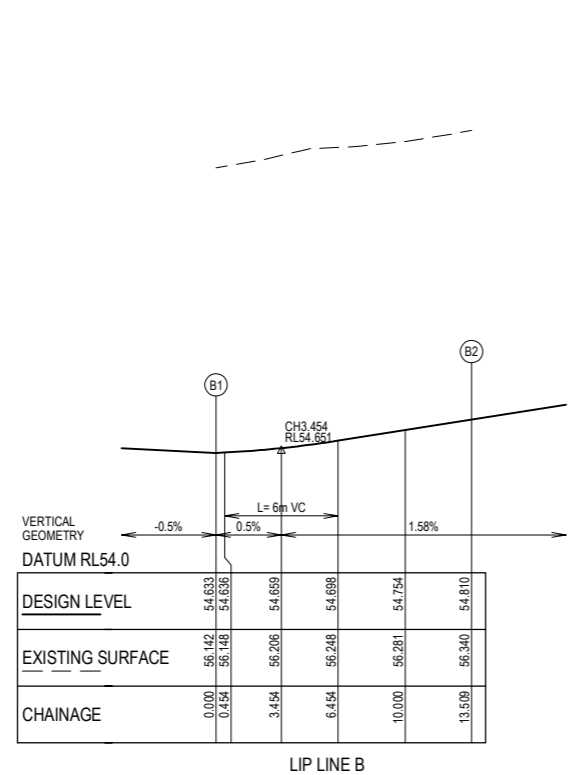
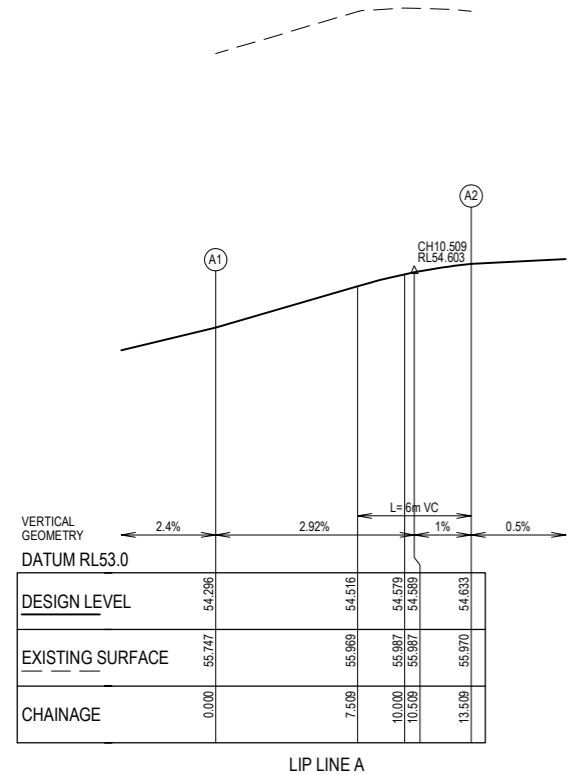

Rev	Amendment	Des/Dt	App'd	Date	Legend	
A	Initial Issue	GP/AW	MG	26/02/18	Existing Drain - Ex D	Drain & Property Inlet
					Existing House Drain - H	House Drain
					Existing Sewer - Ex S	Sewer
					Existing Gas - Ex G	Proposed Gas
					Existing Electricity U/G - Ex E	Proposed Electricity U/G
					Existing Electricity OH - Ex E	Proposed Communications
					Existing Communications - Ex T	Proposed Drinking Water
					Existing Drinking Water - Ex DW	Prop. Non-Drinking Water
					Existing Swale Drain - Ex S	PSM / TBM

Peet Botanic Village Syndicate Ltd  
 Level 4, 380 St Kilda Road  
 Melbourne VIC 3004

**GPR Consulting**

GPR Consulting Pty Ltd  
 ABN 98 140 136 205  
 Suite 217, 202 Jells Road  
 Wheelers Hill Vic 3150  
 Telephone (03) 8544 8400  
 © GPR Consulting Pty Ltd

Council: City of Casey

Project: **Acacia, Botanic Ridge Stage 8**

Title: **Intersection Details Sheet 1 of 2**

Designed: G.Pratt  
 Drafted: A.Wilkins

Authorised: M.Graham  
 Date: February 2018

Scale @ A1: H1:200 V1:20

Drawing No. **0055-08-R16**

Sheet 16 of 22  
 Rev **A**





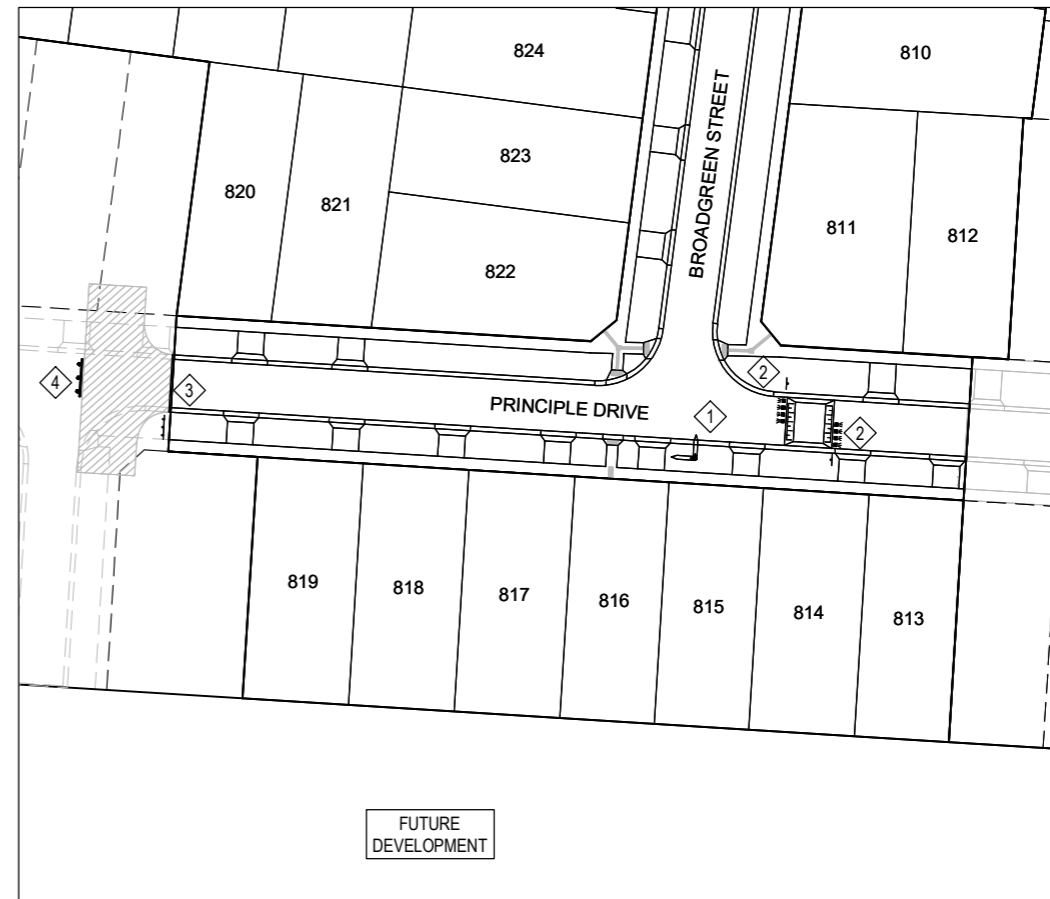

SIGN SCHEDULE	
SIGN	REF
	1
STREET SIGN	
	2
W5-10 & W8-2	
	3
TEMPORARY TURNING AREA ONLY UNTIL COMPLETION OF FUTURE STAGES	
REFER DETAIL	
	4
ROAD CLOSED	
G9-20 & D4-5	

FOR CONTINUATION REFER ABOVE RIGHT

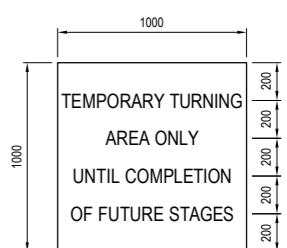

TEMPORARY TURNING AREA SIGN

- NOTES:
1. WHITE SIGN WITH BLACK FRAME & TEXT.
  2. LETTER HEIGHT 80mm.
  3. RATIO H2 : V1.

**WARNING**  
**BEWARE OF UNDERGROUND SERVICES**  
 The locations of underground services are approximate only and their exact position should be proven on site. No guarantee is given that all existing services are shown. Locate all underground services before commencement of works.  
**DIAL 1100 BEFORE YOU DIG**  
 www.1100.com.au

Rev	Amendment	Des/Dt	App'd	Date	Legend
A	Initial Issue	GP/AW	MG	26/02/18	Street Sign Sign RRPM

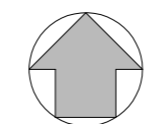

Principal  
**acacia**  
 BOTANIC RIDGE  
 Peet Botanic Village Syndicate Ltd  
 Level 4, 380 St Kilda Road  
 Melbourne VIC 3004

**GPR Consulting**  
 GPR Consulting Pty Ltd  
 ABN 98 140 136 205  
 Suite 217, 202 Jells Road  
 Wheelers Hill Vic 3150  
 Telephone (03) 8544 8400  
 © GPR Consulting Pty Ltd

Council City of Casey  
 Project **Acacia, Botanic Ridge Stage 8**  
 Title Signage & Linemarking Plan  
 Designed: G.Pratt  
 Drafted: A.Wilkins  
 Authorised: M.Graham  
 Date: February 2018

Scale @ A1: 1:500  
  
 Drawing No. **0055-08-R18**  
 Sheet 18 of 22  
 Rev **A**

**NOTE: DRAINAGE PIPES**  
 1. ALL DRAINAGE PIPES TO BE CLASS 2 RCP UNLESS NOTED OTHERWISE.  
 2. PIPES LESS THAN OR EQUAL TO 750mm ARE TO HAVE RUBBER RING JOINTS. ALL OTHER PIPES TO HAVE FLUSH JOINTS WITH EXTERNAL SEALING BAND.

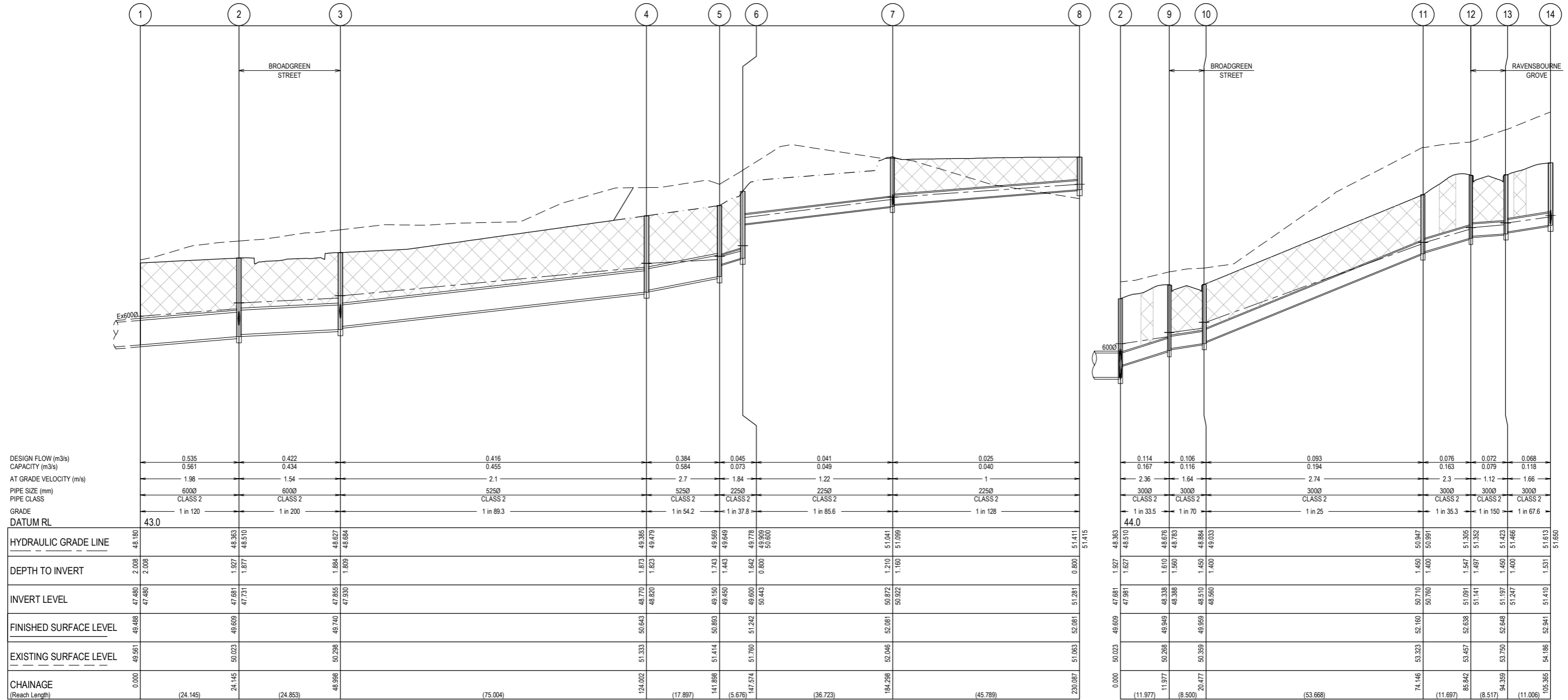

Rev	Amendment	Des/Dt	App'd	Date	Legend
A	Initial Issue	GP/AW	MG	26/02/18	Existing Surface Design Surface Future Design Surface Existing Drain Proposed Drain Hydraulic Grade Line Retaining Wall Crushed Rock Backfill Rock Beaching



Principal  
**acacia**  
 BOTANIC RIDGE  
 Peet Botanic Village Syndicate Ltd  
 Level 4, 380 St Kilda Road  
 Melbourne VIC 3004

**GPR Consulting**  
 GPR Consulting Pty Ltd  
 ABN 98 140 136 205  
 Suite 217, 202 Jells Road  
 Wheelers Hill Vic 3150  
 Telephone (03) 8544 8400  
 © GPR Consulting Pty Ltd

Council City of Casey  
 Project **Acacia, Botanic Ridge Stage 8**  
 Title Drainage Longitudinal Sections Sheet 1 of 3  
 Designed: G.Pratt  
 Drafted: A.Wilkins  
 Authorised: M.Graham  
 Date: February 2018

Scale @ A1: H1:500 V1:50  
  
 Drawing No. **0055-08-R19**  
 Sheet 19 of 22  
 Rev **A**

**NOTE: DRAINAGE PIPES**  
 1. ALL DRAINAGE PIPES TO BE CLASS 2 RCP UNLESS NOTED OTHERWISE.  
 2. PIPES LESS THAN OR EQUAL TO 750mm ARE TO HAVE RUBBER RING JOINTS. ALL OTHER PIPES TO HAVE FLUSH JOINTS WITH EXTERNAL SEALING BAND.

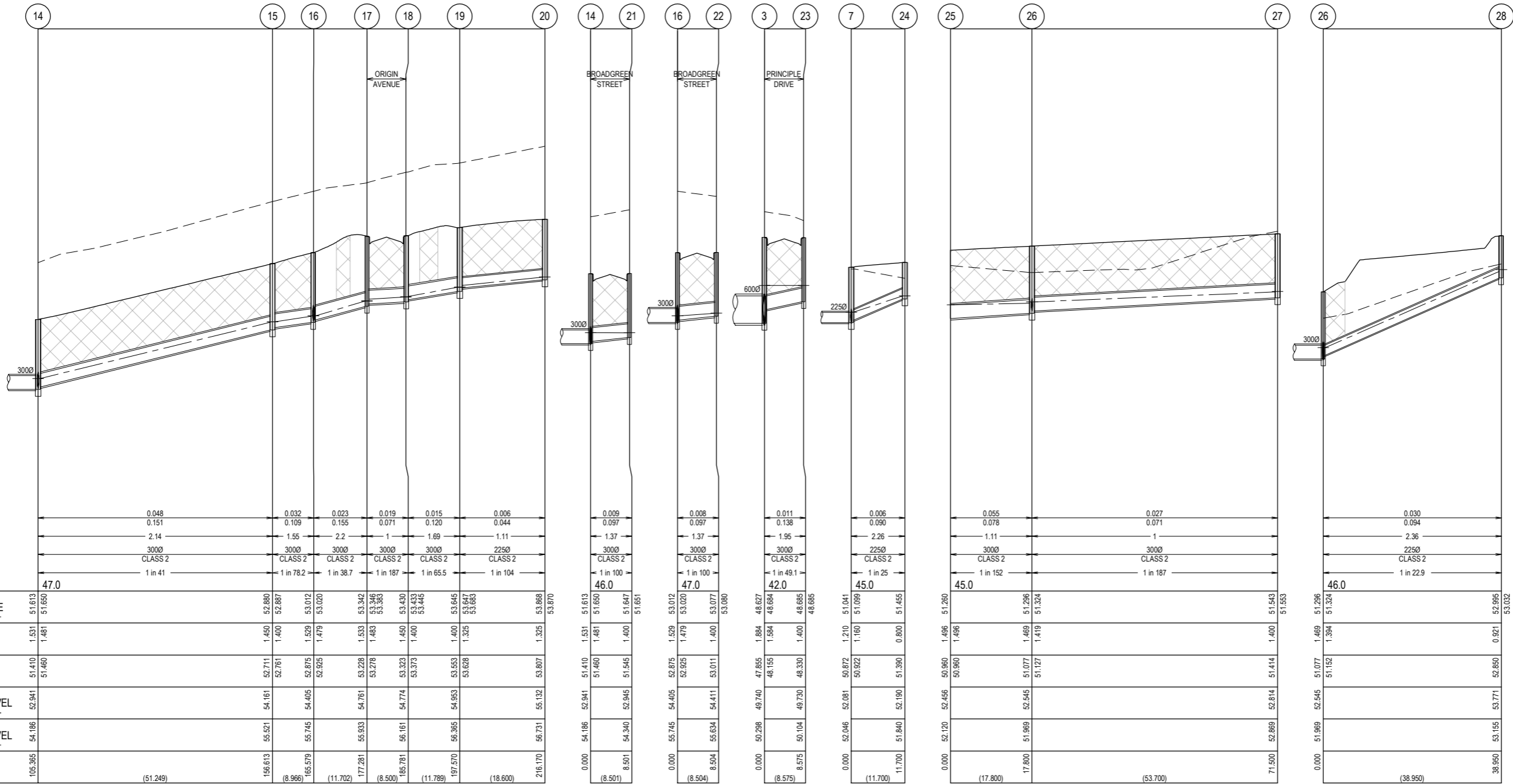

Rev	Amendment	Des/Dt	App'd	Date	Legend
A	Initial Issue	GP/AW	MG	26/02/18	Existing Surface Design Surface Future Design Surface Existing Drain Proposed Drain Hydraulic Grade Line Retaining Wall Crushed Rock Backfill Rock Beaching

Principal
acacia BOTANIC RIDGE
Peet Botanic Village Syndicate Ltd Level 4, 380 St Kilda Road Melbourne VIC 3004

**GPR Consulting**

GPR Consulting Pty Ltd  
 ABN 98 140 136 205  
 Suite 217, 202 Jells Road  
 Wheelers Hill Vic 3150  
 Telephone (03) 8544 8400  
 © GPR Consulting Pty Ltd

Council	City of Casey	Scale @ A1:	H1:500 V1:50
Project	Acacia, Botanic Ridge Stage 8		
Title	Drainage Longitudinal Sections Sheet 2 of 3	Drawing No.	0055-08-R20
Designed:	G.Pratt	Authorised:	M.Graham
Drafted:	A.Wilkins	Date:	February 2018
Sheet	20 of 22	Rev	A

**NOTE: DRAINAGE PIPES**  
 1. ALL DRAINAGE PIPES TO BE CLASS 2 RCP UNLESS NOTED OTHERWISE.  
 2. PIPES LESS THAN OR EQUAL TO 750mm ARE TO HAVE RUBBER RING JOINTS. ALL OTHER PIPES TO HAVE FLUSH JOINTS WITH EXTERNAL SEALING BAND.

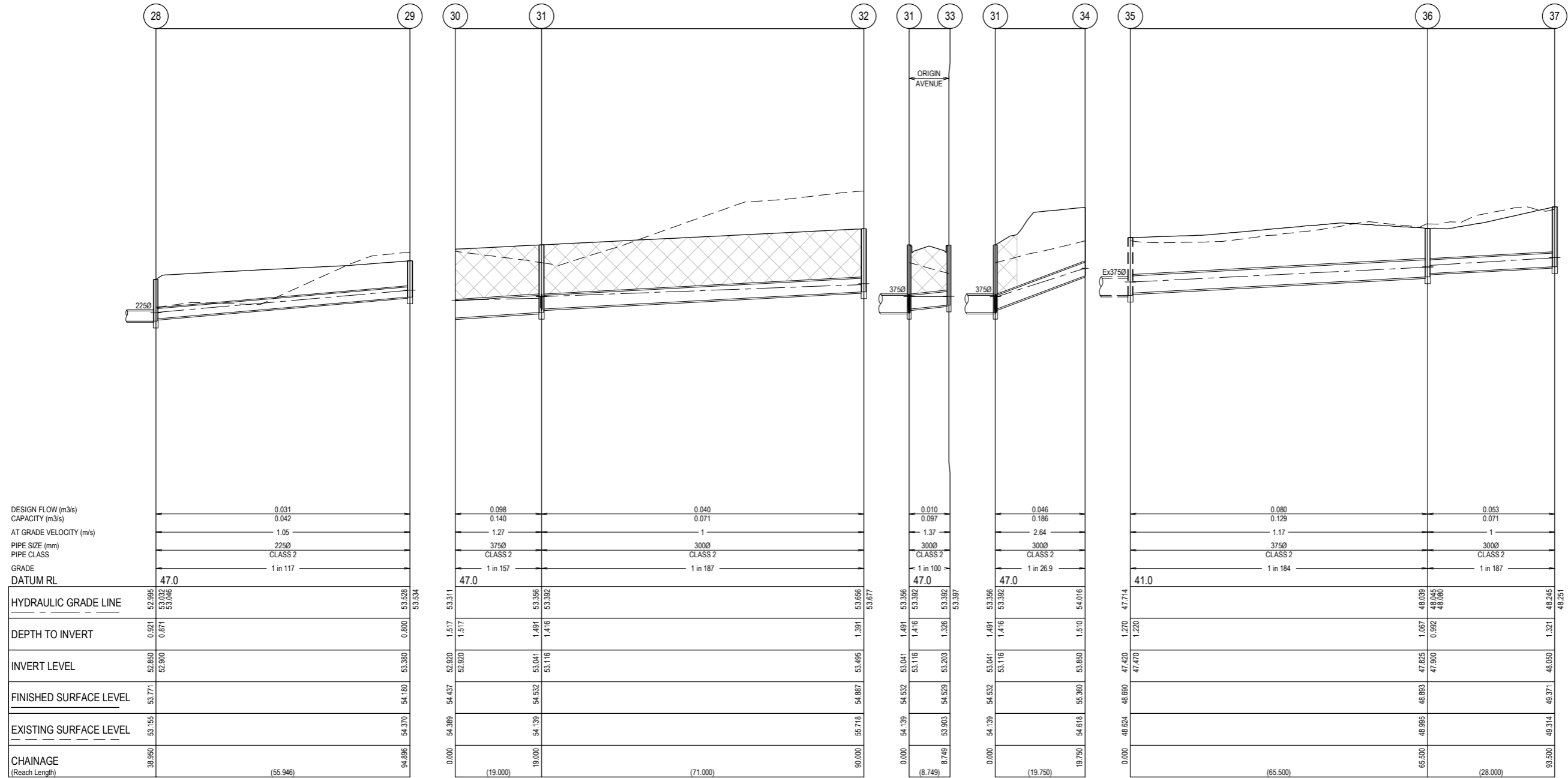

Rev	Amendment	Des/Dt	App'd	Date	Legend
A	Initial Issue	GP/AW	MG	26/02/18	Existing Surface --- Design Surface --- Future Design Surface --- Existing Drain --- Proposed Drain --- Hydraulic Grade Line --- Retaining Wall --- Crushed Rock Backfill --- Rock Beaching ---

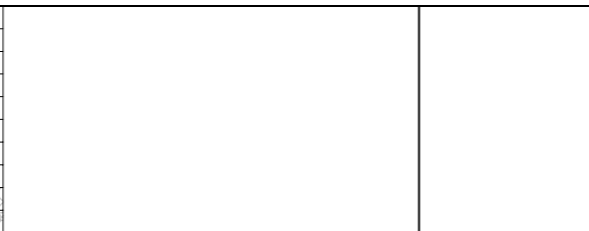

Principal  
**acacia**  
 BOTANIC RIDGE  
 Peet Botanic Village Syndicate Ltd  
 Level 4, 380 St Kilda Road  
 Melbourne VIC 3004

**GPR Consulting**  
 GPR Consulting Pty Ltd  
 ABN 98 140 136 205  
 Suite 217, 202 Jells Road  
 Wheelers Hill Vic 3150  
 Telephone (03) 8544 8400  
 © GPR Consulting Pty Ltd

Council City of Casey  
 Project **Acacia, Botanic Ridge Stage 8**  
 Title Drainage Longitudinal Sections Sheet 3 of 3  
 Designed: G.Pratt  
 Drafted: A.Wilkins  
 Authorised: M.Graham  
 Date: February 2018

Scale @ A1: H1:500 V1:50  
  
 Drawing No. **0055-08-R21**  
 Sheet 21 of 22  
 Rev **A**



