

These plans are design plans and are indicative only and parties must make any objection, requisition or claim for compensation in relation to the plans. The final condition of lots upon completion may vary from the condition described in the plans.
 The Property may have been filled, raised, levelled, compacted or cut prior to the Vendor becoming registered proprietor of the Property and the condition of the Property may change after completion of works due to circumstances beyond the Vendor's control. No warranty or representation is given or to be construed in respect of such works or changes in condition. Parties should review the plans carefully, make their own inquiries and obtain independent advice before taking any action in relation to the Property.

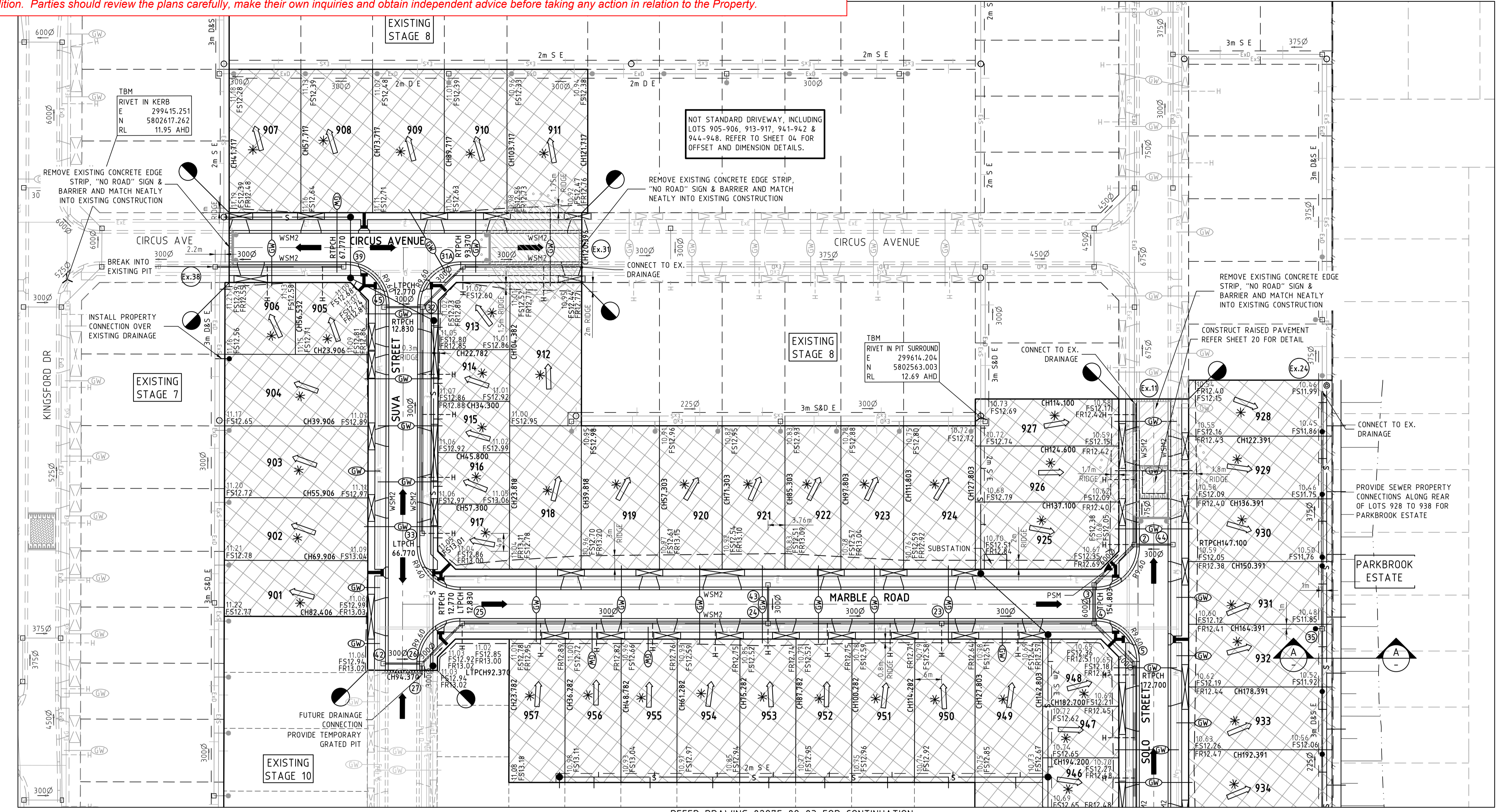

LEGEND - LAYOUT PLAN

- STORMWATER DRAIN, PIT & PROPERTY INLET
- SWALE DRAIN
- SEWER & MAINTENANCE STRUCTURES
- HOUSE DRAIN
- ELECTRICITY (U.GROUND) (INDICATIVE ONLY)
- ELECTRICITY (O.HEAD) (INDICATIVE ONLY)
- GAS (INDICATIVE ONLY)
- TELSTRA (INDICATIVE ONLY)
- WATER (INDICATIVE ONLY)
- RECYCLED WATER (INDICATIVE ONLY)
- AG. DRAIN (INDICATIVE ONLY)
- OPTIC FIBRE (INDICATIVE ONLY)
- SERVICE CONDUITS
- TACTILE PAVERS
- EXISTING ELECTRICITY (UNDERGROUND) (INDICATIVE ONLY)
- EXISTING ELECTRICITY (OVERHEAD) (INDICATIVE ONLY)
- EXISTING GAS (INDICATIVE ONLY)
- EXISTING TELSTRA (INDICATIVE ONLY)
- EXISTING OPTIC FIBRE (INDICATIVE ONLY)
- EXISTING WATER (INDICATIVE ONLY)
- EXISTING RECYCLED WATER (INDICATIVE ONLY)
- EXISTING STORMWATER DRAIN (INDICATIVE ONLY)
- EXISTING SEWER (INDICATIVE ONLY)
- EXISTING HOUSE DRAIN
- EXISTING SWALE DRAIN
- FUTURE AG DRAIN (INDICATIVE ONLY)
- FUTURE ELECTRICITY (UNDERGROUND) (INDICATIVE ONLY)
- FUTURE ELECTRICITY (OVERHEAD) (INDICATIVE ONLY)
- FUTURE GAS (INDICATIVE ONLY)
- FUTURE TELSTRA (INDICATIVE ONLY)
- FUTURE OPTIC FIBRE (INDICATIVE ONLY)
- FUTURE WATER (INDICATIVE ONLY)
- FUTURE RECYCLED WATER (INDICATIVE ONLY)
- FUTURE STORMWATER DRAIN (INDICATIVE ONLY)
- FUTURE SEWER (INDICATIVE ONLY)
- FUTURE HOUSE DRAIN
- EXISTING SURFACE LEVEL
- EXISTING BUILDING LEVEL
- FINISHED RIDGE LINE LEVEL
- TOP OF RETAINING WALL
- BOTTOM OF RETAINING WALL
- RETAINING WALL
- ZERO LOT LINES
- PAVEMENT TREATMENT
- STRUCTURAL FILL > 200mm DEEP
- EX. STRUCTURAL FILL > 200mm DEEP
- DIRECTION OF FALL
- OVERLAND FLOW
- ALLOTMENT TO BE GRADED EVENLY IN DIRECTION OF FALL TO LEVELS INDICATED
- CONCRETE EDGE STRIP WITH SUBSOIL DRAIN, "NO ROAD" SIGN & BARRIER
- LIMIT OF WORKS
- EXISTING TREE TO BE REMOVED
- EXISTING TREE TO BE RETAINED
- PERMANENT SURVEY MARK
- TEMPORARY BENCH MARK
- PROPOSED DRIVEWAY

REFER DRAWING 0297E-09-03 FOR CONTINUATION

SERVICES OFFSET SCHEDULE

ROAD NAME	GAS		WATER		ELECTRICITY		TELSTRA	
	SIDE	OFFSET (m)	SIDE	OFFSET (m)	SIDE	OFFSET (m)	SIDE	OFFSET (m)
CIRCUS AVENUE	SOUTH	2.25	SOUTH	2.70	NORTH	2.35	NORTH	1.85
MARBLE ROAD	SOUTH	2.25	SOUTH	2.70	NORTH	2.35	NORTH	1.85
KNIGHT AVENUE	SOUTH	2.25	SOUTH	2.70	NORTH	2.35	NORTH	1.85
SOLO STREET	EAST	2.25	EAST	2.70	WEST	2.35	WEST	1.85
SUVA STREET	WEST	2.25	WEST	2.70	EAST	2.35	EAST	1.85

ROAD LAYOUT TABLE

ROAD NAME	RESERVE WIDTH (m)	ROAD WIDTH (m)				KERB TYPE		VERGE WIDTH (m)	
		LIP to LIP	INV to INV	BACK to BACK	NTH/WEST	STH/EAST	NTH/WEST	STH/EAST	
CIRCUS AVENUE	15.60	6.40	7.00	7.60	WSM2	WSM2	4.00	4.00	
MARBLE ROAD	15.60	6.40	7.00	7.60	WSM2	WSM2	4.00	4.00	
KNIGHT AVENUE	15.60	6.40	7.00	7.60	WSM2	WSM2	4.00	4.00	
SOLO STREET	15.60	6.40	7.00	7.60	WSM2	WSM2	4.00	4.00	
SUVA STREET	15.60	6.40	7.00	7.60	WSM2	WSM2	4.00	4.00	

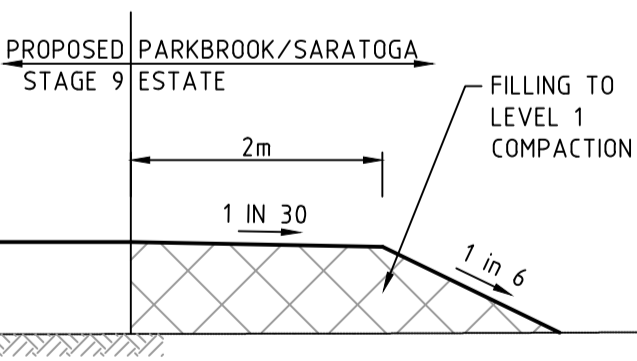

AS CONSTRUCTED PLANS
 The purpose of these as-constructed plans is to update the design drawings to show significant changes which occurred during construction. Note that the levels shown on these plans are design levels, and have not been verified by survey. All information shown on these plans should be verified on site. SMEC Urban and SMEC Australia Pty Ltd accept no responsibility for loss or damages resulting from the inappropriate usage of these plans.

WARNING
BEWARE OF UNDERGROUND SERVICES
 The locations of underground services are approximate only and their exact position should be proven on site. No guarantee is given that all existing services are shown. Locate all underground services before commencement of works
DIAL 1100 BEFORE YOU DIG
 www.1100.com.au

75/110/2769/08/E9

REVISION	DATE	DES/DFT	APPD
G	DOUBLE DWAY ADDED		
F	AS CONSTRUCTED		
E	LOTS 905-906,913-917,941-942-944-948 DW UPDATED	04.03.14	AS/AS NH
D	ISSUED FOR CONSTRUCTION	15.11.13	MB/MB NH
C	ISSUED TO COUNCIL FOR APPROVAL	08.07.13	KM/KM NH
B	ISSUED TO COUNCIL FOR APPROVAL	25.06.13	SM/SS NH
A	ISSUED TO COUNCIL FOR APPROVAL	17.05.13	SM/SS NH
		19.04.13	SM/SS NH
		17.04.13	SM/SS NH

Kingsford AT POINT COOK
 Principal
 Peet Point Cook Kingsford Syndicate
 Level 3, 492 St Kilda Road
 Melbourne VIC 3004

All setting out should be carried out in accordance with GAA/Council's standard drawings or as nominated on hard copy plans provided by SMEC Urban. Any digital information supplied by this office is for information only. Any discrepancies should be discussed with the superintendent.

Designed
S.Murad
 Drawn
S.Sathasivam
 Checked
K.Mak
 Authorised
N.Hollow
 Date
April 2013

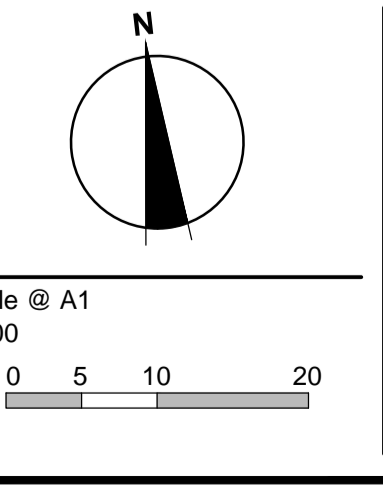

© SMEC Australia Pty Ltd
 ABN 47 065 475 148
 These designs and drawings are the copyright of SMEC Australia Pty Ltd.
 The drawing shall not be reproduced or copied, in whole or part, without the written permission of SMEC Australia Pty Ltd.
 The contents of this drawing are electronically generated, are confidential and may only be used for the purpose for which they are intended.

smeC urban
 Part of the SMEC Group

SmeC Urban
 Level 10, 71 Queens Road, Melbourne, VIC, 3004
 p +61 3 9869 0800 | f +61 3 9869 0900 | www.smeC.com.au

Adelaide +61 8 8223 6455
 Brisbane +61 7 3831 8988
 Canberra +61 2 6126 1900
 Geelong +61 3 5228 3100
 Gold Coast +61 7 5578 0222
 Trawalgon +61 3 5173 0100

KINGSFORD AT POINT COOK
 Stage 9
 Wyndham City Council
 Roadworks and Drainage
 Layout Plan - 1

Drawing No. 0297E-09-02 **Rev G**
 Sheet No. 2 of 21

As Constructed

I:\work\0297E-09-03\0297E-09-03.dwg

These plans are design plans and are indicative only and parties must not make any objection, requisition or claim for compensation in relation to the plans. The final condition of lots upon completion may vary from the condition described in the plans. The Property may have been filled, raised, levelled, compacted or cut prior to the Vendor becoming registered proprietor of the Property and the condition of the Property may change after completion of works due to circumstances beyond the Vendor's control. No warranty or representation is given or to be construed in respect of such works or changes in condition. Parties should review the plans carefully, make their own inquiries and obtain independent advice before taking any action in relation to the Property.

REFER DRAWING 0297E-09-02 FOR CONTINUATION

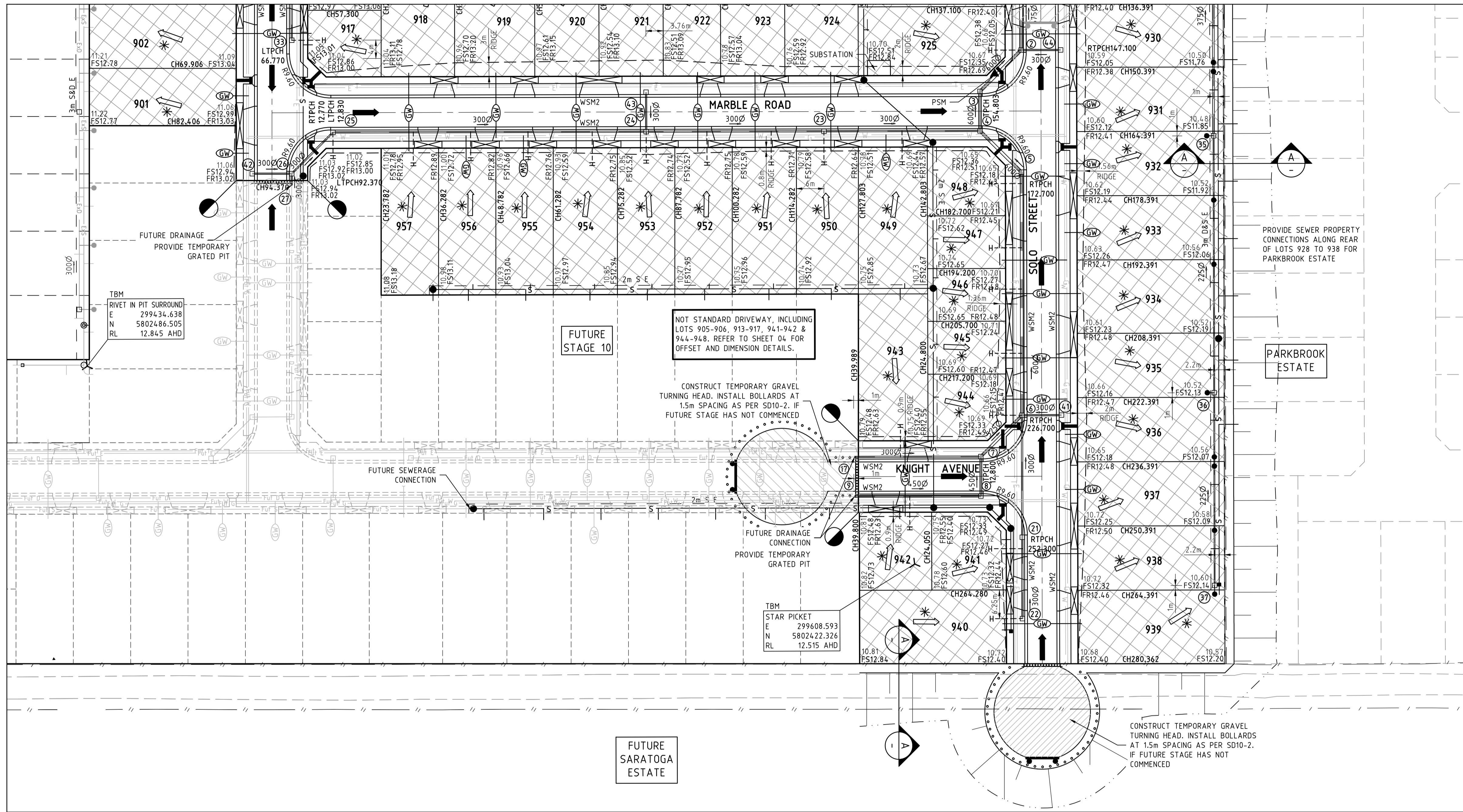

LEGEND - LAYOUT PLAN

- STORMWATER DRAIN, PIT & PROPERTY INLET
- SWALE DRAIN
- SEWER & MAINTENANCE STRUCTURES
- HOUSE DRAIN
- ELECTRICITY (U.GROUND) (INDICATIVE ONLY)
- ELECTRICITY (O.HEAD) (INDICATIVE ONLY)
- GAS (INDICATIVE ONLY)
- TELSTRA (INDICATIVE ONLY)
- WATER (INDICATIVE ONLY)
- RECYCLED WATER (INDICATIVE ONLY)
- AG. DRAIN (INDICATIVE ONLY)
- OPTIC FIBRE (INDICATIVE ONLY)
- SERVICE CONDUITS
- TACTILE PAVERS
- EXISTING ELECTRICITY (UNDERGROUND) (INDICATIVE ONLY)
- EXISTING ELECTRICITY (OVERHEAD) (INDICATIVE ONLY)
- EXISTING GAS (INDICATIVE ONLY)
- EXISTING TELSTRA (INDICATIVE ONLY)
- EXISTING OPTIC FIBRE (INDICATIVE ONLY)
- EXISTING WATER (INDICATIVE ONLY)
- EXISTING RECYCLED WATER (INDICATIVE ONLY)
- EXISTING STORMWATER DRAIN (INDICATIVE ONLY)
- EXISTING SEWER (INDICATIVE ONLY)
- EXISTING HOUSE DRAIN
- EXISTING SWALE DRAIN
- FUTURE AG DRAIN (INDICATIVE ONLY)
- FUTURE ELECTRICITY (UNDERGROUND) (INDICATIVE ONLY)
- FUTURE ELECTRICITY (OVERHEAD) (INDICATIVE ONLY)
- FUTURE GAS (INDICATIVE ONLY)
- FUTURE TELSTRA (INDICATIVE ONLY)
- FUTURE OPTIC FIBRE (INDICATIVE ONLY)
- FUTURE WATER (INDICATIVE ONLY)
- FUTURE RECYCLED WATER (INDICATIVE ONLY)
- FUTURE STORMWATER DRAIN (INDICATIVE ONLY)
- FUTURE SEWER (INDICATIVE ONLY)
- FUTURE HOUSE DRAIN
- EXISTING SURFACE LEVEL
- FINISHED BUILDING LINE LEVEL
- FINISHED RIDGE LINE LEVEL
- TOP OF RETAINING WALL
- BOTTOM OF RETAINING WALL
- RETAINING WALL
- ZERO LOT LINES
- PAVEMENT TREATMENT
- STRUCTURAL FILL > 200mm DEEP
- EX. STRUCTURAL FILL > 200mm DEEP
- DIRECTION OF FALL
- OVERLAND FLOW
- ALLOTMENT TO BE GRADED EVENLY IN DIRECTION OF FALL TO LEVELS INDICATED
- CONCRETE EDGE STRIP WITH SUBSOIL DRAIN, "NO ROAD" SIGN & BARRIER
- LIMIT OF WORKS
- EXISTING TREE TO BE REMOVED
- EXISTING TREE TO BE RETAINED
- PERMANENT SURVEY MARK
- TEMPORARY BENCH MARK
- PROPOSED DRIVEWAY

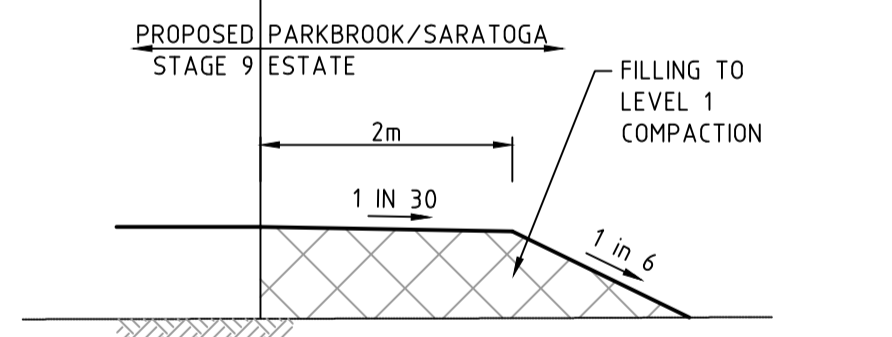

**SECTION A-A
TYPICAL BOUNDARY FILL & BATTER
TO FUTURE DEVELOPMENT
NOT TO SCALE**

AS CONSTRUCTED PLANS
The purpose of these as-constructed plans is to update the design drawings to show significant changes which occurred during construction. Note that the levels shown on these plans are design levels, and have not been verified by survey. All information shown on these plans should be verified on site. SMEC Urban and SMEC Australia Pty Ltd accept no responsibility for loss or damages resulting from the inappropriate usage of these plans.

75/110/2769/08/E9

**WARNING
BEWARE OF UNDERGROUND SERVICES**
The locations of underground services are approximate only and their exact position should be proven on site. No guarantee is given that all existing services are shown. Locate all underground services before commencement of works.
DIAL 1100 BEFORE YOU DIG
www.1100.com.au

I:\work\0297E-09-02\0297E-09-02.dwg

REVISION	DATE	DES/DFT	APPD
G	04.03.14	AS/AS	NH
F	15.11.13	MB/MB	NH
E	08.07.13	KM/KM	NH
D	25.06.13	SM/SS	NH
C	17.05.13	SM/SS	NH
B	19.04.13	SM/SS	NH
A	17.04.13	SM/SS	NH

Kingsford
AT POINT COOK
Principal
Peet Point Cook Kingsford Syndicate
Level 3, 492 St Kilda Road
Melbourne VIC 3004

All setting out should be carried out in accordance with GAA/Council's standard drawings or as nominated on hard copy plans provided by SMEC Urban. Any digital information supplied by this office is for information only. Any discrepancies should be discussed with the superintendent.

Designed
S.Murad
Drawn
S.Sathasivam
Checked
K.Mak
Authorised
N.Hollow
Date
April 2013

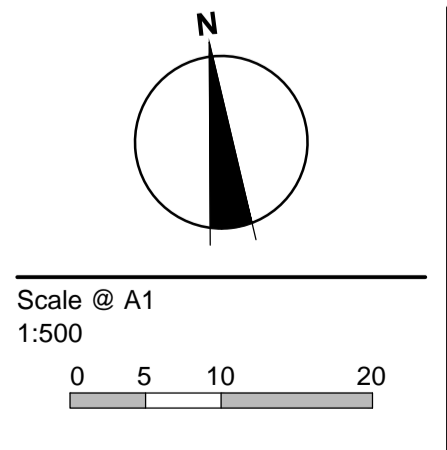

© SMEC Australia Pty Ltd
ABN 47 065 475 148
These designs and drawings are the copyright of SMEC Australia Pty Ltd.
The drawing shall not be reproduced or copied, in whole or part, without the written permission of SMEC Australia Pty Ltd.
The contents of this drawing are electronically generated, are confidential and may only be used for the purpose for which they are intended.

smec urban
Part of the SMEC Group
SmeC Urban
Level 10, 71 Queens Road, Melbourne, VIC, 3004
p +61 3 9869 0800 | f +61 3 9869 0900 | www.smeC.com.au

Adelaide +61 8 8223 6455
Brisbane +61 7 3831 8988
Canberra +61 2 6126 1900
Geelong +61 3 5228 3100
Gold Coast +61 7 5578 0222
Traralgon +61 3 5173 0100

KINGSFORD AT POINT COOK
Stage 9
Wyndham City Council
Roadworks and Drainage
Layout Plan - 2
Drawing No. **0297E-09-03** Rev G
Sheet No. 3 of 21
As Constructed