



Keeping our estate well maintained is up to all of us:

- **The City of Wanneroo (City)**
- **Peet**
- **Residents**

Everyone knows first impressions matter and, at Yanchep Golf Estate, we're keen to ensure our community's streetscape always looks the part. The streetscape is the visual identity of a neighbourhood and plays an important role in adding to the character, amenity, biodiversity, habitat and cooling of the community as a whole.

With that in mind, we have developed some guidelines to help you understand who is responsible for the maintenance of verges.

Did you know that the City of Wanneroo offers a free verge tree planting service to residents and businesses every winter?

There are a variety of trees to choose from and planting will occur over the winter months. All forms need to be submitted by 30 April each year, with planting taking place over the following winter months.

Find Out More:

www.wanneroo.wa.gov.au/forms/form/157/verge_tree_planting_request

THE CITY

The City is responsible for maintaining:

- Roundabouts
- Public access ways
- Swales
- Street trees
- Median strips
- Several verges that border parks

Contact the City of Wanneroo
enquiries@wanneroo.wa.gov.au
(08) 9405 5000

Ranger & Safety Services

9405 5000 during office hours or
1300 138 393 after office hours.

PEET

Peet is responsible for the maintenance of Parks that have not yet been handed over to the City.

This currently includes:

- Linksman Park (Stages 1 and 2, including the western verge)
- Pivot Park
- Victory Park (including the western verge)
- The Entry Statement/Sales Office (including the verge, roundabout and Yanchep Beach Road medians)
- Marker Drive Park

Contact Peet

customer.relations@peet.com.au
(08) 9420 1111

RESIDENTS

Residents are responsible for maintaining their front and side verges (if there is a swale in the verge at the side of your property this is maintained by the City), including the watering of street trees.

VERGE MAINTENANCE RESPONSIBILITY EXAMPLES

- Resident to maintain verge.
- City to maintain.
- Developer to maintain.

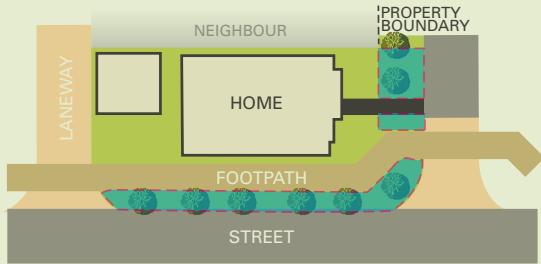

EXAMPLE 1

- Rear loaded corner.
- Resident to maintain front verge and side verge.



EXAMPLE 2

- Yanchep Golf Estate entry – all of the parks, verges, median strips and roundabouts in the area outlined above are the Developer's responsibility.

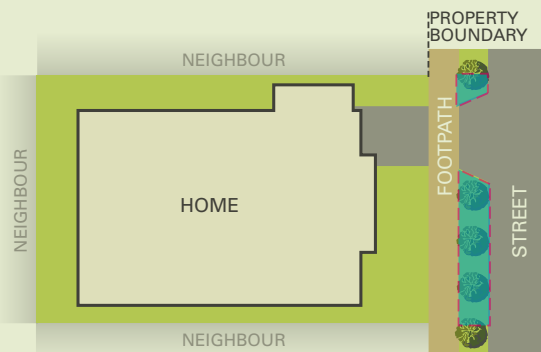

EXAMPLE 3

- Front loaded.
- Resident to maintain (beyond the footpath).

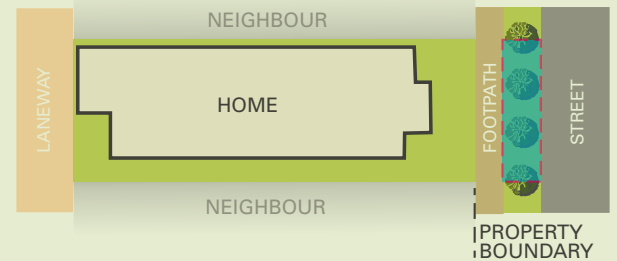

EXAMPLE 4

- Rear loaded.
- Resident to maintain front verge (beyond the footpath).

Note: Rear loaded means the garage is located off the laneway. Front loaded means the garage is located off the main street.

VERGE MAINTENANCE RESPONSIBILITY EXAMPLES

- Resident to maintain verge.
- City to maintain.
- Developer maintain.

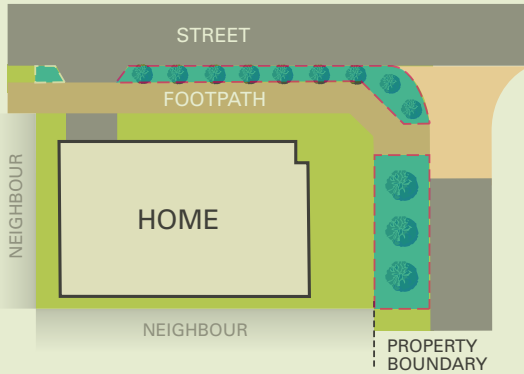

EXAMPLE 5

- Front loaded corner.
- Resident to maintain front verge and side verge.

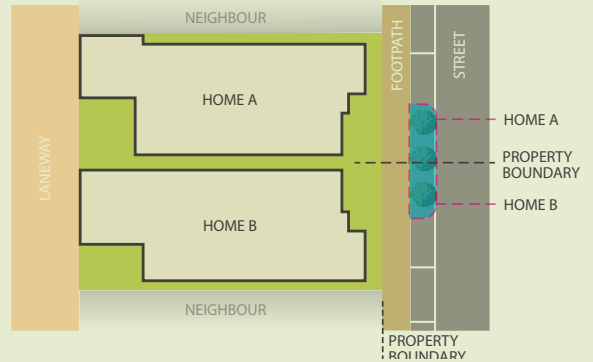

EXAMPLE 6

- Rear loaded with car bays in front.
- Resident to maintain front verge (beyond the footpath).



EXAMPLE 7

- Median strips – all median strips are the City's responsibility.



EXAMPLE 8

- Park verges – all verges that are abutting both a road and footpath next to a park are the City's responsibility.

Note: Rear loaded means the garage is located off the laneway. Front loaded means the garage is located off the main street.