

PSM191027
 E: 495937.616
 N: 7003052.339
 RL: 8.767m

LEGEND:

- NEW SEWER MAIN
- EXISTING SEWER MAIN
- NEW HOUSE CONNECTION
- SEWER MAINTENANCE HOLE
- SEWER MAINTENANCE SHAFT U.N.O.
- SEWER EOL

NOTE:

- ALL SEWER MAINS DN160 PE100 CLASS SDR21 U.N.O.
- ALL MAINTENANCE HOLES (MH) 1200Ø CONCRETE INSITU U.N.O.
- ALL MAINTENANCE SHAFTS (MS) 600Ø SERVICESTREAM PE100

COORDINATE DATUM NOTE:

HORIZONTAL COORDINATES(E,N) SUPPLIED ARE MAPPING GRID OF AUSTRALIA(IMG), ZONE 56 BASED ON THE UNIVERSAL TRANSVERSE MERCATOR PROJECTION AND THE GEOCENTRIC DATUM OF AUSTRALIA 1994.
 HORIZONTAL DATUM DERIVED FROM PSM191027, E 495937.616, N 7003052.339.
 LEVELS SUPPLIED ARE ON THE AUSTRALIAN HEIGHT DATUM(AHD)
 LEVEL DATUM DERIVED FROM PSM191027 RL 8.767 (AHD)

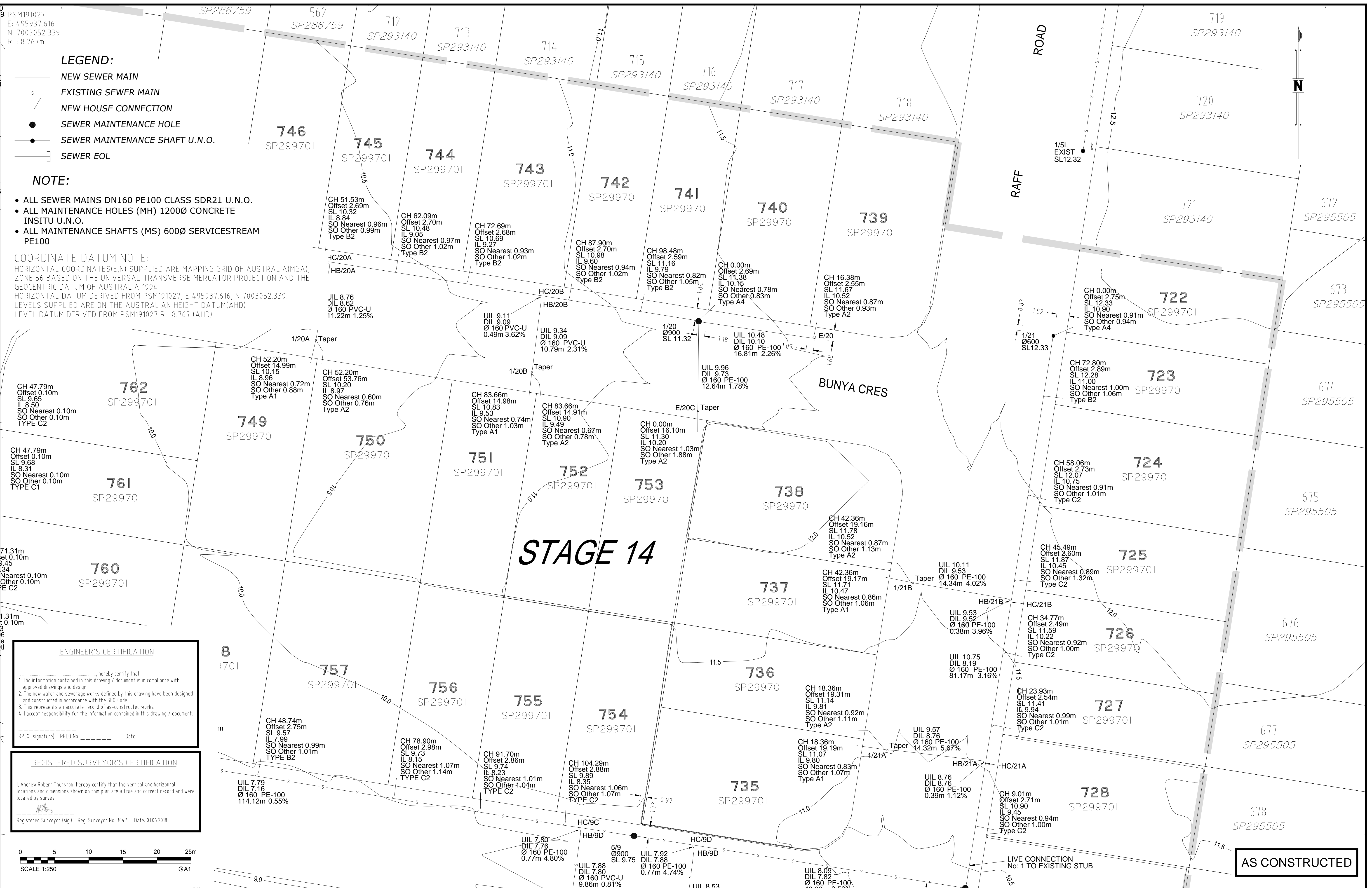

STAGE 14

AS CONSTRUCTED

ENGINEER'S CERTIFICATION
 I, _____, hereby certify that:
 1. The information contained in this drawing / document is in compliance with approved drawings and design.
 2. The new water and sewerage works defined by this drawing have been designed and constructed in accordance with the SEQ Code.
 3. This represents an accurate record of as-constructed works.
 4. I accept responsibility for the information contained in this drawing / document.
 RPEQ (signature) RPEQ No. _____ Date: _____

REGISTERED SURVEYOR'S CERTIFICATION
 I, Andrew Robert Thurston, hereby certify that the vertical and horizontal locations and dimensions shown on this plan are a true and correct record and were located by survey.

 Registered Surveyor (Sig) Reg. Surveyor No. 3047 Date: 01/06/2018

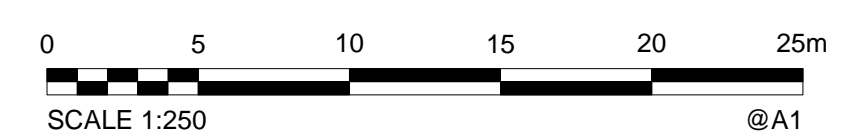

A1	0	01/06/2018	As Constructed	JTC	ADH	AT	PASSED	AT	01/06/2018
	INDEX	DATE	REVISIONS	DRAWN	CHECKED	PASSED	INITIALS	DATE	

WOLTER consulting group
 Planning Urban Design Landscape Environment Surveying
 Brisbane Level 2, 1 Breakfast Ck Road, Newstead, QLD 4006 Phone: (07) 3666 5200



Unitywater
 16-002636
 RIVERBANK - STAGE 14
 As-Constructed Sewer Reticulation
 DA/31030/2015/V3RL

SHEET 1 OF 3 SHEETS	SCALE 1:250
REVISION DATE 01/06/2018	REVISION 0
DISCIPLINE CODE C	
DRAWING NO. U-2018-0676	

PSM191027
 E: 495937.616
 N: 7003052.339
 RL: 8.767m

LEGEND:

- NEW SEWER MAIN
- EXISTING SEWER MAIN
- NEW HOUSE CONNECTION
- SEWER MAINTENANCE HOLE
- SEWER MAINTENANCE SHAFT U.N.O.
- SEWER EOL

NOTE:

- ALL SEWER MAINS DN160 PE100 CLASS SDR21 U.N.O.
- ALL MAINTENANCE HOLES (MH) 1200Ø CONCRETE INSITU U.N.O.
- ALL MAINTENANCE SHAFTS (MS) 600Ø SERVICESTREAM PE100

ENGINEER'S CERTIFICATION

I, _____, hereby certify that:
 1. The information contained in this drawing / document is in compliance with approved drawings and design.
 2. The new water and sewerage works defined by this drawing have been designed and constructed in accordance with the SED Code.
 3. This represents an accurate record of as-constructed works.
 4. I accept responsibility for the information contained in this drawing / document.

RPEQ (signature) RPEQ No. _____ Date: _____

REGISTERED SURVEYOR'S CERTIFICATION

I, Andrew Robert Thurston, hereby certify that the vertical and horizontal locations and dimensions shown on this plan are a true and correct record and were located by survey.

Registered Surveyor (sig) Reg. Surveyor No. 3047 Date: 01/06/2018

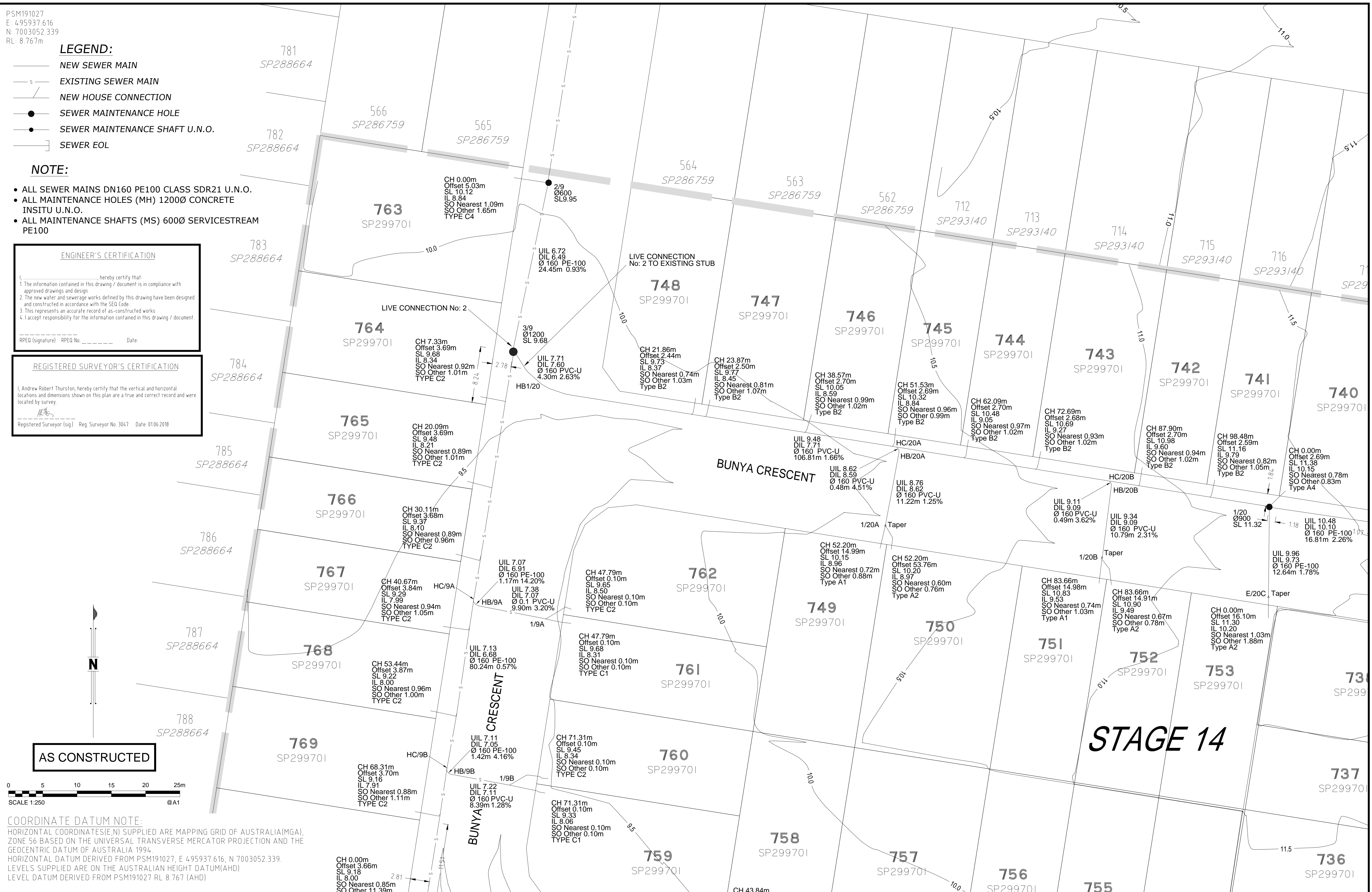

AS CONSTRUCTED

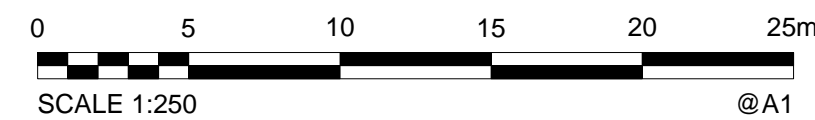

COORDINATE DATUM NOTE:

HORIZONTAL COORDINATES (E, N) SUPPLIED ARE MAPPING GRID OF AUSTRALIA (MGA), ZONE 56 BASED ON THE UNIVERSAL TRANSVERSE MERCATOR PROJECTION AND THE GEOCENTRIC DATUM OF AUSTRALIA 1994.
 HORIZONTAL DATUM DERIVED FROM PSM191027, E 495937.616, N 7003052.339.
 LEVELS SUPPLIED ARE ON THE AUSTRALIAN HEIGHT DATUM (AHD)
 LEVEL DATUM DERIVED FROM PSM191027 RL 8.767 (AHD)

A1	0	01/06/2018	As Constructed	JTC	ADH	AT	PASSED	AT	01/06/2018
	INDEX	DATE	REVISIONS	DRAWN	CHECKED	PASSED	INITIALS	DATE	

DRAWN	JTC	01/06/2018
CHECKED	ADH	01/06/2018
PASSED	AT	01/06/2018









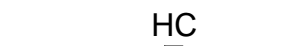

Unitywater

16-002636
 RIVERBANK - STAGE 14
 As-Constructed Sewer Reticulation
 DA/31030/2015/V3RL

SHEET 3 OF 3 SHEETS	SCALE 1:250
REVISION DATE 01/06/2018	REVISION 0
DISCIPLINE CODE C	
DRAWING NO. U-2018-0676	

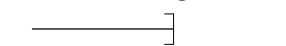
PSM191027
 E: 495937.616
 N: 7003052.339
 RL: 8.767m

LEGEND:

-  NEW Ø100 PVC-U CLASS PN16 WATERMAIN
-  NEW READY TAP HOUSE CONNECTION
-  NEW HYDRANT
-  NEW SLUICE VALVE
-  NEW END CAP
-  NEW WATER SERVICE CONDUIT 100Ø PVC-O
-  EXISTING WATER MAIN
-  NEW WATER SERVICE CONNECTION 20mm MANUFACTURER - ELSTER
-  DICL WATERMAIN

COORDINATE DATUM NOTE:
 HORIZONTAL COORDINATES(E,N) SUPPLIED ARE MAPPING GRID OF AUSTRALIA(MGA), ZONE 56 BASED ON THE UNIVERSAL TRANSVERSE MERCATOR PROJECTION AND THE GEOCENTRIC DATUM OF AUSTRALIA 1994.
 HORIZONTAL DATUM DERIVED FROM PSM191027, E 495937.616, N 7003052.339.
 LEVELS SUPPLIED ARE ON THE AUSTRALIAN HEIGHT DATUM(AHD)
 LEVEL DATUM DERIVED FROM PSM191027 RL 8.767 (AHD)

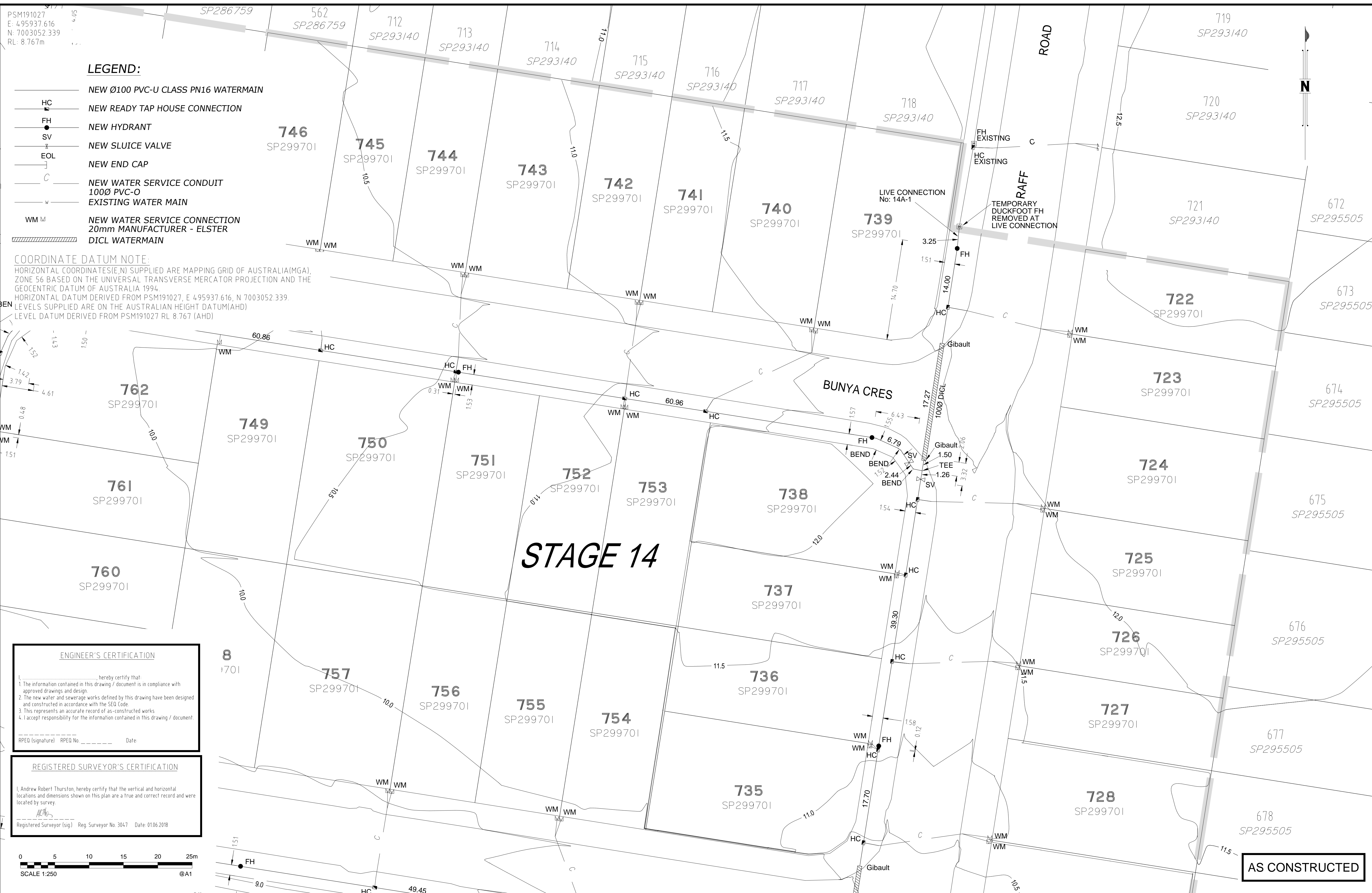

STAGE 14

ENGINEER'S CERTIFICATION
 I, _____, hereby certify that:
 1. The information contained in this drawing / document is in compliance with approved drawings and design.
 2. The new water and sewerage works defined by this drawing have been designed and constructed in accordance with the SEQ Code.
 3. This represents an accurate record of as-constructed works.
 4. I accept responsibility for the information contained in this drawing / document.
 RPEQ (signature) RPEQ No. _____ Date: _____

REGISTERED SURVEYOR'S CERTIFICATION
 I, Andrew Robert Thurston, hereby certify that the vertical and horizontal locations and dimensions shown on this plan are a true and correct record and were located by survey.
 Registered Surveyor (Sig) Reg. Surveyor No. 3047 Date: 01/06/2018

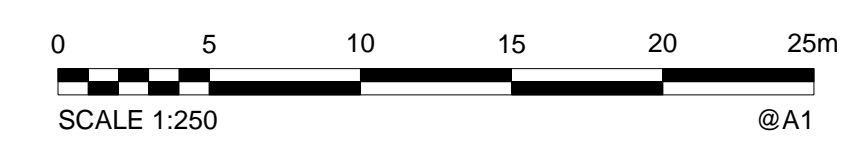

AS CONSTRUCTED

A1	0	01/06/2018	As Constructed	JTC	ADH	AT
	INDEX	DATE	REVISIONS	DRAWN	CHECKED	PASSED

DRAWN	JTC	01/06/2018
CHECKED	ADH	01/06/2018
PASSED	AT	01/06/2018
INITIALS	DATE	

WOLTER consulting group
 Planning Urban Design Landscape Environment Surveying
 Brisbane, Level 2, 1 Breakfast Ck Road, Newstead, QLD 4006 Phone: (07) 3666 5200



Unitywater
 16-002636
 RIVERBANK - STAGE 14
 As-Constructed Water Reticulation
 DA/31030/2015/V3RL

SHEET 1 OF 4 SHEETS	SCALE 1:250
REVISION DATE 01/06/2018	REVISION 0
DISCIPLINE CODE C	
DRAWING NO. U-2018-0676	

PSM191027
 E: 495937.616
 N: 7003052.339
 RL: 8.767m

STAGE 14



- LEGEND:**
- NEW Ø100 PVC-U CLASS PN16 WATERMAIN
 - NEW READY TAP HOUSE CONNECTION
 - NEW HYDRANT
 - NEW SLUICE VALVE
 - NEW END CAP
 - NEW WATER SERVICE CONDUIT 100Ø PVC-O
 - EXISTING WATER MAIN
 - NEW WATER SERVICE CONNECTION 20mm MANUFACTURER - ELSTER
 - DICL WATERMAIN

COORDINATE DATUM NOTE:
 HORIZONTAL COORDINATES (E, N) SUPPLIED ARE MAPPING GRID OF AUSTRALIA (MGA), ZONE 56 BASED ON THE UNIVERSAL TRANSVERSE MERCATOR PROJECTION AND THE GEOCENTRIC DATUM OF AUSTRALIA 1994.
 HORIZONTAL DATUM DERIVED FROM PSM191027, E 495937.616, N 7003052.339.
 LEVELS SUPPLIED ARE ON THE AUSTRALIAN HEIGHT DATUM (AHD)
 LEVEL DATUM DERIVED FROM PSM191027 RL 8.767 (AHD)

ENGINEER'S CERTIFICATION

I, _____, hereby certify that:
 1. The information contained in this drawing / document is in compliance with approved drawings and design.
 2. The new water and sewerage works defined by this drawing have been designed and constructed in accordance with the SED Code.
 3. This represents an accurate record of as-constructed works
 4. I accept responsibility for the information contained in this drawing / document.

RPEQ (Signature) RPEQ No. _____ Date: _____

REGISTERED SURVEYOR'S CERTIFICATION

I, Andrew Robert Thurston, hereby certify that the vertical and horizontal locations and dimensions shown on this plan are a true and correct record and were located by survey.

Registered Surveyor (sig) Reg. Surveyor No. 3047 Date: 01/06/2018



AS CONSTRUCTED

A1	0	01/06/2018	As Constructed	JTC	ADH	AT	DRAWN	CHECKED	PASSED
	INDEX	DATE	REVISIONS	DRAWN	CHECKED	PASSED	INITIALS	DATE	

WOLTER consulting group

Planning Urban Design Landscape Environment Surveying

Brisbane: Level 2, 1 Breakfast Ck Road, Newstead, QLD 4006 Phone: (07) 3666 5200



Unitywater

16-002636
 RIVERBANK - STAGE 14
 As-Constructed Water Reticulation
 DA/31030/2015/V3RL

SHEET 2 OF 4 SHEETS	SCALE 1:250
REVISION DATE 01/06/2018	REVISION 0
DISCIPLINE CODE C	
DRAWING NO. U-2018-0676	

PSM191027
 E: 495937.616
 N: 7003052.339
 RL: 8.767m

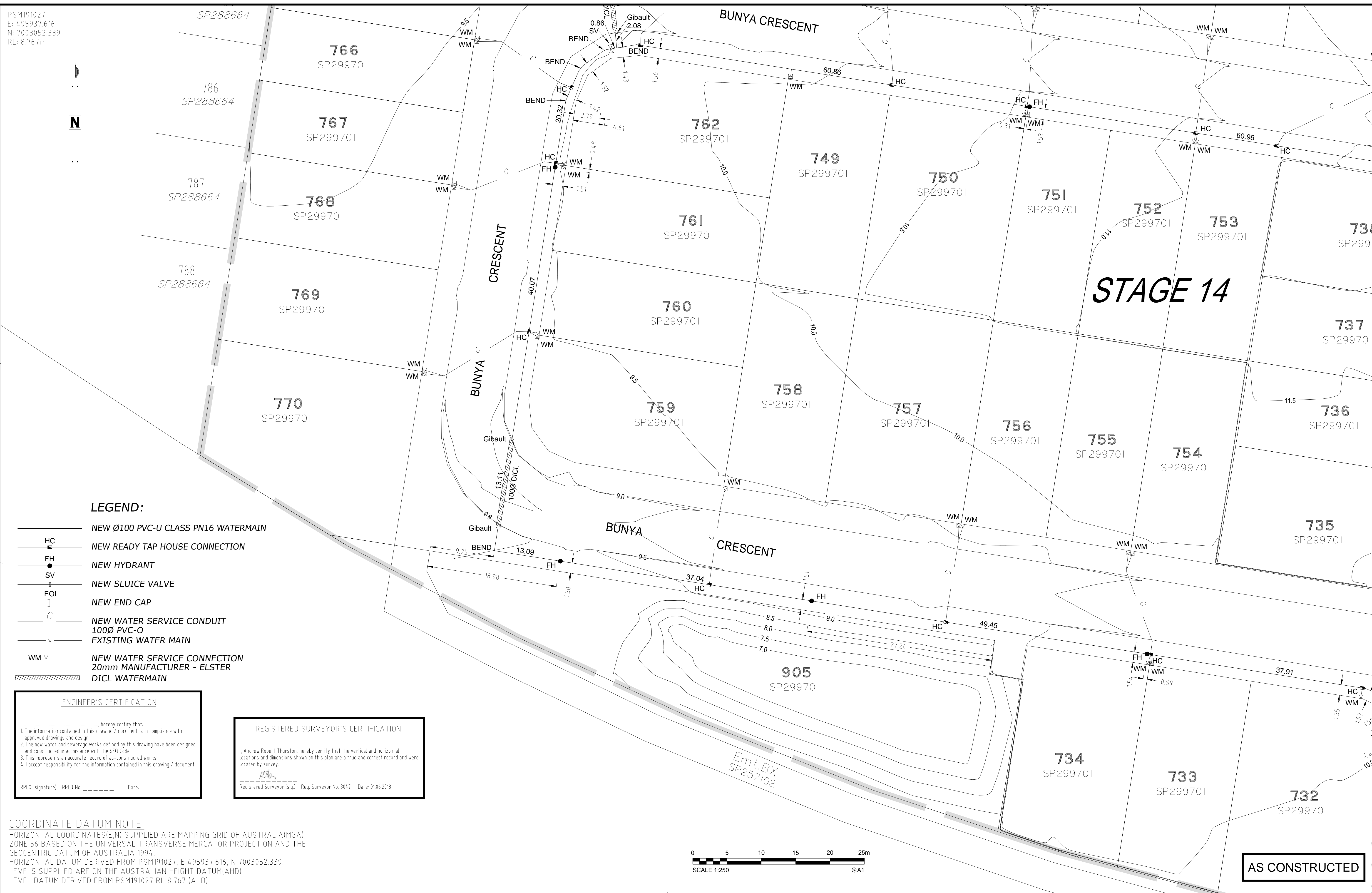

LEGEND:

- NEW Ø100 PVC-U CLASS PN16 WATERMAIN
- NEW READY TAP HOUSE CONNECTION
- NEW HYDRANT
- NEW SLUICE VALVE
- NEW END CAP
- NEW WATER SERVICE CONDUIT
100Ø PVC-O
- EXISTING WATER MAIN
- NEW WATER SERVICE CONNECTION
20mm MANUFACTURER - ELSTER
- DICL WATERMAIN

ENGINEER'S CERTIFICATION

I, _____ hereby certify that:
 1. The information contained in this drawing / document is in compliance with approved drawings and design.
 2. The new water and sewerage works defined by this drawing have been designed and constructed in accordance with the SEQ Code.
 3. This represents an accurate record of as-constructed works.
 4. I accept responsibility for the information contained in this drawing / document.

RPEQ (signature) RPEQ No. _____ Date: _____

REGISTERED SURVEYOR'S CERTIFICATION

I, Andrew Robert Thurston, hereby certify that the vertical and horizontal locations and dimensions shown on this plan are a true and correct record and were located by survey.

Registered Surveyor (sig) Reg. Surveyor No. 3047 Date: 01/06/2018

COORDINATE DATUM NOTE:
 HORIZONTAL COORDINATES (E, N) SUPPLIED ARE MAPPING GRID OF AUSTRALIA (MGA), ZONE 56 BASED ON THE UNIVERSAL TRANSVERSE MERCATOR PROJECTION AND THE GEOCENTRIC DATUM OF AUSTRALIA 1994.
 HORIZONTAL DATUM DERIVED FROM PSM191027, E 495937.616, N 7003052.339.
 LEVELS SUPPLIED ARE ON THE AUSTRALIAN HEIGHT DATUM (AHD)
 LEVEL DATUM DERIVED FROM PSM191027 RL 8.767 (AHD)

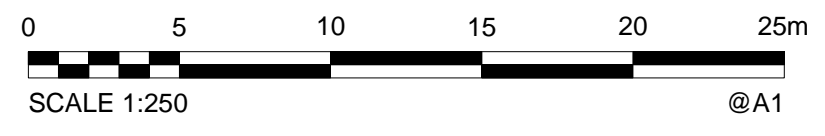

AS CONSTRUCTED

A1	0	01/06/2018	As Constructed	JTC	ADH	AT	DRAWN	CHECKED	PASSED	INITIALS	DATE
	0	01/06/2018	As Constructed	JTC	ADH	AT	DRAWN	CHECKED	PASSED	INITIALS	DATE

WOLTER
consulting group

Planning Urban Design Landscape Environment Surveying

Brisbane: Level 2, 1 Breakfast Ck Road, Newstead, QLD 4006 Phone: (07) 3666 5200









Unitywater

16-002636
 RIVERBANK - STAGE 14
 As-Constructed Water Reticulation
 DA/31030/2015/V3RL

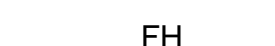
SHEET 3 OF 4 SHEETS	SCALE 1:250
REVISION DATE 01/06/2018	REVISION 0
DISCIPLINE CODE C	
DRAWING NO. U-2018-0676	

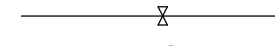
PSM191027
 E: 4.95937.616
 N: 7003052.339
 RL: 8.767m

LEGEND:

-  NEW Ø100 PVC-U CLASS PN16 WATERMAIN
-  NEW READY TAP HOUSE CONNECTION
-  NEW HYDRANT
-  NEW SLUICE VALVE
-  NEW END CAP
-  NEW WATER SERVICE CONDUIT 100Ø PVC-O
-  EXISTING WATER MAIN
-  NEW WATER SERVICE CONNECTION 20mm MANUFACTURER - ELSTER
-  DI CL WATERMAIN

ENGINEER'S CERTIFICATION

I, _____, hereby certify that:

- The information contained in this drawing / document is in compliance with approved drawings and design.
- The new water and sewerage works defined by this drawing have been designed and constructed in accordance with the SED Code.
- This represents an accurate record of as-constructed works.
- I accept responsibility for the information contained in this drawing / document.

RPEQ (signature) RPEQ No. _____ Date: _____

REGISTERED SURVEYOR'S CERTIFICATION

I, Andrew Robert Thurston, hereby certify that the vertical and horizontal locations and dimensions shown on this plan are a true and correct record and were located by survey.

AT

Registered Surveyor (sig) Reg. Surveyor No. 3047 Date: 01/06/2018

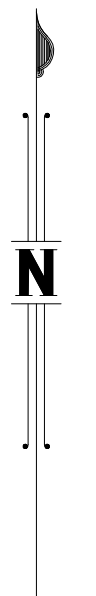

AS CONSTRUCTED

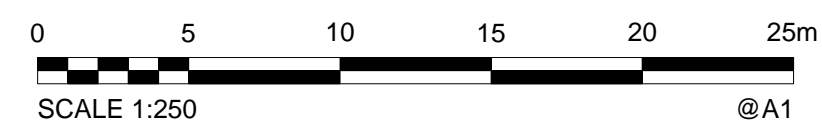

COORDINATE DATUM NOTE:
 HORIZONTAL COORDINATES (E, N) SUPPLIED ARE MAPPING GRID OF AUSTRALIA (MGA), ZONE 56 BASED ON THE UNIVERSAL TRANSVERSE MERCATOR PROJECTION AND THE GEOCENTRIC DATUM OF AUSTRALIA 1994.
 HORIZONTAL DATUM DERIVED FROM PSM191027, E 4.95937.616, N 7003052.339.
 LEVELS SUPPLIED ARE ON THE AUSTRALIAN HEIGHT DATUM (AHD)
 LEVEL DATUM DERIVED FROM PSM191027 RL 8.767 (AHD)

A1	0	01/06/2018	As Constructed	JTC	ADH	AT
	INDEX	DATE	REVISIONS	DRAWN	CHECKED	PASSED

DRAWN	JTC	01/06/2018
CHECKED	ADH	01/06/2018
PASSED	AT	01/06/2018
INITIALS	DATE	

WOLTER consulting group

Planning Urban Design Landscape Environment Surveying

Brisbane: Level 2, 1 Breakfast Ck Road, Newstead, QLD 4006 Phone: (07) 3666 5200



Unitywater

16-002636
 RIVERBANK - STAGE 14
 As-Constructed Water Reticulation
 DA/31030/2015/V3RL

SHEET 4 OF 4 SHEETS	SCALE 1:250
REVISION DATE 01/06/2018	REVISION 0
DISCIPLINE CODE C	
DRAWING NO. U-2018-0676	

ENGINEER'S CERTIFICATION
 I, _____ hereby certify that:
 1. The information contained in this drawing / document is in compliance with approved drawings and design.
 2. The new drainage and transport works defined by this drawing have been designed and constructed in accordance with Council Standards.
 3. This represents an accurate record of as-constructed works.
 4. I accept responsibility for the information contained in this drawing / document.

RPEQ (signature) RPEQ No. _____ Date: _____

REGISTERED SURVEYOR'S CERTIFICATION
 I, Andrew Robert Thurston (Cad. Surv.), hereby certify that the vertical and horizontal locations and dimensions shown on this plan are a true and correct record and were located by survey.

Registered Surveyor (sig.) Reg. Surveyor No. 3047 Date: 12/07/2018

- LEGEND:**
- NEW STORMWATER LINE
 - TOP OF BANK
 - BOTTOM OF BANK
 - CONTOURS
 - SW — EXISTING STORMWATER LINE
 - NEW STORMWATER MANHOLE
 - ≡ NEW STORMWATER GULLY PIT
 - NEW RETAINING WALL
 - - - NEW RETAINING WALL AND ACOUSTIC BARRIER

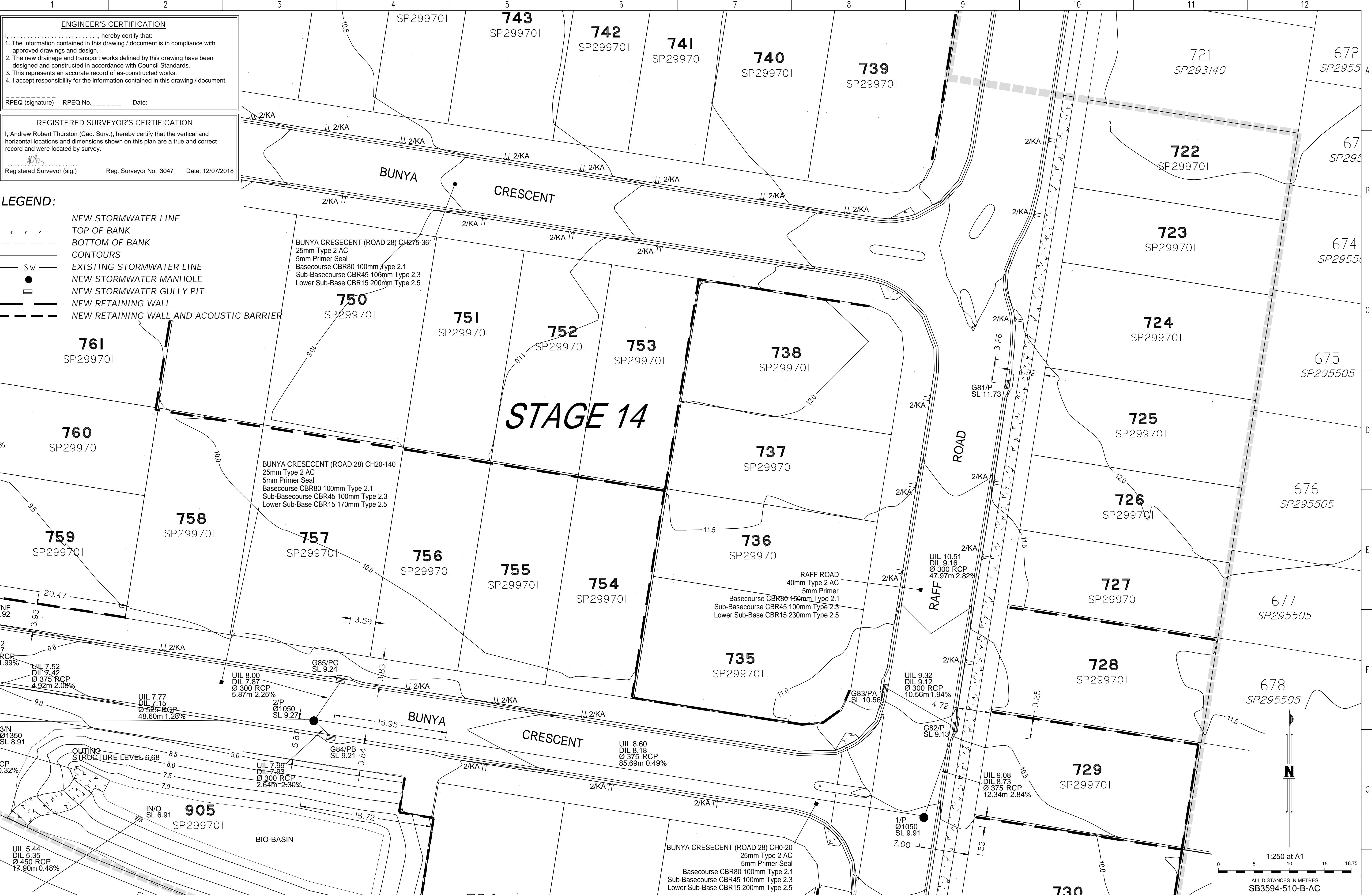

DRAWING REVISIONS		REFERENCE DRAWINGS		DESIGN FILE No.		DESIGNED	
REV.	REVISION DESCRIPTION	DRG. No.	DESCRIPTION	CONSTRUCT. No.	DATE	DATE	DATE
A	AS CONSTRUCTED					12.07.2018	J Braga
B	AS CONSTRUCTED - AMENDED					12.07.2018	A Dahn-Harvey

THIS WORK WAS PREPARED BY:

WOLTER consulting group

Planning Urban Design Landscape Environment Surveying

190 Stone Lane St 1 Brisbane QLD 4000 Phone: (07) 3468 5000

SCALE 1:250 ORIGINAL SIZE A1

MORETON BAY REGIONAL COUNCIL
 CABOOLTURE DISTRICT OFFICE
 2 HASKING STREET CABOOLTURE QLD 4510
 PO BOX 159 CABOOLTURE QLD 4510
 Telephone: (07) 5433 0100
 Fax: (07) 5433 4000

RIVERBANK ESTATE
STAGE 14
AS CONSTRUCTED
ROADS AND DRAINAGE

CSC SUBDIVISION REFERENCE
 DA/31030/2015/V3RL

No. 1 OF 4 PLANS
 ASCON GRID NUMBER REV.
 B

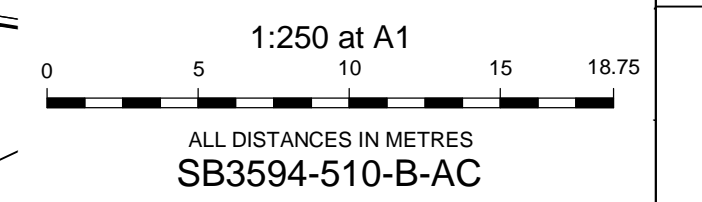

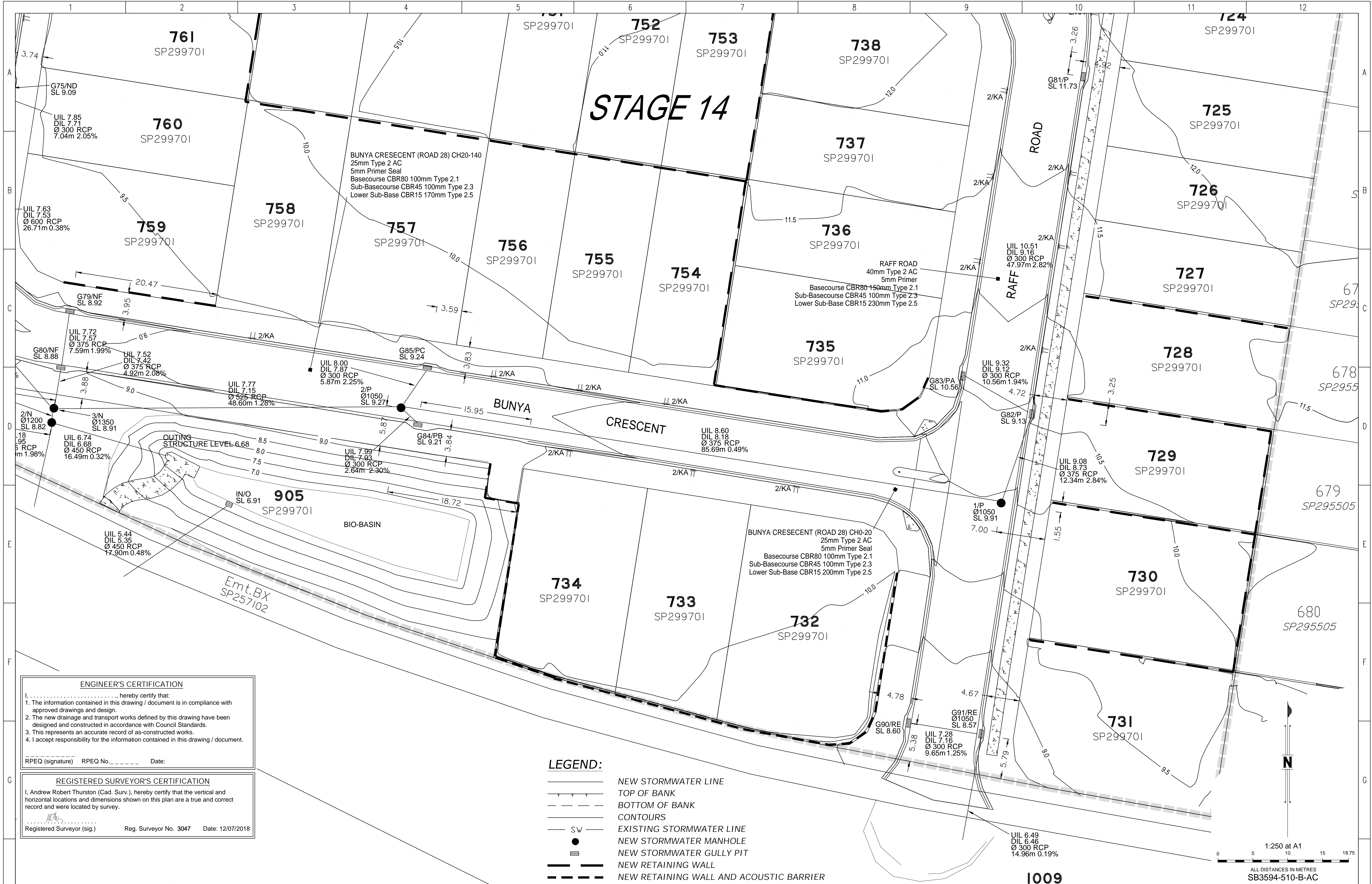

ENGINEER'S CERTIFICATION
 I, _____ hereby certify that:
 1. The information contained in this drawing / document is in compliance with approved drawings and design.
 2. The new drainage and transport works defined by this drawing have been designed and constructed in accordance with Council Standards.
 3. This represents an accurate record of as-constructed works.
 4. I accept responsibility for the information contained in this drawing / document.
 RPEQ (signature) RPEQ No. _____ Date: _____

REGISTERED SURVEYOR'S CERTIFICATION
 I, Andrew Robert Thurston (Cad. Surv.), hereby certify that the vertical and horizontal locations and dimensions shown on this plan are a true and correct record and were located by survey.
 Registered Surveyor (sig) Reg. Surveyor No. 3047 Date: 12/07/2018

- LEGEND:**
- NEW STORMWATER LINE
 - TOP OF BANK
 - BOTTOM OF BANK
 - CONTOURS
 - SW — EXISTING STORMWATER LINE
 - NEW STORMWATER MANHOLE
 - NEW STORMWATER GULLY PIT
 - NEW RETAINING WALL
 - NEW RETAINING WALL AND ACOUSTIC BARRIER

DRAWING REVISIONS		REFERENCE DRAWINGS		DESIGN FILE No.	DESIGNED
REV.	REVISION DESCRIPTION	DRG. No.	DESCRIPTION	CONSTRUCT. No.	DATE
A	AS CONSTRUCTED				J Braga
B	AS CONSTRUCTED - AMENDED				12.07.2018
				FIELD BOOK	CHECKED A Dahn-Harvey
				LOG BOOK	DATE 12.07.2018
				LEVEL DATUM	Lev. datum
				DATUM	Datum

THIS WORK WAS PREPARED BY:

 WOLTER consulting group
 1/100 The Esplanade, Brisbane, QLD 4000
 Telephone: (07) 3433 0100 Fax: (07) 3433 4000

SCALE 1:250 ORIGINAL SIZE A1

MORETON BAY REGIONAL COUNCIL
 CABOOLTURE DISTRICT OFFICE
 2 HASKING STREET CABOOLTURE QLD 4510
 PO BOX 159 CABOOLTURE QLD 4510
 Telephone: (07) 5433 0100 Fax: (07) 5433 4000

RIVERBANK ESTATE
 STAGE 14
 AS CONSTRUCTED
 ROADS AND DRAINAGE

ALL DISTANCES IN METRES
 SB3594-510-B-AC

CSC SUBDIVISION REFERENCE	
DA/31030/2015/V3RL	
No. 2 OF 4 PLANS	
ASCAN GRID NUMBER	REV.
	B

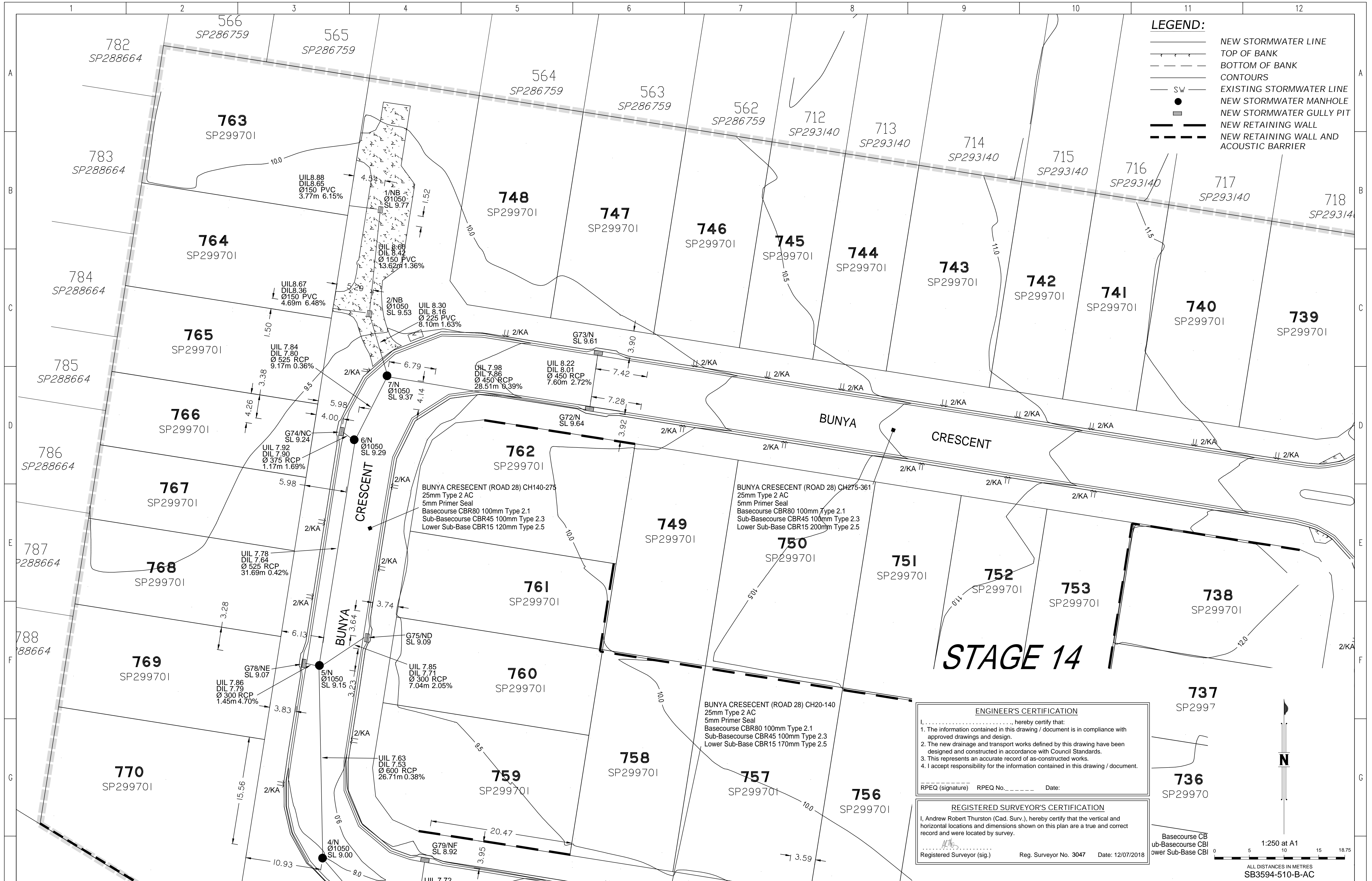

- LEGEND:**
- NEW STORMWATER LINE
 - TOP OF BANK
 - BOTTOM OF BANK
 - - - CONTOURS
 - SW — EXISTING STORMWATER LINE
 - NEW STORMWATER MANHOLE
 - ≡ NEW STORMWATER GULLY PIT
 - NEW RETAINING WALL
 - - - NEW RETAINING WALL AND ACOUSTIC BARRIER

ENGINEER'S CERTIFICATION

I, _____, hereby certify that:

- The information contained in this drawing / document is in compliance with approved drawings and design.
- The new drainage and transport works defined by this drawing have been designed and constructed in accordance with Council Standards.
- This represents an accurate record of as-constructed works.
- I accept responsibility for the information contained in this drawing / document.

RPEQ (signature) RPEQ No. _____ Date: _____

REGISTERED SURVEYOR'S CERTIFICATION

I, Andrew Robert Thurston (Cad. Surv.), hereby certify that the vertical and horizontal locations and dimensions shown on this plan are a true and correct record and were located by survey.

Registered Surveyor (sig.) Reg. Surveyor No. 3047 Date: 12/07/2018

Basecourse CB
ub-Basecourse CBI
ower Sub-Base CBI

1:250 at A1

ALL DISTANCES IN METRES
SB3594-510-B-AC

DRAWING REVISIONS		REFERENCE DRAWINGS		DESIGN FILE No.		DESIGNED	
REV.	REVISION DESCRIPTION	DRG. No.	DESCRIPTION	CONSTRUCT. No.	DATE	DATE	
A	AS CONSTRUCTED				12.07.2018		J Braga
B	AS CONSTRUCTED - AMENDED				12.07.2018		A Dahn-Harvey
					12.07.2018		

THIS WORK WAS PREPARED BY:

WOLTER
consulting group

Moreton Bay Regional Council

SCALE 1:250 ORIGINAL SIZE A1

MORETON BAY REGIONAL COUNCIL
CABOOLTURE DISTRICT OFFICE
2 HASKING STREET CABOOLTURE QLD 4510
PO BOX 159 CABOOLTURE QLD 4510
Telephone: (07) 5433 0100
Fax: (07) 5433 4000

RIVERBANK ESTATE
STAGE 14
AS CONSTRUCTED
ROADS AND DRAINAGE

CSC SUBDIVISION REFERENCE	
DA/31030/2015/V3RL	
No. 4 OF 4 PLANS	
ASCAN GRID NUMBER	REV.
	B