

Land Title Act 1994 ; Land Act 1994
Form 21 Version 4

SURVEY PLAN

Sheet **1** of **2**

PERMANENT MARKS

PM	ORIGIN	BEARING	DIST	NO	TYPE
7-OPM (New Conn)	21/1S278514	322°44'	42.821	191027	

REFERENCE MARKS

STN	TO	ORIGIN	BEARING	DIST
4	O.Screw in Kerb	12/1S275082	283°38'30"	4.884
5	O.Screw in Kerb (New Conn)	15/1S275082	287°18'	22.208
7	O.Screw in Kerb	9/1S275082	230°42'30"	8.607

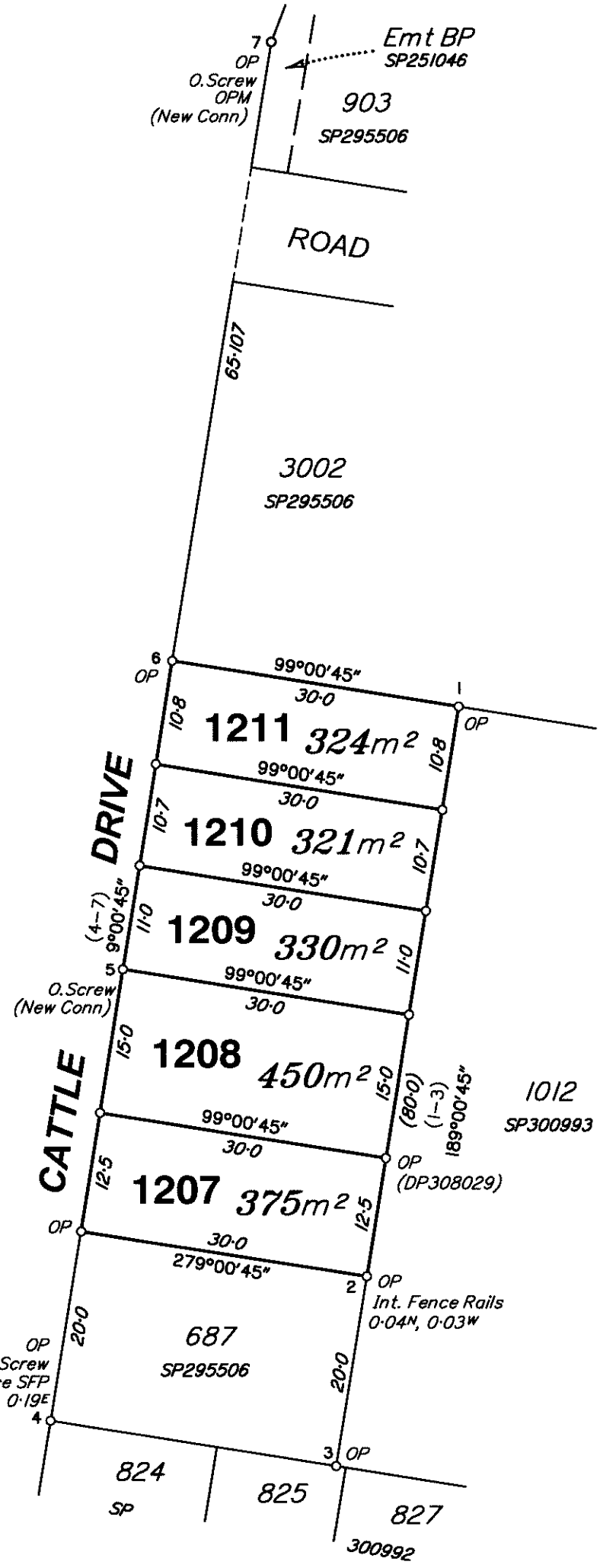

Reinstatement Report

This is a staged development. Stage boundaries have been reinstated from existing monuments from underlying and adjoining survey plans. Subject dimensions agree with previous surveys within established survey accuracies.

The reinstatement of the subject boundaries directly follows the precedent established by SP295506.

Peg placed at all new corners, unless otherwise stated.

Scale 1:600 - Lengths are in Metres.

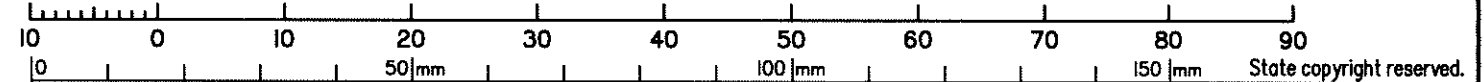

Wolter Consulting Group Pty Ltd (ACN 147 343 084) hereby certify that the land comprised in this plan was surveyed by the corporation, by Angela Margaret DÄHN-HARVEY, Surveying Graduate for whose work the corporation accepts responsibility, under the supervision of Andrew Robert THURSTON, Cadastral Surveyor and that the plan is accurate, that the said survey was performed in accordance with the Survey and Mapping Infrastructure Act 2003 and Surveyors Act 2003 and associated Regulations and Standards and that the said survey was completed on 15-03-2019.

Authorised Delegate

21-03-2019
Date

Plan of Lots 1207-1211

Cancelling Lots 684 to 686 on SP295506

LOCAL MORETON BAY
GOVERNMENT: REGIONAL

LOCALITY: CABOOLTURE SOUTH

Meridian: MGA Zone 56 vide SP295506

Survey Records: No

Scale: **1:600**
Format: **STANDARD**

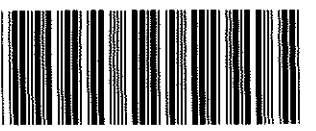

SP308016

719434304

BE 400 NT

\$864.00
30/05/2019 15:19

WARNING : Folded or Mutilated Plans will not be accepted.
Plans may be rolled.
Information may not be placed in the outer margins.

5. Lodged by
HWL Ebsworth Lawyers
Level 19, 480 Queen Street,
Brisbane Q 4000
GPO Box 2033, Brisbane Q 4001
Ph: (07) 3169 4700 Fax: 1300 368 717
REF: JDW - MKF = 43175
(Include address, phone number, reference, and Lodger Code)

Lodger Code
88A

(8223036)

1. Certificate of Registered Owners or Lessees.

+/We **PEET CABOOLTURE SYNDICATE LIMITED**
ACN 103 038 688

(Names in full)

* as Registered Owners of this land agree to this plan and dedicate the Public Use Land as shown hereon in accordance with Section 50 of the Land Title Act 1994.

* as Lessees of this land agree to this plan.

Jonathan Lawson (Jonathan Lawson)
Signature of *Registered Owners *Lessees

of Peet Limited ← Peet Caboolture Syndicate Limited ACN 103 038 688 by its duly authorised attorney *Jonathan Lawson* - Senior Development Manager - Level 2 Attorney - under Power of Attorney No. 713650742 and who has received no notice of revocation of that attorney and who warrants that they have the requisite power under that attorney.

Michael Stone

Peet Caboolture Syndicate Limited ACN 103 038 688 by its duly authorised attorney *Michael Stone* - General Manager - Developments (equivalent to State Operations Manager) - Level 1 Attorney - under Power of Attorney No. 713650742 and who has received no notice of revocation of that attorney and who warrants that they have the requisite power under that attorney. → of Peet Limited

* Rule out whichever is inapplicable

2. Planning Body Approval.

* *Moreton Bay Regional Council*
hereby approves this plan in accordance with the:
% *Planning Act 2016*

Dated this *28th* day of *May* *2019*

Greg Potter # Delegated Officer
Greg Potter
Team Leader Planning

* Insert the name of the Planning Body.

Insert designation of signatory or delegation

% Insert applicable approving legislation.

3. Plans with Community Management Statement :

CMS Number :

Name :

4. References :

Dept File :

Local Govt : *DA/360572018/0511*

Surveyor : *SB3594/23*

6. Existing		Created		
Title Reference	Description	New Lots	Road	Secondary Interests
51124538	Lot 684 on SP295506	1210 & 1211	---	---
51124539	Lot 685 on SP295506	1208 - 1210	---	---
51124540	Lot 686 on SP295506	1207 & 1208	---	---

EXISTING ADMINISTRATIVE ADVISE ALLOCATIONS

Administrative Advice	Lots to be Encumbered
709669863	1207-1211

1207-1211	Por 2
Lots	Orig

7. Orig Grant Allocation :

8. Passed & Endorsed :

By : **Wolter Consulting Group Pty Ltd**

Date : *21-03-2019*

Signed : *[Signature]*

Designation : **Liaison Officer**

9. Building Format Plans only.

I certify that :

* As far as it is practical to determine, no part of the building shown on this plan encroaches onto adjoining lots or road;

* Part of the building shown on this plan encroaches onto adjoining * lots and road

Cadastral Surveyor/Director* Date

* delete words not required

10. Lodgement Fees :

Survey Deposit	\$
Lodgement	\$
..... New Titles	\$
Photocopy	\$
Postage	\$
TOTAL	\$

11. Insert Plan Number

SP308016