

NOTES

This plan was prepared as a provisional layout to accompany a development application. The information on this plan is not suitable for any other purpose.

Property dimensions, areas, numbers of lots and contours and other physical features shown have been compiled from existing information and may not have been verified by field survey. These may need verification if the development application is approved and development proceeds, and may change when a full survey is undertaken or in order to comply with development approval conditions. No reliance should be placed on the information on this plan for detailed subdivision design or for any financial dealings involving the land.

The Saunders Havill Group therefore disclaims any liability for any loss or damage whatsoever or howsoever incurred, arising from any party using or relying upon this plan for any purpose other than as a document prepared for the sole purpose of accompanying a development application and which may be subject to alteration beyond the control of the Saunders Havill Group. Unless a development approval states otherwise, this is not an approved plan.

* This note is an integral part of this plan/data. Reproduction of this plan or any part of it without this note being included in full will render the information shown on such reproduction invalid and not suitable for use.

- 2000m² - < 2500m²
- 2500m² - < 3000m²
- 3000m² - < 3500m²
- 3500m² - < 4000m²
- > 4000m²
- Open Space
- Q2 Floodline
- Q20 Floodline
- Q100 Floodline
- Buffer Areas
- Sub-Stage Boundary

STATISTICS - STAGE 15 OVERALL

| | |
|---------------------------|----------|
| No of Proposed Lots | 73 |
| Length New Road | 2260 m |
| Total Area Parks | 12.91 ha |
| Total Area New Road | 4.363 ha |
| Area of Stage | 28.62 ha |

STATISTICS - STAGE 15A

| | |
|---------------------------|----------|
| No of Proposed Lots | 28 |
| Length New Road | 720 m |
| Total Area Parks | Nil |
| Total Area New Road | 1.412 ha |
| Area of Stage | 10.65 ha |

STATISTICS - STAGE 15B

| | |
|---------------------------|----------------------|
| No of Proposed Lots | 24 |
| Length New Road | 760 m |
| Total Area Parks | Nil |
| Total Area New Road | 1.321 m ² |
| Area of Stage | 7.306ha |

STATISTICS - STAGE 15C

| | |
|---------------------------|-----------|
| No of Proposed Lots | 21 |
| Length New Road | 780 m |
| Total Area Parks | 12.91 ha |
| Total Area New Road | 1.63 ha |
| Area of Stage | 10.667 ha |

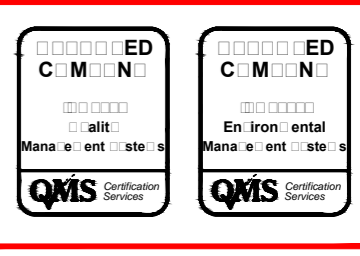
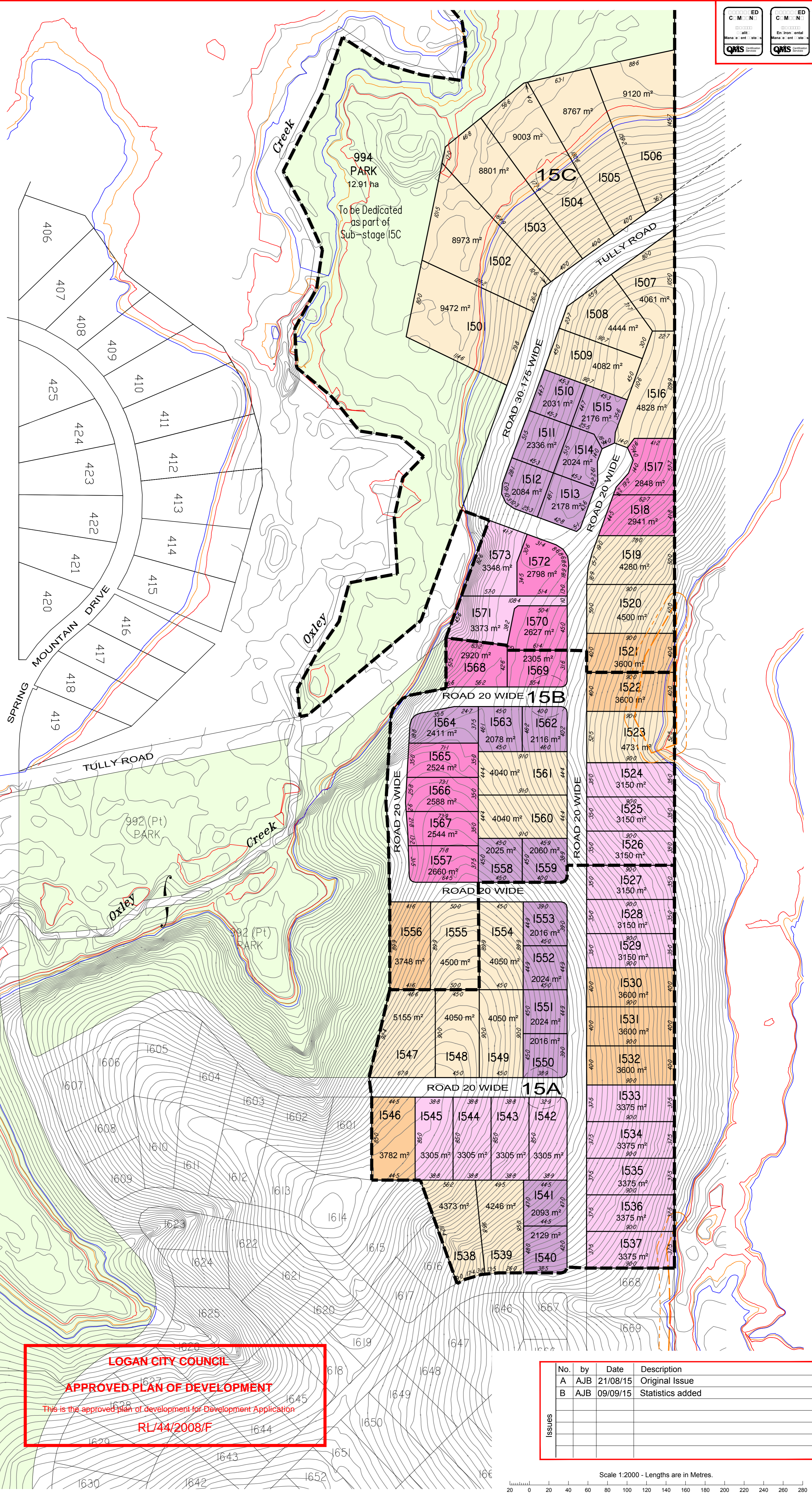

| No. | by | Date | Description |
|-----|-----|----------|------------------|
| A | AJB | 21/08/15 | Original Issue |
| B | AJB | 09/09/15 | Statistics added |

Scale 1:2000 - Lengths are in Metres.

saunders havill group
 Saunders Havill Group Pty Ltd ABN 24 144 972 949
 Brisbane • Emerald • Gladstone
 head office 9 Thompson St Bowen Hills Q 4006
 phone 1300 123 SHG web www.saundershavill.com
 ■ surveying ■ town planning ■ urban design ■ environmental management ■ landscape architecture

Plan of **SUB-STAGING PLAN STAGE 15**
 Project **SPRING MOUNTAIN ESTATE - GREENBANK**
 Client **MTAA Superannuation Fund (Flagstone Creek and Spring Mountain Park) Property Pty Ltd**

town planning
 Scale @A1 1:2000
 @A3 1:4000
 Dwg No. **7081 P 04 PP B**