

13th January 2023

Reference No. SMS1.22205-L24.Rev0

Mr Michael Engelaar
LR&M Construction Pty Ltd
6 Roseworthy Road
ROSEWORTHY SA 5371

LOT 142 BROUGHAM CIRCUIT – BLUESTONE LAND DIVISION STAGE 5C1, MT BARKER

Dear Michael,

SMS Geotechnical Pty Ltd (SMS) was commissioned by LR&M Construction Pty Ltd (LR&M) to provide Level 1 earthworks inspection and testing services during fill placement on Lot 142 Brougham Circuit on the above project in Mt Barker, South Australia. The area where fill was placed is shown approximately in Drawing SMS1.22205-F24.Rev0.

SMS were provided with a TBM by LR&M which was used to measure and record both pre and post fill levels. Post fill levels were taken prior to the placement of topsoil. The post fill levels were measured at approximately the same locations as the pre fill levels. These levels are detailed in Drawing SMS1.22205-F24.Rev0.

Whilst the utmost amount of care was taken while measuring these levels, SMS is not a licensed surveyor and the difference in measurements on Drawing SMS1.22205-F24.Rev0 may differ slightly to the maximum depth of placed fill on this site.

Level 1 inspection and testing services were carried out by SMS to Australian Standard AS3798-2007 "Guidelines on earthworks for commercial and residential developments" between 31st March 2022 and 10th January 2023. The subgrade was inspected and showed no signs of organic or unsuitable material. Subgrade proof rolling was witnessed prior to fill being placed and was deemed suitable by SMS' representative on site.

SMS conducted in situ density testing to AS1289.5.8.1 at randomly selected locations throughout areas in which fill was placed as per frequencies outlined in AS3798-2007. The density test results have been issued separately to LR&M and are retained in our project file. The required laboratory dry density ratio was achieved on all tests taken during fill placement. Laboratory tests were conducted to AS1289.5.1.1.

On the completion of Level 1 earthworks inspection and testing, SMS advise that the fill placed on Lot 142 Brougham Circuit as shown in Drawing SMS1.22205-F24.Rev0, was witnessed and in our opinion meets the requirements of "Controlled Fill" as defined in AS3798-2007 and AS2870-2011 "Residential slabs and footings".

However, it should be recognised that the passage of time affects the information provided in this letter. SMS's opinions are based upon information that existed at the time that our services were provided. The services allowed SMS to form no more than an opinion of the fill placement undertaken under our Level 1 inspection and testing services at the times the earthworks were carried out. These services cannot be used to assess the effect of any subsequent further works at the site.

If you have any questions relating to this project or require any additional information, please contact our office on (08) 8258 7498.

SMS GEOTECHNICAL PTY LTD



Luke Garcia
Laboratory Manager

Attachments: Drawing SMS1.22205-F24.Rev0

Location	Pre Fill	Post Fill
Lot 142	346.800	348.180

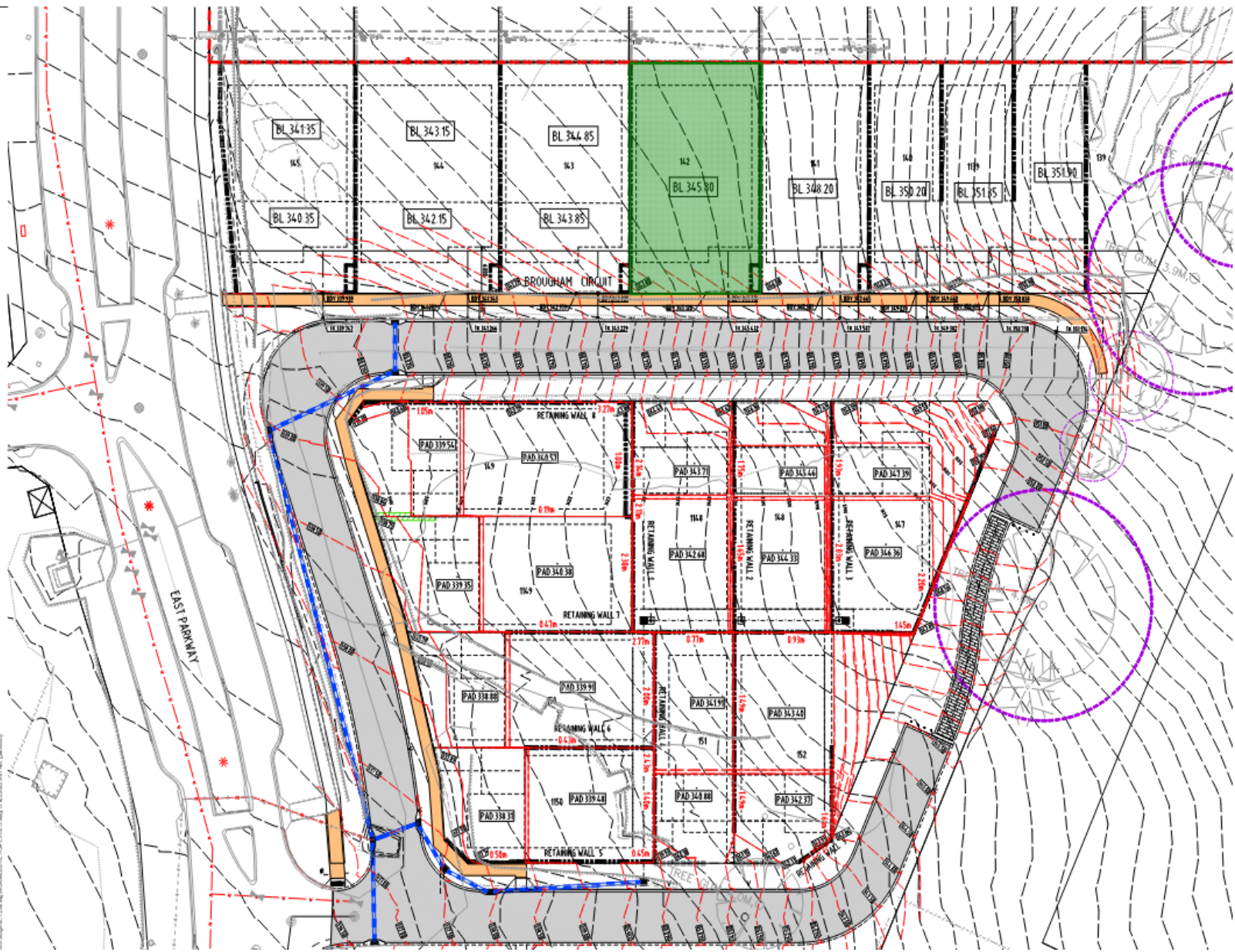

 Approx. Fill Location



Drawn:	LG	Date:	13.01.2023
Checked:	CS	Date:	13.01.2023
Revision:		Date:	
Scale:	NTS		A4

LR&M CONSTRUCTIONS PTY LTD	
BLUESTONE STAGE 5C1	
MOUNT BARKER	
SITE PLAN SHOWING PRE AND POST FILL LEVELS	
Project No.:	SMS1.22205
Drawing No.:	SMS1.22205-F24.Rev0

13th January 2023

Reference No. SMS1.22205-L23.Rev0

Mr Michael Engelaar
LR&M Construction Pty Ltd
6 Roseworthy Road
ROSEWORTHY SA 5371

LOT 141 BROUGHAM CIRCUIT – BLUESTONE LAND DIVISION STAGE 5C1, MT BARKER

Dear Michael,

SMS Geotechnical Pty Ltd (SMS) was commissioned by LR&M Construction Pty Ltd (LR&M) to provide Level 1 earthworks inspection and testing services during fill placement on Lot 141 Brougham Circuit on the above project in Mt Barker, South Australia. The area where fill was placed is shown approximately in Drawing SMS1.22205-F23.Rev0.

SMS were provided with a TBM by LR&M which was used to measure and record both pre and post fill levels. Post fill levels were taken prior to the placement of topsoil. The post fill levels were measured at approximately the same locations as the pre fill levels. These levels are detailed in Drawing SMS1.22205-F23.Rev0.

Whilst the utmost amount of care was taken while measuring these levels, SMS is not a licensed surveyor and the difference in measurements on Drawing SMS1.22205-F23.Rev0 may differ slightly to the maximum depth of placed fill on this site.

Level 1 inspection and testing services were carried out by SMS to Australian Standard AS3798-2007 "Guidelines on earthworks for commercial and residential developments" between 31st March 2022 and 10th January 2023. The subgrade was inspected and showed no signs of organic or unsuitable material. Subgrade proof rolling was witnessed prior to fill being placed and was deemed suitable by SMS' representative on site.

SMS conducted in situ density testing to AS1289.5.8.1 at randomly selected locations throughout areas in which fill was placed as per frequencies outlined in AS3798-2007. The density test results have been issued separately to LR&M and are retained in our project file. The required laboratory dry density ratio was achieved on all tests taken during fill placement. Laboratory tests were conducted to AS1289.5.1.1.

On the completion of Level 1 earthworks inspection and testing, SMS advise that the fill placed on Lot 141 Brougham Circuit as shown in Drawing SMS1.22205-F23.Rev0, was witnessed and in our opinion meets the requirements of "Controlled Fill" as defined in AS3798-2007 and AS2870-2011 "Residential slabs and footings".

However, it should be recognised that the passage of time affects the information provided in this letter. SMS's opinions are based upon information that existed at the time that our services were provided. The services allowed SMS to form no more than an opinion of the fill placement undertaken under our Level 1 inspection and testing services at the times the earthworks were carried out. These services cannot be used to assess the effect of any subsequent further works at the site.

If you have any questions relating to this project or require any additional information, please contact our office on (08) 8258 7498.

SMS GEOTECHNICAL PTY LTD



Luke Garcia
Laboratory Manager

Attachments: Drawing SMS1.22205-F23.Rev0

Location	Pre Fill	Post Fill
Lot 141	346.800	348.180

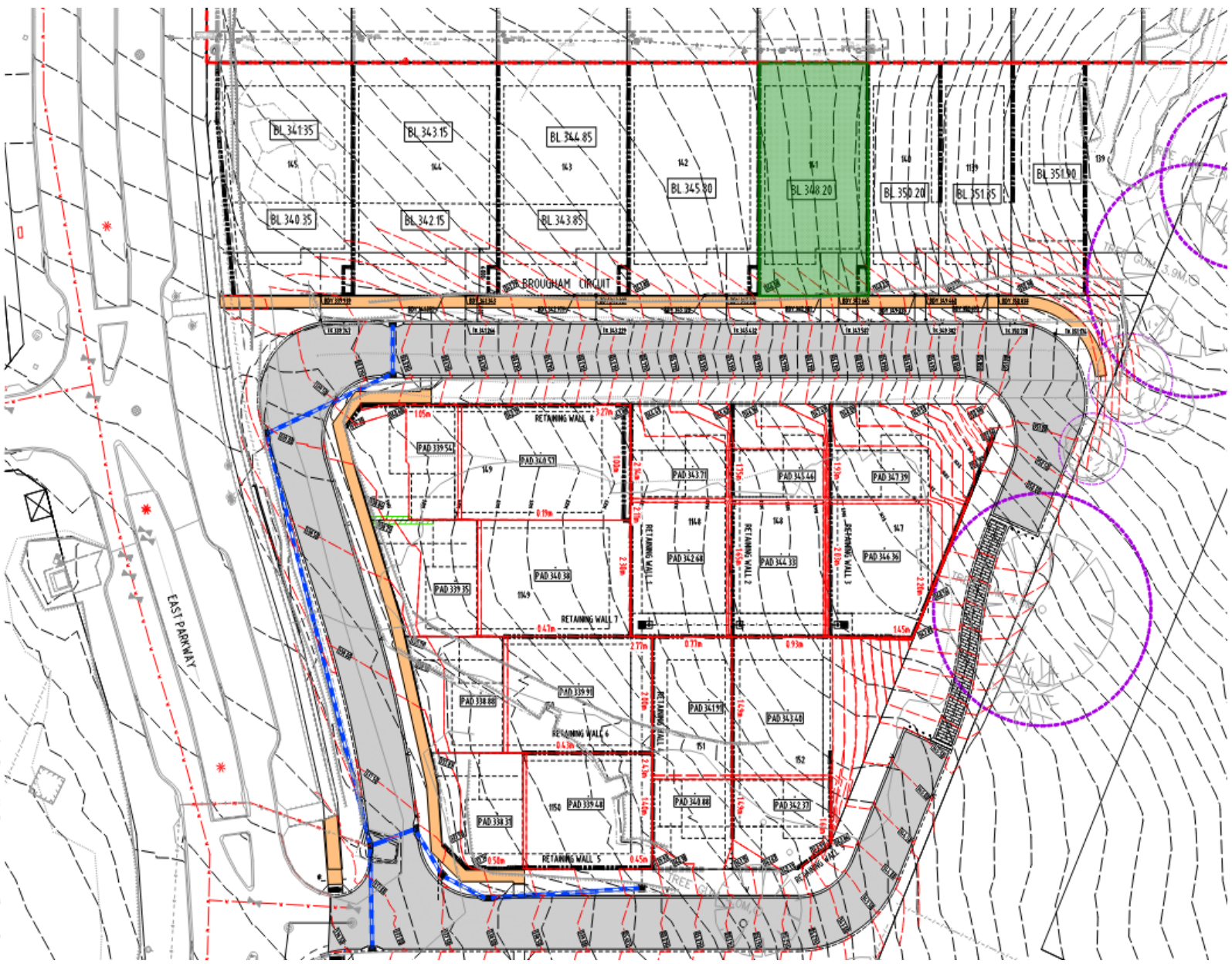

 Approx. Fill Location



Drawn:	LG	Date:	13.01.2023
Checked:	CS	Date:	13.01.2023
Revision:		Date:	
Scale:	NTS		A4

LR&M CONSTRUCTIONS PTY LTD	
BLUESTONE STAGE 5C1	
MOUNT BARKER	
SITE PLAN SHOWING PRE AND POST FILL LEVELS	
Project No.:	SMS1.22205
Drawing No.:	SMS1.22205-F23.Rev0

13th January 2023

Reference No. SMS1.22205-L27.Rev0

Mr Michael Engelaar
LR&M Construction Pty Ltd
6 Roseworthy Road
ROSEWORTHY SA 5371

LOT 148 BROUGHAM CIRCUIT – BLUESTONE LAND DIVISION STAGE 5C1, MT BARKER

Dear Michael,

SMS Geotechnical Pty Ltd (SMS) was commissioned by LR&M Construction Pty Ltd (LR&M) to provide Level 1 earthworks inspection and testing services during fill placement on Lot 148 Brougham Circuit on the above project in Mt Barker, South Australia. The area where fill was placed is shown approximately in Drawing SMS1.22205-F27.Rev0.

SMS were provided with a TBM by LR&M which was used to measure and record both pre and post fill levels. Post fill levels were taken prior to the placement of topsoil. The post fill levels were measured at approximately the same locations as the pre fill levels. These levels are detailed in Drawing SMS1.22205-F27.Rev0.

Whilst the utmost amount of care was taken while measuring these levels, SMS is not a licensed surveyor and the difference in measurements on Drawing SMS1.22205-F27.Rev0 may differ slightly to the maximum depth of placed fill on this site.

Level 1 inspection and testing services were carried out by SMS to Australian Standard AS3798-2007 "Guidelines on earthworks for commercial and residential developments" between 31st March 2022 and 10th January 2023. The subgrade was inspected and showed no signs of organic or unsuitable material. Subgrade proof rolling was witnessed prior to fill being placed and was deemed suitable by SMS' representative on site.

SMS conducted in situ density testing to AS1289.5.8.1 at randomly selected locations throughout areas in which fill was placed as per frequencies outlined in AS3798-2007. The density test results have been issued separately to LR&M and are retained in our project file. The required laboratory dry density ratio was achieved on all tests taken during fill placement. Laboratory tests were conducted to AS1289.5.1.1.

On the completion of Level 1 earthworks inspection and testing, SMS advise that the fill placed on Lot 148 Brougham Circuit as shown in Drawing SMS1.22205-F27.Rev0, was witnessed and in our opinion meets the requirements of "Controlled Fill" as defined in AS3798-2007 and AS2870-2011 "Residential slabs and footings".

However, it should be recognised that the passage of time affects the information provided in this letter. SMS's opinions are based upon information that existed at the time that our services were provided. The services allowed SMS to form no more than an opinion of the fill placement undertaken under our Level 1 inspection and testing services at the times the earthworks were carried out. These services cannot be used to assess the effect of any subsequent further works at the site.

If you have any questions relating to this project or require any additional information, please contact our office on (08) 8258 7498.

SMS GEOTECHNICAL PTY LTD



Luke Garcia
Laboratory Manager

Attachments: Drawing SMS1.22205-F27.Rev0

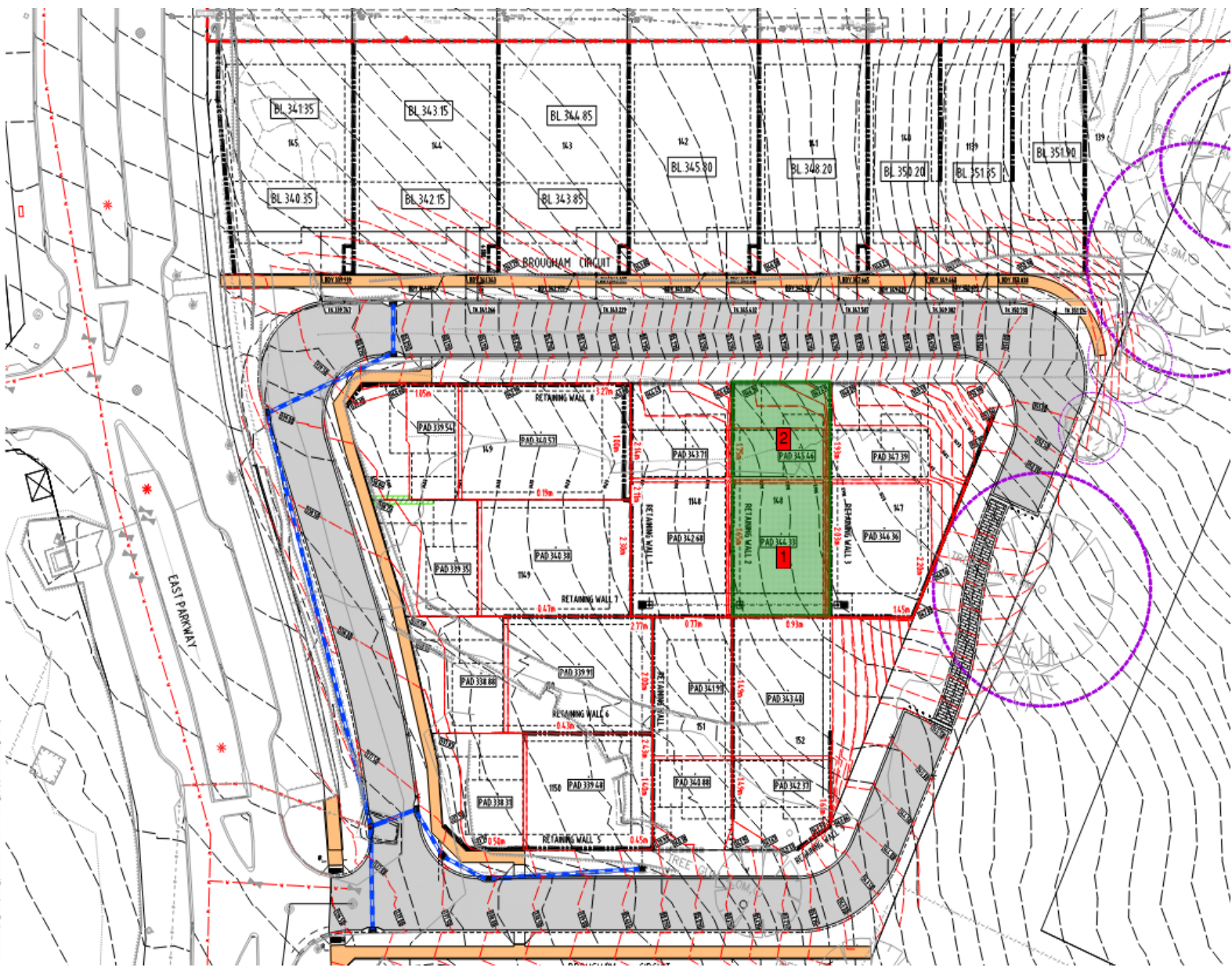

Location	Pre Fill	Post Fill
Lot 148 - 1	343.380	344.230
Lot 148 - 2	349.890	345.375

 Approx. Fill Location



Drawn:	LG	Date:	13.01.2023
Checked:	CS	Date:	13.01.2023
Revision:		Date:	
Scale:	NTS		A4

LR&M CONSTRUCTIONS PTY LTD BLUESTONE STAGE 5C1 MOUNT BARKER SITE PLAN SHOWING PRE AND POST FILL LEVELS	
Project No.:	SMS1.22205
Drawing No.:	SMS1.22205-F27.Rev0

13th January 2023

Reference No. SMS1.22205-L26.Rev0

Mr Michael Engelaar
LR&M Construction Pty Ltd
6 Roseworthy Road
ROSEWORTHY SA 5371

LOT 147 BROUGHAM CIRCUIT – BLUESTONE LAND DIVISION STAGE 5C1, MT BARKER

Dear Michael,

SMS Geotechnical Pty Ltd (SMS) was commissioned by LR&M Construction Pty Ltd (LR&M) to provide Level 1 earthworks inspection and testing services during fill placement on Lot 147 Brougham Circuit on the above project in Mt Barker, South Australia. The area where fill was placed is shown approximately in Drawing SMS1.22205-F26.Rev0.

SMS were provided with a TBM by LR&M which was used to measure and record both pre and post fill levels. Post fill levels were taken prior to the placement of topsoil. The post fill levels were measured at approximately the same locations as the pre fill levels. These levels are detailed in Drawing SMS1.22205-F26.Rev0.

Whilst the utmost amount of care was taken while measuring these levels, SMS is not a licensed surveyor and the difference in measurements on Drawing SMS1.22205-F26.Rev0 may differ slightly to the maximum depth of placed fill on this site.

Level 1 inspection and testing services were carried out by SMS to Australian Standard AS3798-2007 "Guidelines on earthworks for commercial and residential developments" between 31st March 2022 and 10th January 2023. The subgrade was inspected and showed no signs of organic or unsuitable material. Subgrade proof rolling was witnessed prior to fill being placed and was deemed suitable by SMS' representative on site.

SMS conducted in situ density testing to AS1289.5.8.1 at randomly selected locations throughout areas in which fill was placed as per frequencies outlined in AS3798-2007. The density test results have been issued separately to LR&M and are retained in our project file. The required laboratory dry density ratio was achieved on all tests taken during fill placement. Laboratory tests were conducted to AS1289.5.1.1.

On the completion of Level 1 earthworks inspection and testing, SMS advise that the fill placed on Lot 147 Brougham Circuit as shown in Drawing SMS1.22205-F26.Rev0, was witnessed and in our opinion meets the requirements of "Controlled Fill" as defined in AS3798-2007 and AS2870-2011 "Residential slabs and footings".

However, it should be recognised that the passage of time affects the information provided in this letter. SMS's opinions are based upon information that existed at the time that our services were provided. The services allowed SMS to form no more than an opinion of the fill placement undertaken under our Level 1 inspection and testing services at the times the earthworks were carried out. These services cannot be used to assess the effect of any subsequent further works at the site.

If you have any questions relating to this project or require any additional information, please contact our office on (08) 8258 7498.

SMS GEOTECHNICAL PTY LTD



Luke Garcia
Laboratory Manager

Attachments: Drawing SMS1.22205-F26.Rev0

Location	Pre Fill	Post Fill
Lot 147 - 1	344.860	346.260
Lot 147 - 2	346.860	347.275

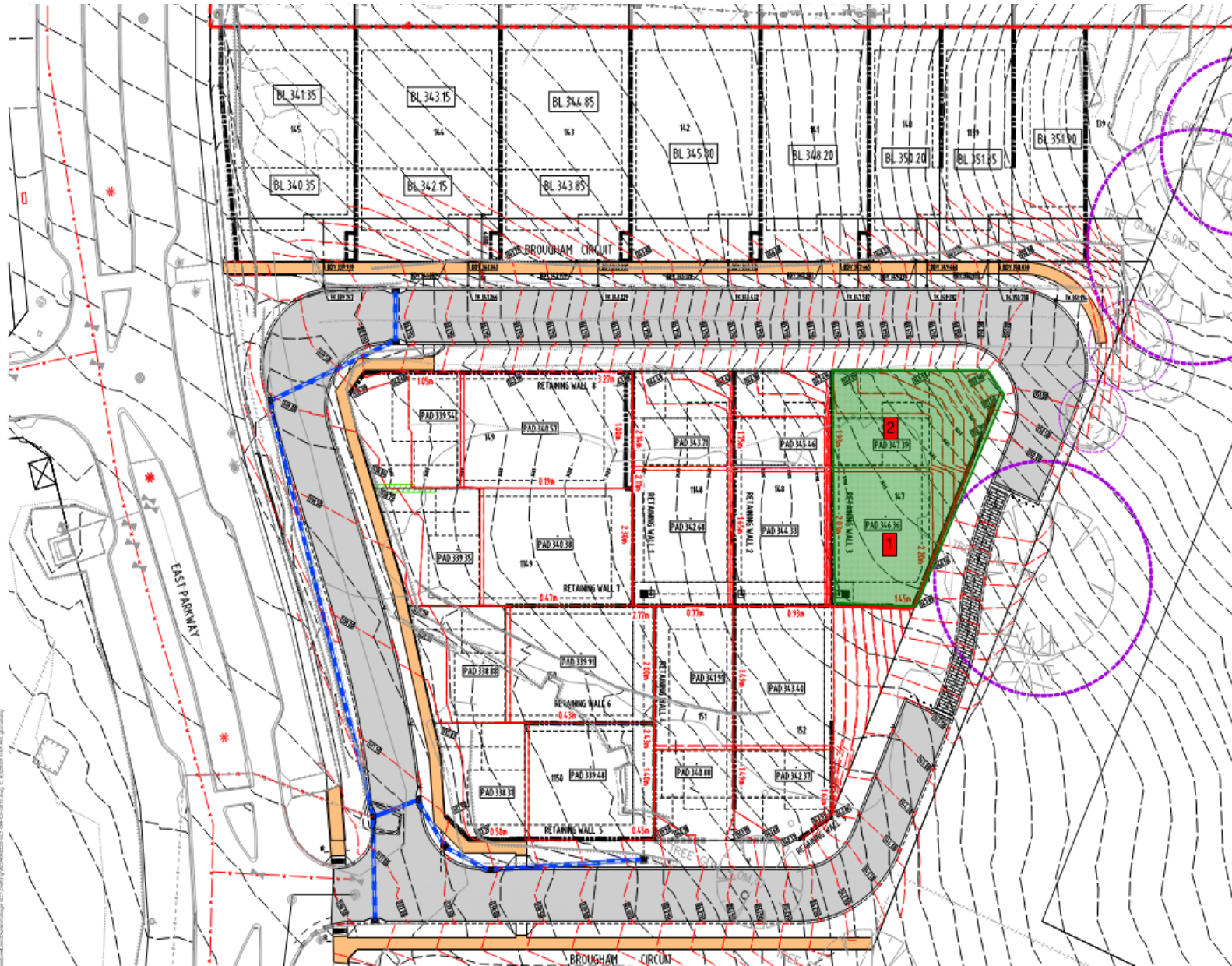

 Approx. Fill Location



Drawn:	LG	Date:	13.01.2023
Checked:	CS	Date:	13.01.2023
Revision:		Date:	
Scale:	NTS		A4

LR&M CONSTRUCTIONS PTY LTD BLUESTONE STAGE 5C1 MOUNT BARKER SITE PLAN SHOWING PRE AND POST FILL LEVELS	
Project No.:	SMS1.22205
Drawing No.:	SMS1.22205-F26.Rev0

13th January 2023

Reference No. SMS1.22205-L30.Rev0

Mr Michael Engelaar
LR&M Construction Pty Ltd
6 Roseworthy Road
ROSEWORTHY SA 5371

LOT 151 BROUGHAM CIRCUIT – BLUESTONE LAND DIVISION STAGE 5C1, MT BARKER

Dear Michael,

SMS Geotechnical Pty Ltd (SMS) was commissioned by LR&M Construction Pty Ltd (LR&M) to provide Level 1 earthworks inspection and testing services during fill placement on Lot 151 Brougham Circuit on the above project in Mt Barker, South Australia. The area where fill was placed is shown approximately in Drawing SMS1.22205-F30.Rev0.

SMS were provided with a TBM by LR&M which was used to measure and record both pre and post fill levels. Post fill levels were taken prior to the placement of topsoil. The post fill levels were measured at approximately the same locations as the pre fill levels. These levels are detailed in Drawing SMS1.22205-F30.Rev0.

Whilst the utmost amount of care was taken while measuring these levels, SMS is not a licensed surveyor and the difference in measurements on Drawing SMS1.22205-F30.Rev0 may differ slightly to the maximum depth of placed fill on this site.

Level 1 inspection and testing services were carried out by SMS to Australian Standard AS3798-2007 "Guidelines on earthworks for commercial and residential developments" between 31st March 2022 and 10th January 2023. The subgrade was inspected and showed no signs of organic or unsuitable material. Subgrade proof rolling was witnessed prior to fill being placed and was deemed suitable by SMS' representative on site.

SMS conducted in situ density testing to AS1289.5.8.1 at randomly selected locations throughout areas in which fill was placed as per frequencies outlined in AS3798-2007. The density test results have been issued separately to LR&M and are retained in our project file. The required laboratory dry density ratio was achieved on all tests taken during fill placement. Laboratory tests were conducted to AS1289.5.1.1.

On the completion of Level 1 earthworks inspection and testing, SMS advise that the fill placed on Lot 151 Brougham Circuit as shown in Drawing SMS1.22205-F30.Rev0, was witnessed and in our opinion meets the requirements of "Controlled Fill" as defined in AS3798-2007 and AS2870-2011 "Residential slabs and footings".

However, it should be recognised that the passage of time affects the information provided in this letter. SMS's opinions are based upon information that existed at the time that our services were provided. The services allowed SMS to form no more than an opinion of the fill placement undertaken under our Level 1 inspection and testing services at the times the earthworks were carried out. These services cannot be used to assess the effect of any subsequent further works at the site.

If you have any questions relating to this project or require any additional information, please contact our office on (08) 8258 7498.

SMS GEOTECHNICAL PTY LTD



Luke Garcia
Laboratory Manager

Attachments: Drawing SMS1.22205-F30.Rev0

Location	Pre Fill	Post Fill
Lot 151 - 1	341.210	341.800
Lot 151 - 2	340.550	340.955

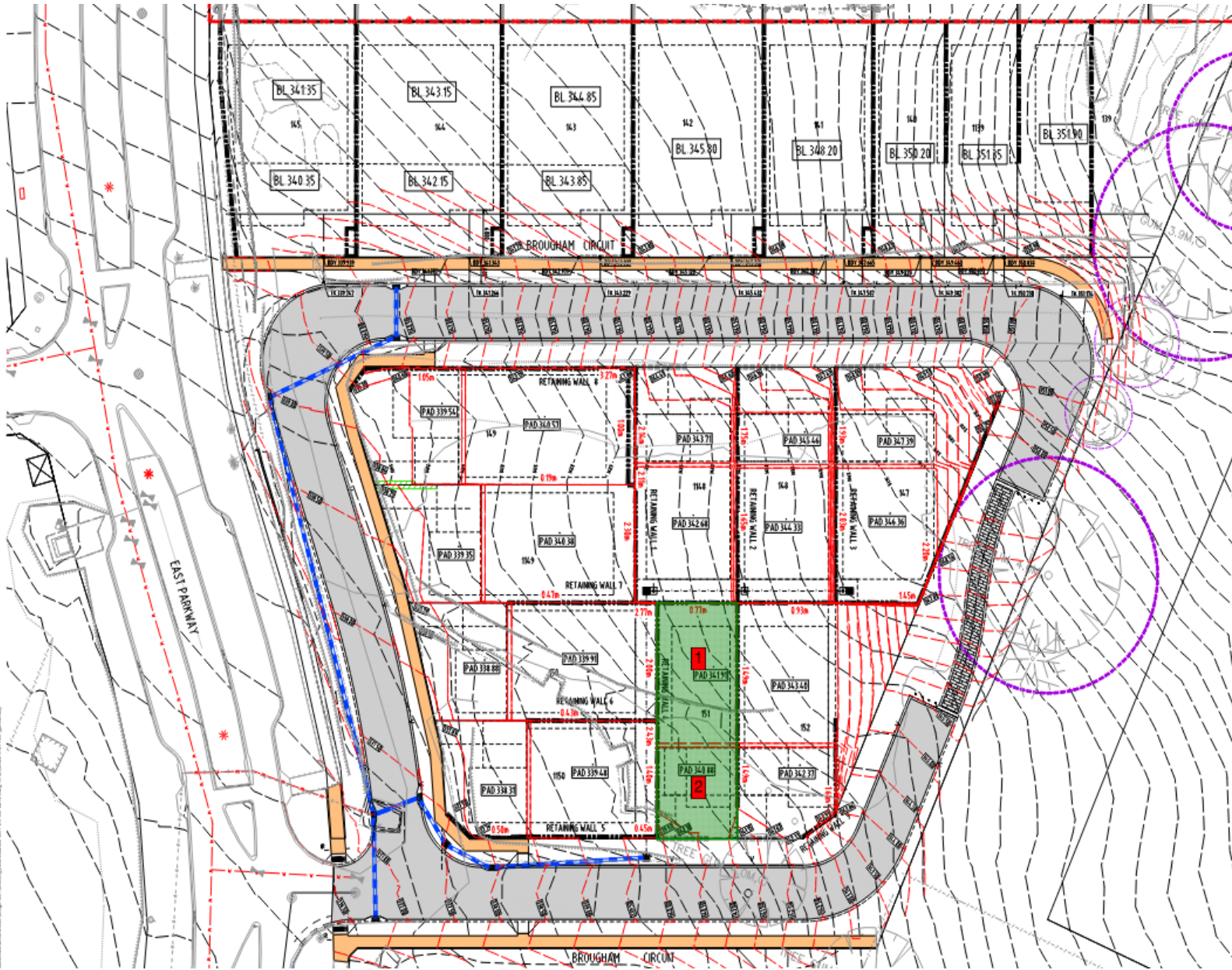

 Approx. Fill Location



Drawn:	LG	Date:	13.01.2023
Checked:	CS	Date:	13.01.2023
Revision:		Date:	
Scale:	NTS		A4

LR&M CONSTRUCTIONS PTY LTD BLUESTONE STAGE 5C1 MOUNT BARKER SITE PLAN SHOWING PRE AND POST FILL LEVELS	
Project No.:	SMS1.22205
Drawing No.:	SMS1.22205-F30.Rev0

13th January 2023

Reference No. SMS1.22205-L29.Rev0

Mr Michael Engelaar
LR&M Construction Pty Ltd
6 Roseworthy Road
ROSEWORTHY SA 5371

LOT 150 BROUGHAM CIRCUIT – BLUESTONE LAND DIVISION STAGE 5C1, MT BARKER

Dear Michael,

SMS Geotechnical Pty Ltd (SMS) was commissioned by LR&M Construction Pty Ltd (LR&M) to provide Level 1 earthworks inspection and testing services during fill placement on Lot 150 Brougham Circuit on the above project in Mt Barker, South Australia. The area where fill was placed is shown approximately in Drawing SMS1.22205-F29.Rev0.

SMS were provided with a TBM by LR&M which was used to measure and record both pre and post fill levels. Post fill levels were taken prior to the placement of topsoil. The post fill levels were measured at approximately the same locations as the pre fill levels. These levels are detailed in Drawing SMS1.22205-F29.Rev0.

Whilst the utmost amount of care was taken while measuring these levels, SMS is not a licensed surveyor and the difference in measurements on Drawing SMS1.22205-F29.Rev0 may differ slightly to the maximum depth of placed fill on this site.

Level 1 inspection and testing services were carried out by SMS to Australian Standard AS3798-2007 "Guidelines on earthworks for commercial and residential developments" between 31st March 2022 and 10th January 2023. The subgrade was inspected and showed no signs of organic or unsuitable material. Subgrade proof rolling was witnessed prior to fill being placed and was deemed suitable by SMS' representative on site.

SMS conducted in situ density testing to AS1289.5.8.1 at randomly selected locations throughout areas in which fill was placed as per frequencies outlined in AS3798-2007. The density test results have been issued separately to LR&M and are retained in our project file. The required laboratory dry density ratio was achieved on all tests taken during fill placement. Laboratory tests were conducted to AS1289.5.1.1.

On the completion of Level 1 earthworks inspection and testing, SMS advise that the fill placed on Lot 150 Brougham Circuit as shown in Drawing SMS1.22205-F29.Rev0, was witnessed and in our opinion meets the requirements of "Controlled Fill" as defined in AS3798-2007 and AS2870-2011 "Residential slabs and footings".

However, it should be recognised that the passage of time affects the information provided in this letter. SMS's opinions are based upon information that existed at the time that our services were provided. The services allowed SMS to form no more than an opinion of the fill placement undertaken under our Level 1 inspection and testing services at the times the earthworks were carried out. These services cannot be used to assess the effect of any subsequent further works at the site.

If you have any questions relating to this project or require any additional information, please contact our office on (08) 8258 7498.

SMS GEOTECHNICAL PTY LTD



Luke Garcia
Laboratory Manager

Attachments: Drawing SMS1.22205-F29.Rev0



Location	Pre Fill	Post Fill
Lot 150 - 1	339.460	339.810
Lot 150 - 2	338.500	338.770

 Approx. Fill Location

SMS
GEOTECHNICAL
Quality in Construction

Drawn:	LG	Date:	13.01.2023
Checked:	CS	Date:	13.01.2023
Revision:		Date:	
Scale:	NTS		A4

LR&M CONSTRUCTIONS PTY LTD	
BLUESTONE STAGE 5C1	
MOUNT BARKER	
SITE PLAN SHOWING PRE AND POST FILL LEVELS	
Project No.:	SMS1.22205
Drawing No.:	SMS1.22205-F29.Rev0

13th January 2023

Reference No. SMS1.22205-L33.Rev0

Mr Michael Engelaar
LR&M Construction Pty Ltd
6 Roseworthy Road
ROSEWORTHY SA 5371

LOT 1149 BROUGHAM CIRCUIT – BLUESTONE LAND DIVISION STAGE 5C1, MT BARKER

Dear Michael,

SMS Geotechnical Pty Ltd (SMS) was commissioned by LR&M Construction Pty Ltd (LR&M) to provide Level 1 earthworks inspection and testing services during fill placement on Lot 1149 Brougham Circuit on the above project in Mt Barker, South Australia. The area where fill was placed is shown approximately in Drawing SMS1.22205-F33.Rev0.

SMS were provided with a TBM by LR&M which was used to measure and record both pre and post fill levels. Post fill levels were taken prior to the placement of topsoil. The post fill levels were measured at approximately the same locations as the pre fill levels. These levels are detailed in Drawing SMS1.22205-F33.Rev0.

Whilst the utmost amount of care was taken while measuring these levels, SMS is not a licensed surveyor and the difference in measurements on Drawing SMS1.22205-F33.Rev0 may differ slightly to the maximum depth of placed fill on this site.

Level 1 inspection and testing services were carried out by SMS to Australian Standard AS3798-2007 "Guidelines on earthworks for commercial and residential developments" between 31st March 2022 and 10th January 2023. The subgrade was inspected and showed no signs of organic or unsuitable material. Subgrade proof rolling was witnessed prior to fill being placed and was deemed suitable by SMS' representative on site.

SMS conducted in situ density testing to AS1289.5.8.1 at randomly selected locations throughout areas in which fill was placed as per frequencies outlined in AS3798-2007. The density test results have been issued separately to LR&M and are retained in our project file. The required laboratory dry density ratio was achieved on all tests taken during fill placement. Laboratory tests were conducted to AS1289.5.1.1.

On the completion of Level 1 earthworks inspection and testing, SMS advise that the fill placed on Lot 1149 Brougham Circuit as shown in Drawing SMS1.22205-F33.Rev0, was witnessed and in our opinion meets the requirements of "Controlled Fill" as defined in AS3798-2007 and AS2870-2011 "Residential slabs and footings".

However, it should be recognised that the passage of time affects the information provided in this letter. SMS's opinions are based upon information that existed at the time that our services were provided. The services allowed SMS to form no more than an opinion of the fill placement undertaken under our Level 1 inspection and testing services at the times the earthworks were carried out. These services cannot be used to assess the effect of any subsequent further works at the site.

If you have any questions relating to this project or require any additional information, please contact our office on (08) 8258 7498.

SMS GEOTECHNICAL PTY LTD



Luke Garcia
Laboratory Manager

Attachments: Drawing SMS1.22205-F33.Rev0

Location	Pre Fill	Post Fill
Lot 1149 - 1	339.430	340.500
Lot 1149 - 2	339.225	339.450

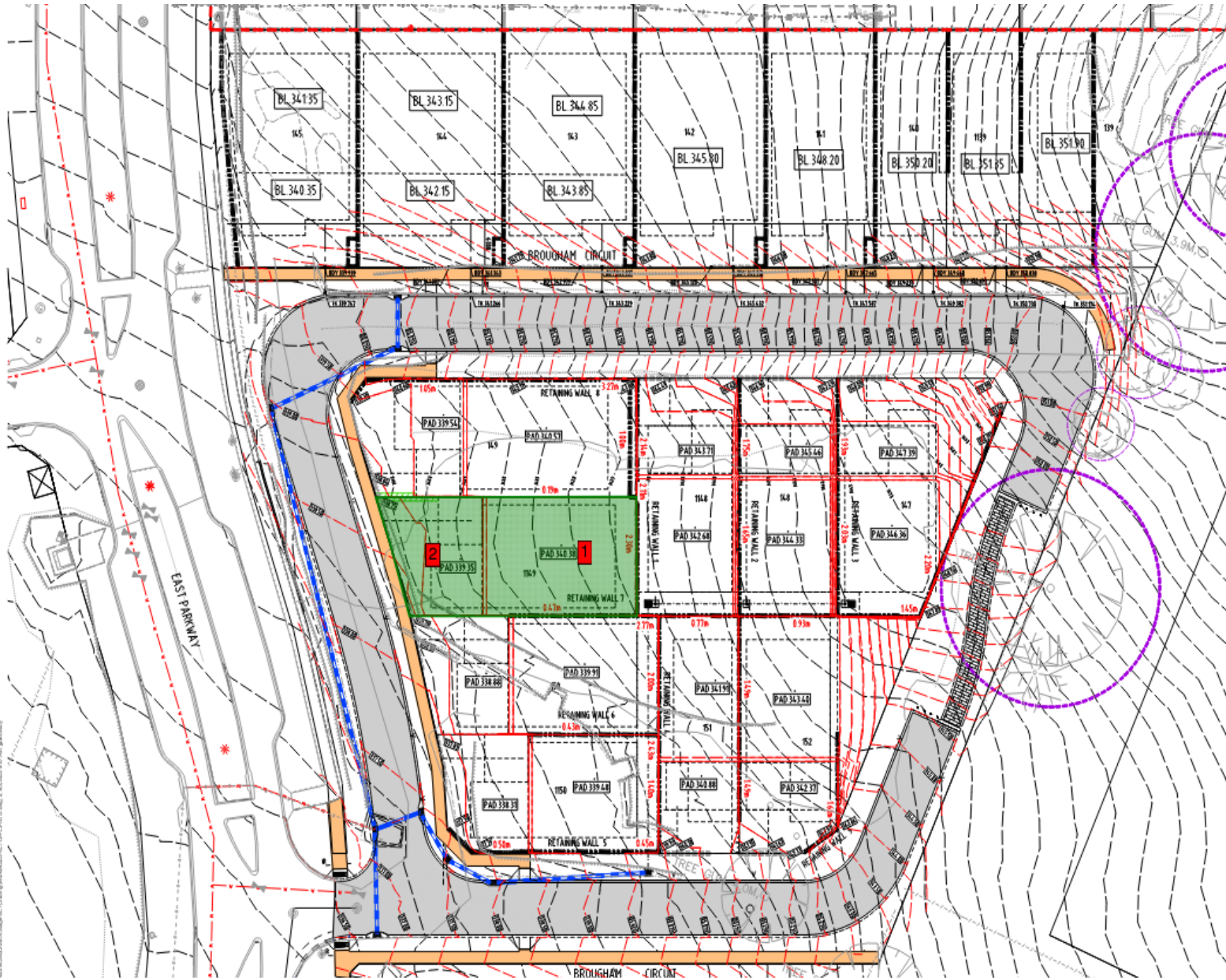

 Approx. Fill Location



Drawn:	LG	Date:	13.01.2023
Checked:	CS	Date:	13.01.2023
Revision:		Date:	
Scale:	NTS		A4

LR&M CONSTRUCTIONS PTY LTD BLUESTONE STAGE 5C1 MOUNT BARKER SITE PLAN SHOWING PRE AND POST FILL LEVELS			
		Project No.:	SMS1.22205
		Drawing No.:	SMS1.22205-F33.Rev0

13th January 2023

Reference No. SMS1.22205-L32.Rev0

Mr Michael Engelaar
LR&M Construction Pty Ltd
6 Roseworthy Road
ROSEWORTHY SA 5371

LOT 1148 BROUGHAM CIRCUIT – BLUESTONE LAND DIVISION STAGE 5C1, MT BARKER

Dear Michael,

SMS Geotechnical Pty Ltd (SMS) was commissioned by LR&M Construction Pty Ltd (LR&M) to provide Level 1 earthworks inspection and testing services during fill placement on Lot 1148 Brougham Circuit on the above project in Mt Barker, South Australia. The area where fill was placed is shown approximately in Drawing SMS1.22205-F32.Rev0.

SMS were provided with a TBM by LR&M which was used to measure and record both pre and post fill levels. Post fill levels were taken prior to the placement of topsoil. The post fill levels were measured at approximately the same locations as the pre fill levels. These levels are detailed in Drawing SMS1.22205-F32.Rev0.

Whilst the utmost amount of care was taken while measuring these levels, SMS is not a licensed surveyor and the difference in measurements on Drawing SMS1.22205-F32.Rev0 may differ slightly to the maximum depth of placed fill on this site.

Level 1 inspection and testing services were carried out by SMS to Australian Standard AS3798-2007 "Guidelines on earthworks for commercial and residential developments" between 31st March 2022 and 10th January 2023. The subgrade was inspected and showed no signs of organic or unsuitable material. Subgrade proof rolling was witnessed prior to fill being placed and was deemed suitable by SMS' representative on site.

SMS conducted in situ density testing to AS1289.5.8.1 at randomly selected locations throughout areas in which fill was placed as per frequencies outlined in AS3798-2007. The density test results have been issued separately to LR&M and are retained in our project file. The required laboratory dry density ratio was achieved on all tests taken during fill placement. Laboratory tests were conducted to AS1289.5.1.1.

On the completion of Level 1 earthworks inspection and testing, SMS advise that the fill placed on Lot 1148 Brougham Circuit as shown in Drawing SMS1.22205-F32.Rev0, was witnessed and in our opinion meets the requirements of "Controlled Fill" as defined in AS3798-2007 and AS2870-2011 "Residential slabs and footings".

However, it should be recognised that the passage of time affects the information provided in this letter. SMS's opinions are based upon information that existed at the time that our services were provided. The services allowed SMS to form no more than an opinion of the fill placement undertaken under our Level 1 inspection and testing services at the times the earthworks were carried out. These services cannot be used to assess the effect of any subsequent further works at the site.

If you have any questions relating to this project or require any additional information, please contact our office on (08) 8258 7498.

SMS GEOTECHNICAL PTY LTD



Luke Garcia
Laboratory Manager

Attachments: Drawing SMS1.22205-F32.Rev0

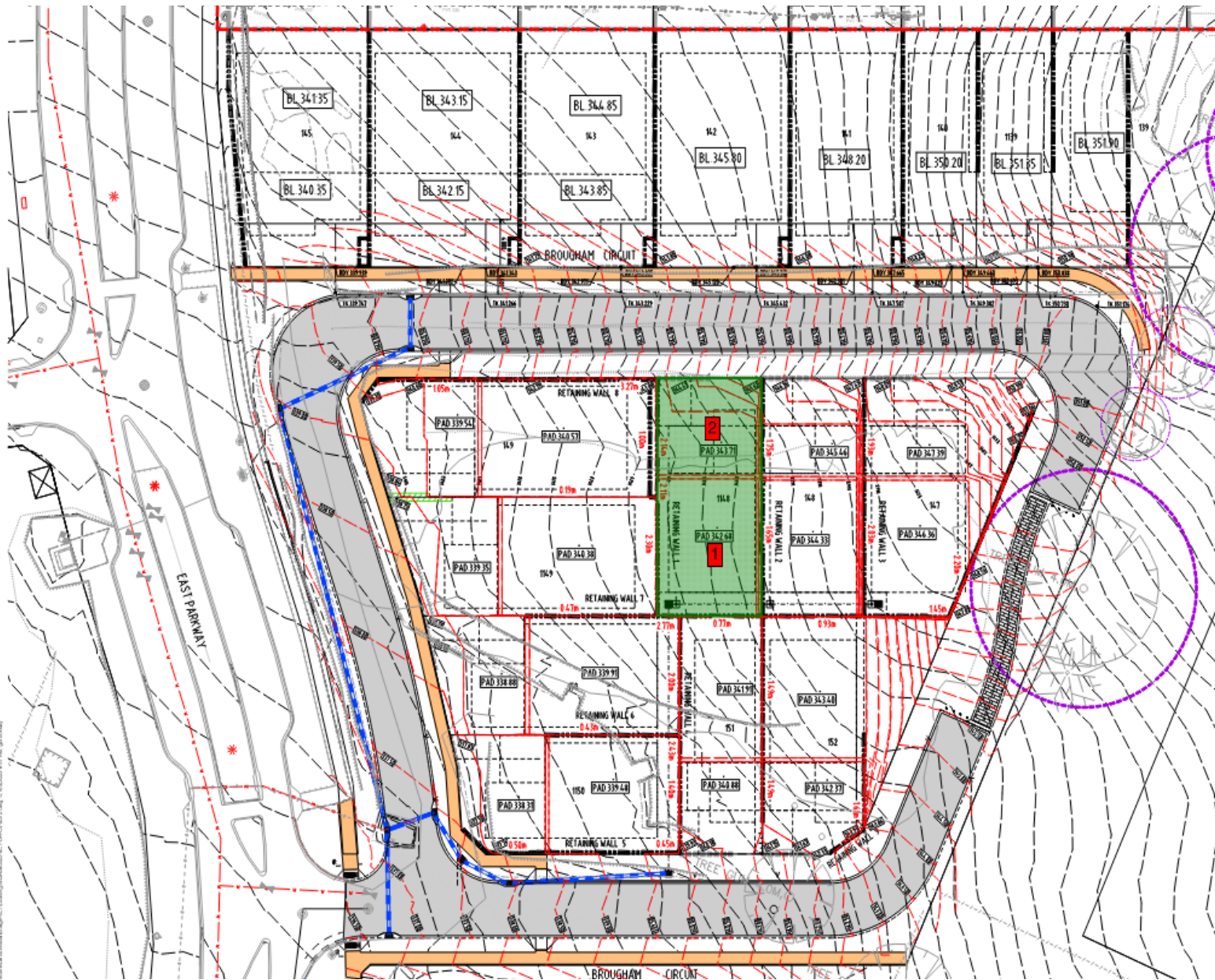

Location	Pre Fill	Post Fill
Lot 1148 - 1	341.980	342.580
Lot 1148 - 2	343.250	343.600

 Approx. Fill Location

SMS
GEOTECHNICAL
Quality in Construction

Drawn:	LG	Date:	13.01.2023
Checked:	CS	Date:	13.01.2023
Revision:		Date:	
Scale:	NTS		A4

LR&M CONSTRUCTIONS PTY LTD	
BLUESTONE STAGE 5C1	
MOUNT BARKER	
SITE PLAN SHOWING PRE AND POST FILL LEVELS	
Project No.:	SMS1.22205
Drawing No.:	SMS1.22205-F32.Rev0

13th January 2023

Reference No. SMS1.22205-L34.Rev0

Mr Michael Engelaar
LR&M Construction Pty Ltd
6 Roseworthy Road
ROSEWORTHY SA 5371

LOT 1150 BROUGHAM CIRCUIT – BLUESTONE LAND DIVISION STAGE 5C1, MT BARKER

Dear Michael,

SMS Geotechnical Pty Ltd (SMS) was commissioned by LR&M Construction Pty Ltd (LR&M) to provide Level 1 earthworks inspection and testing services during fill placement on Lot 1150 Brougham Circuit on the above project in Mt Barker, South Australia. The area where fill was placed is shown approximately in Drawing SMS1.22205-F34.Rev0.

SMS were provided with a TBM by LR&M which was used to measure and record both pre and post fill levels. Post fill levels were taken prior to the placement of topsoil. The post fill levels were measured at approximately the same locations as the pre fill levels. These levels are detailed in Drawing SMS1.22205-F34.Rev0.

Whilst the utmost amount of care was taken while measuring these levels, SMS is not a licensed surveyor and the difference in measurements on Drawing SMS1.22205-F34.Rev0 may differ slightly to the maximum depth of placed fill on this site.

Level 1 inspection and testing services were carried out by SMS to Australian Standard AS3798-2007 "Guidelines on earthworks for commercial and residential developments" between 31st March 2022 and 10th January 2023. The subgrade was inspected and showed no signs of organic or unsuitable material. Subgrade proof rolling was witnessed prior to fill being placed and was deemed suitable by SMS' representative on site.

SMS conducted in situ density testing to AS1289.5.8.1 at randomly selected locations throughout areas in which fill was placed as per frequencies outlined in AS3798-2007. The density test results have been issued separately to LR&M and are retained in our project file. The required laboratory dry density ratio was achieved on all tests taken during fill placement. Laboratory tests were conducted to AS1289.5.1.1.

On the completion of Level 1 earthworks inspection and testing, SMS advise that the fill placed on Lot 1150 Brougham Circuit as shown in Drawing SMS1.22205-F34.Rev0, was witnessed and in our opinion meets the requirements of "Controlled Fill" as defined in AS3798-2007 and AS2870-2011 "Residential slabs and footings".

However, it should be recognised that the passage of time affects the information provided in this letter. SMS's opinions are based upon information that existed at the time that our services were provided. The services allowed SMS to form no more than an opinion of the fill placement undertaken under our Level 1 inspection and testing services at the times the earthworks were carried out. These services cannot be used to assess the effect of any subsequent further works at the site.

If you have any questions relating to this project or require any additional information, please contact our office on (08) 8258 7498.

SMS GEOTECHNICAL PTY LTD



Luke Garcia
Laboratory Manager

Attachments: Drawing SMS1.22205-F34.Rev0

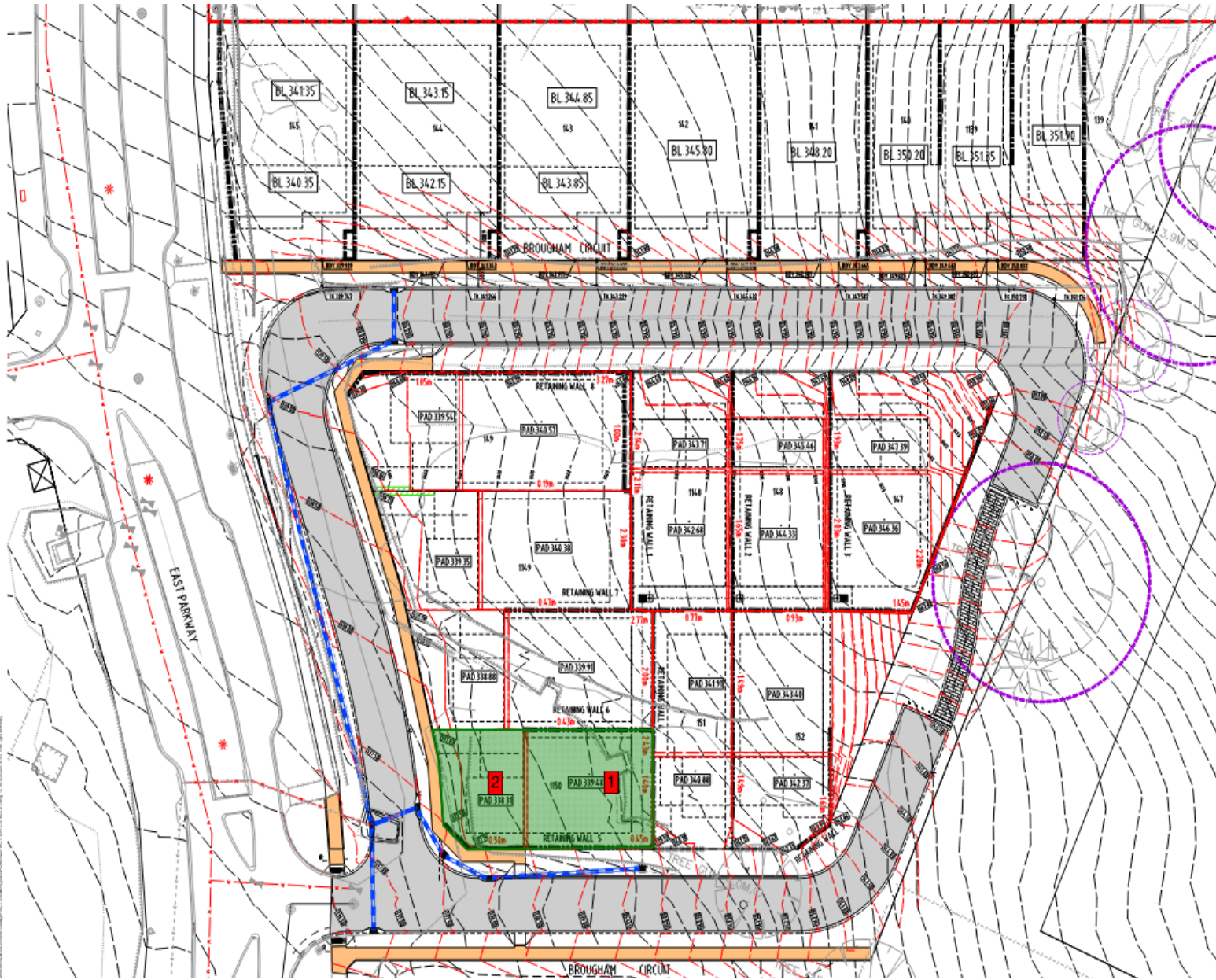

Location	Pre Fill	Post Fill
Lot 1150 - 1	339.030	339.400
Lot 1150 - 2	337.925	338.200

 Approx. Fill Location

SMS
GEOTECHNICAL
Quality in Construction

Drawn:	LG	Date:	13.01.2023
Checked:	CS	Date:	13.01.2023
Revision:		Date:	
Scale:	NTS		A4

LR&M CONSTRUCTIONS PTY LTD	
BLUESTONE STAGE 5C1	
MOUNT BARKER	
SITE PLAN SHOWING PRE AND POST FILL LEVELS	
Project No.:	SMS1.22205
Drawing No.:	SMS1.22205-F34.Rev0

13th January 2023

Reference No. SMS1.22205-L31.Rev0

Mr Michael Engelaar
LR&M Construction Pty Ltd
6 Roseworthy Road
ROSEWORTHY SA 5371

LOT 152 BROUGHAM CIRCUIT – BLUESTONE LAND DIVISION STAGE 5C1, MT BARKER

Dear Michael,

SMS Geotechnical Pty Ltd (SMS) was commissioned by LR&M Construction Pty Ltd (LR&M) to provide Level 1 earthworks inspection and testing services during fill placement on Lot 152 Brougham Circuit on the above project in Mt Barker, South Australia. The area where fill was placed is shown approximately in Drawing SMS1.22205-F31.Rev0.

SMS were provided with a TBM by LR&M which was used to measure and record both pre and post fill levels. Post fill levels were taken prior to the placement of topsoil. The post fill levels were measured at approximately the same locations as the pre fill levels. These levels are detailed in Drawing SMS1.22205-F31.Rev0.

Whilst the utmost amount of care was taken while measuring these levels, SMS is not a licensed surveyor and the difference in measurements on Drawing SMS1.22205-F31.Rev0 may differ slightly to the maximum depth of placed fill on this site.

Level 1 inspection and testing services were carried out by SMS to Australian Standard AS3798-2007 "Guidelines on earthworks for commercial and residential developments" between 31st March 2022 and 10th January 2023. The subgrade was inspected and showed no signs of organic or unsuitable material. Subgrade proof rolling was witnessed prior to fill being placed and was deemed suitable by SMS' representative on site.

SMS conducted in situ density testing to AS1289.5.8.1 at randomly selected locations throughout areas in which fill was placed as per frequencies outlined in AS3798-2007. The density test results have been issued separately to LR&M and are retained in our project file. The required laboratory dry density ratio was achieved on all tests taken during fill placement. Laboratory tests were conducted to AS1289.5.1.1.

On the completion of Level 1 earthworks inspection and testing, SMS advise that the fill placed on Lot 152 Brougham Circuit as shown in Drawing SMS1.22205-F31.Rev0, was witnessed and in our opinion meets the requirements of "Controlled Fill" as defined in AS3798-2007 and AS2870-2011 "Residential slabs and footings".

However, it should be recognised that the passage of time affects the information provided in this letter. SMS's opinions are based upon information that existed at the time that our services were provided. The services allowed SMS to form no more than an opinion of the fill placement undertaken under our Level 1 inspection and testing services at the times the earthworks were carried out. These services cannot be used to assess the effect of any subsequent further works at the site.

If you have any questions relating to this project or require any additional information, please contact our office on (08) 8258 7498.

SMS GEOTECHNICAL PTY LTD



Luke Garcia
Laboratory Manager

Attachments: Drawing SMS1.22205-F31.Rev0

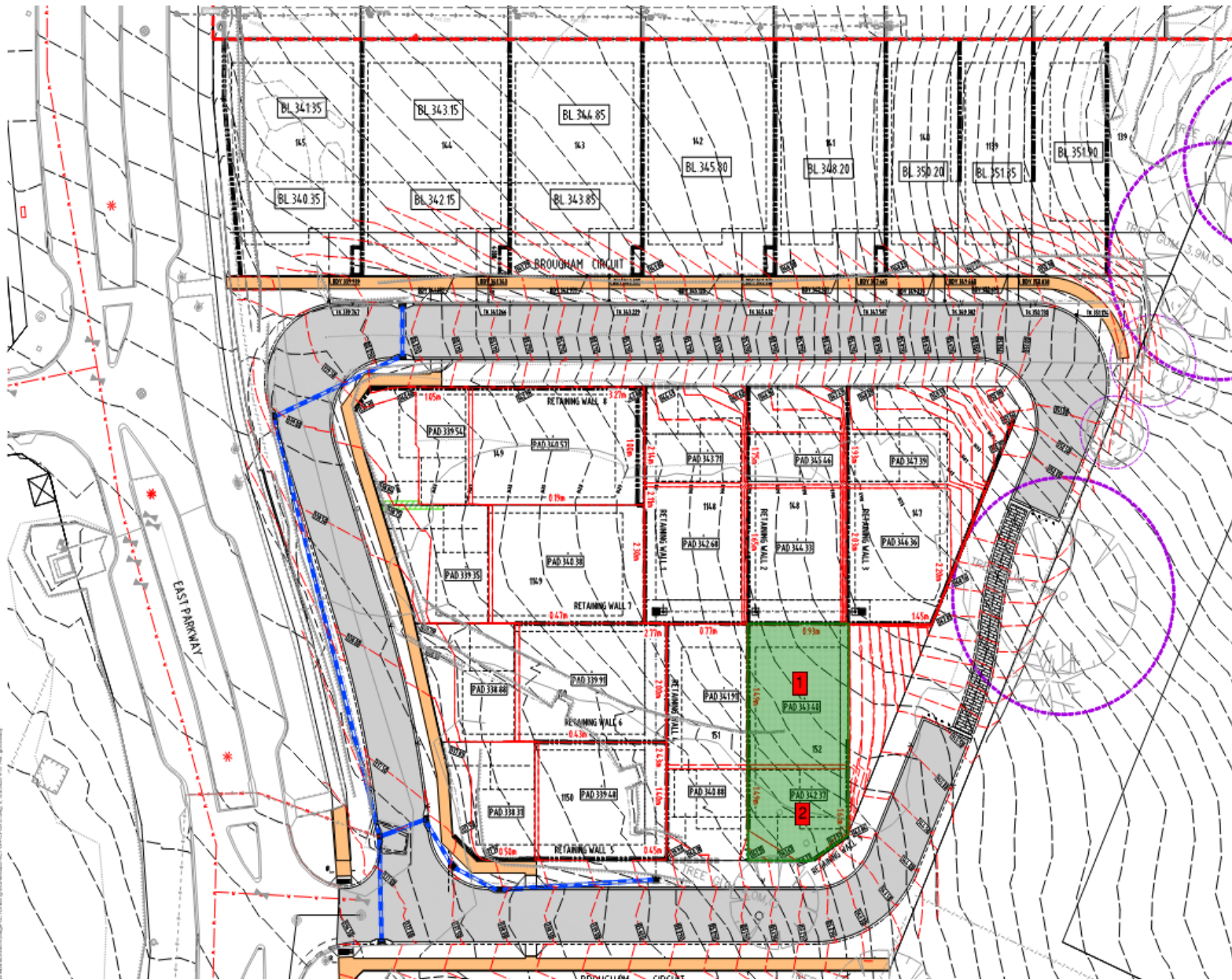

Location	Pre Fill	Post Fill
Lot 152 - 1	342.200	343.350
Lot 152 - 2	341.865	342.285

 Approx. Fill Location

SMS
GEOTECHNICAL
Quality in Construction

Drawn:	LG	Date:	13.01.2023
Checked:	CS	Date:	13.01.2023
Revision:		Date:	
Scale:	NTS		A4

LR&M CONSTRUCTIONS PTY LTD	
BLUESTONE STAGE 5C1	
MOUNT BARKER	
SITE PLAN SHOWING PRE AND POST FILL LEVELS	
Project No.:	SMS1.22205
Drawing No.:	SMS1.22205-F31.Rev0

13th January 2023

Reference No. SMS1.22205-L28.Rev0

Mr Michael Engelaar
LR&M Construction Pty Ltd
6 Roseworthy Road
ROSEWORTHY SA 5371

LOT 149 BROUGHAM CIRCUIT – BLUESTONE LAND DIVISION STAGE 5C1, MT BARKER

Dear Michael,

SMS Geotechnical Pty Ltd (SMS) was commissioned by LR&M Construction Pty Ltd (LR&M) to provide Level 1 earthworks inspection and testing services during fill placement on Lot 149 Brougham Circuit on the above project in Mt Barker, South Australia. The area where fill was placed is shown approximately in Drawing SMS1.22205-F28.Rev0.

SMS were provided with a TBM by LR&M which was used to measure and record both pre and post fill levels. Post fill levels were taken prior to the placement of topsoil. The post fill levels were measured at approximately the same locations as the pre fill levels. These levels are detailed in Drawing SMS1.22205-F28.Rev0.

Whilst the utmost amount of care was taken while measuring these levels, SMS is not a licensed surveyor and the difference in measurements on Drawing SMS1.22205-F28.Rev0 may differ slightly to the maximum depth of placed fill on this site.

Level 1 inspection and testing services were carried out by SMS to Australian Standard AS3798-2007 "Guidelines on earthworks for commercial and residential developments" between 31st March 2022 and 10th January 2023. The subgrade was inspected and showed no signs of organic or unsuitable material. Subgrade proof rolling was witnessed prior to fill being placed and was deemed suitable by SMS' representative on site.

SMS conducted in situ density testing to AS1289.5.8.1 at randomly selected locations throughout areas in which fill was placed as per frequencies outlined in AS3798-2007. The density test results have been issued separately to LR&M and are retained in our project file. The required laboratory dry density ratio was achieved on all tests taken during fill placement. Laboratory tests were conducted to AS1289.5.1.1.

On the completion of Level 1 earthworks inspection and testing, SMS advise that the fill placed on Lot 149 Brougham Circuit as shown in Drawing SMS1.22205-F28.Rev0, was witnessed and in our opinion meets the requirements of "Controlled Fill" as defined in AS3798-2007 and AS2870-2011 "Residential slabs and footings".

However, it should be recognised that the passage of time affects the information provided in this letter. SMS's opinions are based upon information that existed at the time that our services were provided. The services allowed SMS to form no more than an opinion of the fill placement undertaken under our Level 1 inspection and testing services at the times the earthworks were carried out. These services cannot be used to assess the effect of any subsequent further works at the site.

If you have any questions relating to this project or require any additional information, please contact our office on (08) 8258 7498.

SMS GEOTECHNICAL PTY LTD



Luke Garcia
Laboratory Manager

Attachments: Drawing SMS1.22205-F28.Rev0

Location	Pre Fill	Post Fill
Lot 149 - 1	338.870	340.470
Lot 149 - 2	339.290	339.455

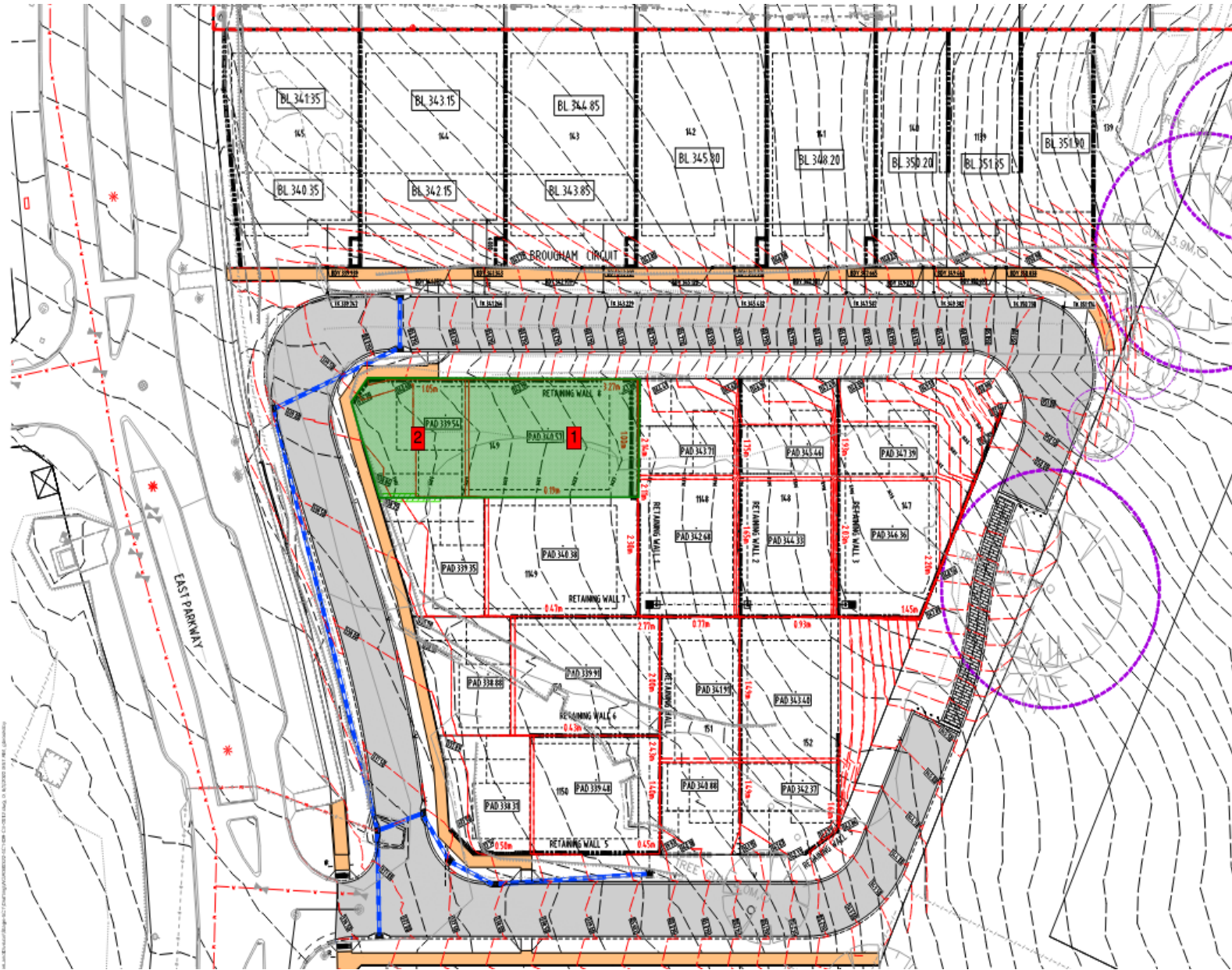

 Approx. Fill Location



Drawn:	LG	Date:	13.01.2023
Checked:	CS	Date:	13.01.2023
Revision:		Date:	
Scale:	NTS		A4

LR&M CONSTRUCTIONS PTY LTD BLUESTONE STAGE 5C1 MOUNT BARKER SITE PLAN SHOWING PRE AND POST FILL LEVELS	
Project No.:	SMS1.22205
Drawing No.:	SMS1.22205-F28.Rev0

13th January 2023

Reference No. SMS1.22205-L25.Rev0

Mr Michael Engelaar
LR&M Construction Pty Ltd
6 Roseworthy Road
ROSEWORTHY SA 5371

LOT 143 BROUGHAM CIRCUIT – BLUESTONE LAND DIVISION STAGE 5C1, MT BARKER

Dear Michael,

SMS Geotechnical Pty Ltd (SMS) was commissioned by LR&M Construction Pty Ltd (LR&M) to provide Level 1 earthworks inspection and testing services during fill placement on Lot 143 Brougham Circuit on the above project in Mt Barker, South Australia. The area where fill was placed is shown approximately in Drawing SMS1.22205-F25.Rev0.

SMS were provided with a TBM by LR&M which was used to measure and record both pre and post fill levels. Post fill levels were taken prior to the placement of topsoil. The post fill levels were measured at approximately the same locations as the pre fill levels. These levels are detailed in Drawing SMS1.22205-F25.Rev0.

Whilst the utmost amount of care was taken while measuring these levels, SMS is not a licensed surveyor and the difference in measurements on Drawing SMS1.22205-F25.Rev0 may differ slightly to the maximum depth of placed fill on this site.

Level 1 inspection and testing services were carried out by SMS to Australian Standard AS3798-2007 "Guidelines on earthworks for commercial and residential developments" between 31st March 2022 and 10th January 2023. The subgrade was inspected and showed no signs of organic or unsuitable material. Subgrade proof rolling was witnessed prior to fill being placed and was deemed suitable by SMS' representative on site.

SMS conducted in situ density testing to AS1289.5.8.1 at randomly selected locations throughout areas in which fill was placed as per frequencies outlined in AS3798-2007. The density test results have been issued separately to LR&M and are retained in our project file. The required laboratory dry density ratio was achieved on all tests taken during fill placement. Laboratory tests were conducted to AS1289.5.1.1.

On the completion of Level 1 earthworks inspection and testing, SMS advise that the fill placed on Lot 143 Brougham Circuit as shown in Drawing SMS1.22205-F25.Rev0, was witnessed and in our opinion meets the requirements of "Controlled Fill" as defined in AS3798-2007 and AS2870-2011 "Residential slabs and footings".

However, it should be recognised that the passage of time affects the information provided in this letter. SMS's opinions are based upon information that existed at the time that our services were provided. The services allowed SMS to form no more than an opinion of the fill placement undertaken under our Level 1 inspection and testing services at the times the earthworks were carried out. These services cannot be used to assess the effect of any subsequent further works at the site.

If you have any questions relating to this project or require any additional information, please contact our office on (08) 8258 7498.

SMS GEOTECHNICAL PTY LTD



Luke Garcia
Laboratory Manager

Attachments: Drawing SMS1.22205-F25.Rev0

Location	Pre Fill	Post Fill
Lot 143 - 1	343.400	344.765
Lot 143 - 2	343.400	343.750

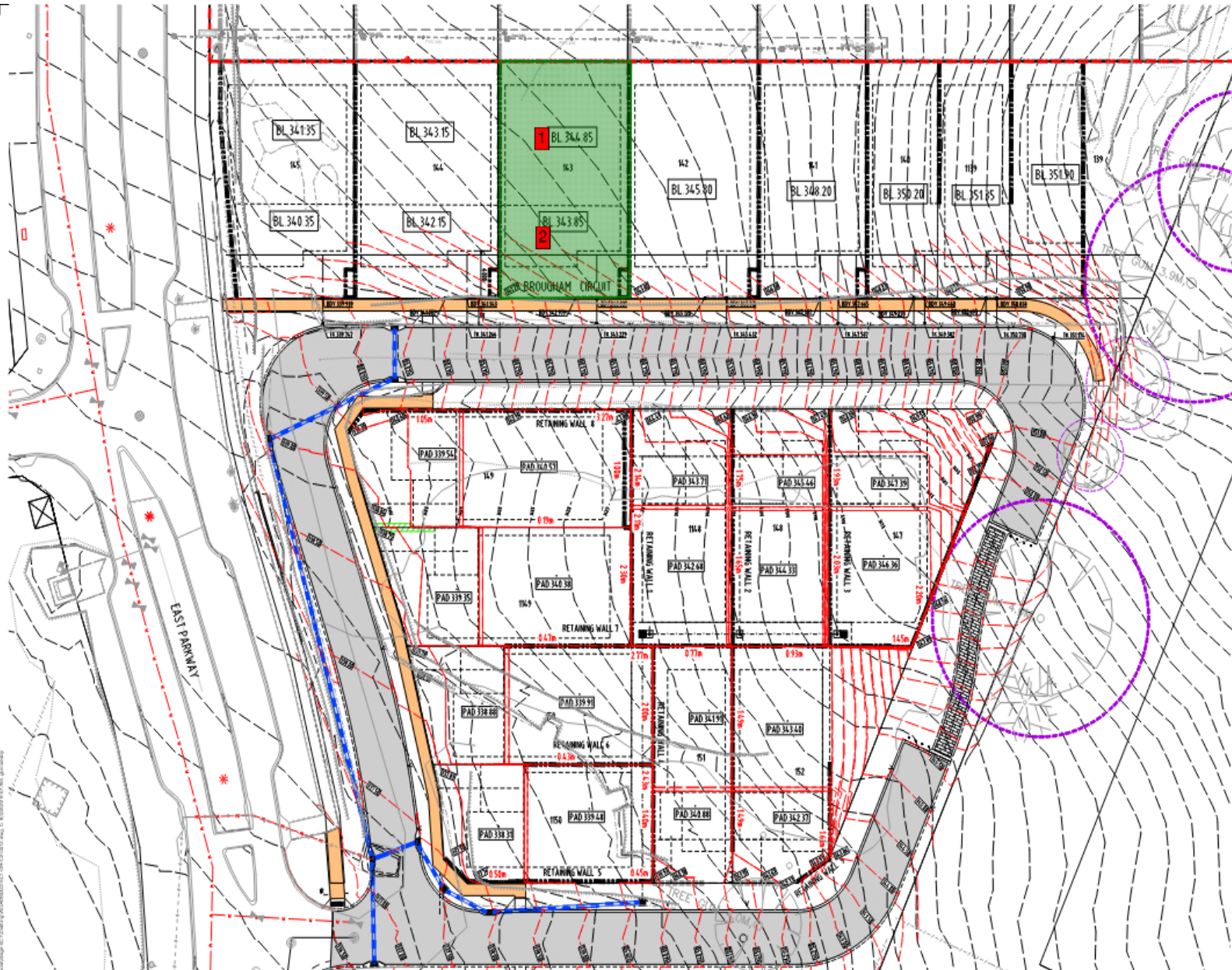

 Approx. Fill Location

SMS
GEOTECHNICAL
Quality in Construction

Drawn:	LG	Date:	13.01.2023
Checked:	CS	Date:	13.01.2023
Revision:		Date:	
Scale:	NTS		A4

LR&M CONSTRUCTIONS PTY LTD	
BLUESTONE STAGE 5C1	
MOUNT BARKER	
SITE PLAN SHOWING PRE AND POST FILL LEVELS	
Project No.:	SMS1.22205
Drawing No.:	SMS1.22205-F25.Rev0

13th January 2023

Reference No. SMS1.22205-L22.Rev0

Mr Michael Engelaar
LR&M Construction Pty Ltd
6 Roseworthy Road
ROSEWORTHY SA 5371

LOT 140 BROUGHAM CIRCUIT – BLUESTONE LAND DIVISION STAGE 5C1, MT BARKER

Dear Michael,

SMS Geotechnical Pty Ltd (SMS) was commissioned by LR&M Construction Pty Ltd (LR&M) to provide Level 1 earthworks inspection and testing services during fill placement on Lot 140 Brougham Circuit on the above project in Mt Barker, South Australia. The area where fill was placed is shown approximately in Drawing SMS1.22205-F22.Rev0.

SMS were provided with a TBM by LR&M which was used to measure and record both pre and post fill levels. Post fill levels were taken prior to the placement of topsoil. The post fill levels were measured at approximately the same locations as the pre fill levels. These levels are detailed in Drawing SMS1.22205-F22.Rev0.

Whilst the utmost amount of care was taken while measuring these levels, SMS is not a licensed surveyor and the difference in measurements on Drawing SMS1.22205-F22.Rev0 may differ slightly to the maximum depth of placed fill on this site.

Level 1 inspection and testing services were carried out by SMS to Australian Standard AS3798-2007 "Guidelines on earthworks for commercial and residential developments" between 31st March 2022 and 10th January 2023. The subgrade was inspected and showed no signs of organic or unsuitable material. Subgrade proof rolling was witnessed prior to fill being placed and was deemed suitable by SMS' representative on site.

SMS conducted in situ density testing to AS1289.5.8.1 at randomly selected locations throughout areas in which fill was placed as per frequencies outlined in AS3798-2007. The density test results have been issued separately to LR&M and are retained in our project file. The required laboratory dry density ratio was achieved on all tests taken during fill placement. Laboratory tests were conducted to AS1289.5.1.1.

On the completion of Level 1 earthworks inspection and testing, SMS advise that the fill placed on Lot 140 Brougham Circuit as shown in Drawing SMS1.22205-F22.Rev0, was witnessed and in our opinion meets the requirements of "Controlled Fill" as defined in AS3798-2007 and AS2870-2011 "Residential slabs and footings".

However, it should be recognised that the passage of time affects the information provided in this letter. SMS's opinions are based upon information that existed at the time that our services were provided. The services allowed SMS to form no more than an opinion of the fill placement undertaken under our Level 1 inspection and testing services at the times the earthworks were carried out. These services cannot be used to assess the effect of any subsequent further works at the site.

If you have any questions relating to this project or require any additional information, please contact our office on (08) 8258 7498.

SMS GEOTECHNICAL PTY LTD



Luke Garcia
Laboratory Manager

Attachments: Drawing SMS1.22205-F22.Rev0

Location	Pre Fill	Post Fill
Lot 140	349.010	350.200

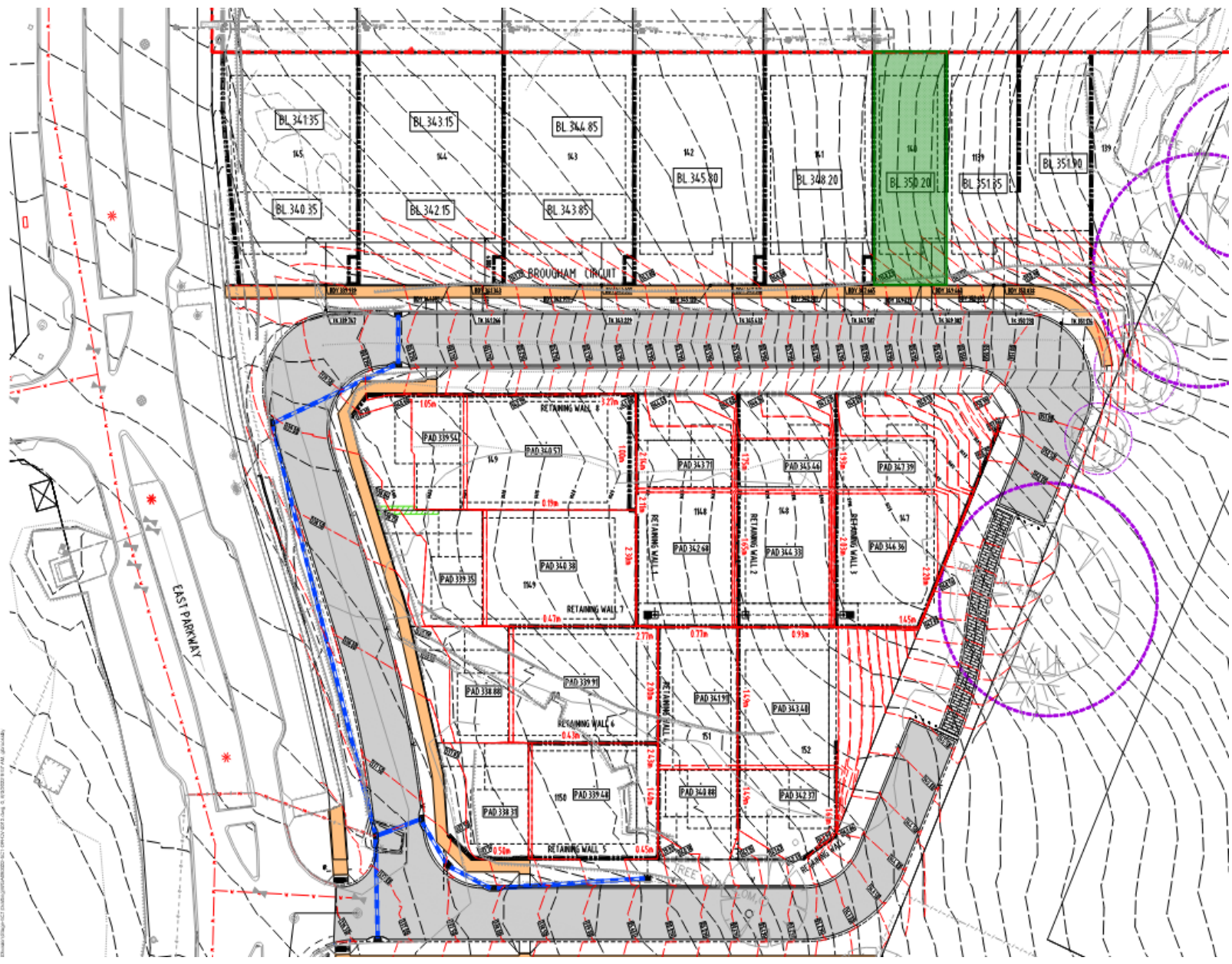

 Approx. Fill Location

SMS
GEOTECHNICAL
Quality in Construction

Drawn:	LG	Date:	13.01.2023
Checked:	CS	Date:	13.01.2023
Revision:		Date:	
Scale:	NTS		A4

LR&M CONSTRUCTIONS PTY LTD	
BLUESTONE STAGE 5C1	
MOUNT BARKER	
SITE PLAN SHOWING PRE AND POST FILL LEVELS	
Project No.:	SMS1.22205
Drawing No.:	SMS1.22205-F22.Rev0